



ASFA Officers and Board of Directors

Pres: Ping Pirrung; 1st VP: Dean Wright; 2nd VP: Thom Haig;
Corr. Sec'y: Bill Bowlus-Root; Rec. Sec'y: Karen Frederick;
Chief Financial Officer: Jeff Lipps

Region 1 Dir: Avery McLeod
Region 3 Dir: Peter Lowe
Region 5 Dir: Josie Haumont
Region 7 Dir: Todd Birchfield
Region 9 Dir: Rich Whitenour
Region 2 Dir: Lisa Voss
Region 4 Dir: Jack Downing
Region 6 Dir: Steve Curry
Region 8 Dir: Don Ewing
Region 10 Dir: Bill Martin



LKC Officers and Board of Directors

Pres: Deenie Morris 1st VP: Phil Bokar; 2nd VP: Laurie Temple
Secretary: Kathy Yontz
Treasurer: Nina Fetter
Directors: Jim Morris, Robert Fetter, Tony Smith

MGA Officers and Board of Directors

Pres: Joe Shoemaker VP: Meg Willis-Redfern
Corr. Sec'y: Caren Shoemaker Rec. Sec'y: Sue Ostrander
Treasurer: Rose Mary Frazer
Directors: Jim Frazer, Diane Guest, Jack Helder,
Meribeth Metevia, Vicki Roll



TSSC Officers and Board of Directors

Pres: Ping Pirrung VP: Meredith Wille
Secretary: Dawn Ferris
Treasurer: Barbara Duffield
Directors: Tom Cigolle, Paul Kytta & Carol Weber



Field Committee

Field Trial Chairmen: Dawn Ferris 419.632.0095 sabig@yahoo.com
Joe Shoemaker 734.904.5526 jas512@me.com
Field Trial Secretary: Ping Pirrung 724.586.6158 asfa.ii.fts@gmail.com
156 West Cruikshank Road, Butler, PA 16002-8928

Lure Operators: Bob Bohanek, Tom Cigolle, Steve Curry, Dawn Ferris,
Sean McMichael, Anne Midgarden, Bill Othick, Denis Seeley, Joe Shoemaker, Meg Willis-Redfern

Judging Panel

Todd Birchfield ... McDonough, GA
Kim Bork ... Meriden, KS
Jeff Lipps ... Blacklick, OH

Elaine McMichael ... Crestview, FL
Gary Runyan ... Sallisaw, OK
Laurie Soutar* ... Princeton, ON
* = Canadian

SATURDAY ASSIGNMENTS

FIELD A
Gary Runyan
Jeff Lipps

FIELD B
Todd Birchfield
Elaine McMichael

FIELD C
Kim Bork
Laurie Soutar

Basenji
Azawakh
Afghan Hound
Irish Wolfhound
Silken Windhound (Provisional)
Limited
Ibizan Hound
Scottish Deerhound
Greyhound
Cirneco dell'Etna
Pharaoh Hound
Borzoi
Rhodesian Ridgeback
Sloughi
Saluki
Italian Greyhound
Whippet

SUNDAY ASSIGNMENTS

FIELD A
Gary Runyan
Jeff Lipps

FIELD B
Todd Birchfield
Elaine McMichael

FIELD C
Kim Bork
Laurie Soutar

Italian Greyhound
Whippet
Basenji
Azawakh
Afghan Hound
Irish Wolfhound
Silken Windhound (Provisional)
Limited
Ibizan Hound
Scottish Deerhound
Greyhound
Cirneco dell'Etna
Pharaoh Hound
Borzoi
Rhodesian Ridgeback
Sloughi
Saluki

IMPORTANT INFORMATION

Trial Hours (EDT): 5:00 A.M. to completion

Roll Call and Inspection: Promptly at **6:00 A.M.**

* All breeds * No Exceptions

Stakes will be split into tentative flights on

Friday, April 12th at 5:30 PM in the Field Committee Tent

**All Entries close midnight Wednesday, March 27, 2013
(received at the FTS's home)**

Late, incomplete, unsigned, unpaid or conditional entries will not be accepted. Changes of stake and substitutions for lame or in season hounds may be made by notifying Ping Pirung (asfa.ii.ftis@gmail.com). Substitutions must be made no later than Monday, April 8, 2013 and will not appear in the catalogue. Substitutions must have been eligible for entry at the time entries closed and are from the same owner & household only.

Entries will **NOT** be acknowledged by mail.

**** Please DO NOT send entries overnight with signature required. ****

Eligibility for the INTERNATIONAL INVITATIONAL

Any hound that has earned at least 20 ASFA points, or equivalent points in its country of residence, or is an AKC or equivalent foreign Field Champion of Record in another lure coursing field trial-sanctioning organization or has placed in a Regional Invitational (with competition) is eligible to enter. Proof of non-ASFA title and non-ASFA points for hounds should be in the form of a photocopy of the certificate, or page of formal printing, and included with the entry. For a Limited breed to be eligible, the entry must have one first placement, or two second placements, with competition in the Limited Stake. For a Provisional breed to be eligible, the entry must have one first placement, or two second placements, with competition within its breed. All points or placements must be earned by the entry closing date of the event.

Only purebred Afghan Hounds, Azawakh, Basenjis, Borzois, Cirneco dell'Etna, Greyhounds, Ibizan Hounds, Irish Wolfhounds, Italian Greyhounds, Pharaoh Hounds, Rhodesian Ridgebacks, Salukis, Scottish Deerhounds, Sloughi, Whippets and Provisional Breeds may enter the regular stakes. Current Provisional breeds: Silken Windhounds. Limited breeds may be entered in the Limited Stake. Limited Stake breeds currently include purebred Chart Polski, Galgo Español, Magyar Agar, Peruvian Inca Orchid, Portuguese Podengo (Pequino) and Portuguese Podengo (Medio and Grande) and must be individually registered by the appropriate registry

All entries shall be individually registered with the AKC, NGA, FCI, UKC or an ASFA recognized foreign or an ASFA approved registry or possess a CRN from SPDBS.

Regular Stakes Offered

Open Stake - Any eligible sighthound that has met certification requirements and has earned at least 20 ASFA points, or equivalent in country of residence, excluding ASFA Field Champions of record.

Field Champion - Any ASFA Field Champion.

Veterans - Any eligible sighthound that has met certification requirements and that is six years of age or older (5 years for Irish Wolfhounds; 7 years or older for Afghans, Whippets & Rhodesian Ridgebacks).

Limited - Any sighthound of an eligible breed that has met certification requirements and have one 1st placement or two 2nd placements with competition in the Limited Stake.

Non-Regular Stakes Offered

Bench Champion Stake: For any hound eligible to enter a regular stake, that is an AKC, CKC, UKC or ASFA-approved International show champion of record. A copy of the hound's championship certificate must accompany each Stake entry.

To enter the Bench Stake be sure to check the appropriate box on the entry form AND include a copy of the hound's Championship certificate with the entry. Be sure to add the \$5 fee with your entry.

Kennel Stake: For two hounds of the same breed, designated at the time of entry, entered in one of the regular stakes, owned and kennelled by the same person. \$5 per pair.

Breeder Stake: For two hounds of the same breed, designated at the time of entry, entered in one of the regular stakes, bred by the same individual.

Note: An owner/breeder may have more than one entry in the kennel or breeder stakes as long as the two hounds comprising each entry are properly identified at the time of entry. A hound may only be part of any one kennel and one breeder stake entry. Please send in Breeder/Kennel Stake form indicating pairs along with properly marked entry forms.

Gillette Stake – Saturday Only

The competition will be run following the same procedures as Best in Field. The eligible hound in each breed that receives the highest qualifying combined score during competition in the Field Champion or Veteran Stake on Saturday will be randomly drawn to run in the Gillette Stake.

Best in International Invitational – Sunday Only

This competition is run on Sunday, following the same procedures as Best in Field, except that all Best of Breed winners from Saturday and Sunday are eligible to compete provided they have been entered and received qualifying scores, running in prelims and finals, both Saturday and Sunday. The hound that wins Best in International Invitational will be credited with winning a Best in Field.

Running Procedure

- Stakes will be split into flights, in public view at 5:30 PM, Friday, April 12th, if the entry in any one stake is 20 or more hounds.
- All hounds will run twice, in trios if possible, or braces unless excused, dismissed or disqualified.
- Hounds not present at roll call will be scratched.
- Bitches in season, hounds with breed disqualifications and lame hounds at roll call/inspection will be excused and entry fee refunded.
- Monorchid, cryptorchid, spayed or neutered hounds may be entered.
- Muzzles are not required.
- The Field Committee reserves the right to alter the course plans as required by weather and/or field conditions on the day of the trial.
- There will be a \$10 fine for any loose hound on the field not taking part in a course in progress.
- There will be a **\$50 fee for returned checks**.
- Everyone must clean up after their own dogs.
- A battery powered continuous loop lure machine(s) will be used on each field except for Gillette Stake & BII where drag lure will be used.
- Backup equipment will be available.
- The lure will consist of highly visible plastic strips.

THERE IS LIMITED SHADE. WATER WILL BE AVAILABLE FOR COOLING DOWN HOUNDS. PLEASE BRING DRINKING WATER AND SHADE FOR YOU AND YOUR DOGS.

Eligibility for the GILLETTE STAKE

Eligible hounds must have **ALL** of the following:

- 1) Be an AKC or foreign bench champion of record
- 2) Be an ASFA Field Champion,
- 3) Have earned 20 ASFA points in the 12-month period preceding close of entries.
- 4) Be entered in the Field Champion or Veteran Stake on Saturday.

Requirements must be met prior to close of entries. Proof of bench title should be in the form of a photocopy or page from formal printing and **MUST BE INCLUDED WITH THE ENTRY. NO EXCEPTIONS WILL BE MADE.** The Field Trial Secretary must receive a special entry form for the Gillette Stake by the closing date for regular entries. There is no additional fee for an entry in this stake.

In addition the following perpetual trophies will be offered:

Memorial Trophies

Saturday

Gary Forrester	Afghan Hound	Bandit
Merv Bauer	Azawakh	Cinnamon
Locket	Basenji	Sheena
Mike Lorenzo	Borzoi	Pyerun
Downing & Dickinson	Greyhound	Fantasy
Kevin Bryson	Ibizan Hound	Flyer
Marc Gembala	Italian Greyhound	"D"
Bill Henry	Irish Wolfhound	Joshua
Robert Sellers	Pharaoh Hound	Bozo
Tom Leone	Rhodesian Ridgeback	Ida
	Saluki	Haseeb
	Sloughi	Bouthayna
	Scottish Deerhound	Pyns
	Whippet	Betz Leone

Sunday

- *The Gillette Memorial Trophy will be awarded to the **Gillette Stake Winner** on Saturday.
- *The AWC Perpetual Trophy is awarded to the **Whippet** representing the breed in the Gillette Stake.
- *The Darkling Perpetual Trophy is awarded to the **Borzoi** representing the breed in the Gillette Stake.
- *The Eterna Perpetual Trophy is awarded to the **Ibizan Hound** representing the breed in the Gillette Stake.
- *The Gallant Perpetual Trophy is awarded to the **NGA Greyhound** with the greatest cumulative score for both days at the II.
- *The President's Cup, donated by Arnold Ross and \$100, donated by the current ASFA President, will be awarded to the winner of **Best in International Invitational** on Sunday.

Special award for the Gillette Stake winner:

Mati Memorium, a hand crafted pottery bowl featuring various coursing breeds in memory of DC Klassic Gebeep Hakuna Matata, LCM 12, the Basenji "Mati", donated by Suzi Clark.

International Aeromodeling Center Site Map

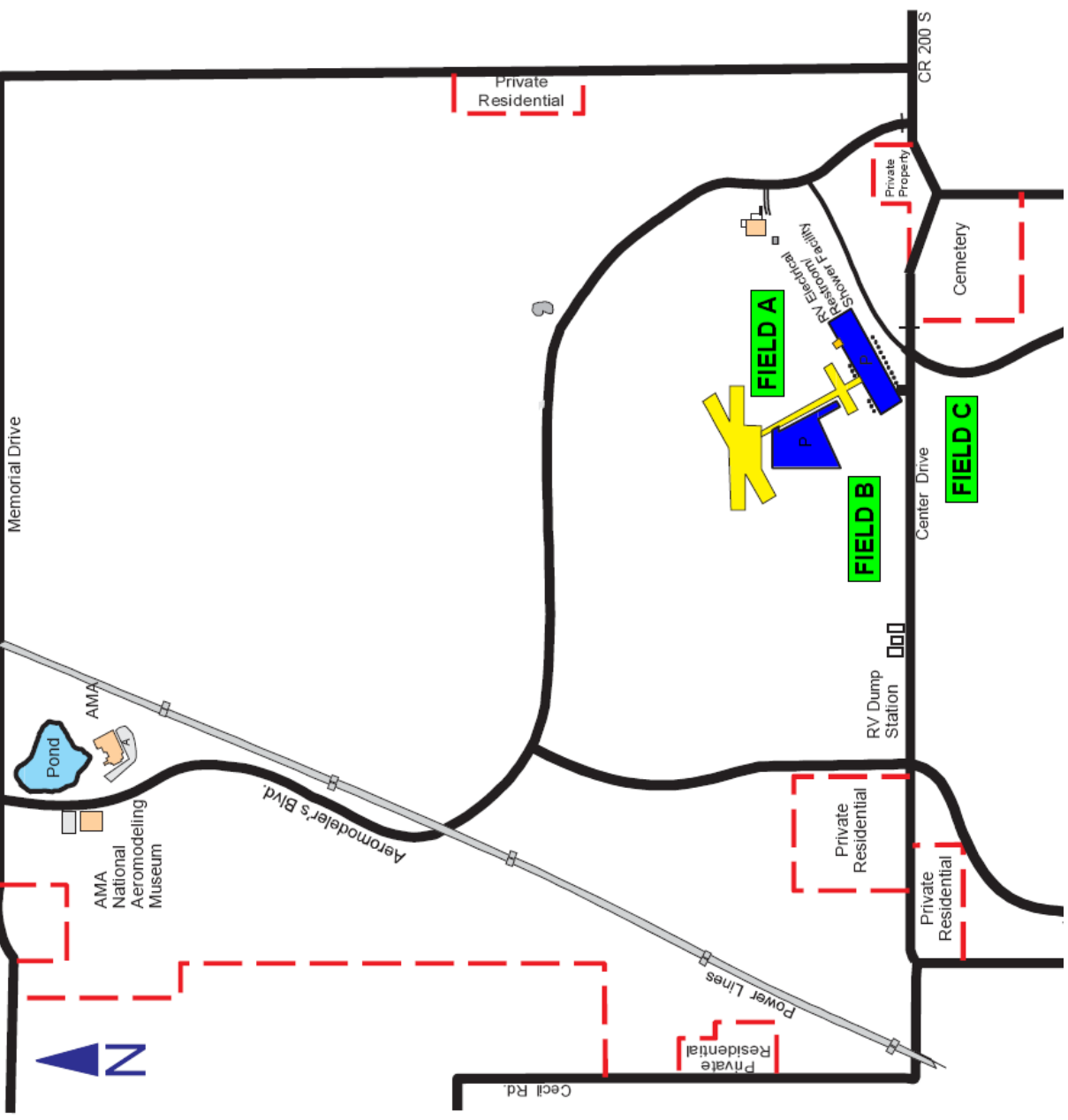

SPEED LIMIT 25 mph

DO NOT DRIVE ON RUNWAYS MARKED IN YELLOW

PLEASE PARK IN THE PARKING LOTS MARKED IN BLUE

THE THREE FIELD AREAS THAT WILL BE USED ARE MARKED IN GREEN

COURSE PLANS

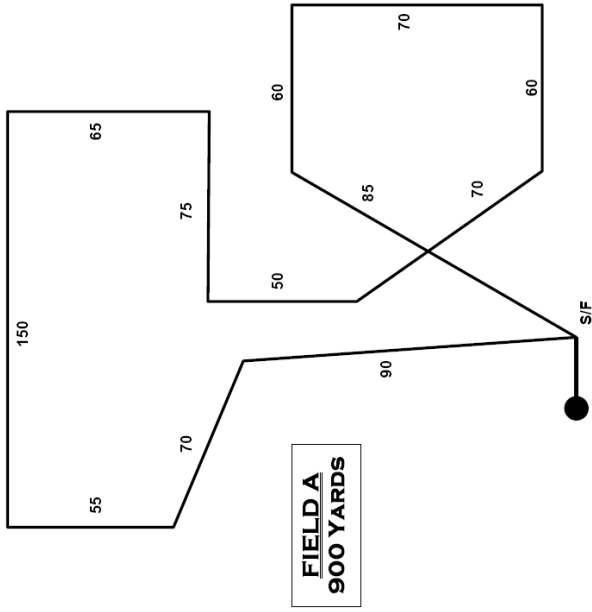

Field A 900 yards

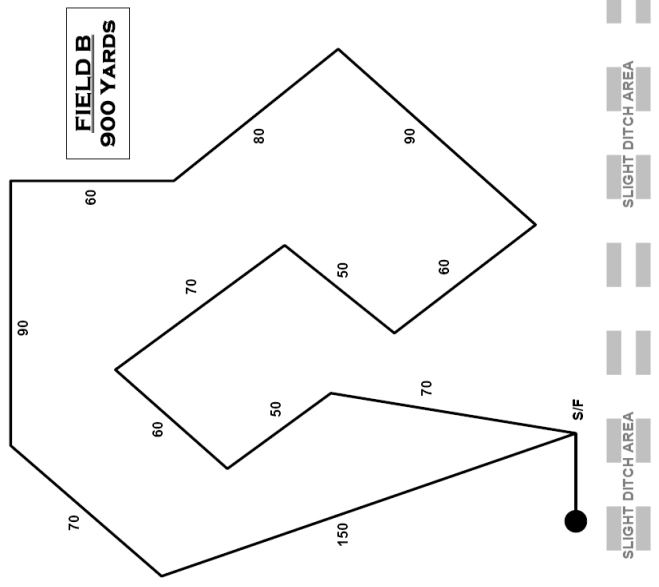

Field B 900 yards

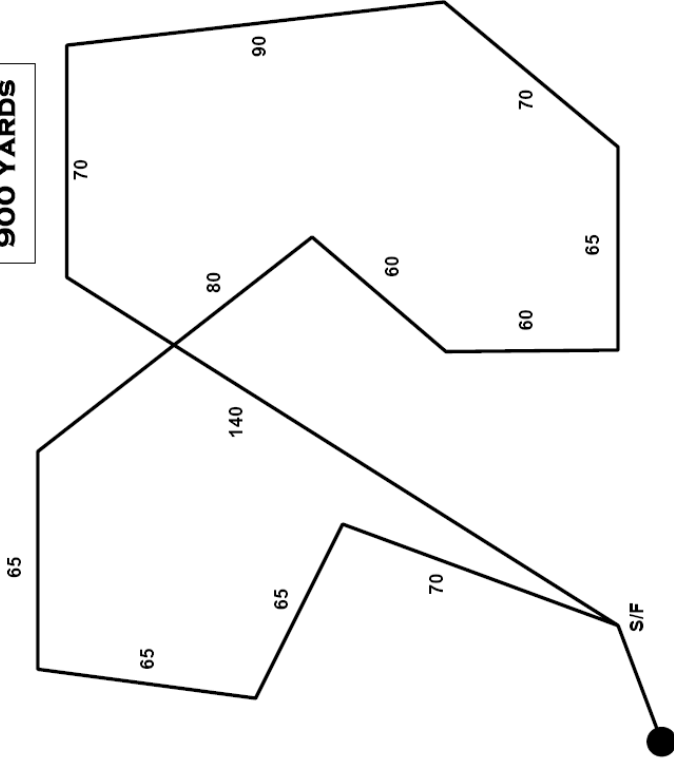

Field C 900 yards

***** Courses will be reversed for finals *****
 Courses may also be reversed for Runoffs and
 Best of Breed at the discretion of the field committee
 and/or field judges

Best in II (Field A) 1,250 yards

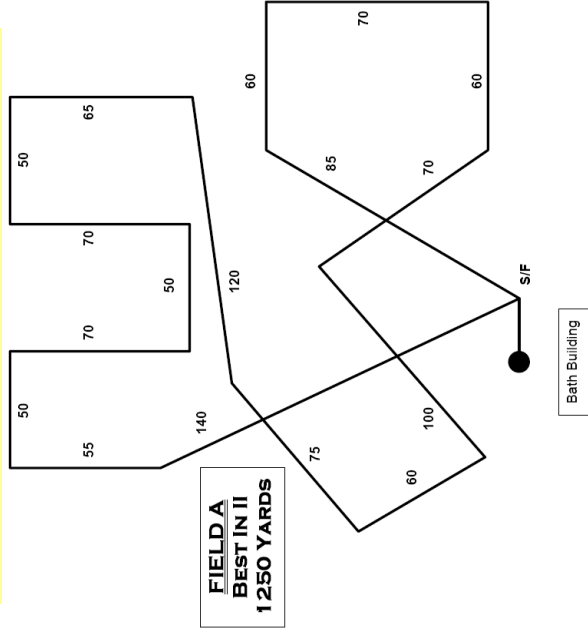

Gillette Cup (Field A) 1000 yards

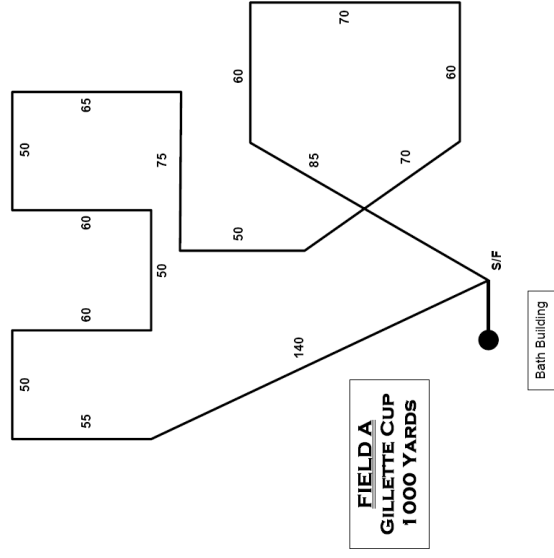

Rosettes & Trophies

- ✦ LKC, MGA & TSSC will award rosettes for all placements
- ✦ ASFA will award medallions for Best of Breed winners
- ✦ LKC, MGA & TSSC will award rosettes for high score in Breeder and Kennel Stakes each day.
- ✦ LKC, MGA & TSSC will award rosettes for high score in Bench Stakes each day.
- ✦ LKC, MGA & TSSC will award the Gillette Stake winner with a rosette and ASFA will award a medallion.
- ✦ LKC, MGA & TSSC will award the Best in International Invitational winner with a rosette and ASFA will award a medallion.
- ✦ LKC, MGA & TSSC and ASFA will award trophies for all placements and Best of Breed.



Field Conditions

The fields are well groomed grassy fields that are used by model plane enthusiasts from which to fly their planes. The area is so expansive that there are no sight lines on any of the three fields we are using for the II. Exhibitors should make sure their dogs are in shape! There is no shade so be sure to bring your own. Water will be available for cooling down your hounds.

Individuals entering and using the AMA facilities and/or grounds do so at their own risk. The AMA shall not be liable for any claims for bodily injury to themselves or their dogs or property damage arising out of or related to the use of the International Aeromodeling Center.

OFFICIAL AMERICAN SIGHTHOUND FIELD ASSOCIATION ENTRY FORM

36th ASFA International Invitational

Saturday, April 13, 2013

Entry: \$29 first dog; \$26 each additional entry from same household & owner

Entries received after March 6th: \$36 per hound

All entries close Wednesday March 27, 2013

\$5 for Bench, \$5 per pair Kennel and Breeder (fill out separate form)

Make checks payable to **2013 II** and mail to:

Ping Pirrung, FTS, 156 West Cruikshank Road, Butler, PA 16002-8928

Fee Paid _____ The Field Secretary cannot accept conditional, unsigned, incomplete or unpaid entries; please check your completed entry carefully.

Breed:		Call Name:	
Registered Name of Hound:			
Stake: <input type="checkbox"/> Open <input type="checkbox"/> FCH <input type="checkbox"/> Veteran <input type="checkbox"/> Limited		Additional Stakes <input type="checkbox"/> Kennel <input type="checkbox"/> Breeder <input type="checkbox"/> Bench	
Registration Number: (please write in registering body before number)			
<input type="checkbox"/> If possible, please separate my hounds		Date of Birth:	
Name of actual owner(s):		Sex: <input type="checkbox"/> Dog <input type="checkbox"/> Bitch	
Address:			
City:		State:	
E-mail (Optional)		Zip:	
(Optional) Region of Residence:			
<input type="checkbox"/> Check if any information has changed since the last ASFA trial entry. Regarding _____			
<input type="checkbox"/> Check if this hound has been dismissed within the last 6 trials entered. Must be marked in order to qualify for a "clean" trial requirement.			

I CERTIFY that I am the actual owner of this dog, or that I am the duly authorized agent of the actual owner whose name I have entered above. In consideration of the acceptance of this entry and the opportunity to have this dog judged and to win prize money, ribbons, or trophies, I (we) agree to abide by the rules and regulations of the American Sighthound Field Association in effect at the time of this lure field trial, and by any additional rules and regulations appearing in the premium list for this lure field trial. I (we) agree that the club holding this lure field trial has the right to refuse this entry for cause, which the club shall deem to be sufficient. I (we) agree to hold this club, its members, directors, governors, officers, agents or other functionaries, any employees of the aforementioned parties and the owner(s) of the trial premises or grounds harmless from any claim for loss or injury which may be alleged to have been caused directly or indirectly to any person or thing by the act of this dog while in or upon the lure field trial premises or grounds or near any entrance thereto and I (we) personally assume all responsibility and liability for any such claim, and I (we) further agree to hold the aforementioned parties harmless from any claim loss of this dog by disappearance, theft damage or injury be caused or alleged to be caused by the negligence of the club or any of the aforementioned parties or by the negligence of any person or any other cause or causes. I (we) certify and represent that the dog entered is not a hazard to person or other dogs. This entry is submitted for acceptance of the forgoing representations and agreements

SIGNATURE of owner or his agent _____
duly authorized to make this entry

OFFICIAL AMERICAN SIGHTHOUND FIELD ASSOCIATION ENTRY FORM

36th ASFA International Invitational

Sunday, April 14, 2012

Entry: \$29 first dog; \$26 each additional entry from same household & owner

Entries received after March 6th: \$36 per hound

All entries close Wednesday March 27, 2013

\$5 for Bench, \$5 per pair Kennel and Breeder (fill out separate form)

Make checks payable to **2013 II** and mail to:

Ping Pirrung, FTS, 156 West Cruikshank Road, Butler, PA 16002-8928

Fee Paid _____ The Field Secretary cannot accept conditional, unsigned, incomplete or unpaid entries; please check your completed entry carefully.

Breed:		Call Name:	
Registered Name of Hound:			
Stake: <input type="checkbox"/> Open <input type="checkbox"/> FCH <input type="checkbox"/> Veteran <input type="checkbox"/> Limited		Additional Stakes <input type="checkbox"/> Kennel <input type="checkbox"/> Breeder <input type="checkbox"/> Bench	
Registration Number: (please write in registering body before number)			
<input type="checkbox"/> If possible, please separate my hounds		Date of Birth:	
Name of actual owner(s):		Sex: <input type="checkbox"/> Dog <input type="checkbox"/> Bitch	
Address:			
City:		State:	
E-mail (Optional)		Zip:	
(Optional) Region of Residence:			
<input type="checkbox"/> Check if any information has changed since the last ASFA trial entry. Regarding _____			
<input type="checkbox"/> Check if this hound has been dismissed within the last 6 trials entered. Must be marked in order to qualify for a "clean" trial requirement.			

I CERTIFY that I am the actual owner of this dog, or that I am the duly authorized agent of the actual owner whose name I have entered above. In consideration of the acceptance of this entry and the opportunity to have this dog judged and to win prize money, ribbons, or trophies, I (we) agree to abide by the rules and regulations of the American Sighthound Field Association in effect at the time of this lure field trial, and by any additional rules and regulations appearing in the premium list for this lure field trial. I (we) agree that the club holding this lure field trial has the right to refuse this entry for cause, which the club shall deem to be sufficient. I (we) agree to hold this club, its members, directors, governors, officers, agents or other functionaries, any employees of the aforementioned parties and the owner(s) of the trial premises or grounds harmless from any claim for loss or injury which may be alleged to have been caused directly or indirectly to any person or thing by the act of this dog while in or upon the lure field trial premises or grounds or near any entrance thereto and I (we) personally assume all responsibility and liability for any such claim, and I (we) further agree to hold the aforementioned parties harmless from any claim loss of this dog by disappearance, theft damage or injury be caused or alleged to be caused by the negligence of the club or any of the aforementioned parties or by the negligence of any person or any other cause or causes. I (we) certify and represent that the dog entered is not a hazard to person or other dogs. This entry is submitted for acceptance of the forgoing representations and agreements

SIGNATURE of owner or his agent _____
duly authorized to make this entry

OFFICIAL AMERICAN SIGHTHOUND FIELD ASSOCIATION ENTRY FORM
36th ASFA International Invitational
Gillette Stake
 Saturday, April 13th, 2013

By signing and submitting this entry, you certify that this hound meets **ALL** of the following eligibility requirements for the Gillette Stake.
 _____ Has an AKC or foreign bench championship
 _____ **Proof is submitted with entry form**
 _____ Is an ASFA Field Champion
 _____ Has earned 20 ASFA points in the 12-month period preceding 03/27/2013
 _____ Is entered in the Field Champion or Veteran Stake on Saturday, 03/27/2013
Early Entries close March 6th, 2013, Late Entries close March 27th, 2013
 Eligibility requirements must be met by closing date, with proof submitted with entry.

Breed:	Call Name:		
Registered Name of Hound:	Registration Number: (circle one)		
AKC Registration: AKC ILP/PAL: NGA #: Critique Case #: Foreign Reg. No. & Country: Pending: UKC #	Date of Birth:	Sex: <input type="checkbox"/> Dog <input type="checkbox"/> Bitch	
Name of actual owner(s):	Phone:		
Address:	City:	State:	Zip:
E-mail (Optional)	(Optional) Region of Residence:		
Breeder (Optional)			
Sire (Optional)			
Dam (Optional)			

I CERTIFY that I am the actual owner of this dog, or that I am the duly authorized agent of the actual owner whose name I have entered above. In consideration of the acceptance of this entry and the opportunity to have this dog judged and to win prize money, ribbons, or trophies, I (we) agree to abide by the rules and regulations of the American Sighthound Field Association in effect at the time of this lure field trial, and by any additional rules and regulations appearing in the premium list for this lure field trial. I (we) agree that the club holding this lure field trial has the right to refuse this entry for cause, which the club shall deem to be sufficient. I (we) agree to hold this club, its members, directors, governors, officers, agents or other functionaries, any employees of the aforementioned parties and the owner(s) of the trial premises or grounds harmless from any claim for loss or injury which may be alleged to have been caused directly or indirectly to any person or thing by the act of this dog while in or upon the lure field trial premises or grounds or near any entrance thereto and I (we) personally assume all responsibility and liability for any such claim, and I (we) further agree to hold the aforementioned parties harmless from any claim loss of this dog by disappearance, theft, damage or injury be caused or alleged to be caused by the negligence of the club or any of the aforementioned parties or by the negligence of any person or any other cause or causes. I (we) certify and represent that the dog entered is not a hazard to person or other dogs. This entry is submitted for acceptance of the foregoing representations and agreements

SIGNATURE of owner or his agent _____
 duly authorized to make this entry _____

Kennel & Breeder Stake Entry
 One Form per Pair of Hounds per Stake

Check one or both: Kennel Stake Breeder Stake
 Check one or both: Saturday Sunday

Breed: _____

Breeder(s): _____

Hound #1: _____

Call Name: _____

Registered Name: _____

Owner(s): _____

Call Name: _____

Registered Name: _____

Owner(s): _____

Please include \$5.00 per pair of hounds for EACH non-regular stake entry. Must accompany entries.



Kennel & Breeder Stake Entry
 One Form per Pair of Hounds per Stake

Check one or both: Kennel Stake Breeder Stake
 Check one or both: Saturday Sunday

Breed: _____

Breeder(s): _____

Hound #1: _____

Call Name: _____

Registered Name: _____

Owner(s): _____

Call Name: _____

Registered Name: _____

Owner(s): _____

Please include \$5.00 per pair of hounds for EACH non-regular stake entry. Must accompany entries.



Thank you to Les PekarSKI for
the slogan
for this year's II

"Flying First Class in 2013"

RAFFLE AND AUCTION

There will be a Chance Auction **and** a bidding auction for some unique and fun items.

Everything from practical item such as collars, dog bowls, tote bags to some unique and one of a kind art.

If you find you have some things that you no longer want to look at or may have won and can't use please consider donating them to the auction.

All proceeds will go to defer expenses for the II.

In order to make the raffle as diverse and fun as possible, please contact Dean Wright with a description of the item(s) you will be donating or with any questions you may have.

Dean Wright
h1b2@comcast.net
717.637.3011

2013 II Wearables

T-Shirts and Hats commemorating the 36th ASFA II

Logo is viewable at www.asfa.org or 2013 II Facebook page

Short Sleeved T-Shirt (silk-screened logo) Sports Grey **\$15.00**

Ladies V-neck T-Shirt (silk-screened logo) Sports Grey **\$15.00**

Long Sleeved T-Shirt (silk-screened logo) Royal Blue **\$20.00**

*T-Shirts are Adult Sizes: S, M, L, XL,
for 2X & 3X add \$3 per shirt
for 4X & 5X add \$6 per shirt*

Hats (embroidered logo) Stone **\$15.00**

Pre-order deadline: March 6th, 2013

Please pre-order to ensure size availability.

Make all checks payable to **2013 II** and **mail with your entries.**

For other colors of hats and additional II wearables
please contact Kathy Lipps lippsk@aol.com

2013 II Order Form for Wearables

Name: _____

Phone: _____ E-Mail: _____

T-shirts: QTY: _____ Size(s): _____ T-shirt Sub Total: \$ _____
Sizes 2X or 3X add \$3 Sizes 4X & 5X add \$6

Ladies T-shirts: QTY: _____ Size(s): _____ Ladies T-shirt Sub Total: \$ _____
Sizes 2X or 3X add \$3 Sizes 4X & 5X add \$6

Long Sleeved T-shirts: QTY: _____ Size(s): _____ Long Sleeved T-shirt Sub Total: \$ _____
Sizes 2X or 3X add \$3 Sizes 4X & 5X add \$6

Hats: QTY: _____ Hat Sub Total: \$ _____

Total Amount Enclosed: \$ _____

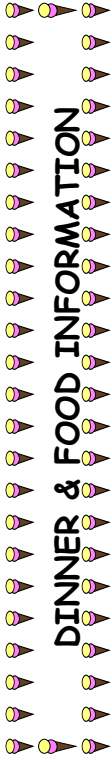

DINNER & FOOD INFORMATION

DINNER ORDER FORM

Name(s): _____

Total # of meals ____ X \$25 = \$ ____ (enclosed)

*Make check out to **2013 II** for the total amount and include with entries. (See Worksheet)*

We hope you will join us for a delicious dinner to be held Saturday evening at the Field. Dinners will cost \$25 each. In keeping with our **green** theme those who bring their own **NON**-disposable plate, silverware, cup, etc. will earn a \$2 discount on their meal. You will receive your discount when you check in for dinner with your NON-disposable plate and utensils

We encourage you to save some green by acting green.

Dinner is an ALL YOU CAN EAT BUFFET by Jonathan Byrd's Catering!

- Entrées:** Southern Fried Chicken
 BBQ Pork Ribs
 Baked Cheese Ravioli
Sides: Parsley Buttered Potatoes
 Southern Style Green Beans
 Cole Slaw
 Tossed Garden Salad
 Dinner rolls and butter

Dessert: Assorted cookies and brownies
 There will be iced tea and lemonade to drink

To order dinner(s) please complete the above form and mail with entries.

Breakfast and lunch will also be available both days a la carte.

VENDOR REGISTRATION

Anyone selling **anything** at the II must complete the Vendor Registration Form. There will be a special area set aside for the vendors. The fee will be \$40 for the weekend,. The spots will be numbered, and each vendor will be assigned a 10' X 10' area. All vendors must register by completing and mailing the following form with payment. **It is the responsibility of the vendor to determine the applicable laws & tax laws for vending in the state of Indiana.**

Questions regarding vendor spaces please contact:

Dawn Ferris 419.632.0095 sabig@yahoo.com

Vendor Registration Form

Vendor Name _____
 DBA _____
 Address _____
 City, State, ZIP _____
 Phone _____ E-Mail _____ (required)
 Product(s) for sale _____

Mail completed form and check made payable to **2013 II**

Trophy Sponsorships

Gain recognition for yourself and your breed by sponsoring II trophies.

Best of Breed	\$45	General donations to the trophy fund:	
Stake Winner	\$35	Silver Class	\$10-\$25
Flight Winner	\$25	Gold Class	\$26-\$75
Kennel Stake	\$25	Platinum Class	\$76+
Breeder Stake	\$25		
Bench Stake	\$25		

Please send a check payable to **2013 II** to the Field Trial Secretary with your entries. All trophy sponsors and general fund donations will be listed in the catalogue *if received by March 6, 2013.*

HOSPITALITY and FOOD

Please join us for light snacks at an informal get-together at the field on Friday night, April 12th. This evening's festivities will be sponsored by Michigan Gazehound Association. Bring wine and/or beer to share.

There will be a caterer on site for breakfast and lunch on Saturday and Sunday. Please plan to have cash on hand for meals (consider small bills).

Please join us for the International Invitational Banquet at the field on Saturday evening. Reservations for the dinner are required. See information elsewhere in the premium.

COMMEMORATIVE LOGO PINS

You can order commemorative logo pins of the 36th ASFA II by indicating on the worksheet. The cost will be \$6 each and will be available by **PRE-ORDER ONLY**.

FTS YAHOO GROUPS FOR THE II

By subscribing to the group you'll get:

- ★ UPDATES
- ★ ANSWERS TO PERTINENT QUESTIONS
- ★ REMINDERS

To subscribe send an e-mail to:

ASFA_International_Invitationals-Subscribe@yahoogroups.com

You will receive an e-mail back asking you to confirm your subscription. If you have any questions, e-mail asfa.ii.fts@gmail.com

You are encouraged to join if you plan to attend. The group will be monitored so only pertinent information will be posted.

CAMPING

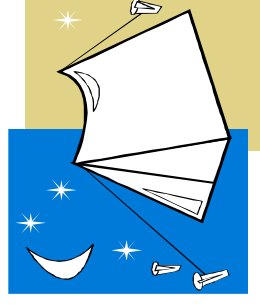

RVs & travel trailers: \$25 per night with electrical hookups.

Tents: \$10 per night (no electricity). **All** campers will need to register with AMA upon arrival or the following morning if you arrive after the AMA closes.
No camp fires.

Include fee with entries, checks payable to 2013 II. (See worksheet.)

Campsites will be available from 12:00 PM (noon) Friday through Monday morning.

There will be assigned campsites so if you would like to park next to someone, please indicate their name on the camping section on the worksheet - the last page of this premium list.

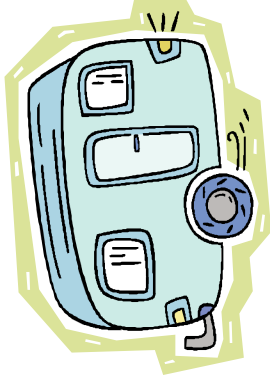

American Sighthound Field Association

For Information go to

WWW.ASFA.ORG

- Monthly posting of Official Trial Results
- Trial Schedule with links to premium lists
- Top 20-Current and Lifetime
- Newly Titled Hounds
- Running Rules and Policies

Additional information is available on the 2013 ASFA II Facebook page
<https://www.facebook.com/2013ASFAII>

MAKING THE FTS' LIFE BEARABLE

And yours too, in the process

These are some things to consider when completing and sending in your entries which will be most helpful to me and make my job a little easier. Thanks.

Ping Pirrung, FTS 2013 ASFA I.I.

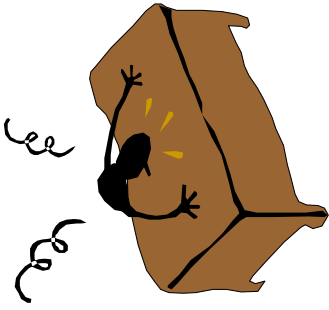

☞ There are two closing dates this year because we wanted to give you extra time to get those 20 points on your open dogs. For open hounds that have 20 points send their entries in prior to March 6th; for those open hounds that haven't obtained 20 points by March 6th you have until March 27th to send in their entries.

☞ Please write clearly – the information in the catalogue depends on being able to accurately spell your hound's name and your name.

☞ Please include your phone number and e-mail address in case there are questions. E-mail is preferable.

☞ If you are using preprinted entries for your dogs, double check that all the necessary information is included such as stake, sex etc. Be sure that the top of the entry form has the following:

- 36th ASFA International Invitational
- The date (Saturday, April 13, 2013 or Sunday April 14, 2013)
- Ping Pirrung, FTS, 156 West Cruikshank Road, Butler, PA 16002.

☞ If your dog has multiple titles, please put a comma between each title so that it can be put into the catalogue accurately.

☞ Be sure your entries are signed.

☞ For Kennel & Breeder stakes, it is much easier if the regular entries for all the dogs entered in those (kennel or breeder) stakes are also included in the same envelope. For example, you want to enter breeder stake and a different person owns one of the dogs you want to enter, if you could co-ordinate your entries to be sent in together that would be ideal.

☞ For the Gillette stake, please attach the proof of Championship to the Gillette Stake entry form and be sure they qualify for ALL of the requirements. They are listed at the top of the Gillette stake entry form.

☞ For the Bench Stake be sure to check the appropriate box on the entry form AND include a copy of the hound's Championship certificate with the entry. Be sure to add the \$5 fee with your entry.

☞ When you put your entries in the envelope, please take a moment to tear or cut the entry forms apart so they are separate; it's very time consuming for the FTS to have to cut or tear apart entries. (Often when entries forms are left on one sheet one entry's information tends to be overwritten onto another.)

☞ Put all the entries for Saturday together and then the ones for Sunday in the order of Open, F.Ch. then Veteran for each day.

☞ Check your entries again to be sure all the information is accurate and complete, especially if you are completing them at the last minute. All entry forms must be 5½" X 8½".

☞ If you do send your entries overnight, please be sure it does NOT require a signature. You'll need to check the box on the address label for no signature required. (I live in a rural area and it's a 20 minute drive, no way, to the post office so this would only delay the receipt of your entries.) Please do NOT send entries by CERTIFIED MAIL as this does require a signature.

☞ Plan to send your entries in well before the deadline that way they can be checked early so that if there are questions they can be taken care of. You can well imagine the huge amount of entries that would have to be processed if everyone mailed the week before the closing.

☞ Use the worksheet to help figure the total amount of your check. Please use the worksheet even if you are only sending in an entry for one dog. The worksheets are used as a quick reference for questions.

☞ If you want to confirm receipt of your entry, please enclose a stamped, self-addressed envelope or post card that can be dropped in the mail. Please do not e-mail me asking if an entry has been received.

☞ Please note that if you need to change the stake of your entry it would be greatly appreciated if you could notify me before the trial, preferably by Monday, April 8, 2013.

☞ If you need to substitute for a lame or in season hound, I need to be notified no later than Monday, April 8, 2013. There will be no substitutions on the day of the trial.

if you have any questions please contact me, the more we can take care of before the weekend, the easier it will be. My e-mail address is asfa.ii.fts@gmail.com or phone 724.586.6158 before 10PM (remember we are in the Eastern time zone). It's easier to contact me via email and you'll most likely get a quicker response that way. I really appreciate you taking the extra effort to help. See you in April!!

2013 ASFA II WORKSHEET



To help you plan, and to let us know for what you are sending a check, please fill out the worksheet below and include with your entries. Indicate the amount for each item you are paying. Leave blank those things you are not entering, or not sending money. Total it up at the end, and send only one check made payable to "2013 II" with all of the appropriate entry, meal reservation, trophy donations, trophy cart rental and vendor registration forms. A separate check is required for catalogue advertising and is sent to Vicky Clarke.

Name: _____ Breed(s): _____

Address: _____

Phone: _____ E-mail: _____

ENTRIES TOTAL

Saturday

Saturday **Breeder Stakes**
Saturday **Kennel Stakes**
Saturday **Bench Stakes**

Sunday

Sunday **Breeder Stakes**
Sunday **Kennel Stakes**
Sunday **Bench Stakes**

SATURDAY EVENING DINNER (include reservation form)

_____ Total # of meals X \$25 =

VENDOR REGISTRATION (include vendor registration form)

_____ Vendor Spots X \$40 =

TROPHY DONATIONS

_____ Total Best of Breeds X \$45 =

_____ Total Stake Winners X \$35 =

_____ Total Flight Winners X \$25 =

_____ Total Kennel Stakes X \$25 =

_____ Total Breeder Stakes X \$25 =

_____ Total Bench Stakes X \$25 =

_____ Silver Class (\$10 - \$25) Amount _____

_____ Gold Class (\$25 - \$75) Amount _____

_____ Platinum Class (\$76 or more) Amount _____

_____ RV / Trailer - Total nights X \$25 =

_____ Tent - Total nights X \$10 =

_____ How many? X \$160 =

_____ T-Shirt(s) X \$15 =

_____ Long Sleeved T-Shirt(s) X \$20 =

_____ Ball Cap(s) X \$15 =

_____ How many? X \$6 =

COMMEMORATIVE LOGO PINS

(make check payable to 2013 II) TOTAL AMOUNT DUE \$ _____

Include this worksheet with your check payable to 2013 II
Submit with your entries to be received no later than March 27, 2013.

CATALOGUE

Separate Check

Mail check made to "2013 II", by March 27th with ad copy to Vicky Clarke (address in premium)