

EARLY ENTRIES CLOSE ON WEDNESDAY, May 1, 2013
at the Field Trial Secretary's address
DAY-OF-TRIAL ENTRIES CLOSE 30 MINUTES BEFORE ROLL CALL
at the Field Trial Secretary's table each day

2013 Grand Slam Schedule

What is a "Grand Slam" you ask?

The Region 8 Grand Slam is a competition for each breed on a specific weekend of trials in Region 8 designated by each club. Both days of our Regional Invitational will be the last event for this competition. Bowen Points will be awarded at each trial in the normal matter. The hound of each breed that has entered a minimum of 60% of these GRAND SLAM trials with the highest number of Bowen Points will be that breed's winner. Hounds do not have to reside in Region 8 to compete. The winning hound of each breed will receive a Grille Plate designating your hound as the winner plus a framed certificate so stating, to be presented at the Regional 8 trial.

The Region 8 Grand Slam Schedule for 2013

March 30-31 Jersey Rag Racers Whippet Assoc, Ft. Mott, NJ
April 20-21 Sight Hounds of Tidewater, VA
April 27-28 Upper Chesapeake Bay Saluki Club, Littlestown, PA
→ May 4-5 Coursing Hounds of Mid-Potomac, Virginia ←
May 25-26 Mason Dixon Ibizan Hound Club, Littlestown, PA
September 14-15 Tortoise & Hare Lure Coursers, Littlestown, PA
September 21-22 District Area Sight Hounds, WV
September 28-29 Lehigh Valley Coursing Club, NJ
October 5-6 Tri-State Sighthound Club, western PA

* Our Champ Cup May trials will count toward this Grand Slam.

COURSING HOUNDS ASSOCIATION OF THE MID-POTOMAC

ALL BREED ASFA SANCTIONED LURE FIELD TRIAL



SATURDAY, May 4, 2013
SUNDAY, May 5, 2013
Region 8

Oatlands Plantation
20850 Oatlands Plantation Lane
Leesburg, Virginia
CHAMP CUP EVENT

EARLY ENTRIES: \$20.00 for the FIRST HOUND
\$18.00 for the SECOND HOUND
\$15.00 for the THIRD HOUND
\$10 for EACH ADDITIONAL HOUND
ENTERED BY THE SAME OWNER OR
FAMILY MEMBER
\$5 EACH SET IN BREEDER & KENNEL STAKE

DAY OF TRIAL ENTRIES: \$25.00 PER HOUND

TRIAL Hours: 7:30 am until complete

ROLL CALL: 8:30 am ALL BREEDS
(CELL ON FIELD: 703-505-1479)

Permission has been granted by the American Sighthound Field Association
for the holding of this event under A.S.F.A. rules and regulations

DENISE COMO, CHAIRMAN - ASFA Scheduling Committee

**COURSING HOUNDS ASSOCIATION
OF THE MID-POTOMAC**

OFFICERS: President--Bheki Mealey; VP--Fred Lutz
Secretary--Bobbie Lutz; Treasurer--Sid Sher
DIRECTORS: Judy Brader & Jay Johnson; ASFA DELEGATE: Judy Brader

JUDGES AND ASSIGNMENTS:

Tom Cigolle, P.O. Box 327, Newell, WV
Holly Hamilton, 6756 Belkenton Ave., Cincinnati, OH
Gary Roush, P.O. Box 400, Lightfoot, VA

Saturday: 4 May '13

	A F	A Z	B A	B Z	C I	G H	I B	I G	I W	P H	R R	S A	S D	S L	S W	W H	L t d	S g l
TC	X	X	X							X						X		
HH				X		X					X							
GR					X		X	X	X			X	X	X	X		X	X

Sunday: 5 May '13

	A F	A Z	B A	B Z	C I	G H	I B	I G	I W	P H	R R	S A	S D	S L	S W	W H	L t d	S g l
TC				X	X	X	X	X	X		X		X	X	X		X	X
HH										X		X	X			X		
GR	X	X	X															

FIELD COMMITTEE:

Field Trial Chairman: Sid Sher: 8370 Jill Brenda Ct., Manassas, VA 20112;

Email: ssher@mac.com; phone: 703-475-2672

Field Trial Secretary: Bobbie Lutz; 157 Warm Springs Rd., Winchester, VA 22603; email: lutzsei@aol.com; phone: (540) 545-8851 home or (703) 505-1479 (cell & cell on field)

Field Clerks: Bobbie Lutz, Judy Brader, Kristen Fredericks, Wendy Gay

Lure Operators: Tom Cigolle, Wendy & Rodney Gay, Bob Marciszewski, Gary Roush, & Sid Sher

Huntmasters: Rodney Gay, Bob Marciszewski, Bheki Mealy, & Sid Sher

Inspection Committee: Judy Brader, Kristen Fredericks, Bheki Mealey

ENTRIES will not be acknowledged by mail. Separate, dated entry forms are required for each day.

ELIGIBLE BREEDS AND REGISTRY

Only purebred Afghan Hounds, Azawakhs, Basenjis, Borzois, Cirnechi dell'Etna, Greyhounds, Ibizan Hounds, Irish Wolfhounds, Italian Greyhounds, Pharaoh Hounds, Rhodesian Ridgebacks, Salukis, Scottish Deerhounds, Sloughis, Whippets and Provisional breeds, if any, may be entered in the regular stakes. Current Provisional breed: Silken Windhound. Limited breeds may be entered in the Limited Stake or the Singles Stake.

Limited stake breeds currently include: purebred Chart Polskis, Galgo Españols, Magyar Agars, Peruvian Inca Orchids, & Portuguese Podengos (Medio & Grande), and must be individually registered with the appropriate registry.

All entries shall be individually registered with the AKC, the NGA, the UKC, the FCI, an ASFA-recognized foreign or ASFA Board approved registry, or possess a CRN from the SPDBS. A photocopy of acceptable registry must be submitted with each hound's first ASFA field trial entry. This requirement is waived for hounds registered with the NGA

REGULAR STAKES OFFERED

OPEN STAKE: Any eligible Sighthound that has met certification requirements excluding ASFA Field Champions of record.

FIELD CHAMPION STAKE: Any ASFA Field Champion.

VETERAN STAKE: Any eligible Sighthound that has met certification requirements and is 6 years of age or older (5 years for Irish Wolfhounds; 7 years for Afghans, Rhodesian Ridgebacks, and Whippets).

SINGLES STAKE: Any eligible Sighthound including those disqualified to run in other stakes. Not eligible for Best of Breed or Best in Field. Hounds are eligible to earn TCP and CPX titles from the Singles stake. Limited breeds are not eligible for these titles.

Each hound runs alone.

LIMITEDSTAKE: Any eligible Sighthound of a Limited breed that has met certification requirements. Not eligible to compete in Best of Breed or Best in Field.

NON-REGULAR STAKES OFFERED

KENNEL STAKE: For hounds of any individual breeds; an entry shall consist of two hounds, designated at time of entry, in one of the regular stakes being owned and kenneled by the same person.

BREEDER STAKE: For any breed which shall have, designated at time of entry, two hounds bred by the same individual.

BEST IN FIELD WILL NOT BE OFFERED

BEST in EVENT will be offered

CONDITIONS OF ENTRY

- All entries must be one year or older on the day of the trial.
- Stakes will be split into flights by public random draw if the entry in any regular stake is 20 or more.
- Bitches in season, lame hounds and hounds with breed disqualifications will be excused at roll call.
- Exhibitors are requested not to bring bitches known to be in season to the field
- Spayed, neutered, monorchid or cryptorchid hounds without breed disqualifications may be entered.
- Hounds with breed disqualifications are not eligible to enter except in the Single Stake.
- Hounds not present at the time of roll call will be scratched.
- All hounds will run twice, in trios if possible or braces (except in the Single Stake), unless excused, dismissed or disqualified. The members of the Coursing Hounds Association of the Mid-Potomac reserve the right to alter the course plan as required by weather and/or field conditions on the day of the trial.

COURSE PLANS - Sat. - 745 yds.
Sun. - 705 yds

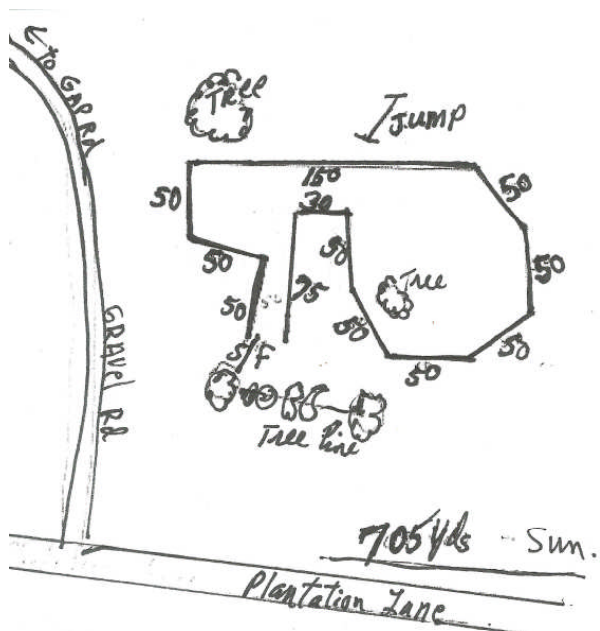
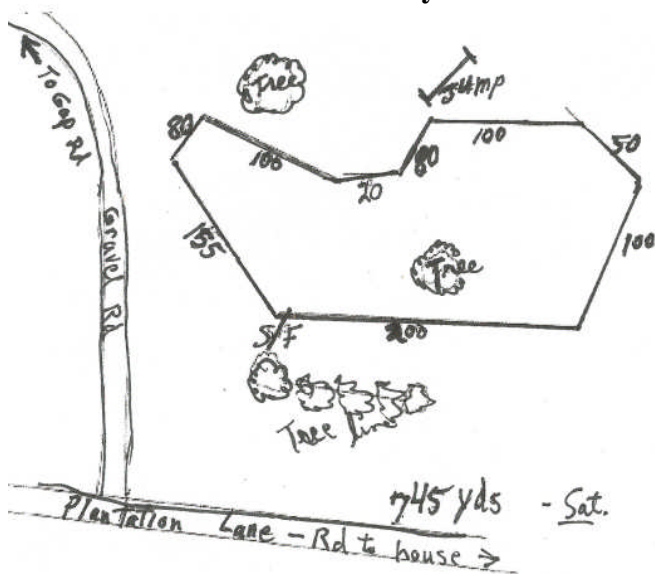

Course plan each day will be reversed for final run.
Equipment: lure machine is battery-powered continuous loop.
Lure type: highly-visible white plastic bags.

DIRECTIONS TO THE FIELD:

Directions from the North:

From Interstate 70 in Frederick, MD: take Route 340/15 South. Bear onto 15S at the split. Leesburg is 24 miles. Follow 15/7 Leesburg bypass to 15 South. Oatlands is 6 miles south of Leesburg on Rt. 15. Turn LEFT on to Gap Road and proceed to the field on the right. Gap Rd. is BEFORE Oatlands. Watch for coursing signs.

From Washington Beltway: take either Route 7 or Dulles Greenway west to Leesburg 15/7 bypass, then exit south on Route 15-South. Follow rest of directions above.

Directions from the South:

Follow Route 15 North toward Leesburg. Oatlands is on the right before Leesburg. Go past the main entrance of Oatlands and TURN RIGHT on the first road, Gap Road. This is a narrow dirt road. Follow coursing signs to the field.

FIELD:

The field is not fenced, but is well off the main road. Please bring your own shade and water.

Limited CAMPING on the Field is permitted w/prior notification to Trial Chair, Sid Sher; ssher@mac.com; phone: 703-475-2672

CERTIFICATIONS:

Certification will be offered on Saturday after completion of the trial if weather, equipment, daylight, and judges permit. The cost is \$10.00 per hound. Hound certification will NOT be offered on Sunday.

PRACTICE:

Practice will be offered on Saturday ONLY AFTER CERTIFICATIONS, weather, equipment, and time permitting. Cost is \$3.00 per hound .

DISCLAIMER: Upon entering this trial, the exhibitor agrees to hold harmless the CHAMP club, its members, and the event location organization for any injury, loss, or damage sustained by person or hound. There will be no refund in the event that the trial has to be canceled due to weather or other unforeseen circumstance.

Coursing Hounds Association of the Mid-Potomac

Presents



The CHAMP Cup Run 2013

In honor of Pete Smith

The CHAMP Cup Run will be held on Sunday

Hounds winning Best of Breed on Saturday and/or Sunday, hounds winning 1st place in Limited Entry Stakes on Saturday and/or Sunday, and previous CHAMP Cup winners are eligible to compete for the CHAMP Cup. **Dogs do not have to run both days to be eligible.**

Pls. note Breeder & Kennel stake are offered this trial. Be sure to checkmark entry if entering & include fee. Also include the special form in this premium.

RIBBONS & TROPHIES:

First – Blue; Second – Red; Third – Yellow; Fourth – White;
NBQ – Green

High Score Single – Navy & Gold

Breeder & Kennel Stakes – Light Green

Best of Breed – Purple and Gold

Best in Event – Red, White and Blue

There will be a \$5.00 fine assessed for any loose hound not taking part in a course in progress.

MOTEL ACCOMMODATIONS:

Days Inn, 721 East Market Street, Leesburg, VA 703/777-6622,
Best Western, 721 E. Market St. Leesburg, VA , 703/777-9400
Holiday Inn, 1500 E. Market St., Leesburg, VA, 703/771-9200
Holiday Inn at Dulles, 1000 Sully Rd., Sterling, VA 703/471-7411—
12 miles from Leesburg

VETERINARIANS: TLC Emergency Clinic, 165 Ft. Evans Rd. NE, Leesburg, VA 20175; 703-777-5755. (Rt 15 bypass to Rt.7 Bus.; R. on Ft. Evans to end) **or**

Blue Ridge Veterinary Assoc.: 120 E. Cornwell Ln., Purellville, VA; 540-338-7387 (From the Rt. 7-15 bypass (& W. Market St.), go west on Rt. 7 for **6.5 miles**. Take the Purcellville exit (Rt. 287) toward Purcellville and Business 7. Take immediate right onto Hirst Rd. Go approx. 1 mile & take a left onto Hatcher Ave. Take the next right onto E. Skyline Dr. to the clinic.)

ASFA Notes

For latest Rulebook, Policies, Contacts, Clubs, Trial Schedules, Trial Results and more, go online to:

www.asfa.org

Visit our website at: www.champlurecoursing2.org

**OFFICIAL AMERICAN SIGHTHOUND FIELD ASSOCIATION
ENTRY FORM**

**COURSING HOUNDS ASSOCIATION OF THE MID-POTOMAC
Saturday, May 4, 2013**

Field Trial Secretary: Bobbie Lutz, 157 Warm Springs Road, Winchester, VA 22603
 Early entries close Wednesday, **May 1, 2013**. --- Day of trial entries close 8:15 AM
Early Entry Fees: \$20 first hound, \$18.00 for 2nd, \$15.00 for 3rd & \$10 each additional hound
\$5 each set of Kennel and/or Breeder Stake
Day of Trial Entry Fee: \$25.00 per hound
 Make checks payable to CHAMP
 Fee Paid _____ The Field Secretary cannot accept conditional, unsigned, incomplete or unpaid entries; please check your completed entry carefully.

Breed:		Call Name:	
Registered Name of Hound:			
Stake: <input type="checkbox"/> Open <input type="checkbox"/> FCH <input type="checkbox"/> Veteran <input type="checkbox"/> Single <input type="checkbox"/> Limited		Additional Stakes: <input type="checkbox"/> Kennel <input type="checkbox"/> Breeder <input type="checkbox"/> Bench	
Registration Number: (please write in registering body before number)			
<input type="checkbox"/> If possible, please separate my hounds	Date of Birth:	Sex: <input type="checkbox"/> Dog <input type="checkbox"/> Bitch	
Name of actual owner(s):			
Address:		Phone:	
City:		State:	Zip:
E-mail (Optional)		(Optional) Region of Residence:	
<input type="checkbox"/> Check if this is the first ASFA trial for this hound. Attach a Hound Certification or waiver if entered in Open, Veterans, Limited. <input type="checkbox"/> Check if this is a first-time entry, a copy of the official Registration of this hound must accompany this entry unless NGA.			
<input type="checkbox"/> Check if any information has changed since the last ASFA trial entry. Regarding _____			
<input type="checkbox"/> Check if this hound has been dismissed within the last 6 trials entered. Must be marked in order to qualify for a "clean" trial requirement.			

I CERTIFY that I am the actual owner of this dog, or that I am the duly authorized agent of the actual owner whose name I have entered above. In consideration of the acceptance of this entry and the opportunity to have this dog judged and to win prize money, ribbons, or trophies, I (we) agree to abide by the rules and regulations of the American Sighthound Field Association in effect at the time of this lure field trial, and by any additional rules and regulations appearing in the premium list for this lure field trial. I (we) agree that the club holding this lure field trial has the right to refuse this entry for cause, which the club shall deem to be sufficient. I (we) agree to hold this club, its members, directors, governors, officers, agents or other functionaries, any employees of the aforementioned parties and the owner(s) of the trial premises or grounds harmless from any claim for loss or injury which may be alleged to have been caused directly or indirectly to any person or thing by the act of this dog while in or upon the lure field trial premises or grounds or near any entrance thereto and I (we) personally assume all responsibility and liability for any such claim, and I (we) further agree to hold the aforementioned parties harmless from any claim loss of this dog by disappearance, theft damage or injury be caused or alleged to be caused by the negligence of the club or any of the aforementioned parties or by the negligence of any person or any other cause or causes. I (we) certify and represent that the dog entered is not a hazard to person or other dogs. This entry is submitted for acceptance of the forgoing representations and agreements

SIGNATURE of owner or his agent
 duly authorized to make this entry _____
 EF-A ~ rev 07-12©

**OFFICIAL AMERICAN SIGHTHOUND FIELD ASSOCIATION
ENTRY FORM**

**COURSING HOUNDS ASSOCIATION OF THE MID-POTOMAC
Sunday, May 5, 2013**

Field Trial Secretary: Bobbie Lutz, 157 Warm Springs Road, Winchester, VA 22603
 Early entries close Wednesday, **May 1, 2013**. ---- Day of trial entries close 8:15 AM
Early Entry Fees: \$20 first hound, \$18.00 for 2nd, \$15.00 for 3rd & \$10 each additional hound
\$5 each set of Kennel and/or Breeder Stake
Day of Trial Entry Fee: \$25.00 per hound
 Make checks payable to CHAMP
 Fee Paid _____ The Field Secretary cannot accept conditional, unsigned, incomplete or unpaid entries; please check your completed entry carefully.

Breed:		Call Name:	
Registered Name of Hound:			
Stake: <input type="checkbox"/> Open <input type="checkbox"/> FCH <input type="checkbox"/> Veteran <input type="checkbox"/> Single <input type="checkbox"/> Limited		Additional Stakes: <input type="checkbox"/> Kennel <input type="checkbox"/> Breeder <input type="checkbox"/> Bench	
Registration Number: (please write in registering body before number)			
<input type="checkbox"/> If possible, please separate my hounds	Date of Birth:	Sex: <input type="checkbox"/> Dog <input type="checkbox"/> Bitch	
Name of actual owner(s):			
Address:		Phone:	
City:		State:	Zip:
E-mail (Optional)		(Optional) Region of Residence:	
<input type="checkbox"/> Check if this is the first ASFA trial for this hound. Attach a Hound Certification or waiver if entered in Open, Veterans, Limited. <input type="checkbox"/> Check if this is a first-time entry, a copy of the official Registration of this hound must accompany this entry unless NGA.			
<input type="checkbox"/> Check if any information has changed since the last ASFA trial entry. Regarding _____			
<input type="checkbox"/> Check if this hound has been dismissed within the last 6 trials entered. Must be marked in order to qualify for a "clean" trial requirement.			

I CERTIFY that I am the actual owner of this dog, or that I am the duly authorized agent of the actual owner whose name I have entered above. In consideration of the acceptance of this entry and the opportunity to have this dog judged and to win prize money, ribbons, or trophies, I (we) agree to abide by the rules and regulations of the American Sighthound Field Association in effect at the time of this lure field trial, and by any additional rules and regulations appearing in the premium list for this lure field trial. I (we) agree that the club holding this lure field trial has the right to refuse this entry for cause, which the club shall deem to be sufficient. I (we) agree to hold this club, its members, directors, governors, officers, agents or other functionaries, any employees of the aforementioned parties and the owner(s) of the trial premises or grounds harmless from any claim for loss or injury which may be alleged to have been caused directly or indirectly to any person or thing by the act of this dog while in or upon the lure field trial premises or grounds or near any entrance thereto and I (we) personally assume all responsibility and liability for any such claim, and I (we) further agree to hold the aforementioned parties harmless from any claim loss of this dog by disappearance, theft damage or injury be caused or alleged to be caused by the negligence of the club or any of the aforementioned parties or by the negligence of any person or any other cause or causes. I (we) certify and represent that the dog entered is not a hazard to person or other dogs. This entry is submitted for acceptance of the forgoing representations and agreements

SIGNATURE of owner or his agent
 duly authorized to make this entry _____
 EF-A ~ rev 07-12©

**AMERICAN SIGHTHOUND FIELD ASSOCIATION
HOUND CERTIFICATION**

Rule effective October 1, 1994: Ch. V, Sec. 4 (a) OPEN STAKE: *To be eligible to enter the open stake, a hound must have been certified by a licensed judge within the year preceding the closing date for the entry or have previously competed in the Open Stake.* This eligibility requirement also applies to a hound entered in the Limited or Veteran Stake, which has not competed in Open previously. Please complete this portion of this form and attach it to the entry form for the hound's first entry, including an entry for a Fun Trial.

Registered Name of Hound: _____

Registration Number: _____ Breed: _____

Registered Owner's Name: _____

I hereby certify that on (date) _____, the above named hound completed a lure course of at least 500 yards, running with another hound of the same breed (or another breed with a similar running style). During the course the above named hound showed no inclination to interfere with the other hound. I further certify that I am a licensed judge for the ASFA.

Name of Licensed Judge: _____

Signature: _____ Date: _____

I hereby certify that the hound running in the certification course is the hound identified above and that information provided on this form is true and correct.

Signature: _____ Date: _____

Owner or Authorized Agent of Hound

This certification form must be attached to the entry form the first time this hound is entered in an open, limited, or veteran stake. Any hound entered in open, limited, or veteran (as a first time entered hound), which has not been certified, shall be declared ineligible by the records coordinator and shall forfeit any points and placements awarded.

PLEASE RETAIN A COPY FOR YOUR RECORDS.

**AMERICAN SIGHTHOUND FIELD ASSOCIATION
HOUND CERTIFICATION WAIVER**

Waiver of Requirement: *This requirement will be waived for a hound that has earned a lure coursing or racing title from another recognized organization, if such title requires competition, and if a waiver for such title has been approved by the ASFA, or a CKC Hound Certification Form.* If your hound qualifies for a waiver, complete this portion of this form and attach it to your entry form. Proof of waivers must accompany this certification form.

Registered Name of Hound: _____

Registration Number: _____ Breed: _____

Registered Owner's Name: _____

CKC: FCH FCHX **CWA:** ARX TRP SRA DPC

AKC: QC SC FC **LGRA:** GRC **NAWRA:** RCH SR

WRA: CR WRCH **NOTRA:** ORC OTR SORC SOR

Hound Certification previously submitted.

I hereby certify that the hound identified above has completed the requirements for the title indicated above (or that the required Certification was previously submitted) and that the information provided on this form is true and correct.

Signature: _____ Date: _____

Owner or Authorized Agent of Hound

**AMERICAN SIGHTHOUND FIELD ASSOCIATION
HOUND CERTIFICATION**

Rule effective October 1, 1994: Ch. V, Sec. 4 (a) OPEN STAKE: *To be eligible to enter the open stake, a hound must have been certified by a licensed judge within the year preceding the closing date for the entry or have previously competed in the Open Stake.* This eligibility requirement also applies to a hound entered in the Limited or Veteran Stake, which has not competed in Open previously. Please complete this portion of this form and attach it to the entry form for the hound's first entry, including an entry for a Fun Trial.

Registered Name of Hound: _____

Registration Number: _____ Breed: _____

Registered Owner's Name: _____

I hereby certify that on (date) _____, the above named hound completed a lure course of at least 500 yards, running with another hound of the same breed (or another breed with a similar running style). During the course the above named hound showed no inclination to interfere with the other hound. I further certify that I am a licensed judge for the ASFA.

Name of Licensed Judge: _____

Signature: _____ Date: _____

I hereby certify that the hound running in the certification course is the hound identified above and that information provided on this form is true and correct.

Signature: _____ Date: _____

Owner or Authorized Agent of Hound

This certification form must be attached to the entry form the first time this hound is entered in an open, limited, or veteran stake. Any hound entered in open, limited, or veteran (as a first time entered hound), which has not been certified, shall be declared ineligible by the records coordinator and shall forfeit any points and placements awarded.

PLEASE RETAIN A COPY FOR YOUR RECORDS.

**AMERICAN SIGHTHOUND FIELD ASSOCIATION
HOUND CERTIFICATION WAIVER**

Waiver of Requirement: *This requirement will be waived for a hound that has earned a lure coursing or racing title from another recognized organization, if such title requires competition, and if a waiver for such title has been approved by the ASFA, or a CKC Hound Certification Form.* If your hound qualifies for a waiver, complete this portion of this form and attach it to your entry form. Proof of waivers must accompany this certification form.

Registered Name of Hound: _____

Registration Number: _____ Breed: _____

Registered Owner's Name: _____

CKC: FCH FCHX **CWA:** ARX TRP SRA DPC

AKC: QC SC FC **LGRA:** GRC **NAWRA:** RCH SR

WRA: CR WRCH **NOTRA:** ORC OTR SORC SOR

Hound Certification previously submitted.

I hereby certify that the hound identified above has completed the requirements for the title indicated above (or that the required Certification was previously submitted) and that the information provided on this form is true and correct.

Signature: _____ Date: _____

Owner or Authorized Agent of Hound

Kennel & Breeder Stakes Entry

One Form per Pair of Hounds per Stake

Check one or both: Kennel Stake Breeder Stake

Breed: _____

Breeder(s): _____

Hound # 1

Call Name: _____

Registered Name: _____

Owner(s): _____

Hound # 2

Call Name: _____

Registered Name: _____

Owner(s): _____

Please include \$5.00 per pair of hound for EACH non-regular stake entry. Must accompany entries

Kennel & Breeder Stakes Entry

One Form per Pair of Hounds per Stake

Check one or both: Kennel Stake Breeder Stake

Breed: _____

Breeder(s): _____

Hound # 1

Call Name: _____

Registered Name: _____

Owner(s): _____

Hound # 2

Call Name: _____

Registered Name: _____

Owner(s): _____

Please include \$5.00 per pair of hound for EACH non-regular stake entry. Must accompany entries