

COLORADO LURE COURSING ASSOCIATION

Darci Kunard
17531 E. 104th Place
Reunion, CO 80022
kdarci@yahoo.com
720-938-3303

www.clcaonline.com

www.asfa.org

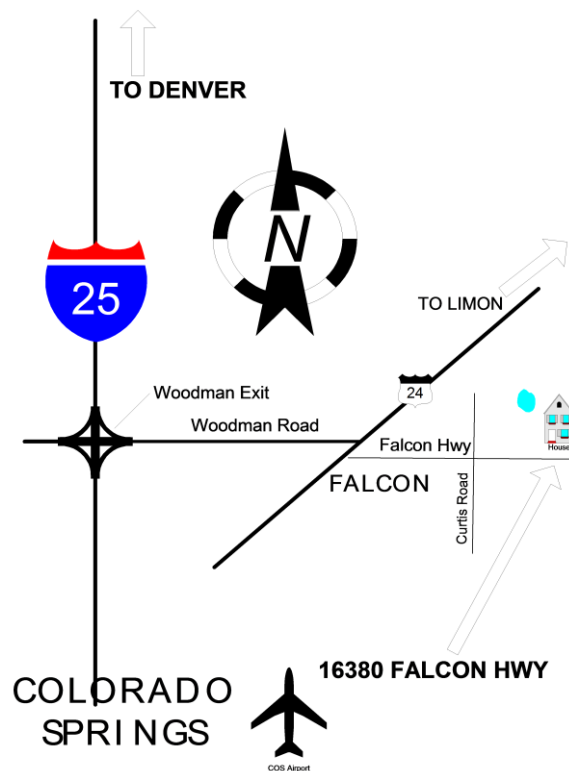

From I-25 North or South: Take Woodmen Road Exit and travel east to Highway 24. Turn Right on Highway 24 and then turn Left on Meridian. Go to stop sign and then Turn Left on Falcon Highway. Turn Left in drive way at 16380 Falcon Highway.

PREMIUM LIST

EARLY ENTRIES close on Wednesday, July 12, 2017 at 6:00pm at the FTS's address.

DAY OF TRIAL ENTRIES close at 7:00am the day of the trial at the FTS desk.

(Substitutions for lame hounds or bitches in season will be allowed prior to 7:30 A.M. on the day of the trial. Owner of the substituted hound must be the Same as the hound already entered.)

REGION 3

ASFA SANCTIONED

ALL BREED LURE FIELD TRIAL

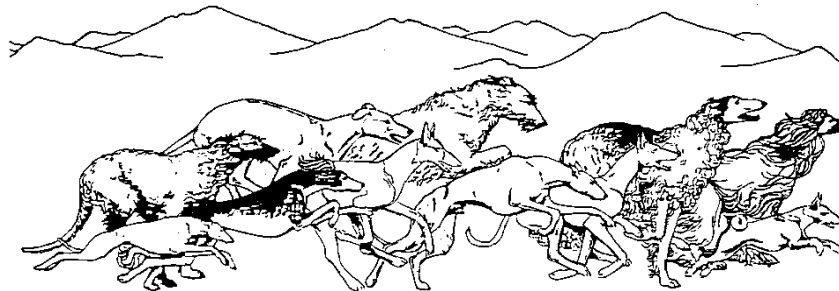

COLORADO LURE COURSING ASSOCIATION

Friday, JULY 14, 2017
SATURDAY JULY 15, 2017
SUNDAY JULY 16, 2017

FALCON INSTITUTE FOR ADVANCED COURSING STUDIES
16380 FALCON HIGHWAY
PEYTON, COLORADO 80831-7993

ENTRY FEES: \$17.00 for 1st ; \$14.00 for 2nd and \$12.00 each additional hound with same owner. Payable in US Funds
Day of trial entry: \$25.00

Permission has been granted by the American Sighthound Field Association for the holding of this event under American Sighthound Field Association Rules and Regulations

Audrey Silverstein, Chairman
ASFA Scheduling Committee

COLORADO LURE COURSING ASSOCIATION

OFFICERS AND DIRECTORS

President Mike Hussey
Vice President Connie Sullivan
Recording Secretary Steven Seay
Corresponding Secretary Dan Heidel
Treasurer Deann Britton
Directors-at-Large: Frank Cassano
Tom Golcher
Melissa Pearce
Cathy Day
Peter Lowe
Linda Pocurull

JUDGES (AND THEIR ASSIGNMENTS)

Frank Cassano, LaSalle, CO

(*) Dan Heidel, Lakewood, CO

Mike Hussey, Elizabeth, CO

Pete Lowe, Falcon, CO

Claudia Miller, Arvada, CO

S = Single Judge * = Provisional Judge # = Canadian Judge

FRIDAY

JUDGE	A	Az	Ba	B	C	G	Ib	Iw	IG	P	R	S	SD	SI	SW	W	Sgl	Ltd
Frank	X	X	X	X	X	X	X	X	X	X	X	X	X	X	X	X	X	X
Claudia	X	X	X	X	X	X	X	X	X	X	X	X	X	X	X	X	X	X

SATURDAY

JUDGE	A	Az	Ba	B	C	G	Ib	Iw	IG	P	R	S	SD	SI	SW	W	Sgl	Ltd
Dan	X		*	X		*		*				*				X	S	
Mike		X			X		X		X	X	X	X	X	X	X			X
Pete	X	X	X	X	X	X	X	X	X	X	X		X	X	X	X		X

SUNDAY

JUDGE	A	Az	Ba	B	C	G	Ib	Iw	IG	P	R	S	SD	SI	SW	W	Sgl	Ltd
Frank	X	X	X	X	X	X	X	X	X	X	X					X	X	X
Mike	X	X	X	X	X	X	X	X				S	X	X	X	X	X	X
Pete									X	X	X		X	X	X			

FIELD COMMITTEE
Field Chairmen Mike Hussey
(303) 646-4081
Field Secretaries Darci Kunard, kdarci@yahoo.com
17531 E. 10th Place, Reunion, CO 80022
720-938-3303
Lure Operators M Hussey, R Buhrdorf, D Heidel, C Sullivan

Ribbons or rosettes will offered for all placements.

First=Blue, Second=Red, Third=Yellow, Fourth=White, NBQ=Green

Highest Scoring Single=Navy/Gold, Best of Breed=Purple/Gold

BEST IN FIELD = Red, White & Blue Rosette

ELIGIBLE BREEDS & REGISTRY

Only purebred Afghan Hounds, Azawakhs, Basenjis, Borzoi, Cirneco dell'Etna, Greyhounds, Ibizan Hounds, Irish Wolfhounds, Italian Greyhounds, Pharaoh Hounds, Rhodesian Ridgebacks, Salukis, Scottish Deerhounds, Silken Windhound, Sloughis, and Whippets. Limited breeds may be entered in the Limited Stake or the Singles Stake. Limited breeds currently include purebred Chart Polski, Galgo Español, Magyar Agar, Peruvian Inca Orchid, Portuguese Podengo (Pequeno), Portuguese Podengo (Medio & Grande), and must be individually registered with the appropriate registry. All entries shall be individually registered with the AKC (including ILP & PAL), the NGA, the UKC, the FCI, an ASFA-recognized foreign or ASFA Board approved registry, or possess a CRN from the SPDBS. A photocopy of acceptable registry must be submitted with each hound's first ASFA field trial entry; this requirement is waived for hounds registered with the NGA.

TRIAL HOURS: 7:00 a.m. until ribbons are awarded. Day of Trial Entries Close: 7:00am

ROLL CALL PROMPTLY AT 7:30 A.M.

Any hound not present at Roll Call will be scratched and entry fee will not be refunded.

ENTRIES WILL NOT BE ACKNOWLEDGED BY MAIL OR TELEPHONE. LATE, INCOMPLETE, UNSIGNED OR CONDITIONAL ENTRIES WILL NOT BE ACCEPTED.

REGULAR STAKES OFFERED:

OPEN - Any eligible sighthound, excluding ASFA Field Champions of record that has met ASFA Certification requirements.

FIELD CHAMPION - Any ASFA Field Champion

VETERAN - Any eligible sighthound which is 6 years or older on the day of the trial, except Irish Wolfhounds whose age shall be at least 5 years; and Afghans, Rhodesian Ridgebacks, Salukis and Whippets whose age shall be at least 7 years of age and has met ASFA certification requirements. Points go toward V-FCh and V-LCM titles.

SINGLE STAKE: Any eligible sighthound including those disqualified to run in other stakes. Each hound runs alone. Not eligible for Best of Breed or Best in Field. Hounds are eligible to earn TCP and CPX titles from the Singles stake. Limited breeds are not eligible for these titles.

LIMITED - Any eligible sighthound of an eligible Limited stake that has met certification requirements. Not eligible for Best of Breed or Best in field.

BEST IN FIELD OFFERED Friday & Saturday ONLY

GENERAL INFORMATION

Conditions of Entry: All entries must be one year or older on the day of the trial. Stakes will be split into flights by public random draw if the entry in any regular stake is 20 or more. Bitches in season, lame hounds and hounds with breed disqualifications will be excused at roll call. Spayed, neutered, monorchid or cryptorchid hounds without breed disqualifications may be entered; hounds with breed disqualifications are not eligible to enter except in the Single Stake. Hounds not present at the time of roll call will be scratched. All hounds will run twice, in trios if possible or braces (except in the Single Stake), unless excused, dismissed or disqualified.

EQUIPMENT: Type of lure machine: battery-powered continuous-loop system. Back-up equipment will be available. Type of lures: highly-visible plastic strips.

A \$20.00 fee will be assessed for any returned checks. Persons exhibiting conduct detrimental to ASFA/CLCA/ any hound(s)/other person(s) will be asked to leave the trial site.

There will be a \$5.00 fine for any owner who does not clean up after his/her hound.

A penalty of \$5.00 will be assessed for any loose hound not competing in the course in progress.

INFORMATION/POLICIES

- Port-a-pottis on site.
- BRING WATER AND SHADE FOR YOUR HOUNDS.
- Veterinarian – Friday and Saturday – Black Forest Veterinary Clinic 719-495-3666. Sunday Animal Emergency Care, 5752 North Academy Blvd., (behind Petco) 719-260-7141.
- Due to dry conditions, smoking of any kind is prohibited on the field, Absolutely NO CAMP FIRES!
- PICK UP AFTER YOUR DOG AND YOURSELF!
- For further information contact either: Deann Britton, 303-249-2844 or Daphane Lowe, 719-351-8862

ENTRIES THAT ARE EMAILED MUST BE ACCOMPANIED BY PAYMENT THRU OUR PayPal account at: deann.clcatreasurer@gmail.com . Please add \$1.00 per entry. If the original entries along with payment are not received the emailed entries will NOT constitute a valid entry.

COURSE PLANS:

Colorado Lure Coursing Association reserves the right to alter the course design(s) depending on field and/or weather conditions on the day of the trial.

Friday 7/14/2017

770 yards, clock wise for prelims and reversed for finals

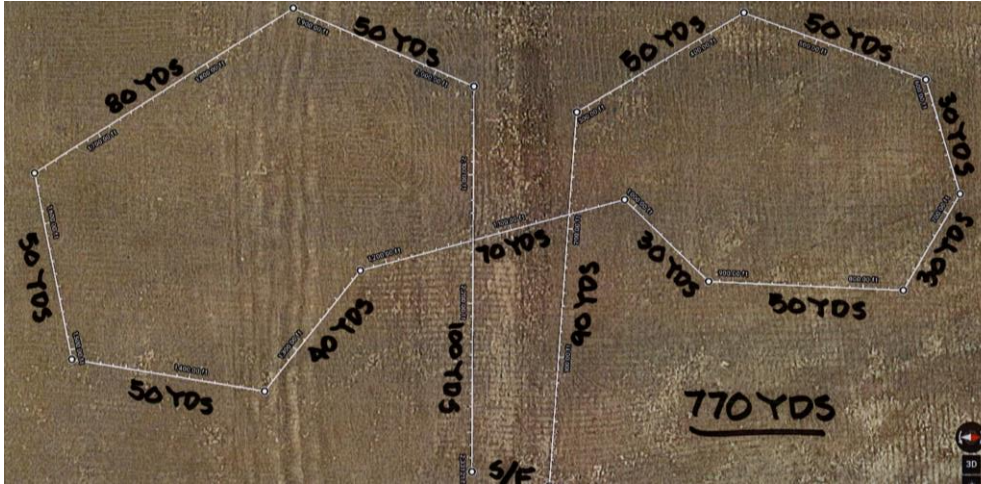

Saturday 7/15/2017

760 yards, clock wise for prelims and reversed for finals



Sunday 7/16/2017

770 yards, clock wise for prelims and reversed for finals

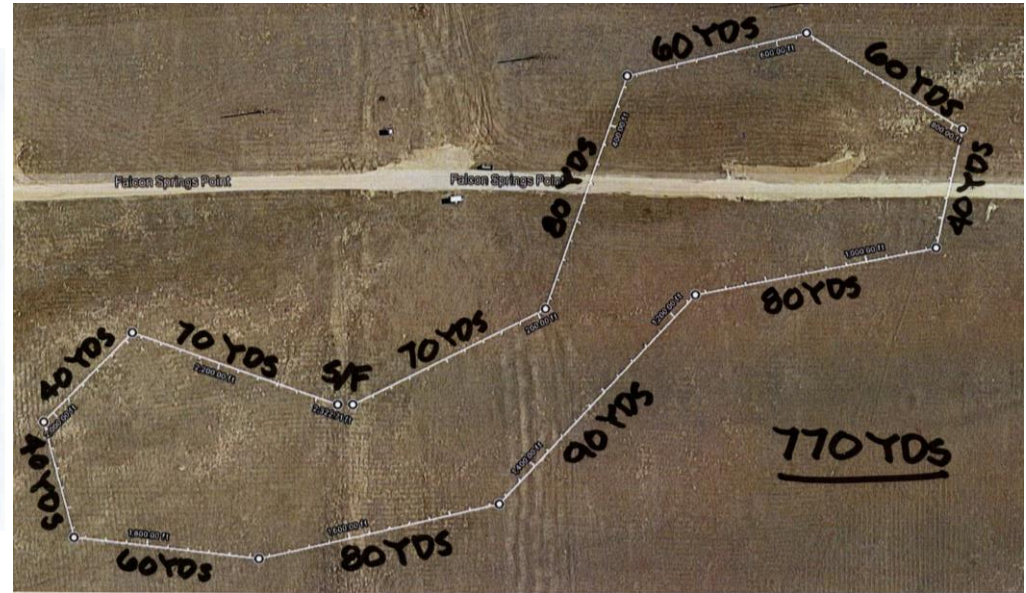

Warning: It is advised that all hounds entered be in top physical condition due to the altitude and rigorous conditions of the course, which will be run on natural terrain and may include such hazards as rocks, trees, cactus, vegetation, gopher holes, gullies, bodies of water and other obstacles. ALL HOUNDS RUN AT THE OWNER'S SOLE RISK.

Friday & Saturday July 14 & 15 2017

Certifications and practices will be held AFTER the CLCA trial on Saturday, WEATHER AND MACHINERY PERMITTING

All hounds will be inspected before running.
Lame hounds and bitches in season may NOT run.

Certification: Any entry marked “First ASFA Point Trial” Must have an ASFA Hound Certification form and a copy of the hound’s registration papers, not required for NGA greyhounds, and must present them to the Field Trial Secretary along with your entry before entering a regular ASFA trial. This applies to “First ASFA point trial” hounds entered in the OPEN, VETERAN or LIMITED stake. Certification forms will be available, but MUST be completed prior to judging. Also have your hound’s registration number available for the Certification Form.

Certification: \$7.00, Owners wishing to certify a hound for competition are responsible for arranging a hound of the same breed, or similar running style, to run with his/her dog for the certification.

Practices: \$5.00 each dog

Plan on arriving to the field around 11:00am; arrive earlier if you wish to see the competition. Practices and Certs will not be run earlier than 11:00am, but may be held much later depending upon the entry in the trial.

Surfing the WEB? Check out the following websites:

www.clcaonline.com

and

www.asfa.org

Breakfast items will be available for a small donation

Motels

The following will accept well behaved dogs, and are in the Colorado Springs area:

(Please verify with the hotel for current pet policies.)

Ramada Inn, I-25 & Hwy 24, Exit 145 – 719-633-5541

Howard Johnson, 8280 Hwy 83, Exit 150 – 719-598-6700

Super 8 Colorado Springs, 719-597-4100

Days Inn Colorado Springs, 719-266-1317

Motel 6, 3228 N. Chestnut – 719-520-5400

Falcon Meadow Campgrounds, 11150 Hwy 24, Falcon – 719-495-2694

(Falcon is 5 miles west of the trial site)

OFFICIAL AMERICAN SIGHTHOUND FIELD ASSOCIATION ENTRY FORM
COLORADO LURE COURSING ASSOCIATION

FRIDAY JULY 14, 2017

FALCON INSTITUTE FOR ADVANCED COURSING STUDIES, FALCON, COLORADO
EARLY ENTRIES: 17.00 1ST hound, \$14.00 2ND and \$12.00 each additional hound entered by same owner.
Wednesday JULY 12, 2017 at 6:00 P.M.

Day of trial entries close at 7:00 A.M. at the FTS desk, the day of the trial, \$25.00 per hound.

Payable in US funds. Make checks payable to CLCA and mail with completed entry form to:
Darci Kunard, 17531 E. 104th Place, Reunion, CO 80022

Fee Paid _____ The Field Secretary cannot accept conditional, unsigned, incomplete or unpaid entries; please check your completed entry carefully.

Breed:	Call Name:		
Registered Name of Hound:			
Stake: <input type="checkbox"/> Open <input type="checkbox"/> FCH <input type="checkbox"/> Veteran <input type="checkbox"/> Single <input type="checkbox"/> Limited		Additional Stakes <input type="checkbox"/> Kennel <input type="checkbox"/> Breeder <input type="checkbox"/> Bench	
Registration Number: (please write in registering body before number)			
<input type="checkbox"/> If possible, please separate my hounds	Date of Birth:	Sex: <input type="checkbox"/> Dog <input type="checkbox"/> Bitch	
Name of actual owner(s):			
Address:		Phone:	
City:	State:	Zip:	
E-mail (Optional)		(Optional) Region of Residence:	
Emergency Contact Name and Phone (Optional)			
<input type="checkbox"/> Check if this is the first ASFA trial for this hound. Attach a Hound Certification or waiver if entered in Open, Veterans, Limited.			
<input type="checkbox"/> Check if this is a first-time entry, a copy of the official Registration of this hound must accompany this entry unless NGA.			
<input type="checkbox"/> Check if any information has changed since the last ASFA trial entry. Regarding _____			
<input type="checkbox"/> Check if this hound has been dismissed within the last 6 trials entered. Must be marked in order to qualify for a "clean" trial requirement.			

I CERTIFY that I am the actual owner of this dog, or that I am the duly authorized agent of the actual owner whose name I have entered above. In consideration of the acceptance of this entry and the opportunity to have this dog judged and to win prize money, ribbons, or trophies, I (we) agree to abide by the rules and regulations of the American Sighthound Field Association in effect at the time of this lure field trial, and by any additional rules and regulations appearing in the premium list for this lure field trial. I (we) agree that the club holding this lure field trial has the right to refuse this entry for cause, which the club shall deem to be sufficient. I (we) agree to hold this club, its members, directors, governors, officers, agents or other functionaries, any employees of the aforementioned parties and the owner(s) of the trial premises or grounds harmless from any claim for loss or injury which may be alleged to have been caused directly or indirectly to any person or thing by the act of this dog while in or upon the lure field trial premises or grounds or near any entrance thereto and I (we) personally assume all responsibility and liability for any such claim, and I (we) further agree to hold the aforementioned parties harmless from any claim loss of this dog by disappearance, theft damage or injury be caused or alleged to be caused by the negligence of the club or any of the aforementioned parties or by the negligence of any person or any other cause or causes. I (we) certify and represent that the dog entered is not a hazard to person or other dogs. This entry is submitted for acceptance of the forgoing representations and agreements.

SIGNATURE of owner or his agent
duly authorized to make this entry _____

Please separate the entries before submitting to FTS.

OFFICIAL AMERICAN SIGHTHOUND FIELD ASSOCIATION ENTRY FORM
COLORADO LURE COURSING ASSOCIATION

FRIDAY JULY 14, 2017

FALCON INSTITUTE FOR ADVANCED COURSING STUDIES, FALCON, COLORADO
EARLY ENTRIES: 17.00 1ST hound, \$14.00 2ND and \$12.00 each additional hound entered by same owner.
Wednesday JULY 12, 2017 at 6:00 P.M.

Day of trial entries close at 7:00 A.M. at the FTS desk, the day of the trial, \$25.00 per hound.

Payable in US funds. Make checks payable to CLCA and mail with completed entry form to:
Darci Kunard, 17531 E. 104th Place, Reunion, CO 80022

Fee Paid _____ The Field Secretary cannot accept conditional, unsigned, incomplete or unpaid entries; please check your completed entry carefully.

Breed:	Call Name:		
Registered Name of Hound:			
Stake: <input type="checkbox"/> Open <input type="checkbox"/> FCH <input type="checkbox"/> Veteran <input type="checkbox"/> Single <input type="checkbox"/> Limited		Additional Stakes <input type="checkbox"/> Kennel <input type="checkbox"/> Breeder <input type="checkbox"/> Bench	
Registration Number: (please write in registering body before number)			
<input type="checkbox"/> If possible, please separate my hounds	Date of Birth:	Sex: <input type="checkbox"/> Dog <input type="checkbox"/> Bitch	
Name of actual owner(s):			
Address:		Phone:	
City:	State:	Zip:	
E-mail (Optional)		(Optional) Region of Residence:	
Emergency Contact Name and Phone (Optional)			
<input type="checkbox"/> Check if this is the first ASFA trial for this hound. Attach a Hound Certification or waiver if entered in Open, Veterans, Limited.			
<input type="checkbox"/> Check if this is a first-time entry, a copy of the official Registration of this hound must accompany this entry unless NGA.			
<input type="checkbox"/> Check if any information has changed since the last ASFA trial entry. Regarding _____			
<input type="checkbox"/> Check if this hound has been dismissed within the last 6 trials entered. Must be marked in order to qualify for a "clean" trial requirement.			

I CERTIFY that I am the actual owner of this dog, or that I am the duly authorized agent of the actual owner whose name I have entered above. In consideration of the acceptance of this entry and the opportunity to have this dog judged and to win prize money, ribbons, or trophies, I (we) agree to abide by the rules and regulations of the American Sighthound Field Association in effect at the time of this lure field trial, and by any additional rules and regulations appearing in the premium list for this lure field trial. I (we) agree that the club holding this lure field trial has the right to refuse this entry for cause, which the club shall deem to be sufficient. I (we) agree to hold this club, its members, directors, governors, officers, agents or other functionaries, any employees of the aforementioned parties and the owner(s) of the trial premises or grounds harmless from any claim for loss or injury which may be alleged to have been caused directly or indirectly to any person or thing by the act of this dog while in or upon the lure field trial premises or grounds or near any entrance thereto and I (we) personally assume all responsibility and liability for any such claim, and I (we) further agree to hold the aforementioned parties harmless from any claim loss of this dog by disappearance, theft damage or injury be caused or alleged to be caused by the negligence of the club or any of the aforementioned parties or by the negligence of any person or any other cause or causes. I (we) certify and represent that the dog entered is not a hazard to person or other dogs. This entry is submitted for acceptance of the forgoing representations and agreements.

SIGNATURE of owner or his agent
duly authorized to make this entry _____

Please separate the entries before submitting to FTS.

OFFICIAL AMERICAN SIGHTHOUND FIELD ASSOCIATION ENTRY FORM
COLORADO LURE COURSING ASSOCIATION

SATURDAY JULY 15, 2017

FALCON INSTITUTE FOR ADVANCED COURSING STUDIES, FALCON, COLORADO
EARLY ENTRIES: 17.00 1ST hound, \$14.00 2ND and \$12.00 each additional hound entered by same owner.
Wednesday JULY 12, 2017 at 6:00 P.M.

Day of trial entries close at 7:00 A.M. at the FTS desk, the day of the trial, \$25.00 per hound.

Payable in US funds. Make checks payable to CLCA and mail with completed entry form to:

Darci Kunard, 17531 E. 104th Place, Reunion, CO 80022

Fee Paid _____ The Field Secretary cannot accept conditional, unsigned, incomplete or unpaid entries; please check your completed entry carefully.

Breed:	Call Name:		
Registered Name of Hound:			
Stake: <input type="checkbox"/> Open <input type="checkbox"/> FCH <input type="checkbox"/> Veteran <input type="checkbox"/> Single <input type="checkbox"/> Limited		Additional Stakes <input type="checkbox"/> Kennel <input type="checkbox"/> Breeder <input type="checkbox"/> Bench	
Registration Number: (please write in registering body before number)			
<input type="checkbox"/> If possible, please separate my hounds	Date of Birth:	Sex: <input type="checkbox"/> Dog <input type="checkbox"/> Bitch	
Name of actual owner(s):			
Address:		Phone:	
City:	State:	Zip:	
E-mail (Optional)		(Optional) Region of Residence:	
Emergency Contact Name and Phone (Optional)			
<input type="checkbox"/> Check if this is the first ASFA trial for this hound. Attach a Hound Certification or waiver if entered in Open, Veterans, Limited.			
<input type="checkbox"/> Check if this is a first-time entry, a copy of the official Registration of this hound must accompany this entry unless NGA.			
<input type="checkbox"/> Check if any information has changed since the last ASFA trial entry. Regarding _____			
<input type="checkbox"/> Check if this hound has been dismissed within the last 6 trials entered. Must be marked in order to qualify for a "clean" trial requirement.			

I CERTIFY that I am the actual owner of this dog, or that I am the duly authorized agent of the actual owner whose name I have entered above. In consideration of the acceptance of this entry and the opportunity to have this dog judged and to win prize money, ribbons, or trophies, I (we) agree to abide by the rules and regulations of the American Sighthound Field Association in effect at the time of this lure field trial, and by any additional rules and regulations appearing in the premium list for this lure field trial. I (we) agree that the club holding this lure field trial has the right to refuse this entry for cause, which the club shall deem to be sufficient. I (we) agree to hold this club, its members, directors, governors, officers, agents or other functionaries, any employees of the aforementioned parties and the owner(s) of the trial premises or grounds harmless from any claim for loss or injury which may be alleged to have been caused directly or indirectly to any person or thing by the act of this dog while in or upon the lure field trial premises or grounds or near any entrance thereto and I (we) personally assume all responsibility and liability for any such claim, and I (we) further agree to hold the aforementioned parties harmless from any claim loss of this dog by disappearance, theft damage or injury be caused or alleged to be caused by the negligence of the club or any of the aforementioned parties or by the negligence of any person or any other cause or causes. I (we) certify and represent that the dog entered is not a hazard to person or other dogs. This entry is submitted for acceptance of the forgoing representations and agreements.

SIGNATURE of owner or his agent
duly authorized to make this entry _____

Please separate the entries before submitting to FTS.

OFFICIAL AMERICAN SIGHTHOUND FIELD ASSOCIATION ENTRY FORM
COLORADO LURE COURSING ASSOCIATION

SATURDAY JULY 15, 2017

FALCON INSTITUTE FOR ADVANCED COURSING STUDIES, FALCON, COLORADO
EARLY ENTRIES: 17.00 1ST hound, \$14.00 2ND and \$12.00 each additional hound entered by same owner.
Wednesday JULY 12, 2017 at 6:00 P.M.

Day of trial entries close at 7:00 A.M. at the FTS desk, the day of the trial, \$25.00 per hound.

Payable in US funds. Make checks payable to CLCA and mail with completed entry form to:

Darci Kunard, 17531 E. 104th Place, Reunion, CO 80022

Fee Paid _____ The Field Secretary cannot accept conditional, unsigned, incomplete or unpaid entries; please check your completed entry carefully.

Breed:	Call Name:		
Registered Name of Hound:			
Stake: <input type="checkbox"/> Open <input type="checkbox"/> FCH <input type="checkbox"/> Veteran <input type="checkbox"/> Single <input type="checkbox"/> Limited		Additional Stakes <input type="checkbox"/> Kennel <input type="checkbox"/> Breeder <input type="checkbox"/> Bench	
Registration Number: (please write in registering body before number)			
<input type="checkbox"/> If possible, please separate my hounds	Date of Birth:	Sex: <input type="checkbox"/> Dog <input type="checkbox"/> Bitch	
Name of actual owner(s):			
Address:		Phone:	
City:	State:	Zip:	
E-mail (Optional)		(Optional) Region of Residence:	
Emergency Contact Name and Phone (Optional)			
<input type="checkbox"/> Check if this is the first ASFA trial for this hound. Attach a Hound Certification or waiver if entered in Open, Veterans, Limited.			
<input type="checkbox"/> Check if this is a first-time entry, a copy of the official Registration of this hound must accompany this entry unless NGA.			
<input type="checkbox"/> Check if any information has changed since the last ASFA trial entry. Regarding _____			
<input type="checkbox"/> Check if this hound has been dismissed within the last 6 trials entered. Must be marked in order to qualify for a "clean" trial requirement.			

I CERTIFY that I am the actual owner of this dog, or that I am the duly authorized agent of the actual owner whose name I have entered above. In consideration of the acceptance of this entry and the opportunity to have this dog judged and to win prize money, ribbons, or trophies, I (we) agree to abide by the rules and regulations of the American Sighthound Field Association in effect at the time of this lure field trial, and by any additional rules and regulations appearing in the premium list for this lure field trial. I (we) agree that the club holding this lure field trial has the right to refuse this entry for cause, which the club shall deem to be sufficient. I (we) agree to hold this club, its members, directors, governors, officers, agents or other functionaries, any employees of the aforementioned parties and the owner(s) of the trial premises or grounds harmless from any claim for loss or injury which may be alleged to have been caused directly or indirectly to any person or thing by the act of this dog while in or upon the lure field trial premises or grounds or near any entrance thereto and I (we) personally assume all responsibility and liability for any such claim, and I (we) further agree to hold the aforementioned parties harmless from any claim loss of this dog by disappearance, theft damage or injury be caused or alleged to be caused by the negligence of the club or any of the aforementioned parties or by the negligence of any person or any other cause or causes. I (we) certify and represent that the dog entered is not a hazard to person or other dogs. This entry is submitted for acceptance of the forgoing representations and agreements.

SIGNATURE of owner or his agent
duly authorized to make this entry _____

Please separate the entries before submitting to FTS.

OFFICIAL AMERICAN SIGHTHOUND FIELD ASSOCIATION ENTRY FORM
COLORADO LURE COURSING ASSOCIATION

SUNDAY JULY 16, 2017

FALCON INSTITUTE FOR ADVANCED COURSING STUDIES, FALCON, COLORADO
EARLY ENTRIES: 17.00 1ST hound, \$14.00 2ND and \$12.00 each additional hound entered by same owner.
Wednesday JULY 12, 2017 at 6:00 P.M.

Day of trial entries close at 7:00 A.M. at the FTS desk, the day of the trial, \$25.00 per hound.

Payable in US funds. Make checks payable to CLCA and mail with completed entry form to:

Darci Kunard, 17531 E. 104th Place, Reunion, CO 80022

Fee Paid _____ The Field Secretary cannot accept conditional, unsigned, incomplete or unpaid entries; please check your completed entry carefully.

Breed:	Call Name:		
Registered Name of Hound:			
Stake: <input type="checkbox"/> Open <input type="checkbox"/> FCH <input type="checkbox"/> Veteran <input type="checkbox"/> Single <input type="checkbox"/> Limited		Additional Stakes <input type="checkbox"/> Kennel <input type="checkbox"/> Breeder <input type="checkbox"/> Bench	
Registration Number: (please write in registering body before number)			
<input type="checkbox"/> If possible, please separate my hounds	Date of Birth:	Sex: <input type="checkbox"/> Dog <input type="checkbox"/> Bitch	
Name of actual owner(s):			
Address:		Phone:	
City:	State:	Zip:	
E-mail (Optional)		(Optional) Region of Residence:	
Emergency Contact Name and Phone (Optional)			
<input type="checkbox"/> Check if this is the first ASFA trial for this hound. Attach a Hound Certification or waiver if entered in Open, Veterans, Limited.			
<input type="checkbox"/> Check if this is a first-time entry, a copy of the official Registration of this hound must accompany this entry unless NGA.			
<input type="checkbox"/> Check if any information has changed since the last ASFA trial entry. Regarding _____			
<input type="checkbox"/> Check if this hound has been dismissed within the last 6 trials entered. Must be marked in order to qualify for a "clean" trial requirement.			

I CERTIFY that I am the actual owner of this dog, or that I am the duly authorized agent of the actual owner whose name I have entered above. In consideration of the acceptance of this entry and the opportunity to have this dog judged and to win prize money, ribbons, or trophies, I (we) agree to abide by the rules and regulations of the American Sighthound Field Association in effect at the time of this lure field trial, and by any additional rules and regulations appearing in the premium list for this lure field trial. I (we) agree that the club holding this lure field trial has the right to refuse this entry for cause, which the club shall deem to be sufficient. I (we) agree to hold this club, its members, directors, governors, officers, agents or other functionaries, any employees of the aforementioned parties and the owner(s) of the trial premises or grounds harmless from any claim for loss or injury which may be alleged to have been caused directly or indirectly to any person or thing by the act of this dog while in or upon the lure field trial premises or grounds or near any entrance thereto and I (we) personally assume all responsibility and liability for any such claim, and I (we) further agree to hold the aforementioned parties harmless from any claim loss of this dog by disappearance, theft damage or injury be caused or alleged to be caused by the negligence of the club or any of the aforementioned parties or by the negligence of any person or any other cause or causes. I (we) certify and represent that the dog entered is not a hazard to person or other dogs. This entry is submitted for acceptance of the forgoing representations and agreements.

SIGNATURE of owner or his agent
duly authorized to make this entry _____

Please separate the entries before submitting to FTS.

OFFICIAL AMERICAN SIGHTHOUND FIELD ASSOCIATION ENTRY FORM
COLORADO LURE COURSING ASSOCIATION

SUNDAY JULY 16, 2017

FALCON INSTITUTE FOR ADVANCED COURSING STUDIES, FALCON, COLORADO
EARLY ENTRIES: 17.00 1ST hound, \$14.00 2ND and \$12.00 each additional hound entered by same owner.
Wednesday JULY 12, 2017 at 6:00 P.M.

Day of trial entries close at 7:00 A.M. at the FTS desk, the day of the trial, \$25.00 per hound.

Payable in US funds. Make checks payable to CLCA and mail with completed entry form to:

Darci Kunard, 17531 E. 104th Place, Reunion, CO 80022

Fee Paid _____ The Field Secretary cannot accept conditional, unsigned, incomplete or unpaid entries; please check your completed entry carefully.

Breed:	Call Name:		
Registered Name of Hound:			
Stake: <input type="checkbox"/> Open <input type="checkbox"/> FCH <input type="checkbox"/> Veteran <input type="checkbox"/> Single <input type="checkbox"/> Limited		Additional Stakes <input type="checkbox"/> Kennel <input type="checkbox"/> Breeder <input type="checkbox"/> Bench	
Registration Number: (please write in registering body before number)			
<input type="checkbox"/> If possible, please separate my hounds	Date of Birth:	Sex: <input type="checkbox"/> Dog <input type="checkbox"/> Bitch	
Name of actual owner(s):			
Address:		Phone:	
City:	State:	Zip:	
E-mail (Optional)		(Optional) Region of Residence:	
Emergency Contact Name and Phone (Optional)			
<input type="checkbox"/> Check if this is the first ASFA trial for this hound. Attach a Hound Certification or waiver if entered in Open, Veterans, Limited.			
<input type="checkbox"/> Check if this is a first-time entry, a copy of the official Registration of this hound must accompany this entry unless NGA.			
<input type="checkbox"/> Check if any information has changed since the last ASFA trial entry. Regarding _____			
<input type="checkbox"/> Check if this hound has been dismissed within the last 6 trials entered. Must be marked in order to qualify for a "clean" trial requirement.			

I CERTIFY that I am the actual owner of this dog, or that I am the duly authorized agent of the actual owner whose name I have entered above. In consideration of the acceptance of this entry and the opportunity to have this dog judged and to win prize money, ribbons, or trophies, I (we) agree to abide by the rules and regulations of the American Sighthound Field Association in effect at the time of this lure field trial, and by any additional rules and regulations appearing in the premium list for this lure field trial. I (we) agree that the club holding this lure field trial has the right to refuse this entry for cause, which the club shall deem to be sufficient. I (we) agree to hold this club, its members, directors, governors, officers, agents or other functionaries, any employees of the aforementioned parties and the owner(s) of the trial premises or grounds harmless from any claim for loss or injury which may be alleged to have been caused directly or indirectly to any person or thing by the act of this dog while in or upon the lure field trial premises or grounds or near any entrance thereto and I (we) personally assume all responsibility and liability for any such claim, and I (we) further agree to hold the aforementioned parties harmless from any claim loss of this dog by disappearance, theft damage or injury be caused or alleged to be caused by the negligence of the club or any of the aforementioned parties or by the negligence of any person or any other cause or causes. I (we) certify and represent that the dog entered is not a hazard to person or other dogs. This entry is submitted for acceptance of the forgoing representations and agreements.

SIGNATURE of owner or his agent
duly authorized to make this entry _____

Please separate the entries before submitting to FTS.

AMERICAN SIGHTHOUND FIELD ASSOCIATION**HOUND CERTIFICATION**

Rule effective October 1, 1994: Ch. V, Sec. 4 (a) OPEN STAKE: *To be eligible to enter the open stake, a hound must have been certified by a licensed judge within the year preceding the closing date for the entry or have previously competed in the Open Stake.* This eligibility requirement also applies to a hound entered in the Limited or Veteran Stake, which has not competed in Open previously. Please complete this portion of this form and attach it to the entry form for the hound's first entry, including an entry for a Fun Trial.

Registered Name of Hound: _____

Registration Number: _____ Breed: _____

Registered Owner's Name: _____

I hereby certify that on (date) _____, the above named hound completed a lure course of at least 500 yards, running with another hound of the same breed (or another breed with a similar running style). During the course the above named hound showed no inclination to interfere with the other hound. I further certify that I am a licensed judge for the ASFA.

Name of Licensed Judge: _____

Signature: _____ Date: _____

I hereby certify that the hound running in the certification course is the hound identified above and that information provided on this form is true and correct.

Signature: _____ Date: _____

Owner or Authorized Agent of Hound

This certification form must be attached to the entry form the first time this hound is entered in an open, limited, or veteran stake. Any hound entered in open, limited, or veteran (as a first time entered hound), which has not been certified, shall be declared ineligible by the records coordinator and shall forfeit any points and placements awarded.

PLEASE RETAIN A COPY FOR YOUR RECORDS.**AMERICAN SIGHTHOUND FIELD ASSOCIATION****HOUND CERTIFICATION WAIVER**

Waiver of Requirement: *This requirement will be waived for a hound that has earned a lure coursing or racing title from another recognized organization, if such title requires competition, and if a waiver for such title has been approved by the ASFA, or a CKC Hound Certification Form. If your hound qualifies for a waiver, complete this portion of this form and attach it to your entry form. Proof of waivers must accompany this certification form.*

Registered Name of Hound: _____

Registration Number: _____ Breed: _____

Registered Owner's Name: _____

<u>CKC:</u>	FCH	FCHX		<u>CWA:</u>	ARX	TRP	SRA	
	DPC							
<u>AKC:</u>	QC	SC	FC	<u>LGRA:</u>	GRC	<u>NAWRA:</u>	RCH	SR
<u>WRA:</u>	CR	WRCH		<u>NOTRA:</u>	ORC	OTR	SORC	
	SOR							

Hound Certification previously submitted.

I hereby certify that the hound identified above has completed the requirements for the title indicated above (or that the required Certification was previously submitted) and that the information provided on this form is true and correct.

Signature: _____ Date: _____

Owner or Authorized Agent of Hound

AMERICAN SIGHTHOUND FIELD ASSOCIATION**HOUND CERTIFICATION**

Rule effective October 1, 1994: Ch. V, Sec. 4 (a) OPEN STAKE: *To be eligible to enter the open stake, a hound must have been certified by a licensed judge within the year preceding the closing date for the entry or have previously competed in the Open Stake.* This eligibility requirement also applies to a hound entered in the Limited or Veteran Stake, which has not competed in Open previously. Please complete this portion of this form and attach it to the entry form for the hound's first entry, including an entry for a Fun Trial.

Registered Name of Hound: _____

Registration Number: _____ Breed: _____

Registered Owner's Name: _____

I hereby certify that on (date) _____, the above named hound completed a lure course of at least 500 yards, running with another hound of the same breed (or another breed with a similar running style). During the course the above named hound showed no inclination to interfere with the other hound. I further certify that I am a licensed judge for the ASFA.

Name of Licensed Judge: _____

Signature: _____ Date: _____

I hereby certify that the hound running in the certification course is the hound identified above and that information provided on this form is true and correct.

Signature: _____ Date: _____

Owner or Authorized Agent of Hound

This certification form must be attached to the entry form the first time this hound is entered in an open, limited, or veteran stake. Any hound entered in open, limited, or veteran (as a first time entered hound), which has not been certified, shall be declared ineligible by the records coordinator and shall forfeit any points and placements awarded.

PLEASE RETAIN A COPY FOR YOUR RECORDS.**AMERICAN SIGHTHOUND FIELD ASSOCIATION****HOUND CERTIFICATION WAIVER**

Waiver of Requirement: *This requirement will be waived for a hound that has earned a lure coursing or racing title from another recognized organization, if such title requires competition, and if a waiver for such title has been approved by the ASFA, or a CKC Hound Certification Form. If your hound qualifies for a waiver, complete this portion of this form and attach it to your entry form. Proof of waivers must accompany this certification form.*

Registered Name of Hound: _____

Registration Number: _____ Breed: _____

Registered Owner's Name: _____

<u>CKC:</u>	FCH	FCHX		<u>CWA:</u>	ARX	TRP	SRA	
	DPC							
<u>AKC:</u>	QC	SC	FC	<u>LGRA:</u>	GRC	<u>NAWRA:</u>	RCH	SR
<u>WRA:</u>	CR	WRCH		<u>NOTRA:</u>	ORC	OTR	SORC	
	SOR							

Hound Certification previously submitted.

I hereby certify that the hound identified above has completed the requirements for the title indicated above (or that the required Certification was previously submitted) and that the information provided on this form is true and correct.

Signature: _____ Date: _____

Owner or Authorized Agent of Hound