

# COLORADO LURE COURSING ASSOCIATION

Darci Kunard  
17531 E 104<sup>th</sup> Place  
Reunion, CO 80022  
[kdarci@yahoo.com](mailto:kdarci@yahoo.com)  
720-938-3303

[www.clcaonline.com](http://www.clcaonline.com)  
[www.asfa.org](http://www.asfa.org)

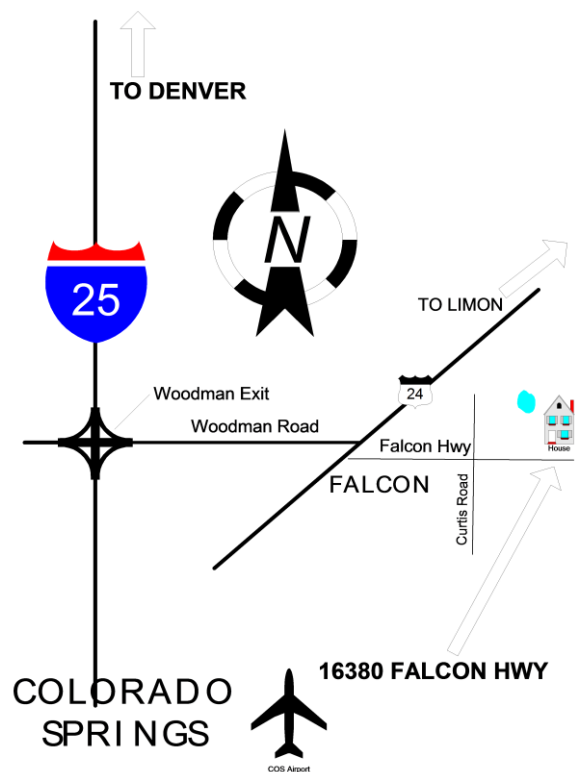

**From I-25 North or South:** Take Woodmen Road Exit and travel east to Highway 24. Turn Right on Highway 24 and then turn Left on Meridian. Go to stop sign and then Turn Left on Falcon Highway. Turn Left in driveway at 16380 Falcon Highway.

## PREMIUM LIST

**EARLY ENTRIES close on Wednesday, July 13, 2022, at 6:00pm at the FTS's address.**

(Substitutions for lame hounds or bitches in season will be allowed prior to 8:30 A.M. on the day of the trial. Owner of the substituted hound must be the Same as the hound already entered.)

### REGION 3 ASFA SANCTIONED ALL BREED LURE FIELD TRIAL



## COLORADO LURE COURSING ASSOCIATION

**FRIDAY July 15, 2022 ALL BREED**

**LCI LIMITED to 15 TOTAL DOGS**

**SATURDAY July 16, 2022 ALL BREED**

**Region 3 Invitational**

**SUNDAY July 17, 2022 ALL BREED & Lure Chasing Instinct**

**LCI LIMITED to 15 TOTAL DOGS**

FALCON INSTITUTE FOR ADVANCED COURSING STUDIES  
16380 FALCON HIGHWAY  
PEYTON, COLORADO 80831-7993

**EARLY ENTRY FEES:** \$17.00 for 1<sup>st</sup>; \$14.00 for 2<sup>nd</sup> and \$12.00 each additional hound with same owner.  
Regional Entry Fees for Regular and Non-Regular Stakes – see page 3.

**DAY-OF ENTRY FEES:** \$25.00 per hound  
Payable in US Funds.

Permission has been granted by the American Sighthound Field Association for the holding of this event under American Sighthound Field Association Rules and Regulations  
Audrey Silverstein, Chairman ASFA Scheduling Committee

## COLORADO LURE COURSING ASSOCIATION

### OFFICERS AND DIRECTORS

President	Darci Kunard
Vice President	Connie Sullivan
Recording Secretary	Robin Phinney
Corresponding Secretary	Dan Heidel
Treasurer	Deann Britton
Directors-at-Large:	Cathy Day
	Gina Hayden
	Peter Lowe
	Tom Golcher
	Heather Fletcher
	Mike Hussey

### JUDGES (AND THEIR ASSIGNMENTS)

Frank Cassano, La Salle, CO	Phil Fullam, Rio Rancho, NM
Dan Heidel, Lakewood, CO	Mike Hussey, Elizabeth, CO
Claudia Miller, Arvada, CO	Heather Minnich, Lander, WY

**S = Single Judge** \* = Provisional Judge # = Canadian Judge

### FRIDAY

JUDGE	A	Az	Ba	B	C	G	IB	IW	IG	L C I	P	R	S	SD	SI	SW	W	S G L	P V L
Frank	X	X	X	X	X	X	X	X	X	X	X		X	X	X	X	X	X	X
Phil								X				X	X			X	X	X	X
Mike						X	X				X	X							
Heather	X	X	X	X	X				X	X				X	X				

### SATURDAY

JUDGE	A	Az	Ba	B	C	G	IB	IW	IG	P	R	S	SD	SI	SW	W	Sgl	Pvl
Dan	X	X	X	X	X	X	X			X	X	X	X	X	X		X	X
Claudia	X	X	X	X	X	X		X	X	X	X		X	X	X	X	X	X
Heather							X	X	X	X	X					X		

### SUNDAY

JUDGE	A	Az	Ba	B	C	G	IB	IW	IG	L C I	P	R	S	SD	SI	SW	W	S G L	P V L
Mike	X	X	X	X	X				X	X	X			X	X	X	X	X	X
Phil		X	X	X	X	X	X	X		X		X	X	X	X	X	X	X	X
Claudia	X					X	X	X	X		X	X	X						

### FIELD COMMITTEE

Field Chair	Mike Hussey, <a href="mailto:cday6234@gmail.com">cday6234@gmail.com</a>
Field Secretary	Darci Kunard, <a href="mailto:kdarci@yahoo.com">kdarci@yahoo.com</a> 720-938-3303 17531 E 104 <sup>th</sup> Pl, Reunion, CO 80022
Lure Operators	D. Heidel, E Kominek, C. Sullivan, M Lundberg, M Hussey

Ribbons or rosettes will be offered for all placements.

First=Blue, Second=Red, Third=Yellow, Fourth=White, NBQ=Green

Highest Scoring Single=Navy/Gold, Best of Breed=Purple/Gold

Regional ribbons and prizes noted on next page.

**TRIAL HOURS: 7:00 a.m. until ribbons are awarded.**

**DAY OF ENTRIES CLOSE AT 7:30 A.M DAY OF TRIAL**

**ROLL CALL PROMPTLY AT 7:45 A.M.**

Any hound not present at Roll Call will be scratched and entry fee will not be refunded.

## BEST IN FIELD OFFERED FRIDAY & SUNDAY

**Regional Saturday** – please check eligibility requirements on next page!

### ELIGIBLE BREEDS & REGISTRY

Only purebred Afghan Hounds, Azawakhs, Basenjis, Borzoi, Cirneco dell'Etna, Greyhounds, Ibizan Hounds, Irish Wolfhounds, Italian Greyhounds, Pharaoh Hounds, Rhodesian Ridgebacks, Salukis, Scottish Deerhounds, Silken Windhound, Sloughis, Whippets and Provisional breeds may be entered in the regular stakes. Current Provisional include purebred Chart Polski, Galgo Español, Magyar Agar, Peruvian Inca Orchid, Portuguese Podengo (Pequeno), Portuguese Podengo (Medio & Grande), and must be individually registered with the appropriate registry.

### REGULAR STAKES OFFERED:

**OPEN** - Any eligible sighthound, excluding ASFA Field Champions of record that has met ASFA certification requirements.

**FIELD CHAMPION** - Any ASFA Field Champion

**VETERAN** - Any eligible sighthound which is 6 years or older on the day of the trial, except Irish Wolfhounds whose age shall be at least 5 years; and Afghans, Rhodesian Ridgebacks, Salukis and Whippets whose age shall be at least 7 years of age and has met ASFA certification requirements. Points go toward V-FCh and V-LCM titles.

**SINGLE STAKE:** Any eligible sighthound including those disqualified to run in other stakes. Each hound runs alone. Not eligible for Best of Breed or Best in Field. Hounds are eligible to earn TCP and CPX titles from the Singles stake. Provisional breeds are not eligible for these titles.

**PROVISIONAL** - Any eligible sighthound of a provisional breed that has met certification requirements. Not eligible to compete in Best of Breed or Best in field.

**LURE COURSING INSTINCT (LCI) STAKE:** Open to NON sighthounds and sighthound mixes. All entries shall be individually registered with the AKC (including ILP & PAL) or the UKC. A photocopy of acceptable registry must be submitted with each dog's first ASFA field trial entry. Dogs without a recognized registry number may obtain an ASFA ID number for a \$10 registration fee at time of entry.

**Small Open:** for dogs 17-1/2 inches or less at the withers and / or brachycephalic ("flat-faced") dogs who have not achieved the title of LCC.

**Small Senior:** for dogs 17-1/2 inches or less at the withers and/or brachycephalic dogs who have achieved the title of LCC.

**Small Veteran:** for dogs 17-1/2 inches or less at the withers and/or brachycephalic dogs over the age of 7 years.

**Large Open:** for dogs over 17-1/2 inches at the withers who have not achieved the title of LCC.

**Large Senior:** is for dogs over 17-1/2 inches at the withers who have achieved the title of LCC.

**Large Veteran:** for dogs over 17-1/2 inches at the withers who are over the age of 7 years.

**Sighthound Mix Open:** for dogs with a sighthound breed in its background who have not achieved the title of LCC.

**Sighthound Mix Senior:** for dogs with sighthound breed in its background who have achieved the title of LCC.

**Sighthound Mix Veteran:** for dogs with sighthound breed in its background over the age of 7 years.

When running as a stake within a regular ASFA trial, Small will run 50% of the ASFA course as laid out for the sighthounds up to a maximum of 400 yards. All other stakes will run the full ASFA laid out course leg.

## ASFA OFFICERS AND DIRECTORS

President, Phil Fullam – President      1st Vice President: Gregory Breitbach  
2nd Vice President Cathy Sanderson      Corresponding Secretary, Mary Frances Miller  
Recording Secretary; Jennifer Gysler      Chief Financial Officer: Scott Hurlbert  
Region Directors Region 1: Karen Sanders; Region 2 : Jayme Jones,  
Region 3:Tom Golcher; Region 4: Terry Sayre; Region 5: Trisha Borland;  
Region 6: Gayle Kytta; Region 7: Eddie Kominek; Region 8: Kathy Sanders;  
Region 9: Vacant; Region 10: Vacant

## REGIONAL ELIGIBILITY & STAKES OFFERED:

### Regional Entry Fees:

**EARLY ENTRY FEES:** \$17.00 for 1<sup>st</sup>; \$14.00 for 2<sup>nd</sup> and \$12.00 each additional hound with same owner.

**Non-Regular Stakes** – \$8 per kennel stake pair; \$8 per breeder stake pair; \$5 for bench stake.

**DAY-OF ENTRY FEES:** \$25.00 per hound.

**Non-regular stakes** cannot be entered day-of; available for pre-entry only.

Payable in US Funds.

## REGIONAL ELIGIBILITY & STAKES OFFERED:

### Regional Invitational Requirements

Any hound that has earned at least one ASFA point if eligible to enter. For Provisional breed to be eligible, the entered hound must have received a placement, with competition. All points or placements must be earned by the closing date of the event. Any hound entered in the Singles Stake does not need prior ASFA experience. An eligible hound may be entered in any number of Regional Invitationals.

### REGULAR STAKES OFFERED:

**OPEN** - Any eligible sighthound, excluding ASFA Field Champions of record that has met ASFA certification requirements.

**FIELD CHAMPION** - Any ASFA Field Champion

**VETERAN** - Any eligible sighthound which is 6 years or older on the day of the trial, except Irish Wolfhounds whose age shall be at least 5 years; and Afghans, Rhodesian Ridgebacks, Salukis and Whippets whose age shall be at least 7 years of age and has met ASFA certification requirements. Points go toward V-FCh and V-LCM titles.

**SINGLE STAKE:** Any eligible sighthound including those disqualified to run in other stakes. Each hound runs alone. Not eligible for Best of Breed or Best in Field. Hounds are eligible to earn TCP and CPX titles from the Singles stake. Provisional breeds are not eligible for these titles.

**PROVISIONAL** - Any eligible sighthound of a provisional breed that has met certification requirements. Not eligible to compete in Best of Breed or Best in field.

### NON-REGULAR STAKES OFFERED:

**KENNEL STAKE:** For hounds of any individual breeds; an entry shall consist of two hounds, designated at time of entry in one of the regular stakes being owned and kenneled by the same person.

**BREEDER STAKE:** For any breed which shall have, designated at time of entry, two hounds bred by the same individual.

**BENCH STAKE:** For any eligible sighthound with proof on file with the ASFA of a conformation champion title from the AKC, CKC, or both, or a conformation grand champion title from the UKC.

### REGIONAL RIBBONS AND PRIZES:

**ASFA Regional Rosettes will be offered for all placements**

**First** = Blue, **Second** = Red, **Third** = Yellow, **Fourth** = White, **NBQ** = Green

**High-Score Single** = Navy/Gold      **Best of Breed** = Purple/Gold

**Best in Field** = Red, White, & Blue

**CLCA Rosettes will be offered for non-regular stakes**

**Kennel** = Light Blue, **Breeder** = Light Green, **Bench** = Lavender

**ASFA Medallions are awarded to each Best of Breed Winner**

**CLCA Prizes** for Regular and Non-Regular Stakes donated by Darci Kunard, Lotus Pharaohs, in memory of Pharaoh Hound Kaba. Best in Field prize donated by Wag 'n Wash.

## GENERAL INFORMATION

**Conditions of Entry:** All entries must be one year or older on the day of the trial. Stakes will be split into flights by public random draw if the entry in any regular stake is 20 or more. Bitches in season, lame hounds and hounds with breed disqualifications will be excused at roll call. Spayed, neutered, monorchid or cryptorchid hounds without breed disqualifications may be entered; hounds with breed disqualifications are not eligible to enter except in the Single Stake. Hounds not present at the time of roll call will be scratched. All hounds will run twice, in trios if possible or braces (except in the Single Stake), unless excused, dismissed or disqualified.

## COURSE PLANS:

Colorado Lure Coursing Association reserves the right to alter the course design(s) depending on field and/or weather conditions on the day of the trial.

**Warning:** It is advised that all hounds entered be in top physical condition due to the altitude and rigorous conditions of the course, which will be run on natural terrain and may include such hazards as rocks, trees, cactus, vegetation, gopher holes, gullies, bodies of water and other obstacles.

**ALL HOUNDS RUN AT THE OWNER'S SOLE RISK.**

**Friday July 15, 2022**

750 yards, clockwise for prelims and reversed for finals

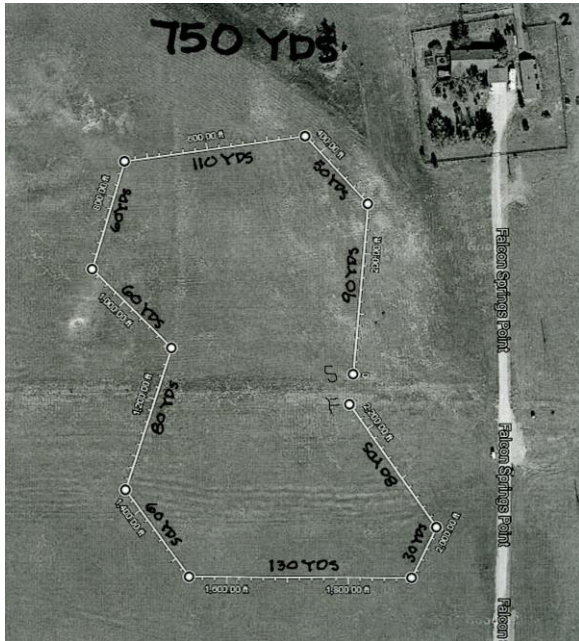

**Saturday July 16, 2022**

770 yards, clockwise for prelims and reversed for finals

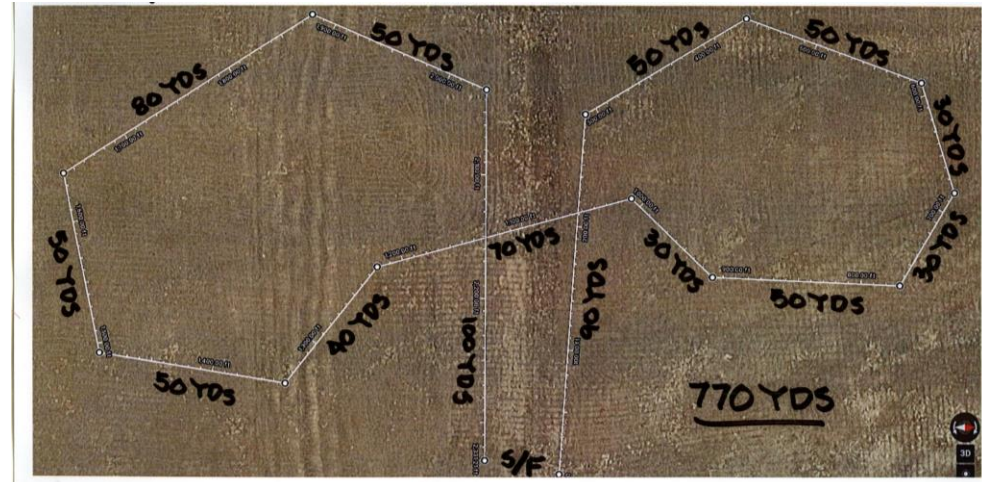

**Sunday July 17, 2022**

760 yards, clockwise for prelims and reversed for finals

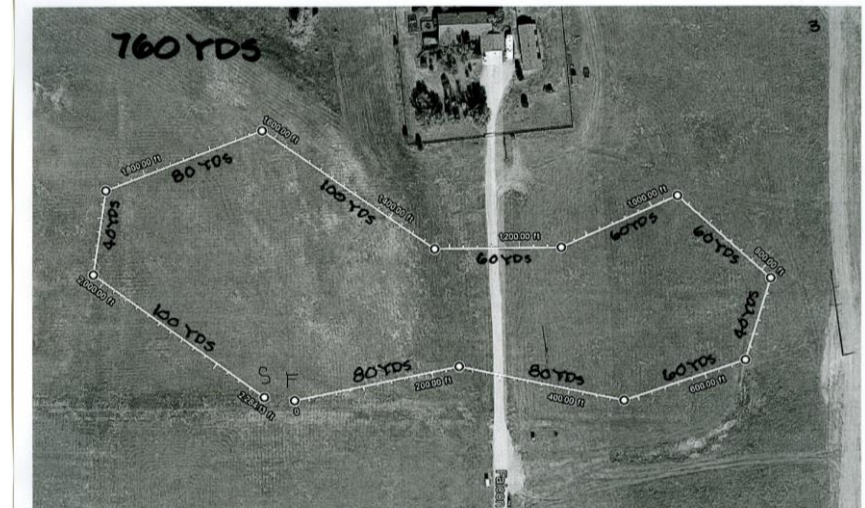



## Information & Policies

- Port-a-pot on site.
- BRING WATER AND SHADE FOR YOUR HOUNDS.
- Bring FOOD – none offer by the Club.
- **Veterinarian –**
- **Friday & Saturday – Black Forest Veterinary Clinic 719-495-3666. Sunday Animal Emergency Care, 5752 North Academy Blvd., (behind Petco) 719-260-7141.**
- Due to dry conditions, smoking of any kind is prohibited on the field, Absolutely NO CAMPFIRES!
- PICK UP AFTER YOUR DOG AND YOURSELF!
- EQUIPMENT: Type of lure machine: battery-powered continuous-loop system. Back-up equipment will be available. Type of lures: highly visible plastic strips.
- A \$20.00 fee will be assessed for any returned checks. Persons exhibiting conduct detrimental to ASFA/CLCA/ any hound(s)/other person(s) will be asked to leave the trial site.
- There will be a \$5.00 fine for any owner who does not clean up after his/her hound and for any loose hound not competing in the course in progress.

## How To Enter the Trial

1. Complete the entry form(s) – one entry form for each dog and each day that the dog is entered.
  - a. If this is the first time you have entered this dog in an ASFA trial, AND your dog has an AKC QC (qualified courser) OR an ASFA Certification, you MUST include a copy of that with your entry AND a copy of your registration certification (i.e., AKC, UKC, CKC, etc.)
  - b. If your dog does NOT have an AKC QC or ASFA Cert, you are allowed to run in SINGLES, but not the regular open stake. We offer certification AFTER the trial (Saturday ONLY.) Certification forms are included.
  - c. For LCI dogs – please complete the entry form – one for each dog.
    - i. If this is your first time entering in an ASFA trial you must complete the form titled: **Request for ASFA Lure Chasing Instinct Registration Number**
  - d. For regional entrants – be sure to check the box on the entry form if you want to enter kennel stake, breeder stake, or bench stake. Failure to check that box constitutes a non-entry.
2. Email your entries to the Field Trial Secretary at [kdarci@yahoo.com](mailto:kdarci@yahoo.com)

- ENTRIES THAT ARE EMAILED MUST BE ACCOMPANIED BY PAYMENT THROUGH the CLCA PayPal – see #3 for more details.
3. Pay the entry fee via the CLCA PayPal account at: [deann.clcatreasurer@gmail.com](mailto:deann.clcatreasurer@gmail.com) . Please add \$1.00 per entry to cover the PayPal fees. Note: If the entries along with payment are not received, then the emailed entries will NOT constitute a valid entry.

**ENTRIES WILL NOT BE ACKNOWLEDGED BY MAIL OR TELEPHONE. LATE, INCOMPLETE, UNSIGNED OR CONDITIONAL ENTRIES WILL NOT BE ACCEPTED.**

**Friday 7/15 and Saturday 7/16**  
**Certifications and practices will be held AFTER the CLCA trial on Friday and Saturday ONLY, WEATHER AND MACHINERY PERMITTING**

**All hounds will be inspected before running.  
Lame hounds and bitches in season may NOT run.**

**Certification:** Any entry marked “First ASFA Point Trial” Must have an ASFA Hound Certification form and a copy of the hound’s registration papers, not required for NGA greyhounds, and must present them to the Field Trial Secretary along with your entry before entering a regular ASFA trial. This applies to “First ASFA point trial” hounds entered in the OPEN, VETERAN or PROVISIONAL stake. Certification forms will be available but MUST be completed prior to judging. Also have your hound’s registration number available for the Certification Form.

**Certification:** \$7.00, Owners wishing to certify a hound for competition are responsible for arranging a hound of the same breed, or similar running style, to run with his/her dog for the certification.

**Practices:** \$5.00 each dog

# Please consider joining CLCA!

We'd love to have you.

Members are eligible to vote on topics at our twice-yearly meetings, to hold offices on the Boards, for the Top 10 year-end awards, and for our fun events and our annual banquet.

Dues are:

Individual - \$10/year

Associate - \$15/year

Family - \$20/year (2 voting members)

## Membership application on the last page

Feel free to turn in at the trial or with your entries

## Surfing the WEB? Check out the following websites:

[www.clcaonline.com](http://www.clcaonline.com)

[www.asfa.org](http://www.asfa.org)

## Motels

The following will accept well behaved dogs, and are in the Colorado Springs area:

- Super 8, Wyndham, Hwy 24 E/AFB Area, 605 Peterson Rd, Colo Spgs 80915, 719-362-5200

- Econo Lodge Airport: 6715 Panamint Ct, Colo Spgs, 80915, 719-638-5800

\*\*\*CHECK HOTELS FOR THEIR PET POLICIES\*\*\*

\*\*\*\* PLEASE CLEAN UP AFTER YOUR PETS\*\*

Falcon Meadow Campgrounds, 11150 Hwy 24, Falcon – 719-495-2694  
(Falcon is 5 miles west of the trial site)

## CLCA Lure Coursing Procedures

We will follow the State of Colorado and all local guidelines.

As of 6/7/2022 the number of people at an outdoor gathering is **NOT limited** this may change, and we will adjust accordingly. Further, El Paso County does **NOT** require face-coverings outdoors. Therefore, face-coverings are optional – up to the individual's comfort level. Please continue to maintain social distancing measures and respect the space that others request.

1. **All participants shall maintain the 6-foot social distancing requirement when interacting with people not in their household.**
2. No food will be served. Please bring your own food, water and shade for yourself and your dogs. None will be available.
3. Park at a 4 to 6-foot distance away from other vehicles.
4. Roll Call will be done at a central location. We will ask the owners of females to wipe their dogs and show the inspection committee the tissue.
5. Huntmasters will stand 4 to 6 feet from the dogs after inspecting blankets and slip leads.
6. At the starting line, all dogs will stand 3-4 feet apart.
7. Practice social distancing the best you can and respect the space that others request.
8. Please be aware of the running order posted.

Above all, have fun with your dogs and be safe!!!

**You can make a difference, even if you can help out for an hour or so..**

Easy ways to volunteer at a lure coursing field trial (and you don't even have to be a CLCA member):

**Field Setup/Tear Down**

- ◆ Come early (one hour before roll call) and start by carrying equipment.
- ◆ Learn as you go: how to place pulleys and tie downs; how to measure the course.
- ◆ Help pick up the course at the end of the day.

**Inspection**

- ◆ Check-in dogs; learn how to use the wicket. Help get the trial moving in the morning!

**Field Clerk**

- ◆ Volunteer for one or two breeds – get paperwork from the judges and deliver to the field trial secretary.
- ◆ Learn how scores are tabulated and recorded. Help correct math errors.
- ◆ The benefit is you will get a whole new perspective on the course and may learn by listening to the judges.

**Paddock**

- ◆ Volunteer for one or two breeds – keep the trial moving by making sure people know when they are up next.

**Help your fellow participants**

- ◆ Many people need help managing multiple dogs. Instead of sitting in your car, offer to hold a dog or release a dog.

**Scoreboard**

- ◆ Hang-up scoresheets... keep the trial moving.

**Lure Operator**

- ◆ Hang around and talk to the lure operator between courses.
- ◆ If you are interested, try running the lure around before the trial, at lunch or after the trial at practice.

**Practice**

- ◆ Give the volunteers who have been working all day a break!
- ◆ Take the practice list, inspect the dogs, call out the names.

THANK YOU FOR VOLUNTEERING. Everyone will appreciate your efforts,

and the trial will run more smoothly.

Whether or not you are a CLCA member, please consider volunteering at this trial! If you have experience and are willing to work a job or if you wish to apprentice to learn a job, please fill out the form below and return it with your entry to the Field Trial Secretary. As an apprentice you will be paired with a person who knows the job so that you will have one-on-one attention.

**I will work on: \_\_\_ Friday \_\_\_ Saturday \_\_\_ Sunday**

**I will apprentice on: \_\_\_ Friday \_\_\_ Saturday \_\_\_ Sunday**

Name: \_\_\_\_\_

Phone: \_\_\_\_\_

Email: \_\_\_\_\_

I am entering dogs of these breeds on Saturday: \_\_\_\_\_

I am entering dogs of these breeds on Sunday: \_\_\_\_\_

Check jobs you are willing to do or learn the day of the trial.

	<u>EXPERIENCED</u>	<u>APPRENTICE</u>
Field Set UP	_____	_____
Roll Call	_____	_____
Paddock	_____	_____
Huntmaster	_____	_____
Lure Operator	_____	_____
Field Clerk	_____	_____
Field Tear Down	_____	_____

**THANK YOU FOR VOLUNTEERING!!**

**OFFICIAL AMERICAN SIGHTHOUND FIELD ASSOCIATION ENTRY FORM**  
**COLORADO LURE COURSING ASSOCIATION ALL BREED ASFA LURE FIELD TRIAL**  
**FRIDAY July 15, 2022**

FALCON INSTITUTE FOR ADVANCED COURSING STUDIES, FALCON, COLORADO  
**EARLY ENTRIES: 17.00 1<sup>ST</sup> hound, \$14.00 2<sup>ND</sup> and \$12.00 each additional hound entered by same owner.**

**DAY OF ENTRIES 25.00 per hound; close at 7:30 A.M. at FTS TABLE**

Payable in US funds. Make checks payable to CLCA and mail with completed entry form to:  
**Darci Kunard, 17531 E 104<sup>th</sup> Pl, Reunion, CO 80022**

Fee Paid \_\_\_\_\_ The Field Secretary cannot accept conditional, unsigned, incomplete or unpaid entries; please check your completed entry carefully

Breed:		Call Name:	
Registered Name of Hound:			
Stake: <input type="checkbox"/> Open <input type="checkbox"/> FCH <input type="checkbox"/> Veteran <input type="checkbox"/> Single <input type="checkbox"/> Provisional		Additional Stakes <input type="checkbox"/> Kennel <input type="checkbox"/> Breeder <input type="checkbox"/> Bench	
<b>Registration Number:</b> (please write in registering body before number)			
<input type="checkbox"/> If possible, please separate my hounds		Date of Birth:	Sex: <input type="checkbox"/> Dog <input type="checkbox"/> Bitch
Name of actual owner(s):			
Address:		Phone:	
City:		State:	Zip:
E-mail (Optional)		(Optional) Region of Residence:	
Emergency Contact Name and Phone (Optional)			
<input type="checkbox"/> <b>Check if this is the first ASFA trial for this hound. Attach a Hound Certification or waiver if entered in Open, Veterans, Limited.</b>			
<input type="checkbox"/> <b>Check if this is a first-time entry, a copy of the official Registration of this hound must accompany this entry unless NGA.</b>			
<input type="checkbox"/> Check if any information has changed since the last ASFA trial entry. Regarding _____			
<input type="checkbox"/> Check if this hound has been dismissed within the last 6 trials entered. Must be marked in order to qualify for a "clean" trial requirement.			

I CERTIFY that I am the actual owner of this dog, or that I am the duly authorized agent of the actual owner whose name I have entered above. In consideration of the acceptance of this entry and the opportunity to have this dog judged and to win prize money, ribbons, or trophies, I (we) agree to abide by the rules and regulations of the American Sighthound Field Association in effect at the time of this lure field trial, and by any additional rules and regulations appearing in the premium list for this lure field trial. I (we) agree that the club holding this lure field trial has the right to refuse this entry for cause, which the club shall deem to be sufficient. I (we) agree to hold this club, its members, directors, governors, officers, agents or other functionaries, any employees of the aforementioned parties and the owner(s) of the trial premises or grounds harmless from any claim for loss or injury which may be alleged to have been caused directly or indirectly to any person or thing by the act of this dog while in or upon the lure field trial premises or grounds or near any entrance thereto and I (we) personally assume all responsibility and liability for any such claim, and I (we) further agree to hold the aforementioned parties harmless from any claim loss of this dog by disappearance, theft damage or injury be caused or alleged to be caused by the negligence of the club or any of the aforementioned parties or by the negligence of any person or any other cause or causes. I (we) certify and represent that the dog entered is not a hazard to person or other dogs. This entry is submitted for acceptance of the forgoing representations and agreements.

**SIGNATURE** of owner or his agent  
 duly authorized to make this entry \_\_\_\_\_

**Please separate the entries before submitting to FTS.**

**OFFICIAL AMERICAN SIGHTHOUND FIELD ASSOCIATION ENTRY FORM**  
**COLORADO LURE COURSING ASSOCIATION ALL BREED ASFA LURE FIELD TRIAL**  
**FRIDAY July 15, 2022**

FALCON INSTITUTE FOR ADVANCED COURSING STUDIES, FALCON, COLORADO  
**EARLY ENTRIES: 17.00 1<sup>ST</sup> hound, \$14.00 2<sup>ND</sup> and \$12.00 each additional hound entered by same owner.**

**DAY OF ENTRIES 25.00 per hound; close at 7:30 A.M. at FTS TABLE**

Payable in US funds. Make checks payable to CLCA and mail with completed entry form to:  
**Darci Kunard, 17531 E 104<sup>th</sup> Pl, Reunion, CO 80022**

Fee Paid \_\_\_\_\_ The Field Secretary cannot accept conditional, unsigned, incomplete or unpaid entries; please check your completed entry carefully

Breed:		Call Name:	
Registered Name of Hound:			
Stake: <input type="checkbox"/> Open <input type="checkbox"/> FCH <input type="checkbox"/> Veteran <input type="checkbox"/> Single <input type="checkbox"/> Provisional		Additional Stakes <input type="checkbox"/> Kennel <input type="checkbox"/> Breeder <input type="checkbox"/> Bench	
<b>Registration Number:</b> (please write in registering body before number)			
<input type="checkbox"/> If possible, please separate my hounds		Date of Birth:	Sex: <input type="checkbox"/> Dog <input type="checkbox"/> Bitch
Name of actual owner(s):			
Address:		Phone:	
City:		State:	Zip:
E-mail (Optional)		(Optional) Region of Residence:	
Emergency Contact Name and Phone (Optional)			
<input type="checkbox"/> <b>Check if this is the first ASFA trial for this hound. Attach a Hound Certification or waiver if entered in Open, Veterans, Limited.</b>			
<input type="checkbox"/> <b>Check if this is a first-time entry, a copy of the official Registration of this hound must accompany this entry unless NGA.</b>			
<input type="checkbox"/> Check if any information has changed since the last ASFA trial entry. Regarding _____			
<input type="checkbox"/> Check if this hound has been dismissed within the last 6 trials entered. Must be marked in order to qualify for a "clean" trial requirement.			

I CERTIFY that I am the actual owner of this dog, or that I am the duly authorized agent of the actual owner whose name I have entered above. In consideration of the acceptance of this entry and the opportunity to have this dog judged and to win prize money, ribbons, or trophies, I (we) agree to abide by the rules and regulations of the American Sighthound Field Association in effect at the time of this lure field trial, and by any additional rules and regulations appearing in the premium list for this lure field trial. I (we) agree that the club holding this lure field trial has the right to refuse this entry for cause, which the club shall deem to be sufficient. I (we) agree to hold this club, its members, directors, governors, officers, agents or other functionaries, any employees of the aforementioned parties and the owner(s) of the trial premises or grounds harmless from any claim for loss or injury which may be alleged to have been caused directly or indirectly to any person or thing by the act of this dog while in or upon the lure field trial premises or grounds or near any entrance thereto and I (we) personally assume all responsibility and liability for any such claim, and I (we) further agree to hold the aforementioned parties harmless from any claim loss of this dog by disappearance, theft damage or injury be caused or alleged to be caused by the negligence of the club or any of the aforementioned parties or by the negligence of any person or any other cause or causes. I (we) certify and represent that the dog entered is not a hazard to person or other dogs. This entry is submitted for acceptance of the forgoing representations and agreements.

**SIGNATURE** of owner or his agent  
 duly authorized to make this entry \_\_\_\_\_

**Please separate the entries before submitting to FTS.**



**OFFICIAL AMERICAN SIGHTHOUND FIELD ASSOCIATION ENTRY FORM**  
**COLORADO LURE COURSING ASSOCIATION ALL BREED ASFA LURE FIELD TRIAL**  
**SATURDAY July 16, 2022 – REGION 3 INVITATIONAL**  
**FALCON INSTITUTE FOR ADVANCED COURSING STUDIES, FALCON, COLORADO**  
**EARLY ENTRIES: 17.00 1<sup>ST</sup> hound, \$14.00 2<sup>ND</sup> and \$12.00 each additional hound entered by same owner.**  
**DAY OF ENTRIES 25.00 per hound; close at 7:30 A.M. at FTS TABLE**  
**Payable in US funds. Make checks payable to CLCA and mail with completed entry form to:**  
**Darci Kunard, 17531 E 104<sup>th</sup> Pl, Reunion, CO 80022**

Fee Paid \_\_\_\_\_ The Field Secretary cannot accept conditional, unsigned, incomplete or unpaid entries; please check your completed entry carefully

Breed:		Call Name:	
Registered Name of Hound:			
Stake: <input type="checkbox"/> Open <input type="checkbox"/> FCH <input type="checkbox"/> Veteran <input type="checkbox"/> Single <input type="checkbox"/> Provisional		Additional Stakes <input type="checkbox"/> Kennel <input type="checkbox"/> Breeder <input type="checkbox"/> Bench	
<b>Registration Number:</b> (please write in registering body before number)			
<input type="checkbox"/> If possible, please separate my hounds		Date of Birth:	Sex: <input type="checkbox"/> Dog <input type="checkbox"/> Bitch
Name of actual owner(s):			
Address:		Phone:	
City:		State:	Zip:
E-mail (Optional)		(Optional) Region of Residence:	
Emergency Contact Name and Phone (Optional)			
<input type="checkbox"/> <b>Check if this is the first ASFA trial for this hound. Attach a Hound Certification or waiver if entered in Open, Veterans, Limited.</b> <input type="checkbox"/> <b>Check if this is a first-time entry, a copy of the official Registration of this hound must accompany this entry unless NGA.</b> <input type="checkbox"/> Check if any information has changed since the last ASFA trial entry. Regarding _____ <input type="checkbox"/> Check if this hound has been dismissed within the last 6 trials entered. Must be marked in order to qualify for a "clean" trial requirement.			

I CERTIFY that I am the actual owner of this dog, or that I am the duly authorized agent of the actual owner whose name I have entered above. In consideration of the acceptance of this entry and the opportunity to have this dog judged and to win prize money, ribbons, or trophies, I (we) agree to abide by the rules and regulations of the American Sighthound Field Association in effect at the time of this lure field trial, and by any additional rules and regulations appearing in the premium list for this lure field trial. I (we) agree that the club holding this lure field trial has the right to refuse this entry for cause, which the club shall deem to be sufficient. I (we) agree to hold this club, its members, directors, governors, officers, agents or other functionaries, any employees of the aforementioned parties and the owner(s) of the trial premises or grounds harmless from any claim for loss or injury which may be alleged to have been caused directly or indirectly to any person or thing by the act of this dog while in or upon the lure field trial premises or grounds or near any entrance thereto and I (we) personally assume all responsibility and liability for any such claim, and I (we) further agree to hold the aforementioned parties harmless from any claim loss of this dog by disappearance, theft damage or injury be caused or alleged to be caused by the negligence of the club or any of the aforementioned parties or by the negligence of any person or any other cause or causes. I (we) certify and represent that the dog entered is not a hazard to person or other dogs. This entry is submitted for acceptance of the forgoing representations and agreements.

**SIGNATURE** of owner or his agent  
 duly authorized to make this entry \_\_\_\_\_

**Please separate the entries before submitting to FTS.**

**OFFICIAL AMERICAN SIGHTHOUND FIELD ASSOCIATION ENTRY FORM**  
**COLORADO LURE COURSING ASSOCIATION ALL BREED ASFA LURE FIELD TRIAL**  
**SATURDAY July 16, 2022 – REGION 3 INVITATIONAL**  
**FALCON INSTITUTE FOR ADVANCED COURSING STUDIES, FALCON, COLORADO**  
**EARLY ENTRIES: 17.00 1<sup>ST</sup> hound, \$14.00 2<sup>ND</sup> and \$12.00 each additional hound entered by same owner.**  
**DAY OF ENTRIES 25.00 per hound; close at 7:30 A.M. at FTS TABLE**  
**Payable in US funds. Make checks payable to CLCA and mail with completed entry form to:**  
**Darci Kunard, 17531 E 104<sup>th</sup> Pl, Reunion, CO 80022**

Fee Paid \_\_\_\_\_ The Field Secretary cannot accept conditional, unsigned, incomplete or unpaid entries; please check your completed entry carefully

Breed:		Call Name:	
Registered Name of Hound:			
Stake: <input type="checkbox"/> Open <input type="checkbox"/> FCH <input type="checkbox"/> Veteran <input type="checkbox"/> Single <input type="checkbox"/> Provisional		Additional Stakes <input type="checkbox"/> Kennel <input type="checkbox"/> Breeder <input type="checkbox"/> Bench	
<b>Registration Number:</b> (please write in registering body before number)			
<input type="checkbox"/> If possible, please separate my hounds		Date of Birth:	Sex: <input type="checkbox"/> Dog <input type="checkbox"/> Bitch
Name of actual owner(s):			
Address:		Phone:	
City:		State:	Zip:
E-mail (Optional)		(Optional ) Region of Residence:	
Emergency Contact Name and Phone (Optional)			
<input type="checkbox"/> <b>Check if this is the first ASFA trial for this hound. Attach a Hound Certification or waiver if entered in Open, Veterans, Limited.</b> <input type="checkbox"/> <b>Check if this is a first-time entry, a copy of the official Registration of this hound must accompany this entry unless NGA.</b> <input type="checkbox"/> Check if any information has changed since the last ASFA trial entry. Regarding _____ <input type="checkbox"/> Check if this hound has been dismissed within the last 6 trials entered. Must be marked in order to qualify for a "clean" trial requirement.			

I CERTIFY that I am the actual owner of this dog, or that I am the duly authorized agent of the actual owner whose name I have entered above. In consideration of the acceptance of this entry and the opportunity to have this dog judged and to win prize money, ribbons, or trophies, I (we) agree to abide by the rules and regulations of the American Sighthound Field Association in effect at the time of this lure field trial, and by any additional rules and regulations appearing in the premium list for this lure field trial. I (we) agree that the club holding this lure field trial has the right to refuse this entry for cause, which the club shall deem to be sufficient. I (we) agree to hold this club, its members, directors, governors, officers, agents or other functionaries, any employees of the aforementioned parties and the owner(s) of the trial premises or grounds harmless from any claim for loss or injury which may be alleged to have been caused directly or indirectly to any person or thing by the act of this dog while in or upon the lure field trial premises or grounds or near any entrance thereto and I (we) personally assume all responsibility and liability for any such claim, and I (we) further agree to hold the aforementioned parties harmless from any claim loss of this dog by disappearance, theft damage or injury be caused or alleged to be caused by the negligence of the club or any of the aforementioned parties or by the negligence of any person or any other cause or causes. I (we) certify and represent that the dog entered is not a hazard to person or other dogs. This entry is submitted for acceptance of the forgoing representations and agreements.

**SIGNATURE** of owner or his agent  
 duly authorized to make this entry \_\_\_\_\_

**Please separate the entries before submitting to FTS.**

**OFFICIAL AMERICAN SIGHTHOUND FIELD ASSOCIATION ENTRY FORM**  
**COLORADO LURE COURSING ASSOCIATION ALL BREED ASFA LURE FIELD TRIAL**

**SUNDAY July 17, 2022**

FALCON INSTITUTE FOR ADVANCED COURSING STUDIES, FALCON, COLORADO  
 EARLY ENTRIES: 17.00 1<sup>ST</sup> hound, \$14.00 2<sup>ND</sup> and \$12.00 each additional hound entered by same owner.

DAY OF ENTRIES 25.00 per hound; close at 7:30 A.M. at FTS TABLE

Payable in US funds. Make checks payable to CLCA and mail with completed entry form to:

**Darci Kunard, 17531 E 104<sup>th</sup> Pl, Reunion, CO 80022**

Fee Paid \_\_\_\_\_ The Field Secretary cannot accept conditional, unsigned, incomplete or unpaid entries; please check your completed entry carefully

Breed:		Call Name:	
Registered Name of Hound:			
Stake: <input type="checkbox"/> Open <input type="checkbox"/> FCH <input type="checkbox"/> Veteran <input type="checkbox"/> Single <input type="checkbox"/> Provisional		Additional Stakes <input type="checkbox"/> Kennel <input type="checkbox"/> Breeder <input type="checkbox"/> Bench	
Registration Number: (please write in registering body before number)			
<input type="checkbox"/> If possible, please separate my hounds		Date of Birth:	Sex: <input type="checkbox"/> Dog <input type="checkbox"/> Bitch
Name of actual owner(s):			
Address:		Phone:	
City:		State:	Zip:
E-mail (Optional)		(Optional) Region of Residence:	
Emergency Contact Name and Phone (Optional)			
<input type="checkbox"/> Check if this is the first ASFA trial for this hound. Attach a Hound Certification or waiver if entered in Open, Veterans, Limited.			
<input type="checkbox"/> Check if this is a first-time entry, a copy of the official Registration of this hound must accompany this entry unless NGA.			
<input type="checkbox"/> Check if any information has changed since the last ASFA trial entry. Regarding _____			
<input type="checkbox"/> Check if this hound has been dismissed within the last 6 trials entered. Must be marked in order to qualify for a "clean" trial requirement.			

I CERTIFY that I am the actual owner of this dog, or that I am the duly authorized agent of the actual owner whose name I have entered above. In consideration of the acceptance of this entry and the opportunity to have this dog judged and to win prize money, ribbons, or trophies, I (we) agree to abide by the rules and regulations of the American Sighthound Field Association in effect at the time of this lure field trial, and by any additional rules and regulations appearing in the premium list for this lure field trial. I (we) agree that the club holding this lure field trial has the right to refuse this entry for cause, which the club shall deem to be sufficient. I (we) agree to hold this club, its members, directors, governors, officers, agents or other functionaries, any employees of the aforementioned parties and the owner(s) of the trial premises or grounds harmless from any claim for loss or injury which may be alleged to have been caused directly or indirectly to any person or thing by the act of this dog while in or upon the lure field trial premises or grounds or near any entrance thereto and I (we) personally assume all responsibility and liability for any such claim, and I (we) further agree to hold the aforementioned parties harmless from any claim loss of this dog by disappearance, theft damage or injury be caused or alleged to be caused by the negligence of the club or any of the aforementioned parties or by the negligence of any person or any other cause or causes. I (we) certify and represent that the dog entered is not a hazard to person or other dogs. This entry is submitted for acceptance of the forgoing representations and agreements.

**SIGNATURE** of owner or his agent  
 duly authorized to make this entry \_\_\_\_\_

**Please separate the entries before submitting to FTS.**

**OFFICIAL AMERICAN SIGHTHOUND FIELD ASSOCIATION ENTRY FORM**  
**COLORADO LURE COURSING ASSOCIATION ALL BREED ASFA LURE FIELD TRIAL**

**SUNDAY July 17, 2022**

FALCON INSTITUTE FOR ADVANCED COURSING STUDIES, FALCON, COLORADO  
 EARLY ENTRIES: 17.00 1<sup>ST</sup> hound, \$14.00 2<sup>ND</sup> and \$12.00 each additional hound entered by same owner.

DAY OF ENTRIES 25.00 per hound; close at 7:30 A.M. at FTS TABLE

Payable in US funds. Make checks payable to CLCA and mail with completed entry form to:

**Darci Kunard, 17531 E 104<sup>th</sup> Pl, Reunion, CO 80022**

Fee Paid \_\_\_\_\_ The Field Secretary cannot accept conditional, unsigned, incomplete or unpaid entries; please check your completed entry carefully

Breed:		Call Name:	
Registered Name of Hound:			
Stake: <input type="checkbox"/> Open <input type="checkbox"/> FCH <input type="checkbox"/> Veteran <input type="checkbox"/> Single <input type="checkbox"/> Provisional		Additional Stakes <input type="checkbox"/> Kennel <input type="checkbox"/> Breeder <input type="checkbox"/> Bench	
Registration Number: (please write in registering body before number)			
<input type="checkbox"/> If possible, please separate my hounds		Date of Birth:	Sex: <input type="checkbox"/> Dog <input type="checkbox"/> Bitch
Name of actual owner(s):			
Address:		Phone:	
City:		State:	Zip:
E-mail (Optional)		(Optional) Region of Residence:	
Emergency Contact Name and Phone (Optional)			
<input type="checkbox"/> Check if this is the first ASFA trial for this hound. Attach a Hound Certification or waiver if entered in Open, Veterans, Limited.			
<input type="checkbox"/> Check if this is a first-time entry, a copy of the official Registration of this hound must accompany this entry unless NGA.			
<input type="checkbox"/> Check if any information has changed since the last ASFA trial entry. Regarding _____			
<input type="checkbox"/> Check if this hound has been dismissed within the last 6 trials entered. Must be marked in order to qualify for a "clean" trial requirement.			

I CERTIFY that I am the actual owner of this dog, or that I am the duly authorized agent of the actual owner whose name I have entered above. In consideration of the acceptance of this entry and the opportunity to have this dog judged and to win prize money, ribbons, or trophies, I (we) agree to abide by the rules and regulations of the American Sighthound Field Association in effect at the time of this lure field trial, and by any additional rules and regulations appearing in the premium list for this lure field trial. I (we) agree that the club holding this lure field trial has the right to refuse this entry for cause, which the club shall deem to be sufficient. I (we) agree to hold this club, its members, directors, governors, officers, agents or other functionaries, any employees of the aforementioned parties and the owner(s) of the trial premises or grounds harmless from any claim for loss or injury which may be alleged to have been caused directly or indirectly to any person or thing by the act of this dog while in or upon the lure field trial premises or grounds or near any entrance thereto and I (we) personally assume all responsibility and liability for any such claim, and I (we) further agree to hold the aforementioned parties harmless from any claim loss of this dog by disappearance, theft damage or injury be caused or alleged to be caused by the negligence of the club or any of the aforementioned parties or by the negligence of any person or any other cause or causes. I (we) certify and represent that the dog entered is not a hazard to person or other dogs. This entry is submitted for acceptance of the forgoing representations and agreements.

**SIGNATURE** of owner or his agent  
 duly authorized to make this entry \_\_\_\_\_

**Please separate the entries before submitting to FTS.**

**OFFICIAL AMERICAN SIGHTHOUND FIELD ASSOCIATION**

**LCI ENTRY FORM**

COLORADO LURE COURSING ASSOCIATION ALL BREED ASFA LURE FIELD TRIAL

FRIDAY July 15, 2022 **- LIMIT 15 DOGS TOTAL**

FALCON INSTITUTE FOR ADVANCED COURSING STUDIES, FALCON, COLORADO

EARLY ENTRIES: 17.00 1<sup>ST</sup> hound, \$14.00 2<sup>ND</sup> and \$12.00 each additional hound entered by same owner.

DAY OF ENTRIES 25.00 per hound; close at 7:30 A.M. at FTS TABLE

Payable in US funds. Make checks payable to CLCA and mail with completed entry form to:

**Darci Kunard, 17531 E 104<sup>th</sup> Pl, Reunion, CO 80022**

Fee Paid \_\_\_\_\_ The Field Secretary cannot accept conditional, unsigned, incomplete or unpaid entries; please check your completed entry carefully.

Breed:		Call Name:	
Registered Name of dog:			
Stake: <input type="checkbox"/> LCI-Small <input type="checkbox"/> LCI-Large <input type="checkbox"/> LCI-Sighthound Mix <input type="checkbox"/> Open <input type="checkbox"/> Senior <input type="checkbox"/> Veteran			
Registration Number: (please write in registering body before number)			
Date of Birth:		Sex: <input type="checkbox"/> Dog <input type="checkbox"/> Bitch	
Name of actual owner(s):			
Address:		Phone:	
City:		State:	Zip:
E-mail		(Optional) Region of Residence:	
Emergency Contact Name and Phone (Optional)			
<input type="checkbox"/> Check if this is a first-time entry, a copy of the official Registration of this hound must accompany this entry. (i.e., AKC Registration form, PAL registration, Canine Partner, etc.)			
<input type="checkbox"/> Check if any information has changed since the last ASFA trial entry. Regarding _____			

I CERTIFY that I am the actual owner of this dog, or that I am the duly authorized agent of the actual owner whose name I have entered above. In consideration of the acceptance of this entry and the opportunity to have this dog judged and to win prize money, ribbons, or trophies, I (we) agree to abide by the rules and regulations of the American Sighthound Field Association in effect at the time of this lure field trial, and by any additional rules and regulations appearing in the premium list for this lure field trial. I (we) agree that the club holding this lure field trial has the right to refuse this entry for cause, which the club shall deem to be sufficient. I (we) agree to hold this club, its members, directors, governors, officers, agents or other functionaries, any employees of the aforementioned parties and the owner(s) of the trial premises or grounds harmless from any claim for loss or injury which may be alleged to have been caused directly or indirectly to any person or thing by the act of this dog while in or upon the lure field trial premises or grounds or near any entrance thereto and I (we) personally assume all responsibility and liability for any such claim, and I (we) further agree to hold the aforementioned parties harmless from any claim loss of this dog by disappearance, theft damage or injury be caused or alleged to be caused by the negligence of the club or any of the aforementioned parties or by the negligence of any person or any other cause or causes. I (we) certify and represent that the dog entered is not a hazard to person or other dogs. This entry is submitted for acceptance of the forgoing representations and agreements.

**SIGNATURE** of owner or his agent  
duly authorized to make this entry \_\_\_\_\_

**Please separate the entries before submitting to FTS.**

**OFFICIAL AMERICAN SIGHTHOUND FIELD ASSOCIATION**

**LCI ENTRY FORM**

COLORADO LURE COURSING ASSOCIATION ALL BREED ASFA LURE FIELD TRIAL

FRIDAY July 15, 2022 **- LIMIT 15 DOGS TOTAL**

FALCON INSTITUTE FOR ADVANCED COURSING STUDIES, FALCON, COLORADO

EARLY ENTRIES: 17.00 1<sup>ST</sup> hound, \$14.00 2<sup>ND</sup> and \$12.00 each additional hound entered by same owner.

DAY OF ENTRIES 25.00 per hound; close at 7:30 A.M. at FTS TABLE

Payable in US funds. Make checks payable to CLCA and mail with completed entry form to:

**Darci Kunard, 17531 E 104<sup>th</sup> Pl, Reunion, CO 80022**

Fee Paid \_\_\_\_\_ The Field Secretary cannot accept conditional, unsigned, incomplete or unpaid entries; please check your completed entry carefully.

Breed:		Call Name:	
Registered Name of dog:			
Stake: <input type="checkbox"/> LCI-Small <input type="checkbox"/> LCI-Large <input type="checkbox"/> LCI-Sighthound Mix <input type="checkbox"/> Open <input type="checkbox"/> Senior <input type="checkbox"/> Veteran			
Registration Number: (please write in registering body before number)			
Date of Birth:		Sex: <input type="checkbox"/> Dog <input type="checkbox"/> Bitch	
Name of actual owner(s):			
Address:		Phone:	
City:		State:	Zip:
E-mail		(Optional) Region of Residence:	
Emergency Contact Name and Phone (Optional)			
<input type="checkbox"/> Check if this is a first-time entry, a copy of the official Registration of this hound must accompany this entry. (i.e., AKC Registration form, PAL registration, Canine Partner, etc.)			
<input type="checkbox"/> Check if any information has changed since the last ASFA trial entry. Regarding _____			

I CERTIFY that I am the actual owner of this dog, or that I am the duly authorized agent of the actual owner whose name I have entered above. In consideration of the acceptance of this entry and the opportunity to have this dog judged and to win prize money, ribbons, or trophies, I (we) agree to abide by the rules and regulations of the American Sighthound Field Association in effect at the time of this lure field trial, and by any additional rules and regulations appearing in the premium list for this lure field trial. I (we) agree that the club holding this lure field trial has the right to refuse this entry for cause, which the club shall deem to be sufficient. I (we) agree to hold this club, its members, directors, governors, officers, agents or other functionaries, any employees of the aforementioned parties and the owner(s) of the trial premises or grounds harmless from any claim for loss or injury which may be alleged to have been caused directly or indirectly to any person or thing by the act of this dog while in or upon the lure field trial premises or grounds or near any entrance thereto and I (we) personally assume all responsibility and liability for any such claim, and I (we) further agree to hold the aforementioned parties harmless from any claim loss of this dog by disappearance, theft damage or injury be caused or alleged to be caused by the negligence of the club or any of the aforementioned parties or by the negligence of any person or any other cause or causes. I (we) certify and represent that the dog entered is not a hazard to person or other dogs. This entry is submitted for acceptance of the forgoing representations and agreements.

**SIGNATURE** of owner or his agent  
duly authorized to make this entry \_\_\_\_\_

**Please separate the entries before submitting to FTS.**

**OFFICIAL AMERICAN SIGHTHOUND FIELD ASSOCIATION**

**LCI ENTRY FORM**

COLORADO LURE COURSING ASSOCIATION ALL BREED ASFA LURE FIELD TRIAL

SUNDAY July 17, 2022 **- LIMIT 15 DOGS TOTAL**

FALCON INSTITUTE FOR ADVANCED COURSING STUDIES, FALCON, COLORADO

EARLY ENTRIES: 17.00 1<sup>ST</sup> hound, \$14.00 2<sup>ND</sup> and \$12.00 each additional hound entered by same owner.

DAY OF ENTRIES 25.00 per hound; close at 7:30 A.M. at FTS TABLE

Payable in US funds. Make checks payable to CLCA and mail with completed entry form to:

**Darci Kunard, 17531 E 104<sup>th</sup> Pl, Reunion, CO 80022**

Fee Paid \_\_\_\_\_ The Field Secretary cannot accept conditional, unsigned, incomplete or unpaid entries; please check your completed entry carefully.

Breed:		Call Name:	
Registered Name of dog:			
Stake: <input type="checkbox"/> LCI-Small <input type="checkbox"/> LCI-Large <input type="checkbox"/> LCI-Sighthound Mix <input type="checkbox"/> Open <input type="checkbox"/> Senior <input type="checkbox"/> Veteran			
Registration Number: (please write in registering body before number)			
Date of Birth:		Sex: <input type="checkbox"/> Dog <input type="checkbox"/> Bitch	
Name of actual owner(s):			
Address:		Phone:	
City:		State:	Zip:
E-mail		(Optional) Region of Residence:	
Emergency Contact Name and Phone (Optional)			
<input type="checkbox"/> Check if this is a first-time entry, a copy of the official Registration of this hound must accompany this entry. (i.e., AKC Registration form, PAL registration, Canine Partner, etc.)			
<input type="checkbox"/> Check if any information has changed since the last ASFA trial entry. Regarding _____			

I CERTIFY that I am the actual owner of this dog, or that I am the duly authorized agent of the actual owner whose name I have entered above. In consideration of the acceptance of this entry and the opportunity to have this dog judged and to win prize money, ribbons, or trophies, I (we) agree to abide by the rules and regulations of the American Sighthound Field Association in effect at the time of this lure field trial, and by any additional rules and regulations appearing in the premium list for this lure field trial. I (we) agree that the club holding this lure field trial has the right to refuse this entry for cause, which the club shall deem to be sufficient. I (we) agree to hold this club, its members, directors, governors, officers, agents or other functionaries, any employees of the aforementioned parties and the owner(s) of the trial premises or grounds harmless from any claim for loss or injury which may be alleged to have been caused directly or indirectly to any person or thing by the act of this dog while in or upon the lure field trial premises or grounds or near any entrance thereto and I (we) personally assume all responsibility and liability for any such claim, and I (we) further agree to hold the aforementioned parties harmless from any claim loss of this dog by disappearance, theft damage or injury be caused or alleged to be caused by the negligence of the club or any of the aforementioned parties or by the negligence of any person or any other cause or causes. I (we) certify and represent that the dog entered is not a hazard to person or other dogs. This entry is submitted for acceptance of the forgoing representations and agreements.

**SIGNATURE** of owner or his agent  
duly authorized to make this entry \_\_\_\_\_

**Please separate the entries before submitting to FTS.**

**OFFICIAL AMERICAN SIGHTHOUND FIELD ASSOCIATION**

**LCI ENTRY FORM**

COLORADO LURE COURSING ASSOCIATION ALL BREED ASFA LURE FIELD TRIAL

SUNDAY July 17, 2022 **- LIMIT 15 DOGS TOTAL**

FALCON INSTITUTE FOR ADVANCED COURSING STUDIES, FALCON, COLORADO

EARLY ENTRIES: 17.00 1<sup>ST</sup> hound, \$14.00 2<sup>ND</sup> and \$12.00 each additional hound entered by same owner.

DAY OF ENTRIES 25.00 per hound; close at 7:30 A.M. at FTS TABLE

Payable in US funds. Make checks payable to CLCA and mail with completed entry form to:

**Darci Kunard, 17531 E 104<sup>th</sup> Pl, Reunion, CO 80022**

Fee Paid \_\_\_\_\_ The Field Secretary cannot accept conditional, unsigned, incomplete or unpaid entries; please check your completed entry carefully.

Breed:		Call Name:	
Registered Name of dog:			
Stake: <input type="checkbox"/> LCI-Small <input type="checkbox"/> LCI-Large <input type="checkbox"/> LCI-Sighthound Mix <input type="checkbox"/> Open <input type="checkbox"/> Senior <input type="checkbox"/> Veteran			
Registration Number: (please write in registering body before number)			
Date of Birth:		Sex: <input type="checkbox"/> Dog <input type="checkbox"/> Bitch	
Name of actual owner(s):			
Address:		Phone:	
City:		State:	Zip:
E-mail		(Optional) Region of Residence:	
Emergency Contact Name and Phone (Optional)			
<input type="checkbox"/> Check if this is a first-time entry, a copy of the official Registration of this hound must accompany this entry. (i.e., AKC Registration form, PAL registration, Canine Partner, etc.)			
<input type="checkbox"/> Check if any information has changed since the last ASFA trial entry. Regarding _____			

I CERTIFY that I am the actual owner of this dog, or that I am the duly authorized agent of the actual owner whose name I have entered above. In consideration of the acceptance of this entry and the opportunity to have this dog judged and to win prize money, ribbons, or trophies, I (we) agree to abide by the rules and regulations of the American Sighthound Field Association in effect at the time of this lure field trial, and by any additional rules and regulations appearing in the premium list for this lure field trial. I (we) agree that the club holding this lure field trial has the right to refuse this entry for cause, which the club shall deem to be sufficient. I (we) agree to hold this club, its members, directors, governors, officers, agents or other functionaries, any employees of the aforementioned parties and the owner(s) of the trial premises or grounds harmless from any claim for loss or injury which may be alleged to have been caused directly or indirectly to any person or thing by the act of this dog while in or upon the lure field trial premises or grounds or near any entrance thereto and I (we) personally assume all responsibility and liability for any such claim, and I (we) further agree to hold the aforementioned parties harmless from any claim loss of this dog by disappearance, theft damage or injury be caused or alleged to be caused by the negligence of the club or any of the aforementioned parties or by the negligence of any person or any other cause or causes. I (we) certify and represent that the dog entered is not a hazard to person or other dogs. This entry is submitted for acceptance of the forgoing representations and agreements.

**SIGNATURE** of owner or his agent  
duly authorized to make this entry \_\_\_\_\_

**Please separate the entries before submitting to FTS.**





**AMERICAN SIGHTHOUND FIELD ASSOCIATION  
HOUND CERTIFICATION**

**Rule effective October 1, 1994: Ch. V, Sec. 4 (a) OPEN STAKE:** *To be eligible to enter the open stake, a hound must have been certified by a licensed judge within the year preceding the closing date for the entry or have previously competed in the Open Stake. This eligibility requirement also applies to a hound entered in the Veteran Stake, which has not competed in Open previously. Please complete this portion of this form and attach it to the entry form for the hound's first entry, including an entry for a Fun Trial.*

Registered Name of Hound: \_\_\_\_\_

Registration Number: \_\_\_\_\_ Breed: \_\_\_\_\_

Registered Owner's Name: \_\_\_\_\_

I hereby certify that on (date) \_\_\_\_\_, the above named hound completed a lure course of at least 500 yards, running with another hound of the same breed (or another breed with a similar running style). During the course the above named hound showed no inclination to interfere with the other hound. I further certify that I am a licensed judge for the ASFA.

Name of Licensed Judge: \_\_\_\_\_

Signature: \_\_\_\_\_ Date: \_\_\_\_\_

I hereby certify that the hound running in the certification course is the hound identified above and that information provided on this form is true and correct.

Signature: \_\_\_\_\_ Date: \_\_\_\_\_

**Owner or Authorized Agent of Hound**

This certification form must be attached to the entry form the first time this hound is entered in an open or veteran stake. Any hound entered in open, or veteran (as a first time entered hound), which has not been certified, shall be declared ineligible by the records coordinator and shall forfeit any points and placements awarded.

**PLEASE RETAIN A COPY FOR YOUR RECORDS.**

**AMERICAN SIGHTHOUND FIELD ASSOCIATION  
HOUND CERTIFICATION WAIVER**

**Waiver of Requirement:** *This requirement will be waived for a hound that has earned a lure coursing title from another recognized organization, if such title requires competition, and if a waiver for such title has been approved by the ASFA, or a CKC Hound Certification Form. If your hound qualifies for a waiver, complete this portion of this form and attach it to your entry form. Proof of waivers must accompany this certification form.*

Registered Name of Hound: \_\_\_\_\_

Registration Number: \_\_\_\_\_ Breed: \_\_\_\_\_

Registered Owner's Name: \_\_\_\_\_

**CKC:** FCH FCHX

**AKC:** QC SC FC

Hound Certification previously submitted.

I hereby certify that the hound identified above has completed the requirements for the title indicated above (or that the required Certification was previously submitted) and that the information provided on this form is true and correct.

Signature: \_\_\_\_\_ Date: \_\_\_\_\_

Owner or Authorized Agent of Hound

**AMERICAN SIGHTHOUND FIELD ASSOCIATION  
HOUND CERTIFICATION**

**Rule effective October 1, 1994: Ch. V, Sec. 4 (a) OPEN STAKE:** *To be eligible to enter the open stake, a hound must have been certified by a licensed judge within the year preceding the closing date for the entry or have previously competed in the Open Stake. This eligibility requirement also applies to a hound entered in the Veteran Stake, which has not competed in Open previously. Please complete this portion of this form and attach it to the entry form for the hound's first entry, including an entry for a Fun Trial.*

Registered Name of Hound: \_\_\_\_\_

Registration Number: \_\_\_\_\_ Breed: \_\_\_\_\_

Registered Owner's Name: \_\_\_\_\_

I hereby certify that on (date) \_\_\_\_\_, the above named hound completed a lure course of at least 500 yards, running with another hound of the same breed (or another breed with a similar running style). During the course the above named hound showed no inclination to interfere with the other hound. I further certify that I am a licensed judge for the ASFA.

Name of Licensed Judge: \_\_\_\_\_

Signature: \_\_\_\_\_ Date: \_\_\_\_\_

I hereby certify that the hound running in the certification course is the hound identified above and that information provided on this form is true and correct.

Signature: \_\_\_\_\_ Date: \_\_\_\_\_

**Owner or Authorized Agent of Hound**

This certification form must be attached to the entry form the first time this hound is entered in an open or veteran stake. Any hound entered in open or veteran (as a first time entered hound), which has not been certified, shall be declared ineligible by the records coordinator and shall forfeit any points and placements awarded.

**PLEASE RETAIN A COPY FOR YOUR RECORDS.**

**AMERICAN SIGHTHOUND FIELD ASSOCIATION  
HOUND CERTIFICATION WAIVER**

**Waiver of Requirement:** *This requirement will be waived for a hound that has earned a lure coursing title from another recognized organization, if such title requires competition, and if a waiver for such title has been approved by the ASFA, or a CKC Hound Certification Form. If your hound qualifies for a waiver, complete this portion of this form and attach it to your entry form. Proof of waivers must accompany this certification form.*

Registered Name of Hound: \_\_\_\_\_

Registration Number: \_\_\_\_\_ Breed: \_\_\_\_\_

Registered Owner's Name: \_\_\_\_\_

**CKC:** FCH FCHX

**AKC:** QC SC FC

Hound Certification previously submitted.

I hereby certify that the hound identified above has completed the requirements for the title indicated above (or that the required Certification was previously submitted) and that the information provided on this form is true and correct.

Signature: \_\_\_\_\_ Date: \_\_\_\_\_

Owner or Authorized Agent of Hound