

# COLORADO LURE COURSING ASSOCIATION

Deann Britton, Field Trial Secretary

PO Box 440847

Aurora, CO 80044



## DIRECTIONS TO THE FIELD

**From I-25 North or South:** Take Woodmen Road Exit and travel east to Highway 24. Turn Right on Highway 24 and then turn Left on Meridian. Go to stop sign and then Turn Left on Falcon Highway. Turn Left in drive way at 16380 Falcon Highway.

## PREMIUM LIST

**EARLY ENTRIES** close on Wed., APRIL 3, 2013 at 6:00pm at FTS address.

**DAY OF TRIAL ENTRIES** close at 9:15 am the day of the trial at the FTS desk.

(Substitutions for lame hounds or bitches in season will be allowed prior to closing time on the day of the trial. Owner of the substituted hound must be the same as the hound already entered.)

### REGION 3 ASFA SANCTIONED ALL BREED LURE FIELD TRIAL



**COLORADO LURE COURSING ASSOCIATION**

**Saturday APRIL 6, 2013 and  
Sunday APRIL 7, 2013**

**FALCON INSTITUTE FOR ADVANCED COURSING STUDIES  
16380 FALCON HIGHWAY  
FALCON, COLORADO, 80831**

#### EARLY ENTRY FEES:

1<sup>st</sup> Trial hound - \$17 for first; \$14 each additional hound entered by same owner.

**Day of trial entry: \$20.00 per hound**

**Certification run \$7.00 per hound Practice run \$5.00 per hound**

*For an additional fee of \$2.00, you may submit entries electronically. Send your payment via your PayPal account to: [deann.ccatreasurer@gmail.com](mailto:deann.ccatreasurer@gmail.com), then e-mail your signed, completed entry forms as a Word or PDF document to: FTS DEANN BRITTON: [rahwynd@yahoo.com](mailto:rahwynd@yahoo.com) along with a copy of your PayPal e-mail receipt.*

**The original signed, completed entry form must be handed to the FTS on the day of the trial.**

Permission has been granted by the American Sighthound Field Association for the holding of this event under American Sighthound Field Association Rules and Regulations

## COLORADO LURE COURSING ASSOCIATION

### OFFICERS AND DIRECTORS

President	Peter Lowe
Vice President	Connie Sullivan
Recording Secretary	Darci Kunard
Corresponding Secretary	Shelley Hood
Treasurer	Deann Britton
Directors-at-Large:	Tom Golcher
	Kathy Dykstra
	Dan Heidel
	Mickey Rubin
	Pete Sorenson
	Renate Roder

### JUDGES (AND THEIR ASSIGNMENTS)

Frank Cassano, P O Box 235, LaSalle, CO 80645  
Tom Golcher, 2115 Curtis Rd. Peyton, CO 80831  
Mike Hussey, 36895 View Ridge Dr, Elizabeth, CO 80107  
Claudia Miller, 8205 W 67<sup>th</sup> Pl, Arvada, CO 80004  
\*- Provisional judge S – Single judge

### SATURDAY

JUDGE	A	Az	Ba	B	C	G	lb	IW	IG	P	RR	S	SD	SI	SW	W	Ltd	Sin
Frank	X	X	X	X	X	X	X	X	X	X						X	X	X
Mike	X	X	X	X	X	X	X	X	X	X	S	S	S	S	S	X	X	X

### SUNDAY

JUDGE	A	Az	Ba	B	C	G	lb	IW	IG	P	RR	S	SD	SI	SW	W	Ltd	Sin
Tom	X		X			*	X	X	*	X	X	*				X	X	X
Claudia	X	S	X	S	S	X	X	X	X	X	X	X	S	S	S	X	X	X

### FIELD COMMITTEE

Field Chairman	Connie Sullivan, 303-690-1677, <a href="mailto:cesullivan@comcast.net">cesullivan@comcast.net</a>
Field Secretary	Deann Britton, 303-367-2077 PO Box 440847, Aurora, CO 80044 email <a href="mailto:rahwynd@yahoo.com">rahwynd@yahoo.com</a>
Lure Operators	F Cassano, T Golcher, P Lowe, C Sullivan, T Ward
Clerks	D Britton, C Day, R Roder, T Ward
Huntmaster	P Lowe, M Rubin, T Ward
Inspection & Paddock	R Roder, KC Thompson, T Ward

### RIBBON PRIZES (Trophies will be awarded for BEST OF BREED)

First Place - Blue; Second Place - Red;  
Third Place - Yellow; Fourth Place - White;  
NBQ (Next Best Qualified) - Dark Green. Singles – Blue/Gold  
Best of Breed - Purple & Gold Rosette.

### TRIAL HOURS: 8:30 a.m. UNTIL COMPLETED.

Day of trial entries Close at 9:15 a.m.

ROLL CALL: PROMPTLY AT 9:30A.M.

DRAW: 9:45 A.M.

Any hound not present at Roll Call will be scratched and entry fee will not be refunded.

### ELIGIBLE BREEDS & REGISTRY

Only purebred Afghan Hounds, Azawakhs, Basenjis, Borzoi, Cirneco dell'Etna, Greyhounds, Ibizan Hounds, Irish Wolfhounds, Italian Greyhounds, Pharaoh Hounds, Rhodesian Ridgebacks, Salukis, Scottish Deerhounds, Sloughis, Whippets, and Provisional breeds may be entered in the regular stakes. Current Provisional breed: Silken Windhound. Limited breeds may be entered in the Limited Stake or the Singles Stake. Limited breeds currently include purebred Chart Polski, Galgo Español, Magyar Agar, Peruvian Inca Orchid, Portuguese Podengo (Pequeno), Portuguese Podengo (Medio & Grande), and must be individually registered with the appropriate registry.

All entries shall be individually registered with the AKC (including ILP & PAL), the NGA, the UKC, the FCI, an ASFA-recognized foreign or ASFA Board approved registry, or possess a CRN from the SPDBS. A photocopy of acceptable registry must be submitted with each hound's first ASFA field trial entry; this requirement is waived for hounds registered with the NGA.

ENTRIES WILL NOT BE ACKNOWLEDGED BY MAIL OR TELEPHONE. LATE, INCOMPLETE, UNSIGNED OR CONDITIONAL ENTRIES WILL NOT BE ACCEPTED. ENTRIES PAID VIA PAYPAL MUST BE SIGNED AND EMAILED TO THE FTS.

### STAKES OFFERED:

OPEN - Any eligible sighthound, excluding ASFA Field Champions of record that has met ASFA Certification requirements.

VETERAN - Any eligible sighthound which is 6 years or older on the day of the trial, except Irish Wolfhounds whose age shall be 5 years; and Afghan Hounds, Rhodesian Ridgebacks and Whippets whose age shall be at least 7 years of age and has met ASFA certification requirements.

FIELD CHAMPION - Any ASFA Field Champion.

SINGLE - Any eligible sighthound including those disqualified to run in other stakes. Not eligible for Best of Breed or Best in Field. Hounds are eligible to earn TCP and CPX titles from the Singles stake. Limited breeds are not eligible for these titles.

LIMITED - Any eligible sighthound of an eligible Limited or Provisional stake that has met certification requirements.

### **BEST IN FIELD WILL BE OFFERED SATURDAY ONLY**

### GENERAL INFORMATION

PLEASE READ CAREFULLY AS THERE ARE SOME NEW RULES

### GENERAL INFORMATION

Conditions of Entry: All entries must be one year or older on the day of the trial. Stakes will be split into flights by public random draw if the entry in any regular stake is 20 or more. Bitches in season, lame hounds and hounds with breed disqualifications will be excused at roll call. Spayed, neutered, monorchid or cryptorchid hounds without breed disqualifications may be entered; hounds with breed disqualifications are not eligible to enter except in the Single Stake. Hounds not present at the time of roll call will be scratched. All hounds will run twice, in trios if possible or braces (except in the Single Stake), unless excused, dismissed or disqualified.

EQUIPMENT: Type of lure machine: battery-powered continuous-loop system. Back-up equipment will be available. Type of lures: highly-visible plastic strips.

A \$20.00 fee will be assessed for any returned checks. Persons exhibiting conduct detrimental to ASFA/CLCA/ any hound(s)/other person(s) will be asked to leave the trial site.

There will be a \$5.00 fine for any owner who does not clean up after his/her hound.

A penalty of \$5.00 will be assessed for any loose hound not competing in the course in progress

### INFORMATION/POLICIES

- Port-a-potties on site.
- BRING WATER AND SHADE FOR YOUR HOUNDS.
- Veterinarian – Saturday Black Forest Veterinary Clinic 719/495-3666. Sunday and after hours Animal Emergency Care, 5520 North Nevada Ave., 719/260-7141.
- Due to dry conditions, smoking may be prohibited on the field.
- Absolutely NO CAMP FIRES!
- PICK UP AFTER YOUR DOG AND YOURSELF!
- Please include a phone number on your entries in case of bad weather.

**COURSE PLANS**

**SATURDAY APRIL 6, 2013**

700 yards; clockwise and reversed for finals. The Colorado Lure Coursing Association reserves the right to alter the course diagram as required by weather and/or field conditions on the day of the trial.

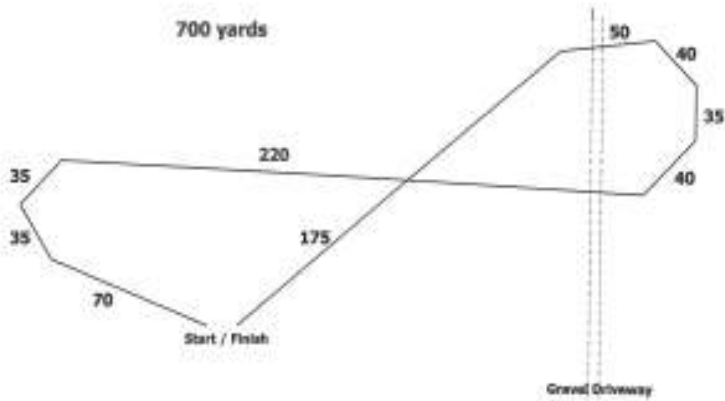

**COURSE PLANS**

**SUNDAY APRIL 7, 2013**

745 yards; clockwise and reversed for finals. The Colorado Lure Coursing Association reserves the right to alter the course diagram as required by weather and/or field conditions on the day of the trial.

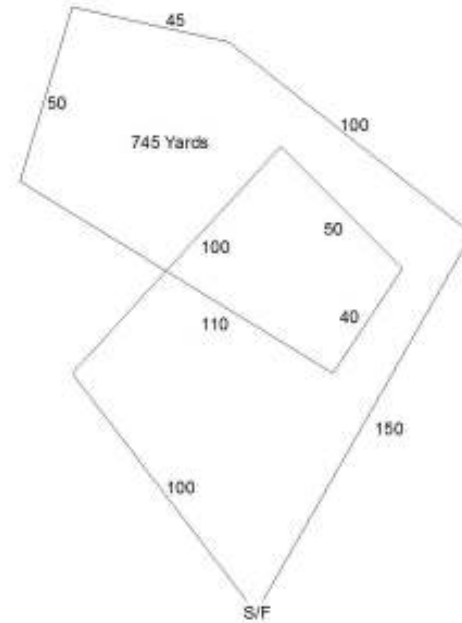

**Warning: It is advised that all hounds entered be in top physical condition due to the altitude and rigorous conditions of the course, which will be run on natural terrain and may include such hazards as rocks, trees, cactus, vegetation, gopher holes, gullies, bodies of water and other obstacles. ALL HOUNDS RUN AT THE OWNER'S SOLE RISK.**

**Saturday, APRIL 6, 2013**

**Certifications and practices will be held AFTER the CLCA trial on Saturday, WEATHER AND MACHINERY PERMITTING**

**All hounds will be inspected before running.  
Lame hounds and bitches in season may NOT run.**

**Certification:** Any entry marked "First ASFA Point Trial" Must have an ASFA Hound Certification form and a copy of the hound's registration papers, not required for NGA greyhounds, and must present them to the Field Trial Secretary along with your entry before entering a regular ASFA trial. This applies to "First ASFA point trial" hounds entered in the OPEN, VETERAN or LIMITED stake. Certification forms will be available, but MUST be completed prior to judging. Also have your hound's registration number available for the Certification Form.

**Certification:** \$7.00 Owners wishing to certify a hound for competition are responsible for arranging for a hound of the same breed, or similar running style, to run with his/her dog for the certification.

**Practices:** \$5.00 each dog

Plan on arriving to the field around 11:30am; arrive earlier if you wish to see the competition. Practices and Certs will not be run earlier than 11:30am, but may be held much later depending upon the entry in the trial.

## **Motels**

**The following will accept well behaved dogs, and are in the Colorado Springs area:**

Ramada Inn, I-25 & Hwy 24, Exit 145 – 719-633-5541

Howard Johnson, 8280 Hwy 83, Exit 150 – 719-598-6700

Super 8 Colorado Springs, 719-597-4100

Days Inn Colorado Springs, 719-266-1317

Motel 6, 3228 N. Chestnut – 719-520-5400

Camping is available at the site \$10.00 a day. Must be self-contained.

Falcon Meadow Campgrounds, 11150 Hwy 24, Falcon – 719-495-2694

(Falcon is 5 miles west of the trial sit)

Breakfast Foods Available  
For a small donation!



**Surfing the web?????**

**CHECK IT OUT!**

**CLCA's web page at:**

<http://www.CLCAonline.com>

**AMERICAN SIGHTHOUND FIELD ASSOCIATION  
HOUND CERTIFICATION**

**Rule effective FEBRUARY 1, 1994: Ch. V, Sec. 4 (a) OPEN STAKE:** *To be eligible to enter the open stake, a hound must have been certified by a licensed judge within the year preceding the closing date for the entry or have previously competed in the Open Stake.* This eligibility requirement also applies to a hound entered in the Limited or Veteran Stake, which has not competed in Open previously. Please complete this portion of this form and attach it to the entry form for the hound's first entry, including an entry for a Fun Trial.

Registered Name of Hound: \_\_\_\_\_

Registration Number: \_\_\_\_\_ Breed: \_\_\_\_\_

Registered Owner's Name: \_\_\_\_\_

I hereby certify that on (date) \_\_\_\_\_, the above named hound completed a lure course of at least 500 yards, running with another hound of the same breed (or another breed with a similar running style). During the course the above named hound showed no inclination to interfere with the other hound. I further certify that I am a licensed judge for the ASFA.

Name of Licensed Judge: \_\_\_\_\_

Signature: \_\_\_\_\_ Date: \_\_\_\_\_

I hereby certify that the hound running in the certification course is the hound identified above and that information provided on this form is true and correct.

Signature: \_\_\_\_\_ Date: \_\_\_\_\_

Owner or Authorized Agent of Hound

This certification form must be attached to the entry form the first time this hound is entered in an open, limited, or veteran stake. Any hound entered in open, limited, or veteran (as a first time entered hound), which has not been certified, shall be declared ineligible by the records coordinator and shall forfeit any points and placements awarded.

**PLEASE RETAIN A COPY FOR YOUR RECORDS.**

**AMERICAN SIGHTHOUND FIELD ASSOCIATION  
HOUND CERTIFICATION WAIVER**

**Waiver of Requirement:** *This requirement will be waived for a hound that has earned a lure coursing or racing title from another recognized organization, if such title requires competition, and if a waiver for such title has been approved by the ASFA, or a CKC Hound Certification Form. If your hound qualifies for a waiver, complete this portion of this form and attach it to your entry form. Proof of waivers must accompany this certification form.*

Registered Name of Hound: \_\_\_\_\_

Registration Number: \_\_\_\_\_ Breed: \_\_\_\_\_

Registered Owner's Name: \_\_\_\_\_

**CKC:** FCH FCHX **CWA:** ARX TRP SRA DPC

**AKC:** QC SC FC **LGRA:** GRC **NAWRA:** RCH SR

**WRA:** CR WRCH **NOTRA:** ORC OTR SORC SOR

Hound Certification previously submitted.

I hereby certify that the hound identified above has completed the requirements for the title indicated above (or that the required Certification was previously submitted) and that the information provided on this form is true and correct.

Signature: \_\_\_\_\_ Date: \_\_\_\_\_

Owner or Authorized Agent of Hound

**OFFICIAL AMERICAN SIGHTHOUND FIELD ASSOCIATION ENTRY FORM  
COLORADO LURE COURSING ASSOCIATION  
ALL BREED ASFA LURE FIELD TRIAL**

SATURDAY, APRIL 6, 2013

FALCON INSTITUTE FOR ADVANCED COURSING STUDIES, FALCON, COLORADO

EARLY ENTRIES: 17.00 first hound, \$14.00 each additional hound entered by same owner.

Early entries close Wed., APRIL 3, 2013 at 6:00 P.M. at the FTS address.

Day of trial entries close at 9:15 A.M. at the FTS desk, the day of the trial, \$20.00 per hound.

Make checks payable to CLCA and mail with completed entry form to:

Deann Britton, PO BOX 440847, Aurora, CO 80044

Fee Paid \_\_\_\_\_ The Field Secretary cannot accept conditional, unsigned, incomplete or unpaid entries; please check your completed entry carefully.

Breed:	Call Name:		
Registered Name of Hound:			
Stake: <input type="checkbox"/> Open <input type="checkbox"/> FCH <input type="checkbox"/> Veteran <input type="checkbox"/> Single <input type="checkbox"/> Limited		Additional Stakes <input type="checkbox"/> Kennel <input type="checkbox"/> Breeder <input type="checkbox"/> Bench	
Registration Number: (please write in registering body before number)			
<input type="checkbox"/> If possible, please separate my hounds	Date of Birth:	Sex: <input type="checkbox"/> Dog <input type="checkbox"/> Bitch	
Name of actual owner(s):			
Address:		Phone:	
City:	State:	Zip:	
E-mail (Optional)		(Optional) Region of Residence:	
<input type="checkbox"/> Check if this is the first ASFA trial for this hound. Attach a Hound Certification or waiver if entered in Open, Veterans, Limited.			
<input type="checkbox"/> Check if this is a first-time entry, a copy of the official Registration of this hound must accompany this entry unless NGA.			
<input type="checkbox"/> Check if any information has changed since the last ASFA trial entry. Regarding _____			
<input type="checkbox"/> Check if this hound has been dismissed within the last 6 trials entered. Must be marked in order to qualify for a "clean" trial requirement.			

I CERTIFY that I am the actual owner of this dog, or that I am the duly authorized agent of the actual owner whose name I have entered above. In consideration of the acceptance of this entry and the opportunity to have this dog judged and to win prize money, ribbons, or trophies, I (we) agree to abide by the rules and regulations of the American Sighthound Field Association in effect at the time of this lure field trial, and by any additional rules and regulations appearing in the premium list for this lure field trial. I (we) agree that the club holding this lure field trial has the right to refuse this entry for cause, which the club shall deem to be sufficient. I (we) agree to hold this club, its members, directors, governors, officers, agents or other functionaries, any employees of the aforementioned parties and the owner(s) of the trial premises or grounds harmless from any claim for loss or injury which may be alleged to have been caused directly or indirectly to any person or thing by the act of this dog while in or upon the lure field trial premises or grounds or near any entrance thereto and I (we) personally assume all responsibility and liability for any such claim, and I (we) further agree to hold the aforementioned parties harmless from any claim loss of this dog by disappearance, theft damage or injury be caused or alleged to be caused by the negligence of the club or any of the aforementioned parties or by the negligence of any person or any other cause or causes. I (we) certify and represent that the dog entered is not a hazard to person or other dogs. This entry is submitted for acceptance of the forgoing representations and agreements

**SIGNATURE** of owner or his agent  
duly authorized to make this entry \_\_\_\_\_

**OFFICIAL AMERICAN SIGHTHOUND FIELD ASSOCIATION ENTRY FORM**  
**COLORADO LURE COURSING ASSOCIATION**  
**ALL BREED ASFA LURE FIELD TRIAL**  
**SATURDAY, APRIL 6, 2013**

**FALCON INSTITUTE FOR ADVANCED COURSING STUDIES, FALCON, COLORADO**  
**EARLY ENTRIES: 17.00 first hound, \$14.00 each additional hound entered by same owner.**  
**Early entries close Wed., APRIL 3, 2013 at 6:00 P.M. at the FTS address.**  
**Day of trial entries close at 9:15 A.M. at the FTS desk, the day of the trial, \$20.00 per hound.**  
**Make checks payable to CLCA and mail with completed entry form to:**  
**Deann Britton, PO BOX 440847, Aurora, CO 80044**

Fee Paid \_\_\_\_\_ The Field Secretary cannot accept conditional, unsigned, incomplete or unpaid entries; please check your completed entry carefully.

Breed:		Call Name:	
Registered Name of Hound:			
Stake: <input type="checkbox"/> Open <input type="checkbox"/> FCH <input type="checkbox"/> Veteran <input type="checkbox"/> Single <input type="checkbox"/> Limited		Additional Stakes <input type="checkbox"/> Kennel <input type="checkbox"/> Breeder <input type="checkbox"/> Bench	
<b>Registration Number:</b> (please write in registering body before number)			
<input type="checkbox"/> If possible, please separate my hounds		Date of Birth:	Sex: <input type="checkbox"/> Dog <input type="checkbox"/> Bitch
Name of actual owner(s):			
Address:		Phone:	
City:		State:	Zip:
E-mail (Optional)		(Optional) Region of Residence:	
<input type="checkbox"/> <b>Check if this is the first ASFA trial for this hound. Attach a Hound Certification or waiver if entered in Open, Veterans, Limited.</b>			
<input type="checkbox"/> <b>Check if this is a first-time entry, a copy of the official Registration of this hound must accompany this entry unless NGA.</b>			
<input type="checkbox"/> Check if any information has changed since the last ASFA trial entry. Regarding _____			
<input type="checkbox"/> Check if this hound has been dismissed within the last 6 trials entered. Must be marked in order to qualify for a "clean" trial requirement.			

I CERTIFY that I am the actual owner of this dog, or that I am the duly authorized agent of the actual owner whose name I have entered above. In consideration of the acceptance of this entry and the opportunity to have this dog judged and to win prize money, ribbons, or trophies, I (we) agree to abide by the rules and regulations of the American Sighthound Field Association in effect at the time of this lure field trial, and by any additional rules and regulations appearing in the premium list for this lure field trial. I (we) agree that the club holding this lure field trial has the right to refuse this entry for cause, which the club shall deem to be sufficient. I (we) agree to hold this club, its members, directors, governors, officers, agents or other functionaries, any employees of the aforementioned parties and the owner(s) of the trial premises or grounds harmless from any claim for loss or injury which may be alleged to have been caused directly or indirectly to any person or thing by the act of this dog while in or upon the lure field trial premises or grounds or near any entrance thereto and I (we) personally assume all responsibility and liability for any such claim, and I (we) further agree to hold the aforementioned parties harmless from any claim loss of this dog by disappearance, theft damage or injury be caused or alleged to be caused by the negligence of the club or any of the aforementioned parties or by the negligence of any person or any other cause or causes. I (we) certify and represent that the dog entered is not a hazard to person or other dogs. This entry is submitted for acceptance of the forgoing representations and agreements

**SIGNATURE** of owner or his agent  
 duly authorized to make this entry \_\_\_\_\_

**OFFICIAL AMERICAN SIGHTHOUND FIELD ASSOCIATION ENTRY FORM**  
**COLORADO LURE COURSING ASSOCIATION**  
**ALL BREED ASFA LURE FIELD TRIAL**  
**SATURDAY, APRIL 6, 2013**

**FALCON INSTITUTE FOR ADVANCED COURSING STUDIES, FALCON, COLORADO**  
**EARLY ENTRIES: 17.00 first hound, \$14.00 each additional hound entered by same owner.**  
**Early entries close Wed., APRIL 3, 2013 at 6:00 P.M. at the FTS address.**  
**Day of trial entries close at 9:15 A.M. at the FTS desk, the day of the trial, \$20.00 per hound.**  
**Make checks payable to CLCA and mail with completed entry form to:**  
**Deann Britton, PO BOX 440847, Aurora, CO 80044**

Fee Paid \_\_\_\_\_ The Field Secretary cannot accept conditional, unsigned, incomplete or unpaid entries; please check your completed entry carefully.

Breed:		Call Name:	
Registered Name of Hound:			
Stake: <input type="checkbox"/> Open <input type="checkbox"/> FCH <input type="checkbox"/> Veteran <input type="checkbox"/> Single <input type="checkbox"/> Limited		Additional Stakes <input type="checkbox"/> Kennel <input type="checkbox"/> Breeder <input type="checkbox"/> Bench	
<b>Registration Number:</b> (please write in registering body before number)			
<input type="checkbox"/> If possible, please separate my hounds		Date of Birth:	Sex: <input type="checkbox"/> Dog <input type="checkbox"/> Bitch
Name of actual owner(s):			
Address:		Phone:	
City:		State:	Zip:
E-mail (Optional)		(Optional) Region of Residence:	
<input type="checkbox"/> <b>Check if this is the first ASFA trial for this hound. Attach a Hound Certification or waiver if entered in Open, Veterans, Limited.</b>			
<input type="checkbox"/> <b>Check if this is a first-time entry, a copy of the official Registration of this hound must accompany this entry unless NGA.</b>			
<input type="checkbox"/> Check if any information has changed since the last ASFA trial entry. Regarding _____			
<input type="checkbox"/> Check if this hound has been dismissed within the last 6 trials entered. Must be marked in order to qualify for a "clean" trial requirement.			

I CERTIFY that I am the actual owner of this dog, or that I am the duly authorized agent of the actual owner whose name I have entered above. In consideration of the acceptance of this entry and the opportunity to have this dog judged and to win prize money, ribbons, or trophies, I (we) agree to abide by the rules and regulations of the American Sighthound Field Association in effect at the time of this lure field trial, and by any additional rules and regulations appearing in the premium list for this lure field trial. I (we) agree that the club holding this lure field trial has the right to refuse this entry for cause, which the club shall deem to be sufficient. I (we) agree to hold this club, its members, directors, governors, officers, agents or other functionaries, any employees of the aforementioned parties and the owner(s) of the trial premises or grounds harmless from any claim for loss or injury which may be alleged to have been caused directly or indirectly to any person or thing by the act of this dog while in or upon the lure field trial premises or grounds or near any entrance thereto and I (we) personally assume all responsibility and liability for any such claim, and I (we) further agree to hold the aforementioned parties harmless from any claim loss of this dog by disappearance, theft damage or injury be caused or alleged to be caused by the negligence of the club or any of the aforementioned parties or by the negligence of any person or any other cause or causes. I (we) certify and represent that the dog entered is not a hazard to person or other dogs. This entry is submitted for acceptance of the forgoing representations and agreements

**SIGNATURE** of owner or his agent  
 duly authorized to make this entry \_\_\_\_\_

**OFFICIAL AMERICAN SIGHTHOUND FIELD ASSOCIATION ENTRY FORM  
 COLORADO LURE COURSING ASSOCIATION  
 ALL BREED ASFA LURE FIELD TRIAL  
 SUNDAY, APRIL 7, 2013**

**FALCON INSTITUTE FOR ADVANCED COURSING STUDIES, FALCON, COLORADO  
 EARLY ENTRIES: 17.00 first hound, \$14.00 each additional hound entered by same owner.  
 Early entries close Wed., APRIL 3, 2013 at 6:00 P.M. at the FTS address.  
 Day of trial entries close at 9:15 A.M. at the FTS desk, the day of the trial, \$20.00 per hound.  
 Make checks payable to CLCA and mail with completed entry form to:  
 Deann Britton, PO BOX 440847, Aurora, CO 80044**

Fee Paid \_\_\_\_\_ The Field Secretary cannot accept conditional, unsigned, incomplete or unpaid entries; please check your completed entry carefully.

Breed:		Call Name:	
Registered Name of Hound:			
Stake: <input type="checkbox"/> Open <input type="checkbox"/> FCH <input type="checkbox"/> Veteran <input type="checkbox"/> Single <input type="checkbox"/> Limited		Additional Stakes <input type="checkbox"/> Kennel <input type="checkbox"/> Breeder <input type="checkbox"/> Bench	
<b>Registration Number:</b> (please write in registering body before number)			
<input type="checkbox"/> If possible, please separate my hounds		Date of Birth:	Sex: <input type="checkbox"/> Dog <input type="checkbox"/> Bitch
Name of actual owner(s):			
Address:		Phone:	
City:		State:	Zip:
E-mail (Optional)		(Optional) Region of Residence:	
<input type="checkbox"/> Check if this is the first ASFA trial for this hound. Attach a Hound Certification or waiver if entered in Open, Veterans, Limited.			
<input type="checkbox"/> Check if this is a first-time entry, a copy of the official Registration of this hound must accompany this entry unless NGA.			
<input type="checkbox"/> Check if any information has changed since the last ASFA trial entry. Regarding _____			
<input type="checkbox"/> Check if this hound has been dismissed within the last 6 trials entered. Must be marked in order to qualify for a "clean" trial requirement.			

I CERTIFY that I am the actual owner of this dog, or that I am the duly authorized agent of the actual owner whose name I have entered above. In consideration of the acceptance of this entry and the opportunity to have this dog judged and to win prize money, ribbons, or trophies, I (we) agree to abide by the rules and regulations of the American Sighthound Field Association in effect at the time of this lure field trial, and by any additional rules and regulations appearing in the premium list for this lure field trial. I (we) agree that the club holding this lure field trial has the right to refuse this entry for cause, which the club shall deem to be sufficient. I (we) agree to hold this club, its members, directors, governors, officers, agents or other functionaries, any employees of the aforementioned parties and the owner(s) of the trial premises or grounds harmless from any claim for loss or injury which may be alleged to have been caused directly or indirectly to any person or thing by the act of this dog while in or upon the lure field trial premises or grounds or near any entrance thereto and I (we) personally assume all responsibility and liability for any such claim, and I (we) further agree to hold the aforementioned parties harmless from any claim loss of this dog by disappearance, theft damage or injury be caused or alleged to be caused by the negligence of the club or any of the aforementioned parties or by the negligence of any person or any other cause or causes. I (we) certify and represent that the dog entered is not a hazard to person or other dogs. This entry is submitted for acceptance of the forgoing representations and agreements

**SIGNATURE** of owner or his agent  
 duly authorized to make this entry \_\_\_\_\_

**OFFICIAL AMERICAN SIGHTHOUND FIELD ASSOCIATION ENTRY FORM  
 COLORADO LURE COURSING ASSOCIATION  
 ALL BREED ASFA LURE FIELD TRIAL  
 SUNDAY, APRIL 7, 2013**

**FALCON INSTITUTE FOR ADVANCED COURSING STUDIES, FALCON, COLORADO  
 EARLY ENTRIES: 17.00 first hound, \$14.00 each additional hound entered by same owner.  
 Early entries close Wed., APRIL 3, 2013 at 6:00 P.M. at the FTS address.  
 Day of trial entries close at 9:15 A.M. at the FTS desk, the day of the trial, \$20.00 per hound.  
 Make checks payable to CLCA and mail with completed entry form to:  
 Deann Britton, PO BOX 440847, Aurora, CO 80044**

Fee Paid \_\_\_\_\_ The Field Secretary cannot accept conditional, unsigned, incomplete or unpaid entries; please check your completed entry carefully.

Breed:		Call Name:	
Registered Name of Hound:			
Stake: <input type="checkbox"/> Open <input type="checkbox"/> FCH <input type="checkbox"/> Veteran <input type="checkbox"/> Single <input type="checkbox"/> Limited		Additional Stakes <input type="checkbox"/> Kennel <input type="checkbox"/> Breeder <input type="checkbox"/> Bench	
<b>Registration Number:</b> (please write in registering body before number)			
<input type="checkbox"/> If possible, please separate my hounds		Date of Birth:	Sex: <input type="checkbox"/> Dog <input type="checkbox"/> Bitch
Name of actual owner(s):			
Address:		Phone:	
City:		State:	Zip:
E-mail (Optional)		(Optional) Region of Residence:	
<input type="checkbox"/> Check if this is the first ASFA trial for this hound. Attach a Hound Certification or waiver if entered in Open, Veterans, Limited.			
<input type="checkbox"/> Check if this is a first-time entry, a copy of the official Registration of this hound must accompany this entry unless NGA.			
<input type="checkbox"/> Check if any information has changed since the last ASFA trial entry. Regarding _____			
<input type="checkbox"/> Check if this hound has been dismissed within the last 6 trials entered. Must be marked in order to qualify for a "clean" trial requirement.			

I CERTIFY that I am the actual owner of this dog, or that I am the duly authorized agent of the actual owner whose name I have entered above. In consideration of the acceptance of this entry and the opportunity to have this dog judged and to win prize money, ribbons, or trophies, I (we) agree to abide by the rules and regulations of the American Sighthound Field Association in effect at the time of this lure field trial, and by any additional rules and regulations appearing in the premium list for this lure field trial. I (we) agree that the club holding this lure field trial has the right to refuse this entry for cause, which the club shall deem to be sufficient. I (we) agree to hold this club, its members, directors, governors, officers, agents or other functionaries, any employees of the aforementioned parties and the owner(s) of the trial premises or grounds harmless from any claim for loss or injury which may be alleged to have been caused directly or indirectly to any person or thing by the act of this dog while in or upon the lure field trial premises or grounds or near any entrance thereto and I (we) personally assume all responsibility and liability for any such claim, and I (we) further agree to hold the aforementioned parties harmless from any claim loss of this dog by disappearance, theft damage or injury be caused or alleged to be caused by the negligence of the club or any of the aforementioned parties or by the negligence of any person or any other cause or causes. I (we) certify and represent that the dog entered is not a hazard to person or other dogs. This entry is submitted for acceptance of the forgoing representations and agreements

**SIGNATURE** of owner or his agent  
 duly authorized to make this entry \_\_\_\_\_