



Field Trial Secretary
Christine Canard FTS
3229 36th Ave S, Minneapolis, MN 55406-2128
ccanard@gmail.com 612-396-1110

Directions to the Field

From either north or south on I-35, take exit 81 east (County Road 70). Follow 70 east about 3 miles to Cedar Avenue. Turn left on Cedar about 1/8 mile to Highway 50. Turn right (east) on 50 to Farmington. Follow the signs to the Dakota County Fairgrounds.

The South Field is located on the West side of the Fairgrounds.

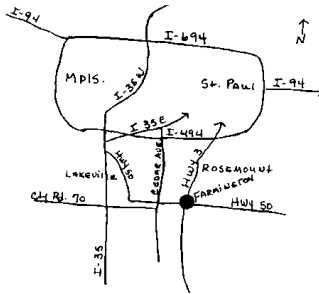

Here is a link to a map and directions to Dakota County Fairgrounds
<http://tinyurl.com/hv2jhqt>

Accommodations

Camping with hook-ups at the Dakota County Fairgrounds. Please contact Field Trial Chair Cassie Rogers in advance for arrangements at crogers@cadan.com or 612-839-0619.

Toilet facilities are available.

Motel 6 I-35 and County Road 70, **Lakeville** (952) 469-1900. 10 minutes or less from site. Use AKC's number CPM64DOG when making a reservation to get pet limit removed

America's Best Value Inn & Suites 1420 Riverview Drive, **Northfield**, MN 55057. (507) 663-0371 About 10 miles south of the Fairgrounds along Highway 3. Does allow pets, but there is an additional pet charge.

PREMIUM LIST

Entries close at 5:00pm WEDNESDAY, SEPTEMBER 16, 2020

E-mail entries WILL NOT be accepted! Separate Entry Form for each dog for each day! GATE ENTRIES DUE AT 8:30am day of trial.

3229 36th Ave S, Minneapolis, MN 55406



*****Facial Coverings will be Required*****

ASFA All-Breed Field Trial
September 19 & 20, 2020



****See Waiver and Safety Protocols Inside****

Dakota County Fairgrounds – South Field
4008 - 220th Street West Farmington, MN 55024

Cell Phone at field: 612-396-1110

ENTRY FEE: \$20.00 for first dog entered each day,
\$17.00 for EACH additional dog from the same household each day.

ROLL CALL & INSPECTION 9am

All Breeds and Stakes – No Exceptions

The American Sighthound Field Association has granted permission
to hold this event under the ASFA Rules & Regulations.

Audrey Silverstein
ASFA Scheduling Committee Chair



President: Marilyn Rew Vice President: Janell Honza
 Secretary: Christine Canard Treasurer: Kay Nierengarten
 Directors: Juliet Carlson, Sandy DePottey, Carol Juelfs, Barb Hearley
 ASFA Delegate: Gail Wieberdink

Judges & Assignments

Scott Hurlbert, Kansas City KS Kent Standerford, Omaha NE

S = Single Judge, * = Provisional Judge, # = Canadian Judge

Saturday

	A	AZ	BA	B	C	G	IB	IW	IG	Ltd	P	RR	S	SD	SW	Sgl	SL	W
SH	X	X	X	X	X	X	X	X	X	X	X		X	X	X		X	
KS	X	X	X	X	X	X	X	X	X	X	X	S	X	X	X	S	X	S

Sunday

	A	AZ	BA	B	C	G	IB	IW	IG	Ltd	P	RR	S	SD	SW	Sgl	SL	W
SH	X	X	X	X	X	X	X	X	X	X	X	X	X	X	X	S	X	S
KS	X	X	X	X	X	X	X	X	X	X	X	X	X	X	X		X	

Field Committee

Field Trial Chair: Cassie Rogers crogers@cadan.com 612-839-0619
Field Trial Secretary: Christine Canard ccanard@gmail.com 612-396-1110
Lure Operators: Barb Steinlage, Kent Standerford, Scott Hurlbert, Janell Honza, Terry Colbert, Bret Ashburn

- **TRIAL HOURS:** 8:00am until after ribbons are awarded.
- **SUBSTITUTIONS** (same owner) until 8:30 am day of trial.
- **ENTRIES WILL NOT BE ACKNOWLEDGED** by phone or mail

RIBBONS or ROSETTES will be offered for all placements.

First Prize - Blue	Next Best Qualified - Green
Second Prize - Red	Best in Singles Stake Winner – Navy & Gold
Third Prize - Yellow	Best of Breed – Purple & Gold Rosette
Fourth Prize - White	Best in Event – Red, White & Blue Rosette
Other prizes may be offered by the GTCWC and Friends of the GTCWC.	

Eligible Breeds & Registration

Purebred Afghan Hounds, Azawakhs, Basenjis, Borzoi, Cirneci dell'Etna, Greyhounds, Ibizan Hounds, Irish Wolfhounds, Italian Greyhounds, Pharaoh Hounds, Rhodesian Ridgebacks, Salukis, Scottish Deerhounds, Silken Windhounds, Sloughis and Whippets may be entered in all stakes, except Limited and LCI.

Limited breeds may be entered in the Limited Stake or Singles Stake. Limited breeds currently include purebred Chart Polski, Galgo Español, Magyar Agar, Peruvian Inca Orchid, Portuguese Podengo (Pequeno), and Portuguese Podengo (Medio & Grande). They must be individually registered with the appropriate registry.

All entries in the above stakes shall be individually registered with the AKC (including ILP and PAL), the NGA, the UKC, the FCI, an ASFA-recognized foreign or ASFA Board approved registry, or possess a CRN from the SPDBS. A photocopy of acceptable registry must be submitted with each hound's first ASFA field trial entry; this requirement is waived for hounds registered with the NGA

Stakes Offered

REGULAR STAKES

OPEN STAKE: For any eligible sighthound that has met certification requirements, excluding ASFA Field Champions of record.

FIELD CHAMPION STAKE: For any ASFA Field Champion of record. Except that hounds whose owner records show them to be ASFA Field Champions may be entered for a period up to 90 days without official certification. Hounds whose owner records show them to have met the requirements for the Field Champion title may be changed from the Open stake to the Field Champion stake provided notification is made to the Field Trial Secretary prior to roll call. Hounds determined to be not eligible to compete in the Field Champion stake will forfeit all points and placements earned in that stake toward an LCM.

VETERAN STAKE: For any eligible sighthound whose age is at least six years and who has met certification requirements. Except Irish Wolfhounds, whose age shall be at least five years, and Afghans, Rhodesian Ridgebacks, Salukis and Whippets, whose age shall be at least seven years. Points earned in this stake go toward V-FCH and V-LCM titles.

LIMITED STAKE:

For any eligible sighthound of a Limited breed that has met the certification requirements. All rules pertaining to Open Stake shall apply to Limited Stake, except when inconsistent with the following. No ASFA points or placements towards a Field Championship or an LCM will be awarded. Limited Stake breeds are not eligible to compete for Best in Field or Best in Event.

SINGLES STAKE: For any eligible sighthound including sighthounds disqualified to run in other stakes. Each hound runs alone and is not eligible to compete for Best of Breed, Best in Field, or Best in Event. Hounds are eligible to earn TCP & CPX titles from this stake.

Conditions of Entry (applies to all stakes)

- Hounds must be one year of age or older on day of trial.
- Stakes will be split into flights by public random draw if the entry in any stake is 20 or more.
- Females in season, lame hounds/dogs and those that are unfit to course will be excused at roll call.
- Hounds with breed disqualifications that are entered in regular breed stakes will be excused at roll call.
- Spayed, neutered, monorchid or cryptorchid without breed disqualifications may be entered in regular hound breed stakes.
- Hounds with breed disqualifications are eligible to enter Singles Stake.
- Hounds/dogs not present at the time of roll call will be scratched.
- All hounds/dogs will be run twice unless excused, dismissed or disqualified.
- All hounds/dogs will run in trios if possible, or braces (except in Singles and LCI stakes).
- A separate entry form is required for each dog for each day.
- All participants must read, understand, sign, and comply with the ASFA Lure Coursing Event COVID-19 Acknowledgement and Liability Waiver

Other Information

- Battery powered continuous loop lure machine will be used. Backup equipment will be available.
- Lure will consist of highly visible plastic strips.
- Exhibitors are requested to not bring bitches known to be in season to the field.
- There will be a \$5.00 fine assessed for any loose hound not participating in the course.
- Any person may, upon reasonable complaint, be asked to leave the grounds of the field trial by the Field Trial Committee.
- The field is partially fenced.
- Children must be under control of their parents or guardians at all times.

LOANER SLIP LEADS AND BLANKETS WILL NOT BE AVAILABLE.

In an effort to reduce the possible spread of COVID-19, we strongly encourage all participants to purchase their own slipeads & and lure coursing jackets. Some vendor suggestions can be found on the end of this premium list.



Course Plans

The course will be reversed for the finals, runoffs and Best of Breed. GTCWC reserves the right to alter the course plan as required by weather and/or field conditions on the date of the trial.
Terrain is grassy

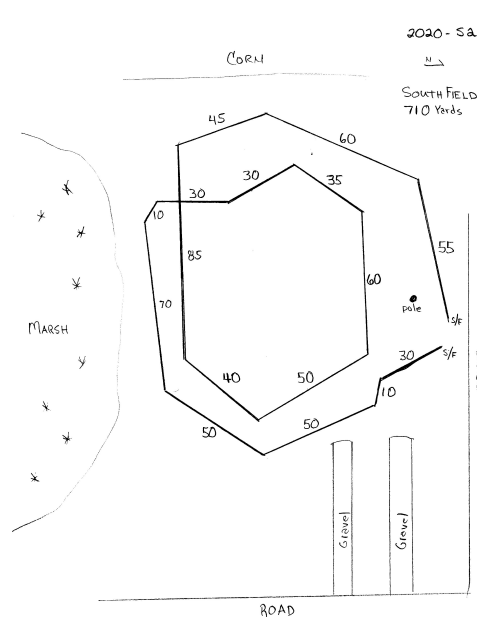

SATURDAY 710 yds

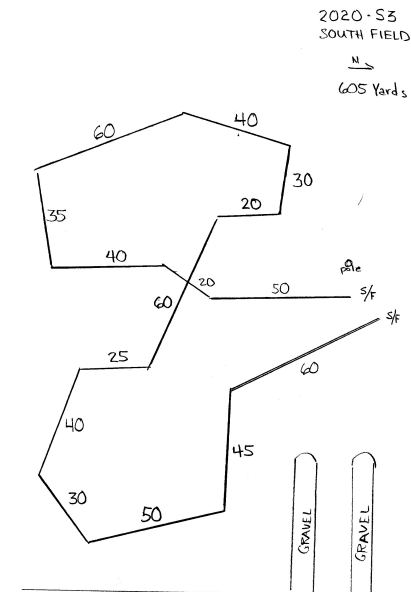

SUNDAY 605 yds

How To Enter

ENTERING:

Mail your entries to Christine Canard, 3229 36th Ave S, Minneapolis, MN 55406-2128. Make payment by check payable to GTCWC. Entries will be considered late if received later than 5pm Wednesday, September 16, 2020. Be sure to allow plenty of time for delivery.

FOR ALL ENTRIES

Include a completed and signed copy of the "Lure Coursing Event COVID-19 Acknowledgement & Liability Waiver."

FOR ALL FIRST TIME ENTRIES

- Include a copy of your dog's registration papers
- Include your "ASFA HOUND CERTIFICATION" form or ASFA approved proof of certification.
- Retain a copy for your records

Veterinarian on Call



**South Metro
Animal
Emergency Care**



**14690 Pennock Avenue,
Apple Valley, MN 55124
Friday 6 pm - Monday 8 am
(952) 953-3737**

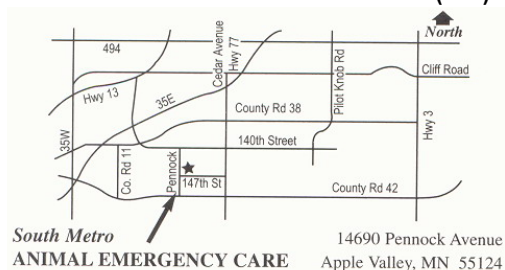

Procedures for COVID-19 Safety

- ✓ We will follow State of Minnesota and local guidelines.
- ✓ Bring your own facial covering. All participants will be required to wear facial coverings when not in their cars.
- ✓ No food will be served, bring your own breakfast and lunch, coffee, water & beverages.
- ✓ We ask that you park at a safe distance from other cars. This may mean that you will not find parking in the shade. Accordingly, be sure to bring plenty of shade for your dog(s) and yourself.
- ✓ There is limited water available on or near the South Field. Bring your own water.
- ✓ Roll Call and Inspection will require social distancing and a mask. The roll call committee will wear gloves and facial coverings. We will ask the owners of females to wipe their dogs and show the inspection committee the tissue.
- ✓ For dogs that require wicketing, the wickets will be wiped down after each dog.
- ✓ Bring your own face covering, hand sanitizer, gloves, and wet wipes.
- ✓ Huntmasters will stand 6 feet from the dogs after inspecting blankets and slip leads.
- ✓ At the starting line, all dogs will stand 6 feet apart.
- ✓ Practice social distancing. Act responsibly!!
- ✓ The running order will be posted – take a photo, be sure to wear a mask and social distance when looking at running order and results.
- ✓ Bring your own poop bags, pens, paper – avoid having to borrow from others.
- ✓ Above all, be safe and have fun with your dogs!!!

Would you like to Help with the Trial?

You Can Make a Difference

Whether or not you are an GTCWC member, please consider volunteering this trial weekend. If you have experience and are willing to work a job or if you wish to apprentice to learn a job, please fill out the form below and return it with your entry to the Field Trial Secretary. As an apprentice you will be paired with a person who knows the job so that you will have one-on-one attention.

I will work on: _____ Saturday _____ Sunday

I will apprentice on: _____ Saturday _____ Sunday

Name: _____

Phone: _____

Email: _____

I am entering dogs of these Stakes on

Saturday: _____

I am entering dogs of these Stakes on

Sunday: _____

Please check jobs that you are willing to do or learn on the day of the trial.

	EXPERIENCED	APPRENTICE
Field Set Up		
Inspection		
Paddock		
Huntmaster		
Lure Operator		
Field Clerk		
Field Tear Down		

THANK YOU FOR VOLUNTEERING.

Your efforts will be greatly appreciated.

OFFICIAL AMERICAN SIGHTHOUND FIELD ASSOCIATION ENTRY FORM

USE A SEPARATE ENTRY FORM FOR EACH DAY FOR EACH HOUND

GREATER TWIN CITIES WHIPPET CLUB SEPTEMBER 19 & 20, 2020

Entry Fees: \$20 first entry; \$17 second entry same household

Entries close **5PM, Wednesday Sept 16th, 2020**

Christine Canard FTS 3229 36th Ave S, Minneapolis, MN 55406 2128

Saturday 9/19/2020

Fee Paid _____ The Field Secretary cannot accept conditional, unsigned, incomplete or unpaid entries; please check your completed entry carefully.

Breed:		Call Name:	
Registered Name of Hound:			
Stake: <input type="checkbox"/> Open <input type="checkbox"/> FCH <input type="checkbox"/> Veteran <input type="checkbox"/> Single <input type="checkbox"/> Limited		Additional Stakes <input type="checkbox"/> Kennel <input type="checkbox"/> Breeder <input type="checkbox"/> Bench	
Registration Number: (please write in registering body before number)			
<input type="checkbox"/> If possible, please separate my hounds	Date of Birth:	Sex: <input type="checkbox"/> Dog <input type="checkbox"/> Bitch	
Name of actual owner(s):			
Address:		Phone:	
City:	State:	Zip:	
E-mail (Optional)		(Optional) Region of Residence:	
Emergency Contact Name and Phone (Optional)			
<input type="checkbox"/> Check if this is the first ASFA trial for this hound. Attach a Hound Certification or waiver if entered in Open, Veterans, Limited. <input type="checkbox"/> Check if this is a first-time entry, a copy of the official Registration of this hound must accompany this entry unless NGA. <input type="checkbox"/> Check if any information has changed since the last ASFA trial entry. Regarding _____ <input type="checkbox"/> Check if this hound has been dismissed within the last 6 trials entered. Must be marked in order to qualify for a "clean" trial requirement.			

I CERTIFY that I am the actual owner of this dog, or that I am the duly authorized agent of the actual owner whose name I have entered above. In consideration of the acceptance of this entry and the opportunity to have this dog judged and to win prize money, ribbons, or trophies, I (we) agree to abide by the rules and regulations of the American Sighthound Field Association in effect at the time of this lure field trial, and by any additional rules and regulations appearing in the premium list for this lure field trial. I (we) agree that the club holding this lure field trial has the right to refuse this entry for cause, which the club shall deem to be sufficient. I (we) agree to hold this club, its members, directors, governors, officers, agents or other functionaries, any employees of the aforementioned parties and the owner(s) of the trial premises or grounds harmless from any claim for loss or injury which may be alleged to have been caused directly or indirectly to any person or thing by the act of this dog while in or upon the lure field trial premises or grounds or near any entrance thereto and I (we) personally assume all responsibility and liability for any such claim, and I (we) further agree to hold the aforementioned parties harmless from any claim loss of this dog by disappearance, theft damage or injury be caused or alleged to be caused by the negligence of the club or any of the aforementioned parties or by the negligence of any person or any other cause or causes. I (we) certify and represent that the dog entered is not a hazard to person or other dogs. This entry is submitted for acceptance of the forgoing representations and agreements.

SIGNATURE of owner or his agent
duly authorized to make this entry _____

Please separate the entries before submitting to FTS.

OFFICIAL AMERICAN SIGHTHOUND FIELD ASSOCIATION ENTRY FORM

USE A SEPARATE ENTRY FORM FOR EACH DAY FOR EACH HOUND

GREATER TWIN CITIES WHIPPET CLUB SEPTEMBER 19 & 20, 2020

Entry Fees: \$20 first entry; \$17 second entry same household

Entries close **5PM, Wednesday Sept 16th, 2020**

Christine Canard FTS 3229 36th Ave S, Minneapolis, MN 55406 2128

Sunday 9/20/2020

Fee Paid _____ The Field Secretary cannot accept conditional, unsigned, incomplete or unpaid entries; please check your completed entry carefully.

Breed:		Call Name:	
Registered Name of Hound:			
Stake: <input type="checkbox"/> Open <input type="checkbox"/> FCH <input type="checkbox"/> Veteran <input type="checkbox"/> Single <input type="checkbox"/> Limited		Additional Stakes <input type="checkbox"/> Kennel <input type="checkbox"/> Breeder <input type="checkbox"/> Bench	
Registration Number: (please write in registering body before number)			
<input type="checkbox"/> If possible, please separate my hounds	Date of Birth:	Sex: <input type="checkbox"/> Dog <input type="checkbox"/> Bitch	
Name of actual owner(s):			
Address:		Phone:	
City:	State:	Zip:	
E-mail (Optional)		(Optional) Region of Residence:	
Emergency Contact Name and Phone (Optional)			
<input type="checkbox"/> Check if this is the first ASFA trial for this hound. Attach a Hound Certification or waiver if entered in Open, Veterans, Limited. <input type="checkbox"/> Check if this is a first-time entry, a copy of the official Registration of this hound must accompany this entry unless NGA. <input type="checkbox"/> Check if any information has changed since the last ASFA trial entry. Regarding _____ <input type="checkbox"/> Check if this hound has been dismissed within the last 6 trials entered. Must be marked in order to qualify for a "clean" trial requirement.			

I CERTIFY that I am the actual owner of this dog, or that I am the duly authorized agent of the actual owner whose name I have entered above. In consideration of the acceptance of this entry and the opportunity to have this dog judged and to win prize money, ribbons, or trophies, I (we) agree to abide by the rules and regulations of the American Sighthound Field Association in effect at the time of this lure field trial, and by any additional rules and regulations appearing in the premium list for this lure field trial. I (we) agree that the club holding this lure field trial has the right to refuse this entry for cause, which the club shall deem to be sufficient. I (we) agree to hold this club, its members, directors, governors, officers, agents or other functionaries, any employees of the aforementioned parties and the owner(s) of the trial premises or grounds harmless from any claim for loss or injury which may be alleged to have been caused directly or indirectly to any person or thing by the act of this dog while in or upon the lure field trial premises or grounds or near any entrance thereto and I (we) personally assume all responsibility and liability for any such claim, and I (we) further agree to hold the aforementioned parties harmless from any claim loss of this dog by disappearance, theft damage or injury be caused or alleged to be caused by the negligence of the club or any of the aforementioned parties or by the negligence of any person or any other cause or causes. I (we) certify and represent that the dog entered is not a hazard to person or other dogs. This entry is submitted for acceptance of the forgoing representations and agreements.

SIGNATURE of owner or his agent
duly authorized to make this entry _____

Please separate the entries before submitting to FTS.

USE THIS FORM FOR SIGHTHOUND CERTIFICATIONS

AMERICAN SIGHTHOUND FIELD ASSOCIATION

HOUD CERTIFICATION

Rule effective October 1, 1994: Ch. V, Sec. 4 (a) OPEN STAKE: *To be eligible to enter the open stake, a hound must have been certified by a licensed judge within the year preceding the closing date for the entry or have previously competed in the Open Stake.* This eligibility requirement also applies to a hound entered in the Provisional or Veteran Stake, which has not competed in Open previously. Please complete this portion of this form and attach it to the entry form for the hound's first entry, including an entry for a Fun Trial.

Registered Name of Hound: _____

Registration Number: _____ Breed: _____

Registered Owner's Name: _____

I hereby certify that on (date) _____, the above named hound completed a lure course of at least 500 yards, running with another hound of the same breed (or another breed with a similar running style). During the course the above named hound showed no inclination to interfere with the other hound. I further certify that I am a licensed judge for the ASFA.

Name of Licensed Judge: _____

Signature: _____ Date: _____

I hereby certify that the hound running in the certification course is the hound identified above and that information provided on this form is true and correct.

Signature: _____ Date: _____

Owner or Authorized Agent of Hound

This certification form must be attached to the entry form the first time this hound is entered in an open, limited, or veteran stake. Any hound entered in open, limited, or veteran (as a first time entered hound), which has not been certified, shall be declared ineligible by the records coordinator and shall forfeit any points and placements awarded.

PLEASE RETAIN A COPY FOR YOUR RECORDS.

AMERICAN SIGHTHOUND FIELD ASSOCIATION

HOUD CERTIFICATION WAIVER

Waiver of Requirement: *This requirement will be waived for a hound that has earned a lure coursing or racing title from another recognized organization, if such title requires competition, and if a waiver for such title has been approved by the ASFA, or a CKC Hound Certification Form.* If your hound qualifies for a waiver, complete this portion of this form and attach it to your entry form. Proof of waivers must accompany this certification form.

Registered Name of Hound: _____

Registration Number: _____ Breed: _____

Registered Owner's Name: _____

CKC: FCH FCHX

AKC: QC SC FC

Hound Certification previously submitted.

I hereby certify that the hound identified above has completed the requirements for the title indicated above (or that the required Certification was previously submitted) and that the information provided on this form is true and correct.

Signature: _____ Date: _____

Owner or Authorized Agent of Hound

USE THIS FORM FOR SIGHTHOUND CERTIFICATIONS

AMERICAN SIGHTHOUND FIELD ASSOCIATION

HOUD CERTIFICATION

Rule effective October 1, 1994: Ch. V, Sec. 4 (a) OPEN STAKE: *To be eligible to enter the open stake, a hound must have been certified by a licensed judge within the year preceding the closing date for the entry or have previously competed in the Open Stake.* This eligibility requirement also applies to a hound entered in the Provisional or Veteran Stake, which has not competed in Open previously. Please complete this portion of this form and attach it to the entry form for the hound's first entry, including an entry for a Fun Trial.

Registered Name of Hound: _____

Registration Number: _____ Breed: _____

Registered Owner's Name: _____

I hereby certify that on (date) _____, the above named hound completed a lure course of at least 500 yards, running with another hound of the same breed (or another breed with a similar running style). During the course the above named hound showed no inclination to interfere with the other hound. I further certify that I am a licensed judge for the ASFA.

Name of Licensed Judge: _____

Signature: _____ Date: _____

I hereby certify that the hound running in the certification course is the hound identified above and that information provided on this form is true and correct.

Signature: _____ Date: _____

Owner or Authorized Agent of Hound

This certification form must be attached to the entry form the first time this hound is entered in an open, limited, or veteran stake. Any hound entered in open, limited, or veteran (as a first time entered hound), which has not been certified, shall be declared ineligible by the records coordinator and shall forfeit any points and placements awarded.

PLEASE RETAIN A COPY FOR YOUR RECORDS.

AMERICAN SIGHTHOUND FIELD ASSOCIATION

HOUD CERTIFICATION WAIVER

Waiver of Requirement: *This requirement will be waived for a hound that has earned a lure coursing or racing title from another recognized organization, if such title requires competition, and if a waiver for such title has been approved by the ASFA, or a CKC Hound Certification Form.* If your hound qualifies for a waiver, complete this portion of this form and attach it to your entry form. Proof of waivers must accompany this certification form.

Registered Name of Hound: _____

Registration Number: _____ Breed: _____

Registered Owner's Name: _____

CKC: FCH FCHX

AKC: QC SC FC

Hound Certification previously submitted.

I hereby certify that the hound identified above has completed the requirements for the title indicated above (or that the required Certification was previously submitted) and that the information provided on this form is true and correct.

Signature: _____ Date: _____

Owner or Authorized Agent of Hound

Lure Coursng Event COVID-19 Acknowledgement & Liability Waiver
(All participants must submit this form along with your entries).

I certify that the following is true and complete to the best of my knowledge:

- ☐ I do not now have COVID-19.
- ☐ I have not had the symptoms of COVID-19 within the past 14 days.
- ☐ I have not tested positive for COVID-19 within the past 14 days.
- ☐ I have NOT been in contact with a known carrier of COVID-19 within the past 14 days.
- ☐ I have NOT been in contact with anyone displaying COVID-19 symptoms within the past 14 days.
- ☐ I understand that COVID-19 can be spread by non-symptomatic or pre-sypmtomatic people. Accordingly, I agree to use my best efforts to protect myself and to protect others from the virus at this event, by wearing a facial covering, practicing social distancing, washing my hands, using hand sanitizer, and taking other appropriate measures according to ASFA, GTCWC, local, state and consistent federal guidelines.
- ☐ I acknowledge that there are risks of exposure to COVID-19 due to the nature of Lure Coursing.
- ☐ I assume all risk in attending this GTCWC ASFA event and take full responsibility for my own health and safety during this event.
- ☐ I agree to release, waive, discharge and hold harmless from liability ASFA, GTCWC, Dakota County Fairgrounds, and their officers, members and the participants in this event.
- ☐ **If any of the above information changes between the time of my signature below and the time of the trial, or if I develop any signs of illness, I shall not attend the trial. I shall report my situation to the Field Trial Secretary to obtain a full refund of my entry fees.**

Place a check mark in each box, indicating that you have read, understand and approved of each statement. Each box must be checked in order to compete in this event. Please complete the designation line, shen sign and date.

Signature or e-signature

Date

Print Name: _____
READ, SIGN AND SUBMIT TO THE FTS WITH YOUR ENTRIES

Lure Coursing Event COVID-19 Acknowledgement & Liability Waiver
(All participants must submit this form along with your entries).

I certify that the following is true and complete to the best of my knowledge:

- ☐ I do not now have COVID-19.
- ☐ I have not had the symptoms of COVID-19 within the past 14 days.
- ☐ I have not tested positive for COVID-19 within the past 14 days.
- ☐ I have NOT been in contact with a known carrier of COVID-19 within the past 14 days.
- ☐ I have NOT been in contact with anyone displaying COVID-19 symptoms within the past 14 days.
- ☐ I understand that COVID-19 can be spread by non-symptomatic or pre-sypmtomatic people. Accordingly, I agree to use my best efforts to protect myself and to protect others from the virus at this event, by wearing a facial covering, practicing social distancing, washing my hands, using hand sanitizer, and taking other appropriate measures according to ASFA, GTCWC, local, state and consistent federal guidelines.
- ☐ I acknowledge that there are risks of exposure to COVID-19 due to the nature of Lure Coursing.
- ☐ I assume all risk in attending this GTCWC ASFA event and take full responsibility for my own health and safety during this event.
- ☐ I agree to release, waive, discharge and hold harmless from liability ASFA, GTCWC, Dakota County Fairgrounds, and their officers, members and the participants in this event.
- ☐ **If any of the above information changes between the time of my signature below and the time of the trial, or if I develop any signs of illness, I shall not attend the trial. I shall report my situation to the Field Trial Secretary to obtain a full refund of my entry fees.**

Place a check mark in each box, indicating that you have read, understand and approved of each statement. Each box must be checked in order to compete in this event. Please complete the designation line, shen sign and date.

Signature or e-signature

Date

Print Name: _____
READ, SIGN AND SUBMIT TO THE FTS WITH YOUR ENTRIES

ENTRY FEE TABLE

Entries	Sat. 1 day	Sun. 1 day	Total for 1 day	Total for 2 days
1st	\$20	\$20	\$20	\$40
2nd	\$17	\$17	\$37	\$74
3 rd	\$17	\$17	\$54	\$108
4th	\$17	\$17	\$71	\$142
5th	\$17	\$10	\$88	\$176

PRACTICES & HOUND CERTIFICATIONS Except for Hounds entered in Singles Stake that may certify before the trial, certs & hound practices will be available after the trial on **Saturday** (weather, equipment & field conditions permitting). The fee for a certification run is \$5. Make arrangements for a hound to run with, and have the proper form for the judge to sign. Certifications will be run before practice runs as a courtesy to the judges.

REFUNDS - GTCWC will refund entry fees for anyone who cannot or should not attend the trial due to illness, possible illness, or exposure to illness during the pandemic. Contact the Field Trial Secretary. GTCWC also provides refunds of entry fees for dogs that are in season or lame, so long as the Field Trial Secretary is notified of the situation **before roll call**. If your dog comes in season or becomes lame before the Trial, and you will not be attending the Trial for that reason, you must notify the Field Trial Secretary BEFORE roll to claim a refund. If the Field Trial Secretary does not receive notice before roll call, GTCWC will not issue a refund.

For GTCWC Members

If your hound is eligible to compete for the Karen Samuelson Memorial Trophy for 2020, please include a copy of your hound's registration along with your trial entry.

sources for lure coursing slip leads & jackets

You can order custom slip leads in Minnesota from Kay Nierengarten
<https://northwindcatalog.com/product-page-new/slip-leads/>

Some Trusted Online Retailers of jackets and slip leads

<https://www.followyourlead.com/racing-coursing-jackets.html>

<http://www.fashionfurwarddog.com/lure-coursing-.html>

<https://www.artfire.com/ext/shop/home/BIFBLANKETSANDLEADS>

... or Google "lure coursing supplies", "slip leads" and/or
 "lure coursing jackets" or "lure coursing blankets"



LUNCH Due to COVID, Please plan to bring your own coffee, lunch, water and other refreshments.

Also, Burger King, Subway & McDonalds are close by.