



MINNESOTA COURSING ASSOCIATION

Karen Peterson - FTS
2432 Sheridan Ave So
Minneapolis, MN 55405
karenpeterson4@gmail.com 612.339.9389



First Class – Dated Material

PREMIUM LIST

Early entries close 5:00pm **WEDNESDAY, May 17, 2017** at the FTS's house.
Day of Trial entries close 8:30am at FTS's table.



MINNESOTA COURSING ASSOCIATION

ASFA Region 5

ASFA All Breed Field Trials

Saturday & Sunday, May 20 & 21, 2017

Dakota County Fairgrounds - **South Field**
4008 - 220th Street West
Farmington, MN 55024

EARLY ENTRY FEE: **\$20.00** FIRST ENTRY
\$17.00 EACH ADDITIONAL ENTRY SAME HOUSEHOLD

E-mail entries **WILL NOT** be accepted!

Separate Entry Form for each dog for each day!

DAY OF TRIAL ENTRY FEE: **\$25.00** per hound

Permission has been granted by the American Sighthound Field Association for the holding of this event under ASFA Rules and Regulations.

Audrey Silverstein, Chair,
ASFA Scheduling Committee

Minnesota Coursing Association Directors and Officers

President: : Barb Steinlage
 Vice President: Kay Nierengarten
 Secretary: Vicki Fagre-Stroetz
 Treasurer: Miles Hecht
 Coursing Director: Wayne Olson
 ASFA Delegates: Karen Peterson
 Directors: Kathy Nelson, Jeanne Mandel, Barb Myers (Hospitality)

JUDGES AND ASSIGNMENTS: Katie Kaltborn, Cynthiana KY Elaine McMichael, Crestview FL

S = Single Judge * = Provisional Judge # = Canadian Judge

SAT	A	Az	Ba	B	C	G	Ib	IW	IG	P	RR	S	SD	SW	SL	W	Ltd	Sgl
KK	X	X	X	X	X	X	X	X	X	X	X	X	X	X	X	X	X	X
EM	X	X	X	X	X	X	X	X	X	X	X	X	X	X	X	X	X	X

SUN	A	Az	Ba	Bz	C	G	Ib	IW	IG	P	RR	S	SD	SW	SL	W	Ltd	Sgl
KK	X	X	X	X	X	X	X	X	X	X	X	X	X	X	X	X	X	X
EM	X	X	X	X	X	X	X	X	X	X	X	X	X	X	X	X	X	X

FIELD COMMITTEE:

Field Chair: Wayne Olson
 Field Secretary: Karen Peterson, karenpeterson4@gmail.com, 612-339-9389
 Lure Operators: Mark Shubert, Janell Honza, Josie Haumont, Scott Hurlbert, Kent Standerford

TRIAL HOURS: 8:00 a.m. UNTIL AFTER RIBBONS ARE AWARDED.

ROLL CALL & INSPECTION: Promptly at 9:00 a.m. -- All Breeds - NO EXCEPTIONS

RIBBON PRIZES:

First Prize - Blue	Next Best Qualified - Green
Second Prize - Red	Best in Singles Stake Winner – Navy & Gold
Third Prize - Yellow	Best of Breed – Purple & Gold Rosette
Fourth Prize - White	Best in Field – Red, White & Blue Rosette
	New Title – Green, White & Black Rosette

ELIGIBLE BREEDS & REGISTRATION:

Only purebred Afghan Hounds, Azawakhs, Basenjis, Borzoi, Cirnechi dell'Etna, Greyhounds, Ibizan Hounds, Irish Wolfhounds, Italian Greyhounds, Pharaoh Hounds, Rhodesian Ridgebacks, Salukis, Scottish Deerhounds, Silken Windhounds, Sloughis and Whippets may be entered in the regular stakes. Limited breeds may be entered in the Limited Stake or Singles Stake. Limited breeds may be entered in Limited Stake or Singles Stake. Limited breeds currently include purebred Chart Polski, Galgo Español, Magyar Agar, Peruvian Inca Orchid, Portuguese Podengo (Pequeno), Portuguese Podengo (Medio & Grande), and must be individually registered with the appropriate registry.

All entries shall be individually registered with the AKC (including ILP and PAL), the NGA, the UKC, the FCI, an ASFA-recognized foreign or ASFA Board approved registry, or possess a CRN from the SPDBS. A photocopy of acceptable registry must be submitted with each hound's first ASFA field trial entry; this requirement is waived for hounds registered with the NGA.

Late, incomplete, unsigned or conditional entries will not be accepted. Entries will **NOT** be acknowledged by mail. Preliminary courses for all breeds will be completed before beginning final courses.

REGULAR STAKES OFFERED:

OPEN STAKE: Any eligible sighthound, excluding ASFA Field Champions of record.

FIELD CHAMPION STAKE: Any ASFA Field Champion of record

VETERAN STAKE: Any eligible sighthound whose age is at least six years, except Irish Wolfhounds whose age shall be at least five years, and Afghans, Rhodesian Ridgebacks, Salukis, and Whippets whose age shall be at least seven years. Points go toward V-FCH and V-LCM titles.

LIMITED STAKE: Any eligible sighthound of a Limited breed that has met certification requirements. Not eligible to compete in Best of Breed or Best in Field.

SINGLES STAKE: Any eligible sighthound including those disqualified to run in other stakes. Each hound runs alone. Not eligible to compete for Best of Breed or Best in Field. Hounds are eligible to earn TCP & CPX titles from the Singles stake. Limited breeds are not eligible for these titles.

All hounds entering Open, Veteran or Limited Stakes for the first time **MUST** include a completed ASFA certification form or waiver form and a copy of the hound's registration certificate (registration is not required for NGA Greyounds ONLY; certification or waiver is not required for Singles stake entries ONLY).

BEST IN FIELD WIN BE OFFERED ON SATURDAY ONLY.

CONDITIONS OF ENTRY

Hounds must be one year of age or older on day of trial. • Stakes will be split into flights by public random draw if the entry in any regular stake is 20 or more. • Bitches in season, lame hounds, and hounds with breed disqualifications will be excused at roll call. • Spayed, neutered, monorchid or cryptorchid hounds without breed disqualifications may be entered. Hounds with breed disqualifications are not eligible to enter, except in Singles Stake. • Hounds not present at the time of roll call will be scratched. • All Hounds will be run twice in trios if possible, or braces (except in the Singles Stake), unless excused, dismissed or disqualified.

EQUIPMENT: Battery powered continuous loop lure machine will be used; backup equipment will be available. Lure will consist of highly visible plastic strips.

MCA provides slip leads and blankets.

COURSE PLANS: Reversed for finals. See below. MCA reserves the right to alter the course plan as required by weather and/or field conditions on the day of the trial. Terrain is grassy.

SATURDAY 710 yards

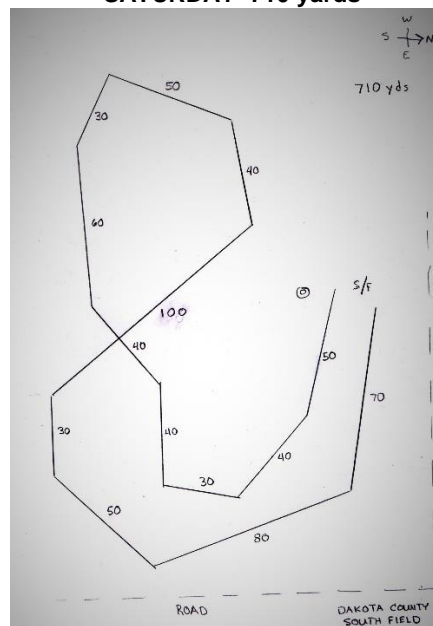

SUNDAY 695 yards

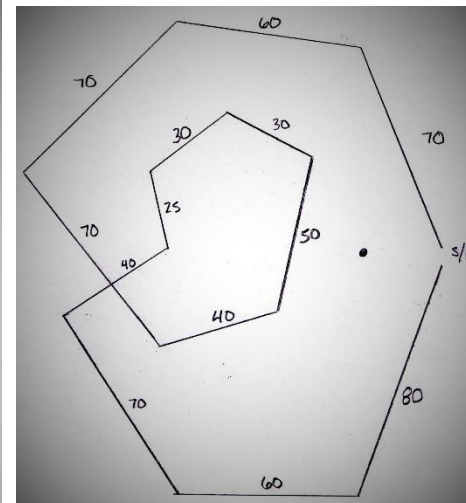

OFFICIAL AMERICAN SIGHTHOUND FIELD ASSOCIATION ENTRY FORM

COMPLETE AN ENTRY FORM FOR EACH DAY FOR EACH HOUND

E-MAIL ENTRIES WILL NOT BE ACCEPTED!

MINNESOTA COURSING ASSOCIATION MAY 20 & 21, 2017

Early Entry: \$20 first entry, \$17 each additional entry Day of Trial Entry: \$25

Early entries close 5:00 p.m., Wednesday, May 17, 2017 Day of Trial Entries 8:30 a.m.

Mail entries with check payable in U.S. funds to MCA to:

Karen Peterson, FTS

2432 Sheridan Ave So, Minneapolis, MN 55405

[] Saturday 5/20

[] Sunday 5/21

Fee Paid _____ The Field Secretary cannot accept conditional, unsigned, incomplete or unpaid entries; please check your completed entry carefully.

Breed:		Call Name:	
Registered Name of Hound:			
Stake: <input type="checkbox"/> Open <input type="checkbox"/> FCH <input type="checkbox"/> Veteran <input type="checkbox"/> Single <input type="checkbox"/> Limited		Additional Stakes <input type="checkbox"/> Kennel <input type="checkbox"/> Breeder <input type="checkbox"/> Bench	
Registration Number: (please write in registering body before number)			
<input type="checkbox"/> If possible, please separate my hounds	Date of Birth:	Sex: <input type="checkbox"/> Dog <input type="checkbox"/> Bitch	
Name of actual owner(s):			
Address:		Phone:	
City:	State:	Zip:	
E-mail (Optional)		(Optional) Region of Residence:	
<input type="checkbox"/> Check if this is the first ASFA trial for this hound. Attach a Hound Certification or waiver if entered in Open, Veterans, Limited.			
<input type="checkbox"/> Check if this is a first-time entry, a copy of the official Registration of this hound must accompany this entry unless NGA.			
<input type="checkbox"/> Check if any information has changed since the last ASFA trial entry. Regarding _____			
<input type="checkbox"/> Check if this hound has been dismissed within the last 6 trials entered. Must be marked in order to qualify for a "clean" trial requirement.			

I CERTIFY that I am the actual owner of this dog, or that I am the duly authorized agent of the actual owner whose name I have entered above. In consideration of the acceptance of this entry and the opportunity to have this dog judged and to win prize money, ribbons, or trophies, I (we) agree to abide by the rules and regulations of the American Sighthound Field Association in effect at the time of this lure field trial, and by any additional rules and regulations appearing in the premium list for this lure field trial. I (we) agree that the club holding this lure field trial has the right to refuse this entry for cause, which the club shall deem to be sufficient. I (we) agree to hold this club, its members, directors, governors, officers, agents or other functionaries, any employees of the aforementioned parties and the owner(s) of the trial premises or grounds harmless from any claim for loss or injury which may be alleged to have been caused directly or indirectly to any person or thing by the act of this dog while in or upon the lure field trial premises or grounds or near any entrance thereto and I (we) personally assume all responsibility and liability for any such claim, and I (we) further agree to hold the aforementioned parties harmless from any claim loss of this dog by disappearance, theft damage or injury be caused or alleged to be caused by the negligence of the club or any of the aforementioned parties or by the negligence of any person or any other cause or causes. I (we) certify and represent that the dog entered is not a hazard to person or other dogs. This entry is submitted for acceptance of the forgoing representations and agreements.

SIGNATURE of owner or his agent
duly authorized to make this entry _____

OFFICIAL AMERICAN SIGHTHOUND FIELD ASSOCIATION ENTRY FORM

COMPLETE AN ENTRY FORM FOR EACH DAY FOR EACH HOUND

E-MAIL ENTRIES WILL NOT BE ACCEPTED!

MINNESOTA COURSING ASSOCIATION MAY 20 & 21, 2017

Early Entry: \$20 first entry, \$17 each additional entry Day of Trial Entry: \$25

Early entries close 5:00 p.m., Wednesday, May 17, 2017 Day of Trial Entries 8:30 a.m.

Mail entries with check payable in U.S. funds to MCA to:

Karen Peterson, FTS

2432 Sheridan Ave So, Minneapolis, MN 55405

[] Saturday 5/20

[] Sunday 5/21

Fee Paid _____ The Field Secretary cannot accept conditional, unsigned, incomplete or unpaid entries; please check your completed entry carefully.

Breed:		Call Name:	
Registered Name of Hound:			
Stake: <input type="checkbox"/> Open <input type="checkbox"/> FCH <input type="checkbox"/> Veteran <input type="checkbox"/> Single <input type="checkbox"/> Limited		Additional Stakes <input type="checkbox"/> Kennel <input type="checkbox"/> Breeder <input type="checkbox"/> Bench	
Registration Number: (please write in registering body before number)			
<input type="checkbox"/> If possible, please separate my hounds	Date of Birth:	Sex: <input type="checkbox"/> Dog <input type="checkbox"/> Bitch	
Name of actual owner(s):			
Address:		Phone:	
City:	State:	Zip:	
E-mail (Optional)		(Optional) Region of Residence:	
<input type="checkbox"/> Check if this is the first ASFA trial for this hound. Attach a Hound Certification or waiver if entered in Open, Veterans, Limited.			
<input type="checkbox"/> Check if this is a first-time entry, a copy of the official Registration of this hound must accompany this entry unless NGA.			
<input type="checkbox"/> Check if any information has changed since the last ASFA trial entry. Regarding _____			
<input type="checkbox"/> Check if this hound has been dismissed within the last 6 trials entered. Must be marked in order to qualify for a "clean" trial requirement.			

I CERTIFY that I am the actual owner of this dog, or that I am the duly authorized agent of the actual owner whose name I have entered above. In consideration of the acceptance of this entry and the opportunity to have this dog judged and to win prize money, ribbons, or trophies, I (we) agree to abide by the rules and regulations of the American Sighthound Field Association in effect at the time of this lure field trial, and by any additional rules and regulations appearing in the premium list for this lure field trial. I (we) agree that the club holding this lure field trial has the right to refuse this entry for cause, which the club shall deem to be sufficient. I (we) agree to hold this club, its members, directors, governors, officers, agents or other functionaries, any employees of the aforementioned parties and the owner(s) of the trial premises or grounds harmless from any claim for loss or injury which may be alleged to have been caused directly or indirectly to any person or thing by the act of this dog while in or upon the lure field trial premises or grounds or near any entrance thereto and I (we) personally assume all responsibility and liability for any such claim, and I (we) further agree to hold the aforementioned parties harmless from any claim loss of this dog by disappearance, theft damage or injury be caused or alleged to be caused by the negligence of the club or any of the aforementioned parties or by the negligence of any person or any other cause or causes. I (we) certify and represent that the dog entered is not a hazard to person or other dogs. This entry is submitted for acceptance of the forgoing representations and agreements.

SIGNATURE of owner or his agent
duly authorized to make this entry _____

**AMERICAN SIGHTHOUND FIELD ASSOCIATION
HOUND CERTIFICATION**

Rule effective October 1, 1994: Ch. V, Sec. 4 (a) OPEN STAKE: *To be eligible to enter the open stake, a hound must have been certified by a licensed judge within the year preceding the closing date for the entry or have previously competed in the Open Stake.* This eligibility requirement also applies to a hound entered in the Limited or Veteran Stake, which has not competed in Open previously. Please complete this portion of this form and attach it to the entry form for the hound's first entry, including an entry for a Fun Trial.

Registered Name of Hound: _____

Registration Number: _____ Breed: _____

Registered Owner's Name: _____

I hereby certify that on (date) _____, the above named hound completed a lure course of at least 500 yards, running with another hound of the same breed (or another breed with a similar running style). During the course the above named hound showed no inclination to interfere with the other hound. I further certify that I am a licensed judge for the ASFA.

Name of Licensed Judge: _____

Signature: _____ Date: _____

I hereby certify that the hound running in the certification course is the hound identified above and that information provided on this form is true and correct.

Signature: _____ Date: _____

Owner or Authorized Agent of Hound

This certification form must be attached to the entry form the first time this hound is entered in an open, limited, or veteran stake. Any hound entered in open, limited, or veteran (as a first time entered hound), which has not been certified, shall be declared ineligible by the records coordinator and shall forfeit any points and placements awarded.

PLEASE RETAIN A COPY FOR YOUR RECORDS.

**AMERICAN SIGHTHOUND FIELD ASSOCIATION
HOUND CERTIFICATION WAIVER**

Waiver of Requirement: *This requirement will be waived for a hound that has earned a lure coursing or racing title from another recognized organization, if such title requires competition, and if a waiver for such title has been approved by the ASFA, or a CKC Hound Certification Form.* If your hound qualifies for a waiver, complete this portion of this form and attach it to your entry form. Proof of waivers must accompany this certification form.

Registered Name of Hound: _____

Registration Number: _____ Breed: _____

Registered Owner's Name: _____

CKC: FCH FCHX **CWA:** ARX TRP SRA DPC

AKC: QC FC SC **LGRA:** GRC **NAWRA:** RCH SR

WRA: CR WRCH **NOTRA:** ORC OTR SORC SOR

Hound Certification previously submitted.

I hereby certify that the hound identified above has completed the requirements for the title indicated above (or that the required Certification was previously submitted) and that the information provided on this form is true and correct.

Signature: _____ Date: _____

Owner or Authorized Agent of Hound

**AMERICAN SIGHTHOUND FIELD ASSOCIATION
HOUND CERTIFICATION**

Rule effective October 1, 1994: Ch. V, Sec. 4 (a) OPEN STAKE: *To be eligible to enter the open stake, a hound must have been certified by a licensed judge within the year preceding the closing date for the entry or have previously competed in the Open Stake.* This eligibility requirement also applies to a hound entered in the Limited or Veteran Stake, which has not competed in Open previously. Please complete this portion of this form and attach it to the entry form for the hound's first entry, including an entry for a Fun Trial.

Registered Name of Hound: _____

Registration Number: _____ Breed: _____

Registered Owner's Name: _____

I hereby certify that on (date) _____, the above named hound completed a lure course of at least 500 yards, running with another hound of the same breed (or another breed with a similar running style). During the course the above named hound showed no inclination to interfere with the other hound. I further certify that I am a licensed judge for the ASFA.

Name of Licensed Judge: _____

Signature: _____ Date: _____

I hereby certify that the hound running in the certification course is the hound identified above and that information provided on this form is true and correct.

Signature: _____ Date: _____

Owner or Authorized Agent of Hound

This certification form must be attached to the entry form the first time this hound is entered in an open, limited, or veteran stake. Any hound entered in open, limited, or veteran (as a first time entered hound), which has not been certified, shall be declared ineligible by the records coordinator and shall forfeit any points and placements awarded.

PLEASE RETAIN A COPY FOR YOUR RECORDS.

**AMERICAN SIGHTHOUND FIELD ASSOCIATION
HOUND CERTIFICATION WAIVER**

Waiver of Requirement: *This requirement will be waived for a hound that has earned a lure coursing or racing title from another recognized organization, if such title requires competition, and if a waiver for such title has been approved by the ASFA, or a CKC Hound Certification Form.* If your hound qualifies for a waiver, complete this portion of this form and attach it to your entry form. Proof of waivers must accompany this certification form.

Registered Name of Hound: _____

Registration Number: _____ Breed: _____

Registered Owner's Name: _____

CKC: FCH FCHX **CWA:** ARX TRP SRA DPC

AKC: QC FC SC **LGRA:** GRC **NAWRA:** RCH SR

WRA: CR WRCH **NOTRA:** ORC OTR SORC SOR

Hound Certification previously submitted.

I hereby certify that the hound identified above has completed the requirements for the title indicated above (or that the required Certification was previously submitted) and that the information provided on this form is true and correct.

Signature: _____ Date: _____

Owner or Authorized Agent of Hound

ACCOMMODATIONS

Camping is available at the Dakota County Fairgrounds for \$20 per night with hook-up, \$15 per night without hook-up. A limited number of hook-ups are available on a first come basis. Toilet facilities are available. **Please pay Dakota County Fairgrounds directly.**

Motel 6 I-35 and County Road 70, Lakeville (952) 469-1900 10 minutes or less from site.

America's Best Value Inn & Suites 1420 Riverview Drive, **Northfield**, MN 55057 (507) 663-0371 About 10 miles south of the Fairgrounds along Highway 3. Does allow pets but there is a \$20 charge.

Directions to the Field: From either north or south on I-35, take exit 81 east (County Road 70). Follow 70 east about 3 miles to Cedar Avenue. Turn left on Cedar about 1/8 mile to Highway 50. Turn right (east) on 50 to Farmington. Follow the signs to the Dakota County Fairgrounds. Proceed to the southwest side of the fairgrounds. **The South field is located adjacent to the Pioneer Village.**

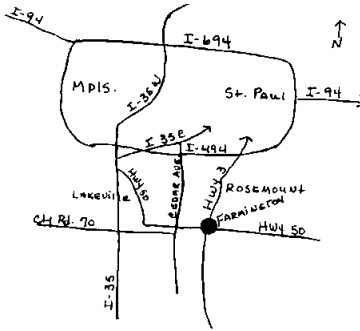

Here is a link to a map and directions to Dakota County Fairgrounds

<http://tinyurl.com/hv2jhgq>

There is water and some shade at the site.

Practice sessions and hound certifications will be available after the trial on **SATURDAY ONLY** (weather, equipment & field conditions permitting). Anyone certifying a hound must pay \$5, make his/her own arrangements for a hound to run with, and have the proper form for the judge to sign. (A form is included in the premium list.) As a courtesy to judges, certifications will be done before practice runs.

Visit our website

<https://sites.google.com/site/mncoursingassociation/>

Follow us on Facebook

<https://www.facebook.com/MinnesotaCoursingAssociation/>

Rainbow Bridge Memorial Trophy
MCA awards the Rainbow Bridge Memorial Trophy on the trial weekend closest to Memorial Day. This trophy is given in honor and remembrance of people loved and lost within the sport of lure coursing. The award goes to Saturday's Best in Field winner.

POTLUCK LUNCH

MCA will host a potluck lunch each day of the trial. The club will provide tacos on Saturday and hot dogs on Sunday, buns, condiments, and paperware included. Feel free to bring a dish to pass. And be sure to bring the non-alcoholic beverage of your choice. If your travel plans don't allow you to bring something there will be a container for donations.

Don't just bring your hound, bring your appetite!

Also, Burger King, Subway & McDonalds are located nearby

Veterinarian on Call:

952-953-3737
 14690 Pennock Avenue
 Apple Valley, MN 55124
 952-953-4433 (fax)
 www.smaec.com



Weekdays 6pm - 8am
 Open Weekends &
 All Major Holidays

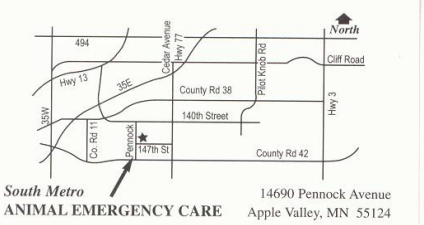

EARLY ENTRY FEE CALCULATION TABLE

Hounds entered	Sat. 1 day	Sun. 1 day	Total for 1 day	Total for 2 days
1st	\$20	\$20	\$20	\$40
2nd	\$17	\$17	\$37	\$74
3rd	\$17	\$17	\$54	\$108
4th	\$17	\$17	\$71	\$142
5th	\$17	\$17	\$88	\$176

REFUNDS: MCA will only issue a refund of entry fees for dogs that are in season or lame. If your hound comes in season or becomes lame before the Trial and you will not be attending the Trial for these reasons, you must inform the Field Trial Secretary BEFORE roll call--otherwise you will forfeit your entry fees!

Go to **www.asfa.org**

for the latest Rulebook, Policies, Contacts, Clubs, Trial Schedules Trial Results and more...

