

Minnesota Coursing Association Directors and Officers

Co-Presidents: Vicki Fagre-Stroetz, Kathy Nelson
 Vice President: Wayne Olson Secretary: Shellie Marvin
 Treasurer: Miles Hecht Coursing Director: Wayne Olson
 Directors: Kay Niereengarten, Teri Olson, Beth Schmidt

Judges & Assignments

Greg Breitbart, Milwaukee WI Scott Hurlbert, Kansas City KS
Darci Kunard, Reunion CO Lee Warden, Ortonville MI

S = Single Judge, * = Provisional Judge, # = Canadian Judge

Saturday

	A	AZ	BA	B	C	G	IB	IW	IG	LCI	Ltd	P	RR	S	SD	SW	Sgl	SL	W
GB	X	X	X	X	X		X	X		X	X							X	X
SH									X					X	X	X	X		
DK			X			S		X	X		X		X	X	X	X	X	X	
LW	X	X		X	X		X			X		S	X						X

Sunday

	A	AZ	BA	B	C	G	IB	IW	IG	LCI	Ltd	P	RR	S	SD	SW	Sgl	SL	W
GB													X	X	X	X	X		
SH	X	X	X	X	X		X	X	X	X	X							X	X
DK	X	X	X	X	X	S	X			X			X	X	X				X
LW								X	X		X	S				X	X	X	

Field Committee

Field Trial Co-Chairs: Teri Olson, sm6349@yahoo.com 715-288-6289
 Wayne Olson, wolson308@yahoo.com 715-877-1640
Field Trial Secretary: Christine Canard, ccanard@gmail.com 612-396-1110
Lure Operators: Greg Breitbart, Scott Hurlbert, Lee Warden

- **TRIAL HOURS:** 7:30 am until after ribbons are awarded.
- **SUBSTITUTIONS** (same owner) until 8:30 am day of trial.
- **CERTIFICATION RUNS** will NOT be offered before the trial on either day. Certifications will be available after the trial on Saturday (weather, equipment & field conditions permitting).
- **ROLL CALL & INSPECTION** at 9:00 am PROMPT. (Earlier for Field Committee, if available)
- **ENTRIES WILL NOT BE ACKNOWLEDGED** by phone or mail

RIBBONS or ROSETTES will be offered for all placements.

First Prize - Blue	Next Best Qualified - Green
Second Prize - Red	Best in Singles Stake Winner – Navy & Gold
Third Prize - Yellow	Best of Breed – Purple & Gold Rosette
Fourth Prize - White	Best in Field – Red, White & Blue Rosette
New Title – Green, White & Black Rosette	

Eligible Breeds & Registration

Purebred Afghan Hounds, Azawakhs, Basenjis, Borzoi, Cirneci dell'Etna, Greyhounds, Ibizan Hounds, Irish Wolfhounds, Italian Greyhounds, Pharaoh Hounds, Rhodesian Ridgebacks, Salukis, Scottish Deerhounds, Silken Windhounds, Sloughis and Whippets may be entered in all stakes, except Limited and LCI.

Limited breeds may be entered in the Limited Stake or Singles Stake. Limited breeds currently include purebred Chart Polski, Galgo Español, Magyar Agar, Peruvian Inca Orchid, Portuguese Podengo (Pequeno), and Portuguese Podengo (Medio & Grande). They must be individually registered with the appropriate registry.

All entries in the above stakes shall be individually registered with the AKC (including ILP and PAL), the NGA, the UKC, the FCI, an ASFA-recognized foreign or ASFA Board approved registry, or possess a CRN from the SPDBS. A photocopy of acceptable registry must be submitted with each hound's first ASFA field trial entry; this requirement is waived for hounds registered with the NGA

Lure Chasing Instinct (LCI) Stake is open to all non-sighthound breeds and mixed breeds. See "LCI STAKES" section below for registration requirements and stake details.

Stakes Offered

REGULAR STAKES

OPEN STAKE: For any eligible sighthound that has met certification requirements, excluding ASFA Field Champions of record.

FIELD CHAMPION STAKE: For any ASFA Field Champion of record. Except that hounds whose owner records show them to be ASFA Field Champions may be entered for a period up to 90 days without official certification. Hounds whose owner records show them to have met the requirements for the Field Champion title may be changed from the Open stake to the Field Champion stake provided notification is made to the Field Trial Secretary prior to roll call. Hounds determined to be not eligible to compete in the Field Champion stake will forfeit all points and placements earned in that stake toward an LCM.

VETERAN STAKE: For any eligible sighthound whose age is at least six years and who has met certification requirements. Except Irish Wolfhounds, whose age shall be at least five years, and Afghans, Rhodesian Ridgebacks, Salukis and Whippets, whose age shall be at least seven years. Points earned in this stake go toward V-FCH and V-LCM titles.

LIMITED STAKE:

For any eligible sighthound of a Limited breed that has met the certification requirements. All rules pertaining to Open Stake shall apply to Limited Stake, except when inconsistent with the following. No ASFA points or placements towards a Field Championship or an LCM will be awarded. Limited Stake breeds are not eligible to compete for Best in Field or Best in Event.

SINGLES STAKE: For any eligible sighthound including sighthounds disqualified to run in other stakes. Each hound runs alone and is not eligible to compete for Best of Breed, Best in Field, or Best in Event. Hounds are eligible to earn TCP & CPX titles from this stake.

LCI STAKES

REGISTRATION FOR LCI (LURE COURSING INSTINCT) STAKES

All dogs entered in LCI stake must have a registration number. If your dog is registered under any of options A – E below, then you must attach a copy (not the original) of the registration certificate to your dog's first ASFA trial entry form. If your dog is not registered under any of the options A – E below, then you may obtain a registration number under paragraph F below.

- A. A registration from AKC or CKC as one of their recognized breeds, or
- B. A registration from AKC Canine Partners or CKC (CCN) as a mixed-breed or other ineligible dog for registration under A (above), or
- C. A registration from AKC PAL (Purebred Alternative Listing), as a pure breed dog ineligible for registration under A (above), or
- D. An FSS (Foundation Stock Service) breed, as a member of a breed that is in the process of obtaining full AKC recognition, or
- E. A registration from UKC (United Kennel Club), which is an international dog registry that focuses on performance, or
- F. If your dog has no registration, you can register your dog with ASFA at the time your dog enters his/her first trial as follows:
 - Complete the registration form below
 - Attach a one time registration fee of \$10, payable to ASFA
 - Submit the registration form and fee to the Field Trial Secretary along with for your dog's first ASFA trial entry form.

The Field Trial Secretary will submit the registration form and fee to ASFA along with the trial records. Please retain a copy for your records until you receive a permanent registration number from ASFA.

LCI (LURE COURSING INSTINCT) STAKES ~~~ NEW STAKES ~~~

- Small** - For LCI dogs of 17-1/2" or less at the withers and for all brachycephalic (flat faced) dogs
- Small Open Stake – for Small dogs that have not achieved the title of LCC (Lure Chasing Champion).
 - Small Senior Stake – for Small dogs that have achieved the title of LCC.
 - Small Veteran Stake – for Small dogs that are over the age of 7.

- Large** - For LCI dogs that are over 17-1/2" at the withers
- Large Open Stake – for Large dogs that have not achieved the title of LCC (Lure Chasing Champion).
 - Large Senior Stake – for Large dogs that have achieved the title of LCC.
 - Large Veteran Stake – for Large dogs that are over the age of 7.

- Sighthound Mix** - For dogs with sighthound breed in its background
- Sighthound Mix Open Stake – for Sighthound Mix dogs that have not achieved the title of LCC (Lure Chasing Champion).
 - Sighthound Mix Senior Stake – for Sighthound Mix dogs that have achieved the title of LCC.
 - Sighthound Mix Veteran Stake – for Sighthound Mix dogs that are over the age of 7.

BEST IN FIELD WILL BE OFFERED ON SATURDAY ONLY. Singles, Limited and LCI are not eligible to run for Best in Field.

Conditions of Entry (applies to all stakes)

- Hounds must be one year of age or older on day of trial.
- Stakes will be split into flights by public random draw if the entry in any stake is 20 or more.
- Females in season, lame hounds/dogs and those that are unfit to course will be excused at roll call.
- Hounds with breed disqualifications that are entered in regular breed stakes will be excused at roll call.
- Spayed, neutered, monorchid or cryptorchid without breed disqualifications may be entered in regular hound breed stakes.
- Hounds with breed disqualifications are eligible to enter Singles Stake.
- Hounds/dogs not present at the time of roll call will be scratched.
- All hounds/dogs will be run twice unless excused, dismissed or disqualified.
- All hounds/dogs will run in trios if possible, or braces (except in Singles and LCI stakes).
- A separate entry form is required for each dog for each day.
- All participants must read, understand, sign, and comply with the ASFA Lure Coursing Event COVID-19 Acknowledgement and Liability Waiver

Other Information

- Battery powered continuous loop lure machine will be used. Backup equipment will be available.
- Lure will consist of highly visible plastic strips.
- Exhibitors are requested to not bring bitches known to be in season to the field.
- There will be a \$5.00 fine assessed for any loose hound not participating in the course.
- Any person may, upon reasonable complaint, be asked to leave the grounds of the field trial by the Field Trial Committee.
- The field is partially fenced.
- Children must be under control of their parents or guardians at all times.

LOANER SLIP LEADS AND BLANKETS WILL NOT BE AVAILABLE.

In an effort to reduce the possible spread of COVID-19, we strongly encourage all participants to purchase their own slipeads & and lure coursing jackets. Some vendor suggestions can be found on the end of this premium list..



MINNESOTA COURSING ASSOCIATION

Course Plans

The course will be reversed for the finals, runoffs and Best of Breed. MCA reserves the right to alter the course plan as required by weather and/or field conditions on the date of the trial
Terrain is grassy

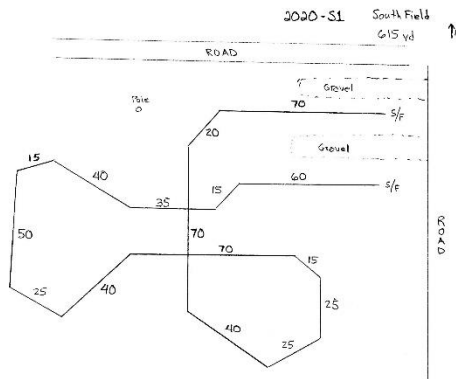

SATURDAY
795 yards

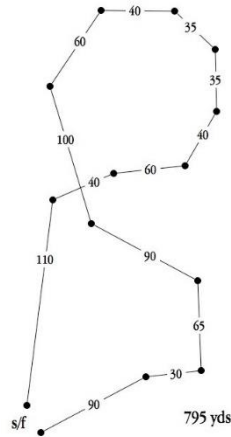

SUNDAY
615 yards

How To Enter

NOTE: THERE IS A 20 DOG LIMIT FOR LCI EACH DAY

IF YOU ARE ENTERING BY MAIL:

Mail your entries to Christine Canard, 3229 36th Ave S, Minneapolis, MN 55406-2128. Make checks payable to MCA. Entries will be considered late if received later than 5:00 pm Wednesday, October 7, 2020. **Be sure to allow plenty of time for delivery.**

IF YOU ARE ENTERING ON THE DAY OF TRIAL (GATE ENTRIES):

Bring your entries and entry fees to the Trial Secretary's table at the field no later than 8:30 am on the day of trial. Make checks payable to MCA.

FOR ALL ENTRIES

Include a completed and signed copy of the "Lure Coursing Event COVID-19 Acknowledgement & Liability Waiver".

FOR ALL FIRST TIME ENTRIES

- Include a copy of your dog's registration papers, but
- If you are entering LCI and your dog has no other registration, include the "OFFICIAL AMERICAN SIGHTHOUND FIELD ASSOCIATION Request for ASFA Lure Chasing Instinct Registration Number" form and one-time registration fee.

FOR FIRST TIME ENTRIES OTHER THAN THOSE ENTERING SINGLES & LCI

Include your "ASFA HOUND CERTIFICATION" form or ASFA approved proof of certification. Retain a copy for your records

Veterinarian on Call



South Metro
Animal
Emergency Care



14690 Pennock Avenue,
Apple Valley, MN 55124
Friday 6 pm - Monday 8 am
(952) 953-3737

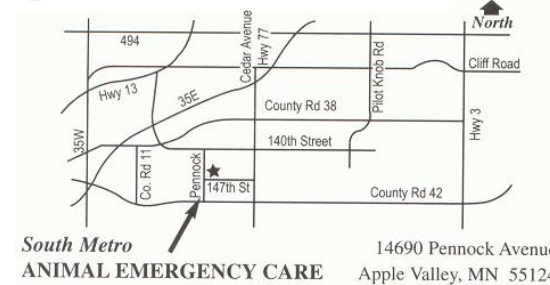

Procedures for COVID-19 Safety

- ✓ We will follow State of Minnesota and local guidelines.
- ✓ Bring your own facial covering. All participants will be required to wear facial coverings when not in their cars.
- ✓ No food will be served, bring your own breakfast and lunch, coffee, water & beverages.
- ✓ We ask that you park at a safe distance from other cars. This may mean that you will not find parking in the shade. Accordingly, be sure to bring plenty of shade for your dog(s) and yourself.
- ✓ There is no water available on or near the South Field. Bring your own water.
- ✓ Roll Call and Inspection will be done at you car, instead of in a central location. The roll call committee will wear gloves and facial coverings. We will ask the owners of females to wipe their dogs and show the inspection committee the tissue.
- ✓ For dogs that require wicketing, the wickets will be wiped down after each dog.
- ✓ Bring your own face covering, hand sanitizer, and wet wipes.
- ✓ Restroom doors will be left open for airflow.
- ✓ Huntmasters will stand 6 feet from the dogs after inspecting blankets and slip leads.
- ✓ At the starting line, all dogs will stand 6 feet apart.
- ✓ Practice social distancing. Act responsibly!!
- ✓ The running order will be posted as usual, and if needed, we will use a bull horn to notify you if you choose to stay by your car.
- ✓ We will also post running orders and scores on the Facebook page for this event. Go to MCA 2020 Labor Day Trial on Facebook.
- ✓ Bring your own poop bags, pens, paper – avoid having to borrow from others.
- ✓ Above all, be safe and have fun with your dogs!!!

How To Register for LCI (Lure Chasing Instinct) Stake for the First Time

All dogs entered in LCI stake must have a registration number. If your dog is registered under any of options A – E below, you must attach a copy (not the original) of the registration certificate to your dog’s first ASFA trial entry form. If your dog is not registered under any of the options A–E below, you may obtain a registration number under paragraph F below.

- A. A registration from AKC or CKC as one of their recognized breeds, or
- B. A registration from AKC “Canine Partners” or CKC (CCN) as a mixed-breed or other ineligible dog for registration under A (above), or
- C. A registration from AKC PAL (Purebreed Alternative Listing), as a pure breed dog ineligible for registration under A (above), or
- D. An FSS (Foundation Stock Service) breed, as a member of a breed that is in the process of obtaining full AKC recognition, or
- E. A registration from UKC (United Kennel Club), which is an international dog registry that focuses on performance, or
- G. If your dog has no registration, you can register your dog with ASFA at the time your dog enters his/her first trial as follows:
 - Complete the registration form entitled “OFFICIAL AMERICAN SIGHTHOUND FIELD ASSOCIATION Request for ASFA Lure Chasing Instinct Registration Number” which is located among the forms toward the end of this premium list.
 - Attach a one time registration fee of \$10, payable to ASFA
 - Submit the registration form and fee to the Field Trial Secretary along with for your dog’s first ASFA trial entry form.

The Field Trial Secretary will submit the registration form and fee to ASFA along with the trial records. Please retain a copy for your records until you receive a permanent registration number from ASFA.



MINNESOTA COURSING ASSOCIATION

Would you like to Help with the Trial? You Can Make a Difference

Whether or not you are an MCA member, please consider volunteering this trial weekend. If you have experience and are willing to work a job or if you wish to apprentice to learn a job, please fill out the form below and return it with your entry to the Field Trial Secretary. As an apprentice you will be paired with a person who knows the job so that you will have one-on-one attention.

I will work on: _____ Saturday ____ Sunday
I will apprentice on: ____ Saturday ____ Sunday

Name: _____

Phone: _____

Email: _____

I am entering dogs of these Stakes on
Saturday: _____

I am entering dogs of these Stakes on
Sunday: _____

Please check jobs that you are willing to do or learn on the day of the trial.

	EXPERIENCED	APPRENTICE
Field Set Up		
Inspection		
Paddock		
Huntmaster		
Lure Operator		
Field Clerk		
Field Tear Down		

THANK YOU FOR VOLUNTEERING.

Your efforts will be greatly appreciated.

OFFICIAL AMERICAN SIGHTHOUND FIELD ASSOCIATION ENTRY FORM

use this form to enter SIGHTHOUNDS in regular, singles, or limited stakes

USE A SEPARATE ENTRY FORM FOR EACH DAY FOR EACH HOUND

MINNESOTA COURSING ASSOCIATION Oct 10-11, 2020

Early Entry Fees: \$20 first entry; \$17 second entry same household; \$10 third & subsequent entries same household.

Day of Trials Entries: \$25 per entry no discounts

See the "How To Enter" in this premium list for instructions for deadlines and other details.

Christine Canard FTS, 3229 36th Ave South, Minneapolis, MN 55406-2128

[] Saturday Oct 10

[] Sunday Oct 11

Fee Paid _____ The Field Secretary cannot accept conditional, unsigned, incomplete or unpaid entries; please check your completed entry carefully.

Breed:		Call Name:	
Registered Name of Hound:			
Stake: <input type="checkbox"/> Open <input type="checkbox"/> FCH <input type="checkbox"/> Veteran <input type="checkbox"/> Single <input type="checkbox"/> Limited		Additional Stakes <input type="checkbox"/> Kennel <input type="checkbox"/> Breeder <input type="checkbox"/> Bench	
Registration Number: (please write in registering body before number)			
<input type="checkbox"/> If possible, please separate my hounds		Date of Birth:	Sex: <input type="checkbox"/> Dog <input type="checkbox"/> Bitch
Name of actual owner(s):			
Address:		Phone:	
City:		State:	Zip:
E-mail (Optional)		(Optional) Region of Residence:	
Emergency Contact Name and Phone (Optional)			
<input type="checkbox"/> Check if this is the first ASFA trial for this hound. Attach a Hound Certification or waiver if entered in Open, Veterans, Limited.			
<input type="checkbox"/> Check if this is a first-time entry, a copy of the official Registration of this hound must accompany this entry unless NGA.			
<input type="checkbox"/> Check if any information has changed since the last ASFA trial entry. Regarding _____			
<input type="checkbox"/> Check if this hound has been dismissed within the last 6 trials entered. Must be marked in order to qualify for a "clean" trial requirement.			

I CERTIFY that I am the actual owner of this dog, or that I am the duly authorized agent of the actual owner whose name I have entered above. In consideration of the acceptance of this entry and the opportunity to have this dog judged and to win prize money, ribbons, or trophies, I (we) agree to abide by the rules and regulations of the American Sighthound Field Association in effect at the time of this lure field trial, and by any additional rules and regulations appearing in the premium list for this lure field trial. I (we) agree that the club holding this lure field trial has the right to refuse this entry for cause, which the club shall deem to be sufficient. I (we) agree to hold this club, its members, directors, governors, officers, agents or other functionaries, any employees of the aforementioned parties and the owner(s) of the trial premises or grounds harmless from any claim for loss or injury which may be alleged to have been caused directly or indirectly to any person or thing by the act of this dog while in or upon the lure field trial premises or grounds or near any entrance thereto and I (we) personally assume all responsibility and liability for any such claim, and I (we) further agree to hold the aforementioned parties harmless from any claim loss of this dog by disappearance, theft damage or injury be caused or alleged to be caused by the negligence of the club or any of the aforementioned parties or by the negligence of any person or any other cause or causes. I (we) certify and represent that the dog entered is not a hazard to person or other dogs. This entry is submitted for acceptance of the forgoing representations and agreements.

SIGNATURE of owner or his agent
duly authorized to make this entry _____

Please separate the entries before submitting to FTS.

OFFICIAL AMERICAN SIGHTHOUND FIELD ASSOCIATION ENTRY FORM

use this form to enter SIGHTHOUNDS in regular, singles, or limited stakes

USE A SEPARATE ENTRY FORM FOR EACH DAY FOR EACH HOUND

MINNESOTA COURSING ASSOCIATION Oct 10-11, 2020

Early Entry Fees: \$20 first entry; \$17 second entry same household; \$10 third & subsequent entries same household.

Day of Trials Entries: \$25 per entry no discounts

See the "How To Enter" in this premium list for instructions for deadlines and other details.

Christine Canard FTS, 3229 36th Ave South, Minneapolis, MN 55406-2128

[] Saturday Oct 10

[] Sunday Oct 11

Fee Paid _____ The Field Secretary cannot accept conditional, unsigned, incomplete or unpaid entries; please check your completed entry carefully.

Breed:		Call Name:	
Registered Name of Hound:			
Stake: <input type="checkbox"/> Open <input type="checkbox"/> FCH <input type="checkbox"/> Veteran <input type="checkbox"/> Single <input type="checkbox"/> Limited		Additional Stakes <input type="checkbox"/> Kennel <input type="checkbox"/> Breeder <input type="checkbox"/> Bench	
Registration Number: (please write in registering body before number)			
<input type="checkbox"/> If possible, please separate my hounds		Date of Birth:	Sex: <input type="checkbox"/> Dog <input type="checkbox"/> Bitch
Name of actual owner(s):			
Address:		Phone:	
City:		State:	Zip:
E-mail (Optional)		(Optional) Region of Residence:	
Emergency Contact Name and Phone (Optional)			
<input type="checkbox"/> Check if this is the first ASFA trial for this hound. Attach a Hound Certification or waiver if entered in Open, Veterans, Limited.			
<input type="checkbox"/> Check if this is a first-time entry, a copy of the official Registration of this hound must accompany this entry unless NGA.			
<input type="checkbox"/> Check if any information has changed since the last ASFA trial entry. Regarding _____			
<input type="checkbox"/> Check if this hound has been dismissed within the last 6 trials entered. Must be marked in order to qualify for a "clean" trial requirement.			

I CERTIFY that I am the actual owner of this dog, or that I am the duly authorized agent of the actual owner whose name I have entered above. In consideration of the acceptance of this entry and the opportunity to have this dog judged and to win prize money, ribbons, or trophies, I (we) agree to abide by the rules and regulations of the American Sighthound Field Association in effect at the time of this lure field trial, and by any additional rules and regulations appearing in the premium list for this lure field trial. I (we) agree that the club holding this lure field trial has the right to refuse this entry for cause, which the club shall deem to be sufficient. I (we) agree to hold this club, its members, directors, governors, officers, agents or other functionaries, any employees of the aforementioned parties and the owner(s) of the trial premises or grounds harmless from any claim for loss or injury which may be alleged to have been caused directly or indirectly to any person or thing by the act of this dog while in or upon the lure field trial premises or grounds or near any entrance thereto and I (we) personally assume all responsibility and liability for any such claim, and I (we) further agree to hold the aforementioned parties harmless from any claim loss of this dog by disappearance, theft damage or injury be caused or alleged to be caused by the negligence of the club or any of the aforementioned parties or by the negligence of any person or any other cause or causes. I (we) certify and represent that the dog entered is not a hazard to person or other dogs. This entry is submitted for acceptance of the forgoing representations and agreements.

SIGNATURE of owner or his agent
duly authorized to make this entry _____

Please separate the entries before submitting to FTS.

OFFICIAL AMERICAN SIGHTHOUND FIELD ASSOCIATION

LCI ENTRY FORM

USE A SEPARATE ENTRY FORM FOR EACH DAY FOR EACH DOG

MINNESOTA COURSING ASSOCIATION Oct 10-11, 2020

Early Entry Fees: \$20 first entry; \$17 second entry same household; \$10 third & subsequent entries same household.

Day of Trials Entries: \$25 per entry no discounts

See the "How To Enter" in this premium list for instructions for deadlines and other details.

Christine Canard FTS, 3229 36th Ave South, Minneapolis, MN 55406-2128

[] Saturday Oct 10

[] Sunday Oct 11

Fee Paid _____ The Field Secretary cannot accept conditional, unsigned, incomplete or unpaid entries; please check your completed entry carefully.

Breed:		Call Name:	
Registered Name of dog:			
Stake: <input type="checkbox"/> LCI-Small <input type="checkbox"/> LCI-Large <input type="checkbox"/> LCI-Sighthound Mix			
<input type="checkbox"/> Open <input type="checkbox"/> Senior <input type="checkbox"/> Veteran			
Registration Number: (please write in registering body before number)			
Date of Birth:		Sex: <input type="checkbox"/> Dog <input type="checkbox"/> Bitch	
Name of actual owner(s):			
Address:		Phone:	
City:		State:	Zip:
E-mail		(Optional) Region of Residence:	
Emergency Contact Name and Phone (Optional)			
<input type="checkbox"/> Check if this is a first-time entry, a copy of the official Registration of this hound must accompany this entry. (i.e., AKC Registration form, PAL registration, Canine Partner, etc.)			
<input type="checkbox"/> Check if any information has changed since the last ASFA trial entry. Regarding _____			

I CERTIFY that I am the actual owner of this dog, or that I am the duly authorized agent of the actual owner whose name I have entered above. In consideration of the acceptance of this entry and the opportunity to have this dog judged and to win prize money, ribbons, or trophies, I (we) agree to abide by the rules and regulations of the American Sighthound Field Association in effect at the time of this lure field trial, and by any additional rules and regulations appearing in the premium list for this lure field trial. I (we) agree that the club holding this lure field trial has the right to refuse this entry for cause, which the club shall deem to be sufficient. I (we) agree to hold this club, its members, directors, governors, officers, agents or other functionaries, any employees of the aforementioned parties and the owner(s) of the trial premises or grounds harmless from any claim for loss or injury which may be alleged to have been caused directly or indirectly to any person or thing by the act of this dog while in or upon the lure field trial premises or grounds or near any entrance thereto and I (we) personally assume all responsibility and liability for any such claim, and I (we) further agree to hold the aforementioned parties harmless from any claim loss of this dog by disappearance, theft damage or injury be caused or alleged to be caused by the negligence of the club or any of the aforementioned parties or by the negligence of any person or any other cause or causes. I (we) certify and represent that the dog entered is not a hazard to person or other dogs. This entry is submitted for acceptance of the forgoing representations and agreements.

SIGNATURE of owner or his agent
duly authorized to make this entry _____

Please separate the entries before submitting to FTS.

OFFICIAL AMERICAN SIGHTHOUND FIELD ASSOCIATION

LCI ENTRY FORM

USE A SEPARATE ENTRY FORM FOR EACH DAY FOR EACH DOG

MINNESOTA COURSING ASSOCIATION Oct 10-11, 2020

Early Entry Fees: \$20 first entry; \$17 second entry same household; \$10 third & subsequent entries same household.

Day of Trials Entries: \$25 per entry no discounts

See the "How To Enter" in this premium list for instructions for deadlines and other details.

Christine Canard FTS, 3229 36th Ave South, Minneapolis, MN 55406-2128

[] Saturday Oct 10

[] Sunday Oct 11

Fee Paid _____ The Field Secretary cannot accept conditional, unsigned, incomplete or unpaid entries; please check your completed entry carefully.

Breed:		Call Name:	
Registered Name of dog:			
Stake: <input type="checkbox"/> LCI-Small <input type="checkbox"/> LCI-Large <input type="checkbox"/> LCI-Sighthound Mix			
<input type="checkbox"/> Open <input type="checkbox"/> Senior <input type="checkbox"/> Veteran			
Registration Number: (please write in registering body before number)			
Date of Birth:		Sex: <input type="checkbox"/> Dog <input type="checkbox"/> Bitch	
Name of actual owner(s):			
Address:		Phone:	
City:		State:	Zip:
E-mail		(Optional) Region of Residence:	
Emergency Contact Name and Phone (Optional)			
<input type="checkbox"/> Check if this is a first-time entry, a copy of the official Registration of this hound must accompany this entry. (i.e., AKC Registration form, PAL registration, Canine Partner, etc.)			
<input type="checkbox"/> Check if any information has changed since the last ASFA trial entry. Regarding _____			

I CERTIFY that I am the actual owner of this dog, or that I am the duly authorized agent of the actual owner whose name I have entered above. In consideration of the acceptance of this entry and the opportunity to have this dog judged and to win prize money, ribbons, or trophies, I (we) agree to abide by the rules and regulations of the American Sighthound Field Association in effect at the time of this lure field trial, and by any additional rules and regulations appearing in the premium list for this lure field trial. I (we) agree that the club holding this lure field trial has the right to refuse this entry for cause, which the club shall deem to be sufficient. I (we) agree to hold this club, its members, directors, governors, officers, agents or other functionaries, any employees of the aforementioned parties and the owner(s) of the trial premises or grounds harmless from any claim for loss or injury which may be alleged to have been caused directly or indirectly to any person or thing by the act of this dog while in or upon the lure field trial premises or grounds or near any entrance thereto and I (we) personally assume all responsibility and liability for any such claim, and I (we) further agree to hold the aforementioned parties harmless from any claim loss of this dog by disappearance, theft damage or injury be caused or alleged to be caused by the negligence of the club or any of the aforementioned parties or by the negligence of any person or any other cause or causes. I (we) certify and represent that the dog entered is not a hazard to person or other dogs. This entry is submitted for acceptance of the forgoing representations and agreements.

SIGNATURE of owner or his agent
duly authorized to make this entry _____

Please separate the entries before submitting to FTS.

USE THIS FORM FOR SIGHTHOUND CERTIFICATIONS

AMERICAN SIGHTHOUND FIELD ASSOCIATION

HOUD CERTIFICATION

Rule effective October 1, 1994: Ch. V, Sec. 4 (a) OPEN STAKE: *To be eligible to enter the open stake, a hound must have been certified by a licensed judge within the year preceding the closing date for the entry or have previously competed in the Open Stake.* This eligibility requirement also applies to a hound entered in the Provisional or Veteran Stake, which has not competed in Open previously. Please complete this portion of this form and attach it to the entry form for the hound's first entry, including an entry for a Fun Trial.

Registered Name of Hound: _____

Registration Number: _____ Breed: _____

Registered Owner's Name: _____

I hereby certify that on (date) _____, the above named hound completed a lure course of at least 500 yards, running with another hound of the same breed (or another breed with a similar running style). During the course the above named hound showed no inclination to interfere with the other hound. I further certify that I am a licensed judge for the ASFA.

Name of Licensed Judge: _____

Signature: _____ Date: _____

I hereby certify that the hound running in the certification course is the hound identified above and that information provided on this form is true and correct.

Signature: _____ Date: _____

Owner or Authorized Agent of Hound

This certification form must be attached to the entry form the first time this hound is entered in an open, limited, or veteran stake. Any hound entered in open, limited, or veteran (as a first time entered hound), which has not been certified, shall be declared ineligible by the records coordinator and shall forfeit any points and placements awarded.

PLEASE RETAIN A COPY FOR YOUR RECORDS.

AMERICAN SIGHTHOUND FIELD ASSOCIATION
HOUD CERTIFICATION WAIVER

Waiver of Requirement: *This requirement will be waived for a hound that has earned a lure coursing or racing title from another recognized organization, if such title requires competition, and if a waiver for such title has been approved by the ASFA, or a CKC Hound Certification Form.* If your hound qualifies for a waiver, complete this portion of this form and attach it to your entry form. Proof of waivers must accompany this certification form.

Registered Name of Hound: _____

Registration Number: _____ Breed: _____

Registered Owner's Name: _____

CKC: FCH FCHX

AKC: QC SC FC

Hound Certification previously submitted.

I hereby certify that the hound identified above has completed the requirements for the title indicated above (or that the required Certification was previously submitted) and that the information provided on this form is true and correct.

Signature: _____ Date: _____

Owner or Authorized Agent of Hound

USE THIS FORM FOR SIGHTHOUND CERTIFICATIONS

AMERICAN SIGHTHOUND FIELD ASSOCIATION

HOUD CERTIFICATION

Rule effective October 1, 1994: Ch. V, Sec. 4 (a) OPEN STAKE: *To be eligible to enter the open stake, a hound must have been certified by a licensed judge within the year preceding the closing date for the entry or have previously competed in the Open Stake.* This eligibility requirement also applies to a hound entered in the Provisional or Veteran Stake, which has not competed in Open previously. Please complete this portion of this form and attach it to the entry form for the hound's first entry, including an entry for a Fun Trial.

Registered Name of Hound: _____

Registration Number: _____ Breed: _____

Registered Owner's Name: _____

I hereby certify that on (date) _____, the above named hound completed a lure course of at least 500 yards, running with another hound of the same breed (or another breed with a similar running style). During the course the above named hound showed no inclination to interfere with the other hound. I further certify that I am a licensed judge for the ASFA.

Name of Licensed Judge: _____

Signature: _____ Date: _____

I hereby certify that the hound running in the certification course is the hound identified above and that information provided on this form is true and correct.

Signature: _____ Date: _____

Owner or Authorized Agent of Hound

This certification form must be attached to the entry form the first time this hound is entered in an open, limited, or veteran stake. Any hound entered in open, limited, or veteran (as a first time entered hound), which has not been certified, shall be declared ineligible by the records coordinator and shall forfeit any points and placements awarded.

PLEASE RETAIN A COPY FOR YOUR RECORDS.

AMERICAN SIGHTHOUND FIELD ASSOCIATION
HOUD CERTIFICATION WAIVER

Waiver of Requirement: *This requirement will be waived for a hound that has earned a lure coursing or racing title from another recognized organization, if such title requires competition, and if a waiver for such title has been approved by the ASFA, or a CKC Hound Certification Form.* If your hound qualifies for a waiver, complete this portion of this form and attach it to your entry form. Proof of waivers must accompany this certification form.

Registered Name of Hound: _____

Registration Number: _____ Breed: _____

Registered Owner's Name: _____

CKC: FCH FCHX

AKC: QC SC FC

Hound Certification previously submitted.

I hereby certify that the hound identified above has completed the requirements for the title indicated above (or that the required Certification was previously submitted) and that the information provided on this form is true and correct.

Signature: _____ Date: _____

Owner or Authorized Agent of Hound

Use this form to request an LCI Registration from ASFA
OFFICIAL AMERICAN SIGHTHOUND FIELD ASSOCIATION
Request for ASFA Lure Chasing Instinct Registration Number

Fee Paid _____ This form is for dogs without any registration number from another registering body.

Please print legibly.

Breed:	Call Name:		
Registered Name of Dog:			
FTS will circle Size after wicketing at Inspection: Sighthound Mix (no need to measure)			
Size Small: up to 17½ inches (or brachycephalic) Size Large: over 17½ inches			
Registration Number: (To be assigned by ASFA records coordinator.)			
Date of Birth:	Sex: <input type="checkbox"/> Dog <input type="checkbox"/> Bitch		
Name of actual owner(s):			
Address:		Phone:	
City:	State:	Zip:	
E-mail	Region of Residence: (Optional)		
Emergency Contact Name and Phone			

This top portion is to be submitted with the \$10 fee to the Field Trial Secretary. First time trial entry on separate form.

_____ was entered in the _____
(Dog's Name) (ASFA Club Name)

ASFA trial held on _____. The dog was wicketed at inspection and is
(Date)
registered as Size _____. The fee of \$10 was received by the FTS and
submitted to the ASFA Records Coordinator.

Printed name of Field Trial Secretary

Signature of Field Trial Secretary

(Owner is to retain this receipt as proof of registration until notified by the ASFA.)

Use this form to request an LCI Registration from ASFA
OFFICIAL AMERICAN SIGHTHOUND FIELD ASSOCIATION
Request for ASFA Lure Chasing Instinct Registration Number

Fee Paid _____ This form is for dogs without any registration number from another registering body.

Please print legibly.

Breed:	Call Name:		
Registered Name of Dog:			
FTS will circle Size after wicketing at Inspection: Sighthound Mix (no need to measure)			
Size Small: up to 17½ inches (or brachycephalic) Size Large: over 17½ inches			
Registration Number: (To be assigned by ASFA records coordinator.)			
Date of Birth:	Sex: <input type="checkbox"/> Dog <input type="checkbox"/> Bitch		
Name of actual owner(s):			
Address:		Phone:	
City:	State:	Zip:	
E-mail	Region of Residence: (Optional)		
Emergency Contact Name and Phone			

This top portion is to be submitted with the \$10 fee to the Field Trial Secretary. First time trial entry on separate form.

_____ was entered in the _____
(Dog's Name) (ASFA Club Name)

ASFA trial held on _____. The dog was wicketed at inspection and is
(Date)
registered as Size _____. The fee of \$10 was received by the FTS and
submitted to the ASFA Records Coordinator.

Printed name of Field Trial Secretary

Signature of Field Trial Secretary

(Owner is to retain this receipt as proof of registration until notified by the ASFA.)

Lure Coursng Event COVID-19 Acknowledgement & Liability Waiver
(All participants must submit this form along with your entries).

I certify that the following is true and complete to the best of my knowledge:

- I do not now have COVID-19.
- I have not had the symptoms of COVID-19 within the past 14 days.
- I have not tested positive for COVID-19 within the past 14 days.
- I have NOT been in contact with a known carrier of COVID-19 within the past 14 days.
- I have NOT been in contact with anyone displaying COVID-19 symptoms within the past 14 days.
- I understand that COVID-19 can be spread by non-symptomatic or pre-sypmtomatic people. Accordingly, I agree to use my best efforts to protect myself and to protect others from the virus at this event, by wearing a facial covering, practicing social distancing, washing my hands, using hand sanitizer, and taking other appropriate measures according to ASFA, MCA, local, state and consistent federal guidelines.
- I acknowledge that there are risks of exposure to COVID-19 due to the nature of Lure Coursing.
- I assume all risk in attending this MCA ASFA event and take full responsibility for my own health and safety during this event.
- I agree to release, waive, discharge and hold harmless from liability ASFA, MCA, Dakota County Fairgrounds, and their officers, members and the participants in this event.

- If any of the above information changes between the time of my signature below and the time of the trial, or if I develop any signs of illness, I shall not attend the trial. I shall report my situation to the Field Trial Secretary to obtain a full refund of my entry fees.**

Place a check mark in each box, indicating that you have read, understand and approved of each statement. Each box must be checked in order to compete in this event. Please complete the designation line, shen sign and date.

Signature or e-signature

Date

Print Name: _____

READ, SIGN AND SUBMIT TO THE FTS WITH YOUR ENTRIES

Lure Coursing Event COVID-19 Acknowledgement & Liability Waiver
(All participants must submit this form along with your entries).

I certify that the following is true and complete to the best of my knowledge:

- I do not now have COVID-19.
- I have not had the symptoms of COVID-19 within the past 14 days.
- I have not tested positive for COVID-19 within the past 14 days.
- I have NOT been in contact with a known carrier of COVID-19 within the past 14 days.
- I have NOT been in contact with anyone displaying COVID-19 symptoms within the past 14 days.
- I understand that COVID-19 can be spread by non-symptomatic or pre-sypmtomatic people. Accordingly, I agree to use my best efforts to protect myself and to protect others from the virus at this event, by wearing a facial covering, practicing social distancing, washing my hands, using hand sanitizer, and taking other appropriate measures according to ASFA, MCA, local, state and consistent federal guidelines.
- I acknowledge that there are risks of exposure to COVID-19 due to the nature of Lure Coursing.
- I assume all risk in attending this MCA ASFA event and take full responsibility for my own health and safety during this event
- I agree to release, waive, discharge and hold harmless from liability ASFA, MCA, Dakota County Fairgrounds, and their officers, members and the participants in this event.

- If any of the above information changes between the time of my signature below and the time of the trial, or if I develop any signs of illness, I shall not attend the trial. I shall report my situation to the Field Trial Secretary to obtain a full refund of my entry fees.**

Place a check mark in each box, indicating that you have read, understand and approved of each statement. Each box must be checked in order to compete in this event. Please complete the designation line, shen sign and date.

Signature or e-signature

Date

Print Name: _____

READ, SIGN AND SUBMIT TO THE FTS WITH YOUR ENTRIES

ENTRY FEE TABLE

Early Entries	Sat. 1 day	Sun. 1 day	Total for 1 day	Total for 2 days
1st	\$20	\$20	\$20	\$40
2nd	\$17	\$17	\$37	\$74
3 rd	\$10	\$10	\$47	\$94
4th	\$10	\$10	\$57	\$114
5th	\$10	\$10	\$67	\$134
Gate Entries	Sat. 1 day	Sun. 1 day	Total for 1 day	Total for 2 days
1st	\$25	\$25	\$25	\$50
2nd	\$25	\$25	\$50	\$100
3 rd	\$25	\$25	\$75	\$150
4th	\$25	\$25	\$100	\$200
5th	\$25	\$25	\$125	\$250

PRACTICES & HOUND CERTIFICATIONS Certifications & hound practices will be available after the trial on **Saturday** (weather, equipment & field conditions permitting). The fee for a certification run is \$5. Make arrangements for a hound to run with, and have the proper form for the judge to sign. Certifications will be run before practice runs as a courtesy to the judges.

REFUNDS - MCA will refund entry fees for anyone who cannot or should not attend the trial due to illness, possible illness, or exposure to illness during the pandemic. Contact the Field Trial Secretary. MCA also provides refunds of entry fees for dogs that are in season or lame, so long as the Field Trial Secretary is notified of the situation **before roll call**. If your dog comes in season or becomes lame before the Trial, and you will not be attending the Trial for that reason, you must notify the Field Trial Secretary BEFORE roll to claim a refund. If the Field Trial Secretary does not receive notice before roll call, MCA will not issue a refund.



LUNCH Due to COVID, MCA will not provide lunch, water, or other refreshments. Bring your own coffee, lunch, water and other refreshments.

Also, Burger King, Subway & McDonalds are close by.

sources for lure coursing **slip leads & jackets**

You can order custom slip leads from
Kay Nierengarten at <https://northwindcatalog.com/product-page-new/slip-leads/>
 or from **Carrie Meyer** at Carriesloan@cox.net

Some Trusted Online Retailers of jackets and slip leads are

Facebook: Canine Corner/ Tru-Luv Whippets
https://www.sosewme.com/coursing_blankets.html
<https://www.followyourlead.com/racing-coursing-jackets.html>
Tracy Rudzitis: www.intrepidgh.com
<http://www.fashionforwarddog.com/lure-coursing-.html>
<https://www.artfire.com/ext/shop/home/BIFBLANKETSANDLEADS>

... or Google "lure coursing supplies", "slip leads" and/or
 "lure coursing jackets" or "lure coursing blankets"

MCA Meeting, communicating & staying informed . . .

Although the coronavirus pandemic prevents all of our club members from safely meeting face-to-face this season, we can still stay in touch.

Here are some options. Start or join a discussion on minnesotacoursingassociation@groups.io. Check out MCA on Facebook at [MCA Group - Minnesota Coursing Association](#), watch for upcoming issues of the [MCA DisCourse](#) and the [ASFA Communique'](#) newsletters or go to www.asfa.org for the current ASFA rules, policies, contacts, clubs, schedules, results, Top 20 and more...

The MCA board members welcome your thoughts, ideas, questions and/or concerns:

Vicki Fagre-Stroetz, Co-Pres stacytazi@yahoo.com
Kathy Nelson, Co-Pres & ASFA Rep rundogs2017@gmail.com
Wayne Olson, VP & Coursing Director wolson308@yahoo.com
Miles Hecht, Treasurer mileshecht@yahoo.com
Shellie Marvin, Secretary, Director shelliem@comcast.net
Kay Nierengarten, Director kay@northwindcatalog.com
Teri Olson, Director sm6349@yahoo.com
Beth Schmidt, Director beths1102@gmail.com