

Cathy Sanderson - FTS
138338 Peters Rd. New Liskeard, ON P0J 1P0
705-380-5308 • fastdogscan@yahoo.com

find us on FACEBOOK: ECHO, Elite Coursing Hounds of Ontario

Kincairn Farm (Casey and Victor Nesbitt)
3874 Old Second Road North
Elmvale, (Springwater), Ontario, L0L 1P0
(Fully fenced hay field)

Directions from Toronto:

HWY 400 to Exit 121 (To Midland/Penetanguishene)
Turn RIGHT /north onto HWY 93 until you are north of the town of ORR LAKE.
Turn LEFT at the traffic light of HWY 27 to the top of the hill. Turn Left onto Old
Second Road North, Arrive at #3874, Destination on the RIGHT into the
CASTLEKEEP Driveway.

Directions from the North

HWY11 south to Trans-Canada HWY/ON 12 N in Orillia. Take the ON -12 W
exit. Turn left onto Vasey Rd/ HWY 23 and follow straight through the traffic light
onto HWY 27. At top of the hill, Turn left onto Old Second Road North. Arrive at
#3874, Destination on the RIGHT into the CASTLEKEEP Driveway.

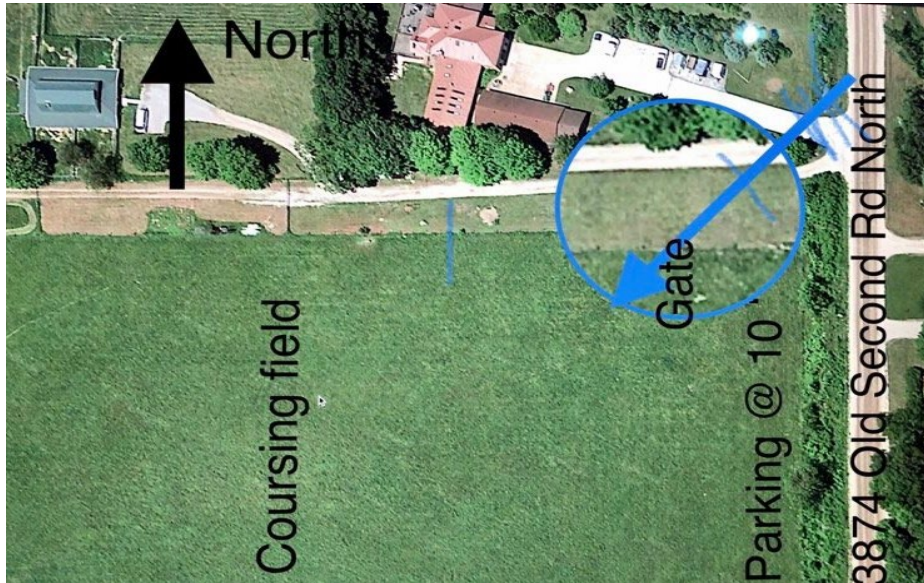

PREMIUM LIST

EARLY ENTRIES CLOSE: Thursday, October 8, 2020 @ 3 pm at the FTS's address NO
DAY OF TRIAL ENTRIES



Elite Coursing Hounds of Ontario, Region 9

ASFA ALL-BREED LURE FIELD TRIALS
LURE CHASING INSTINCT STAKE (25 dog Limit)
Non-Sighthounds and Sighthound mixes
October 10-11, 2020

Entry fees CAD: \$25 first, \$20 second, \$15 third hound, same household



Go to www.ASFA.org
for online Rulebook, Policies, Contacts, Clubs,
Trial Schedules, Trial Results & much more.

Please note we will be following advice from Health Canada
ECHO Covid guidelines will be in place during the Trial
<https://www.canada.ca/en/public-health/services/diseases/coronavirus-disease-covid-19.html>
<https://covid-19.ontario.ca/index.html>

Permission has been granted by the American Sighthound Field Association for the holding of this event under
ASFA Rules and Regulations. Audrey Silverstein, Chairperson, ASFA Scheduling Chair

Elite Coursing Hounds of Ontario (ECHO)

DONNA TOMSON – PRESIDENT JENNIFER JOHANSSON – VICE PRESIDENT
DR. GORDON CHEUNG – SECRETARY/TREASURER

JUDGES & ASSIGNMENTS: #Karen Catt# #Laurie Soutar#

S = Single Judge * = Provisional Judge # = Canadian Judge

SATURDAY

JUDGE	A	Az	Ba	B	C	G	Ib	IW	I	P	R	S	S	S	S	W	Sgl	Ltd	LCI
#Catt#	#	#	#	#	#	#			G			#	D	I	W	#	#	#	
#Soutar#							#	#	#	#	#								#

SUNDAY

JUDGE	A	Az	Ba	B	C	G	Ib	IW	I	P	R	S	S	S	S	W	Sgl	Ltd	LCI
#Catt#						#		#	#	#	#								#
#Soutar#	#	#	#	#	#		#					#	#	#	#	#	#	#	

FIELD TRIAL COMMITTEE

Field Trial Chairman	Donna Tomson (Cell phone on field - 705 321 9391)
Field Trial Secretary	Cathy Sanderson 138338 Peters Rd. New Liskeard, ON P0J 1P0
Lure Operators	Lucie Chauvette, Donna Tomson, Gordon Cheung, Cathy Sanderson, Laurie Soutar
Field Clerks	Marni Smith, Helen Ferguson, Lori Siddons, Jennifer Johansson,
Huntmasters	Lucie Chauvette, Helen Ferguson, Lori Siddons, Erin McCorkell
Inspection	Helen Ferguson, Lori Siddons, Donna Tomson
Paddock	Lori Siddons, Mike Maybee, Vanessa Lobo
Equipment Crew	Donna Tomson, Gordon Cheung, Marni Smith, Cathy Sanderson
Hospitality	Lori Siddons, Donna Tomson, Jennifer Johansson

TRIAL HOURS: 7:30 am UNTIL AFTER RIBBONS ARE AWARDED.

NO Day of Trial entries

ROLL CALL: PROMPTLY at 8:30 am
(Earlier for Field Committee, if available)

IMPORTANT Entry and e-transfer RULES

Virtual ribbons/certificates or rosettes will be offered for all placements.

First=Blue, Second=Red, Third=Yellow, Fourth=White, NBQ=Green

High Scoring Single=Navy/Gold, BIF=Red, White & Blue.

- Please E-transfer Entry fees to: Gordon Cheung, treasurer, at flashgordoc@hotmail.com. If paying by PayPal, add \$2 per PayPal fee.
- Please Email entries to the Cathy Sanderson FTS, fastdogscan@yahoo.com, by 3:00 pm, Oct 8, 2020.
- Please mail all cheques to **Cathy Sanderson** - FTS
- 138338 Peter's Rd. New Liskeard, ON P0J 1P0, payable to "ECHO"
- Late, incomplete, unsigned, or UNPAID entries will NOT be accepted.

- Entries will not be acknowledged.
- ALL RETURNED CHECKS WILL BE CHARGED A \$40 FEE.

ELIGIBLE BREEDS & REGISTRY

Only purebred Afghan Hounds, Azawakhs, Basenjis, Borzoi, Cirneco dell'Etna, Greyhounds, Ibizan Hounds, Irish Wolfhounds, Italian Greyhounds, Pharaoh Hounds, Rhodesian Ridgebacks, Salukis, Scottish Deerhounds, Sloughis, Silken Windhounds and Whippets may be entered in the regular stakes.

Limited breeds may be entered in the Limited Stake or the Singles Stake. Limited breeds currently include purebred Chart Polski, Galgo Español, Magyar Agar, Peruvian Inca Orchid, Portuguese Podengo (Pequeno), Portuguese Podengo (Medio & Grande), and must be individually registered with the appropriate registry.

All entries shall be individually registered with the AKC (ILP/PAL included), the NGA, the UKC, the FCI, an ASFA-recognized foreign or ASFA Board approved registry or possess a CRN from the SPDBS. A photocopy of acceptable registry must be submitted with each hound's first ASFA field trial entry; this requirement is waived for hounds registered with the NGA.

REGULAR STAKES OFFERED

OPEN STAKE: Any eligible sighthound, that has met the certification requirements, excluding ASFA Field Champions of record.

FIELD CHAMPION STAKE: Any ASFA Field Champion

VETERAN STAKE: Any eligible hound, that has met the certification requirements, whose age is at least six years, except Irish Wolfhounds whose age shall be at least five years, and Afghan Hounds, Rhodesian Ridgebacks Salukis and Whippets whose age shall be at least seven years. Points go toward V-FCh or V-LCM titles.

LIMITED STAKE: Any eligible sighthound of a Limited breed that has met certification requirements. Not eligible to compete in Best of Breed or Best in Field.

SINGLE STAKE: Any eligible sighthound including those disqualified to run in other stakes. Each hound runs alone. Not eligible for Best of Breed or Best in Field. Hounds are eligible to earn TCP and CPX titles from the Singles stake. Limited breeds are not eligible for these titles.

BEST IN FIELD OFFERED BOTH DAYS

Conditions of Entry: All entries must be one year or older on the day of the trial

- Stakes will be split into flights by public random draw if the entry in any regular stake is 20 or more
- Bitches in season, lame hounds and hounds with breed disqualifications will be excused at roll call.
- Spayed, neutered, monorchid or cryptorchid hounds without breed disqualifications may be entered; hounds with breed disqualifications are not eligible to enter except in the Single Stake
- Hounds not present at the time of roll call will be scratched
- All hounds will run twice, in trios if possible or braces (except in the Single Stake), unless excused, dismissed or disqualified.

LURE CHASING INSTINCT (LCI) STAKE

All dogs entered must have a registration number via one of the following:
(A photocopy of acceptable registry must be submitted with each dog's first ASFA field trial entry).

- A. AKC/CKC Registration as one of the recognized breeds.
- B. CKC (CCN)/AKC Canine Partners, which is for mixed-breed dogs and dogs ineligible for AKC/CKC registration.
- C. Purebred Alternative Listing (PAL) program, which is for purebred dogs that cannot be fully registered with the AKC to participate in AKC events.
- D. Foundation Stock Service® (FSS), which is for recorded breeds on the road to full AKC recognition.
- E. United Kennel Club (UKC) registration as one of the recognized breeds.
- F. Dogs without a recognized registry number may obtain a unique and permanent ASFA ID number for a one time \$10 registration fee at time of entry (entry form below). The Trial Secretary will submit a copy of the form with the records. The owner will retain a copy as proof of request and payment until a permanent number is provided.

LURE COURSING INSTINCT (LCI) STAKES:

Small Open: Dogs 17-1/2" or less at the withers and/or brachycephalic ("flat-faced") dogs who have not achieved the title of LCC.

Small Senior: Dogs 17-1/2" or less at the withers and/or brachycephalic dogs who have achieved the title of LCC.

Small Veteran: Dogs 17-1/2" or less at the withers and/or brachycephalic dogs over the age of 7 years.

Large Open: Dogs over 17-1/2" at the withers who have not achieved the title of LCC.

Large Senior: Dogs over 17-1/2" at the withers who have achieved the title of LCC.

Large Veteran: Dogs over 17-1/2" at the withers who are over the age of 7 years.

Sighthound Mix Open: Dogs with a sighthound breed in its background who have not achieved the title of LCC.

Sighthound Mix Senior: Dogs with sighthound breed in its background who have achieved the title of LCC.

Sighthound Mix Veteran: Dogs with sighthound breed in its background over the age of 7 years.

- When running as a stake within a regular ASFA trial, Small will run 50% of the ASFA course as laid out for the sighthounds up to a maximum of 400 yards.
- All other stakes will run the full ASFA laid out course length.
- All entries must be one year or older on the day of the Trial.
- Bitches in season and lame hounds will be excused at roll call.
- All hounds will run twice.
- All entries must be one year or older on the day of the Trial
- \$5.00 fine assessed for any loose hound not participating in the course.
- Practice on Saturday, weather, equipment, and time permitting,
\$10.00 per run or \$15 for two runs

24 Hour Veterinary Clinic on Call

705-722-0377

Huron Veterinary Emergency Clinic
391 Dunlop St W. Barrie, ON L4N 1C3

ACCOMMODATIONS:

OVERNIGHT PARKING & CAMPING IS PERMITTED

RV Parking will be available at the trial site for \$10.00/night
(Porta Potty on site – NO HOOK-UPS – No Open Fires)

Nearby Pet-Friendly Hotels:

- Travelodge by Wyndham Barrie on Bayfield 705 996 0702
- Comfort Inn Midland 705 526 2090

These are in Midland or Barrie Ontario and offer ground floor rooms.

Please Note That Some of This Hotel May Have Changed Their Policies Since This List Was Compiled So We Strongly Recommend That You Confirm Their Pet Policy and Rates When Making Your Reservation.

SOCIAL DISTANCING & THINGS TO KNOW:

- Please bring water and shade for your dogs.
- Please pickup after your dog.
- Bring a garbage bag and kindly take all garbage home with you.
- Any person may, upon reasonable complaint, be asked to leave the grounds of the field trial by the Field Trial Committee.
- American exhibitors: Please bring a current rabies certificate for each dog crossing the border.
- A Porta Potty will be available.
- Bring your pens and pencils, masks and wipes.
- Face coverings are required for all competitors.
- Please park a safe distance from each other (6-10' apart)
- If socializing, there will be no groupings of more than 10 people outside your household, each person standing 2 metres apart
- Cell phone on the Field: 705 321 9391

Liability Agreement: By entering this trial, I agree to the following:

I (We) agree to be bound by the rules and regulations of Kincairn Farm and their owners agents/ staff as hosts of this event. I (We) understand that violation of these rules will result in my(our) expulsion from the event and from the property. I (we) personally assume all responsibility and liability for the action of the dog(s) listed below and further agree to hold Kincairn farm, their owners, agents and staff blameless for disappearance, theft, injury, death or otherwise of the dogs listed below as a result of participating in this event on this property. I (we) certify that the dog(s) entered in this event is not a hazard to persons or other dogs (applicable to any dog in my (our) possession, entered or otherwise on this property. I agree to keep my dog(s) under my control at all times whilst on the property of Kincairn Farm.

OFFICIAL AMERICAN SIGHTHOUND FIELD ASSOCIATION ENTRY FORM

ELITE COURSING HOUNDS OF ONTARIO

SATURDAY October 10th, 2020, All entries close 3PM Oct 8th, 2020 at the FTS's residence,
138338 Peters Rd. New Liskeard, ON P0J 1P0

\$25 first, \$20 second, \$15 third hound entered, same household; No Day of Trial Entries

(Substitutions for lame or in-season hounds, same owner, until 8am day of trial)

E-transfer Entry fees to: Gordon Cheung, treasurer, at flashgordoc@hotmail.com

If paying by PayPal, add \$2 per PayPal fee.

Fee Paid _____ The Field Secretary cannot accept conditional, unsigned, incomplete or unpaid entries.	
Breed:	Call Name:
Registered Name of Hound:	
Stake: <input type="checkbox"/> Open <input type="checkbox"/> FCH <input type="checkbox"/> Veteran <input type="checkbox"/> Single <input type="checkbox"/> Limited	Additional Stakes <input type="checkbox"/> Kennel <input type="checkbox"/> Breeder <input type="checkbox"/> Bench
Registration Number (please write in registering body before number)	
<input type="checkbox"/> If possible, please separate my hounds	Date of Birth: Sex: <input type="checkbox"/> Dog <input type="checkbox"/> Bitch
Name of actual owner(s):	
Address:	Phone:
City:	State: Zip:
E-mail (Optional)	(Optional) Region of Residence:
Emergency Contact Name and Phone (Optional)	
<input type="checkbox"/> Check if this is the first ASFA trial for this hound. Attach a Hound Certification or waiver if entered in Open, Veterans, Limited. <input type="checkbox"/> Check if this is a first-time entry, a copy of the official Registration of this hound must accompany this entry unless NGA. <input type="checkbox"/> Check if any information has changed since the last ASFA trial entry. Regarding _____ <input type="checkbox"/> Check if this hound has been dismissed within the last 6 trials entered. Must be marked in order to qualify for a "clean" trial requirement.	

I CERTIFY that I am the actual owner of this dog, or that I am the duly authorized agent of the actual owner whose name I have entered above. In consideration of the acceptance of this entry and the opportunity to have this dog judged and to win prize money, ribbons, or trophies, I (we) agree to abide by the rules and regulations of the American Sighthound Field Association in effect at the time of this lure field trial, and by any additional rules and regulations appearing in the premium list for this lure field trial. I (we) agree that the club holding this lure field trial has the right to refuse this entry for cause, which the club shall deem to be sufficient. I (we) agree to hold this club, its members, directors, governors, officers, agents or other functionaries, any employees of the aforementioned parties and the owner(s) of the trial premises or grounds harmless from any claim for loss or injury which may be alleged to have been caused directly or indirectly to any person or thing by the act of this dog while in or upon the lure field trial premises or grounds or near any entrance thereto and I (we) personally assume all responsibility and liability for any such claim, and I (we) further agree to hold the aforementioned parties harmless from any claim loss of this dog by disappearance, theft damage or injury be caused or alleged to be caused by the negligence of the club or any of the aforementioned parties or by the negligence of any person or any other cause or causes. I (we) certify and represent that the dog entered is not a hazard to person or other dogs. This entry is submitted for acceptance of the forgoing representations and agreements.

Signature: _____ Date: _____
Owner or Authorized Agent of Hound

OFFICIAL AMERICAN SIGHTHOUND FIELD ASSOCIATION ENTRY FORM

ELITE COURSING HOUNDS OF ONTARIO

SUNDAY October 11th, 2020, All entries close 3PM Oct 8th, 2020 at the FTS's residence,
138338 Peters Rd. New Liskeard, ON P0J 1P0

[\$25 first, \$20 second, \$15 third hound entered, same household]; No Day of Trial Entries

(Substitutions for lame or in-season hounds, same owner, until 8am day of trial)

E-transfer Entry fees to: Gordon Cheung, treasurer, at flashgordoc@hotmail.com

If paying by PayPal, add \$2 per PayPal fee.

Fee Paid _____ The Field Secretary cannot accept conditional, unsigned, incomplete or unpaid entries.	
Breed:	Call Name:
Registered Name of Hound:	
Stake: <input type="checkbox"/> Open <input type="checkbox"/> FCH <input type="checkbox"/> Veteran <input type="checkbox"/> Single <input type="checkbox"/> Limited	Additional Stakes <input type="checkbox"/> Kennel <input type="checkbox"/> Breeder <input type="checkbox"/> Bench
Registration Number (please write in registering body before number)	
<input type="checkbox"/> If possible, please separate my hounds	Date of Birth: Sex: <input type="checkbox"/> Dog <input type="checkbox"/> Bitch
Name of actual owner(s):	
Address:	Phone:
City:	State: Zip:
E-mail (Optional)	(Optional) Region of Residence:
Emergency Contact Name and Phone (Optional)	
<input type="checkbox"/> Check if this is the first ASFA trial for this hound. Attach a Hound Certification or waiver if entered in Open, Veterans, Limited. <input type="checkbox"/> Check if this is a first-time entry, a copy of the official Registration of this hound must accompany this entry unless NGA. <input type="checkbox"/> Check if any information has changed since the last ASFA trial entry. Regarding _____ <input type="checkbox"/> Check if this hound has been dismissed within the last 6 trials entered. Must be marked in order to qualify for a "clean" trial requirement.	

I CERTIFY that I am the actual owner of this dog, or that I am the duly authorized agent of the actual owner whose name I have entered above. In consideration of the acceptance of this entry and the opportunity to have this dog judged and to win prize money, ribbons, or trophies, I (we) agree to abide by the rules and regulations of the American Sighthound Field Association in effect at the time of this lure field trial, and by any additional rules and regulations appearing in the premium list for this lure field trial. I (we) agree that the club holding this lure field trial has the right to refuse this entry for cause, which the club shall deem to be sufficient. I (we) agree to hold this club, its members, directors, governors, officers, agents or other functionaries, any employees of the aforementioned parties and the owner(s) of the trial premises or grounds harmless from any claim for loss or injury which may be alleged to have been caused directly or indirectly to any person or thing by the act of this dog while in or upon the lure field trial premises or grounds or near any entrance thereto and I (we) personally assume all responsibility and liability for any such claim, and I (we) further agree to hold the aforementioned parties harmless from any claim loss of this dog by disappearance, theft damage or injury be caused or alleged to be caused by the negligence of the club or any of the aforementioned parties or by the negligence of any person or any other cause or causes. I (we) certify and represent that the dog entered is not a hazard to person or other dogs. This entry is submitted for acceptance of the forgoing representations and agreements.

Signature: _____ Date: _____
Owner or Authorized Agent of Hound

OFFICIAL AMERICAN SIGHTHOUND FIELD ASSOCIATION ENTRY FORM

ELITE COURSING HOUNDS OF ONTARIO

LURE CHASING INSTINCT ENTRY FORM

SATURDAY Oct 10th, 2020, All entries close **3PM Oct 8th, 2020** at the FTS's residence,
138338 Peters Rd. New Liskeard, ON P0J 1P0

\$25 first, \$20 second, \$15 third hound entered, same household; No Day of Trial Entries

E-transfer Entry fees to: Gordon Cheung, treasurer, at flashgordoc@hotmail.com, If paying by PayPal, please add \$2 Fee Paid
The Field Secretary cannot accept conditional, unsigned, incomplete or unpaid entries

Breed (If known) or Mix:		Call Name:	
Registered Name of Dog:			
Stake: (Choose one)	<input type="checkbox"/> Open (dogs who have not achieved the title of LCC) <input type="checkbox"/> Senior (dogs who have achieved the title of LCC) <input type="checkbox"/> Veteran (over age 7)		
Height at withers or Sighthound Mix (choose one)	<input type="checkbox"/> LCI Small: ≤17.5" or any height brachycephalic (flat-faced dogs) <input type="checkbox"/> LCI Large: > 17.5" <input type="checkbox"/> LCI Sighthound Mix		
Registration Number: (please write in registering body before number)			
Date of Birth (if known):	Sex: <input type="checkbox"/> Dog <input type="checkbox"/> Bitch	Height:	
Name of actual owner(s):			
Address:		Phone:	
City:	State:	Zip:	
E-mail	(Optional) Region of Residence:		
Emergency Contact Name and phone (optional)			
<input type="checkbox"/> Check if this is a first-time entry, a copy of the official Registration of this hound must accompany this entry. (i.e., AKC Registration form, PAL registration, Canine Partner, etc.)			
<input type="checkbox"/> Check if any information has changed since the last ASFA trial entry. Regarding _____			
<input type="checkbox"/> Check if this dog has been dismissed within the last 6 trials entered. Must be marked in order to qualify for a "clean" trial requirement.			

I CERTIFY that I am the actual owner of this dog, or that I am the duly authorized agent of the actual owner whose name I have entered above. In consideration of the acceptance of this entry and the opportunity to have this dog judged and to win prize money, ribbons, or trophies, I (we) agree to abide by the rules and regulations of the American Sighthound Field Association in effect at the time of this lure field trial, and by any additional rules and regulations appearing in the premium list for this lure field trial. I (we) agree that the club holding this lure field trial has the right to refuse this entry for cause, which the club shall deem to be sufficient. I (we) agree to hold this club, its members, directors, governors, officers, agents or other functionaries, any employees of the aforementioned parties and the owner(s) of the trial premises or grounds harmless from any claim for loss or injury which may be alleged to have been caused directly or indirectly to any person or thing by the act of this dog while in or upon the lure field trial premises or grounds or near any entrance thereto and I (we) personally assume all responsibility and liability for any such claim, and I (we) further agree to hold the aforementioned parties harmless from any claim loss of this dog by disappearance, theft damage or injury be caused or alleged to be caused by the negligence of the club or any of the aforementioned parties or by the negligence of any person or any other cause or causes. I (we) certify and represent that the dog entered is not a hazard to a person or other dogs. This entry is submitted for acceptance of the foregoing representations and agreements

SIGNATURE of owner or his agent
duly authorized to make this entry: _____ Date: _____

Please separate the entries before submitting to FTS

OFFICIAL AMERICAN SIGHTHOUND FIELD ASSOCIATION ENTRY FORM

ELITE COURSING HOUNDS OF ONTARIO

LURE CHASING INSTINCT ENTRY FORM

SUNDAY Oct 11th, 2020, All entries close **3PM Oct 8th, 2020** at the FTS's residence,
138338 Peters Rd. New Liskeard, ON P0J 1P0

[\$25 first, \$20 second, \$15 third hound entered, same household]; No Day of Trial Entries

E-transfer Entry fees to: Gordon Cheung, treasurer, at flashgordoc@hotmail.com, If paying by PayPal, please add \$2 fee.
Fee Paid The Field Secretary cannot accept conditional, unsigned, incomplete or unpaid entries

Breed (If known) or Mix:		Call Name:	
Registered Name of Dog:			
Stake: (Choose one)	<input type="checkbox"/> Open (dogs who have not achieved the title of LCC) <input type="checkbox"/> Senior (dogs who have achieved the title of LCC) <input type="checkbox"/> Veteran (over age 7)		
Height at withers or Sighthound Mix (choose one)	<input type="checkbox"/> LCI Small: ≤17.5" or brachycephalic (flat-faced dogs) <input type="checkbox"/> LCI Large: > 17.5" <input type="checkbox"/> LCI Sighthound Mix		
Registration Number: (please write in registering body before number)			
Date of Birth (if known):	Sex: <input type="checkbox"/> Dog <input type="checkbox"/> Bitch	Height:	
Name of actual owner(s):			
Address:		Phone:	
City:	State:	Zip:	
E-mail	(Optional) Region of Residence:		
Emergency Contact Name and phone (optional)			
<input type="checkbox"/> Check if this is a first-time entry, a copy of the official Registration of this hound must accompany this entry. (i.e., AKC Registration form, PAL registration, Canine Partner, etc.)			
<input type="checkbox"/> Check if any information has changed since the last ASFA trial entry. Regarding _____			
<input type="checkbox"/> Check if this dog has been dismissed within the last 6 trials entered. Must be marked in order to qualify for a "clean" trial requirement.			

I CERTIFY that I am the actual owner of this dog, or that I am the duly authorized agent of the actual owner whose name I have entered above. In consideration of the acceptance of this entry and the opportunity to have this dog judged and to win prize money, ribbons, or trophies, I (we) agree to abide by the rules and regulations of the American Sighthound Field Association in effect at the time of this lure field trial, and by any additional rules and regulations appearing in the premium list for this lure field trial. I (we) agree that the club holding this lure field trial has the right to refuse this entry for cause, which the club shall deem to be sufficient. I (we) agree to hold this club, its members, directors, governors, officers, agents or other functionaries, any employees of the aforementioned parties and the owner(s) of the trial premises or grounds harmless from any claim for loss or injury which may be alleged to have been caused directly or indirectly to any person or thing by the act of this dog while in or upon the lure field trial premises or grounds or near any entrance thereto and I (we) personally assume all responsibility and liability for any such claim, and I (we) further agree to hold the aforementioned parties harmless from any claim loss of this dog by disappearance, theft damage or injury be caused or alleged to be caused by the negligence of the club or any of the aforementioned parties or by the negligence of any person or any other cause or causes. I (we) certify and represent that the dog entered is not a hazard to a person or other dogs. This entry is submitted for acceptance of the foregoing representations and agreements

SIGNATURE of owner or his agent
duly authorized to make this entry: _____ Date: _____

Please separate the entries before submitting to FTS

OFFICIAL ASFA Request for Unique Entry Number FORM
ELITE COURSING HOUNDS OF ONTARIO
This form is for LCI dogs that DO NOT have a registration number

\$15 per dog for a Unique Entry Number. This one-time fee is separate from the entry fee.

Fee Paid _____

Breed: (If known) or Mix		Call Name:	
Name of Dog as you would like it registered			
FTS will check correct class size after wicketing at inspection,		<input type="checkbox"/> Small height class: ≤17.5" or brachycephalic (flat-faced dogs) <input type="checkbox"/> Large height class: >17.5" <input type="checkbox"/> Sighthound Mix	
Registration Number: (temporary number assigned by Trial Secretary)			
Date of Birth (if known):		Sex: <input type="checkbox"/> Dog <input type="checkbox"/> Bitch	
Name of actual owner(s):			
Address:		Phone:	
City:		State:	Zip:
E-mail (Optional)		(Optional) Region of Residence:	
Emergency Contact: Name and phone number (optional)			

This top portion is to be submitted with the \$15 Unique Entry Number Form and Lure Chasing Instinct Form.

_____ was entered in the **ECHO**
(Dog's name) ASFA Club initials

ASFA trial held on (date) _____. The dog was wicked at inspection and is registered as a Class Size _____. The fee of \$15 was received by the FTS and submitted to the ASFA Records Coordinator.

Printed name of Field Trial Secretary: _____

Signature of Field Trial Secretary: _____

(Owner is to retain this receipt as proof of registration until notified by the ASFA)

OFFICIAL ASFA Request for Unique Entry Number FORM
ELITE COURSING HOUNDS OF ONTARIO
This form is for LCI dogs that DO NOT have a registration number

\$15 per dog for a Unique Entry Number. This one-time fee is separate from the entry fee.

Fee Paid _____

Breed: (If known) or Mix		Call Name:	
Name of Dog as you would like it registered			
FTS will check correct class size after wicketing at inspection,		<input type="checkbox"/> Small height class: ≤17.5" or brachycephalic (flat-faced dogs) <input type="checkbox"/> Large height class: >17.5" <input type="checkbox"/> Sighthound Mix	
Registration Number: (temporary number assigned by Trial Secretary)			
Date of Birth (if known):		Sex: <input type="checkbox"/> Dog <input type="checkbox"/> Bitch	
Name of actual owner(s):			
Address:		Phone:	
City:		State:	Zip:
E-mail (Optional)		(Optional) Region of Residence:	
Emergency Contact: Name and phone number (optional)			

This top portion is to be submitted with the \$15 Unique Entry Number Form and Lure Chasing Instinct Form.

_____ was entered in the **ECHO**
(Dog's name) ASFA Club initials

ASFA trial held on (date) _____. The dog was wicked at inspection and is registered as a Class Size _____. The fee of \$15 was received by the FTS and submitted to the ASFA Records Coordinator.

Printed name of Field Trial Secretary: _____

Signature of Field Trial Secretary: _____

(Owner is to retain this receipt as proof of registration until notified by the ASFA)

ECHO COVID General Guidelines

A medical doctor will be on site to ensure adherence to all Health Canada, Ontario Provincial and local guidelines. More specific details and updates will be distributed just prior to the trial.

- Face coverings are required for all Field Committee members and volunteers.
- Face coverings are required for all competitors at the start line.
- Extra masks are available for \$2 donation.

Roll Call:

- To be performed in accordance with Provincial Guidelines.
- Sighthounds and LCI dogs will be measured with minimal contact.
- LCI: Depending on the number of entries, roll call and start times may be staggered for LCI dogs.
- Owners will swipe their female dog(s) and show the inspection committee the tissue.

Running the dogs:

- Competitors will be a minimum of 2 metres apart at the start.

Once you have finished Running your dog:

- There will be hand sanitizer available in designated areas.
- Virtual ribbons/certificates will be emailed.

Unfortunately for the time being, we must forego some traditions, such as convening for a bite to eat and the evening social. However, in the spirit of the sport, we can still get out, maybe catch up with a friend and have a fun day with our dogs.

ECHO NEEDS YOU

Want to help out at the trial? Kindly let the FTS know if you are interested in doing/learning a job and or shadowing a worker bee at the trial. This will help our trials run smoother and to give other workers a break.

*Whether or not you are an ECHO member, please consider volunteering at this trial weekend. ECHO would like to give a big shout out to the **Lake Country Lure Coursers (LCLC)** members for donation of back up equipment and manpower.*

If you have experience and are willing to work a job or want to learn a job, please fill out the form below and return it with your entry to the Field Trial Secretary.

1. I will work on _____ Saturday _____ Sunday
I will apprentice on _____ Saturday _____ Sunday

Name: _____
Phone: _____
Email: _____

2. I am running dogs of these breeds on Saturday _____
I am running dogs of these breeds on Sunday _____

3. Check jobs you have *experience* with and are willing to do the day of the Trial.

If you are willing to apprentice, check jobs, you would like to learn. We will pair you with a person who knows the job, and you will get one-on-one attention.

	EXPERIENCED	APPRENTICE
Lure OP	_____	_____
Huntmaster	_____	_____
Roll Call	_____	_____
Paddock	_____	_____
Field Clerk	_____	_____
Field Set up	_____	_____
Field Tear Down	_____	_____

THANK YOU FOR VOLUNTEERING.

Everyone will appreciate your efforts, and the Trial will run more smoothly

Type of lure machine: GAS-powered, continuous-loop system. • Type of lures: highly-visible white plastic strips • Back-up equipment will be available.

Course plans: ECHO reserves the right to alter the course plans, as required, by weather and/or field conditions on the day of the Trial.

Saturday

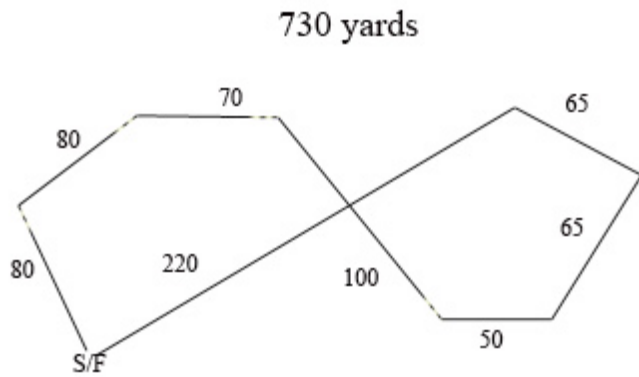

Course plans: ECHO reserves the right to alter the course plans, as required, by weather and/or field conditions on the day of the Trial.

Sunday

