

Field Trial Secretary: Ginny Merchant

Mail Entries to: [38741 Ilex Trail](tel:387411111)

[Eustis, FL 32736 352-589-2521](tel:3525892521) [Kengali53@gmail.com](mailto:Kengali53@gmail.com)

Questions?? Call 5867640634 (Matt) or 8137868963(Ginny) or email [deberhard21@yahoo.com](mailto:deberhard21@yahoo.com)

**Trial Address:**  
**The Grand Oaks Resort**  
**3000 Marion County Road**  
**Weirsdale, FL 32159**

**From the North on I-75:** Exit 341, East on 484 to 27/441. Make a right onto 27/441 South and travel to CR 42 East. Travel to Weirsdale and turn right onto CR 25 South. Travel 2 miles and turn left onto Marion County Road, travel 1.4 miles and turn right into The Grand Oaks. *(Please use second entrance for autos only. RV GUESTS MUST USE 3525 GRIFFIN AVENUE ENTRANCE)*

**From the South on I-75:** Exit 329, travel East on Route 44 to Wildwood and turn left onto Route 301. Travel North. Turn right onto Route 42. Proceed to Weirsdale and turn right onto CR 25. Travel South 2 miles and turn left onto Marion County Road, travel 1.4 miles and turn right into The Grand Oaks. *(Please use second entrance for autos only. RV GUESTS MUST USE 3525 GRIFFIN AVENUE ENTRANCE)*

**IMPORTANT DATE!!!:**  
**Friday, March 11 2016**

**Early Entry Deadline for SSRRC Sunday Trial**  
**(Day of Trial entries accepted)**

**Entry Deadline for Region 7 Invitational**  
**(NO DAY OF TRIAL ENTRIES ACCEPTED!!)**

**Deadline for T-shirt Orders**

**Deadline for Regional Dinner Rsvp**

## PREMIUM LIST

ENTRIES CLOSE 9:00 PM Friday, March, 11 2016 at the FTS's address

**NO DAY OF TRIAL ENTRIES** (for the Region7 Invitational only) **Sunday day of Trial entries will be accepted up to ½ hour before Roll Call (7:30 am)**  
**Substitutions (same owner) until 7:30 AM Day of Trial EXCEPT for Regional Invitational.**



**SSRRC Easter Trial**  
**Sunday March 27, 2016**

**The Grand Oaks Resort**  
**3000 Marion County Road**  
**Weirsdale, FL 32159**

Entry Fees for Both Events.

\$20 first hound \$15 each additional hound, same household

(Single Stake entries limited to 10 by postmark)

\$5 Per Pair for Breeder Stakes

\$5 Per Pair for Kennel Stakes

\$5 Per Hound for Bench Stakes

**See Regional Invitational**  
**Requirements on Page 3**

**\$30 DAY OF TRIAL**  
**ENTRYS (Sunday only)**

*Permission has been granted by the American Sighthound Field Association for the holding of this event under ASFA Rules and Regulations.*  
*Audrey Silverstein ASFA Scheduling Chair*

### SSRRC Officers

President Matt Coughlin  
Vice President Linda Gaunuard  
Secretary Ginny Merchant  
Treasurer Lisa Mcelroy  
Board Members Jane Hils, Stacey Tucker, Julia Toole

### ASFA Officers and Board of Directors

Pres.: Ping Pirrung, 1st VP: Richard Whritenour, 2nd VP Gary Roush  
Corr. Sec.: Bill Bowlus-Root Recording Sec.: Joe  
Shoemaker, Chief Financial Officer: Jeff Lipps  
Region 1 Director: Karen Sanders Region 2 Director: Rick Wolpin  
Region 3 Director: Tom Golcher Region 4 Director: Gary Runyan  
Region 5 Director: Kent Standerford Region 6 Director: Greg Breitbach  
Region 7 Director: Jim Anthony Region 8 Director: Dean Wright  
Region 9 Director: Ben Brodeur Region 10 Director: Lori Silvestri

### JUDGES & ASSIGNMENTS

Doug Berlin Elizabethton, PA  
Rita Figg Laurel, FL  
Donna Richards Denver NC

### FIELD COMMITTEE

Field Chairman – Matt Coughlin (586)764-0634 Field Trial Secretary – Ginny Merchant (813)786-6983  
Lure Operators – Matt Coughlin, Jerry Slattery, Glen Davis

## Assignments and Running Order

### SATURDAY March 26

| JUDGE | Ba | RR | A | Az | B | C | Ib | IW | IG | G | P | S | SD | SI | SW | W | Sgl | Ltd |
|-------|----|----|---|----|---|---|----|----|----|---|---|---|----|----|----|---|-----|-----|
| DOUG  |    |    |   |    | X | X | X  | X  | X  | X | X | X | X  | X  | X  | X | X   | X   |
| RITA  | X  | X  | X | X  | X | X | X  | X  | X  | X | X | X | X  | X  | X  | X | X   | X   |
| DONNA | X  | X  | X | X  | X |   |    |    |    |   |   |   |    |    |    |   |     |     |

### SUNDAY March 27

| JUDGE | Ba | RR | Ib | S | G | A | Az | B | C | IW | IG | P | SD | SI | SW | W | Sgl | Ltd |
|-------|----|----|----|---|---|---|----|---|---|----|----|---|----|----|----|---|-----|-----|
| DOUG  | X  | X  |    |   |   | X | X  | X | X | X  | X  | X | X  | X  | X  | X | X   | X   |
| RITA  |    |    | X  | X | X | X | X  | X | X | X  | X  | X | X  | X  | X  | X | X   | X   |
| DONNA | X  | X  | X  | X | X |   |    |   |   |    |    |   |    |    |    |   |     |     |

**ROLL CALL: PROMPTLY at 8:00 AM**

**(Committee members and volunteers may Roll Call early)**

**\*\*\*\*\*HOUND CERTIFICATIONS WILL ONLY BE AFTER the Trial on Saturday\*\*\*\*\***

**TRIAL HOURS: 7:00 AM until after ribbons are awarded**

ENTRIES WILL NOT BE ACKNOWLEDGED BY RETURN MAIL OR  
PHONE; ENTRIES MAY BE ACKNOWLEDGED BY E-MAIL IF OWNER  
INCLUDES E-MAIL ADDRESS.

### Sunday Trial Ribbons or Rosettes

SSRRC will offer ribbons for all 1st (blue), 2nd (red), 3rd (yellow), 4th  
(white), NBQ (green), Single Stake Winner, (navy/gold), A Rosette will  
be offered for all Best of Breed winners (purple/gold) Best in event  
rosette (Sage, Tangerine and Cream)

**Region 7 Invitational Best in Field will be offered on Saturday**

**BEST IN EVENT WILL BE OFFERED ON SUNDAY**

**- to qualify Sunday's BIE a dog must have won a BOB on Saturday or Sunday . The dog  
must have run in both Preliminary AND Finals on both Trial days (Saturday or Sunday) to  
be eligible.**

### Regional Invitational Ribbons and Rosettes

For the Region 7 Invitational (Saturday) ASFA rosettes will be offered for all placements  
(1st thru NBQ), ASFA Medallions awarded to all BOB winners, High Scoring Single and  
Best of Breed & Best in Field and Stakes

**SEE PAGE 3 FOR A LIST OF REGION 7 REGIONAL TROPHIES OFFERED**

### ELIGIBLE BREEDS & REGISTRY

Only purebred Afghan Hounds, Azawakhs, Basenjis, Borzoi, Cirneco dell'Etna, Greyhounds,  
Ibizan Hounds, Irish Wolfhounds, Italian Greyhounds, Pharaoh Hounds, Rhodesian Ridgebacks,  
Salukis, Scottish Deerhounds, Silken Windhound, Sloughis, Whippets, and Provisional breeds  
\*may be entered in the regular stake.: There are no Provisional Breeds at this time.  
Limited breeds may be entered in the Limited Stake or the Singles Stake. Limited breeds  
currently include purebred Chart Polski, Galgo Español, Magyar Agar, Peruvian Inca Orchid,  
Portuguese Podengo (Pequeno), Portuguese Podengo (Medio & Grande), and must be  
individually registered with the appropriate registry.

All entries shall be individually registered with the AKC (ILP/PAL included), the NGA, the UKC,  
the FCI, an ASFA-recognized foreign or ASFA Board approved registry, or possess a CRN from  
the SPDBS. A photocopy of acceptable registry must be submitted with each hound's first ASFA  
field trial entry; this requirement is waived for hounds registered with the NGA.

### **REGULAR STAKES OFFERED**

**OPEN STAKE:** Any non-Field Champion hound previously entered in the Open Stake.

**FIELD CHAMPION STAKE:** Any ASFA Field Champion.

**VETERAN STAKE:** Any eligible hound whose age is at least six years, except Irish Wolfhounds whose age shall be at least five years, and Afghan Hounds, Rhodesian Ridgebacks, Salukis, and Whippets whose age shall be at least seven years. Points go toward V-FCh or V-LCM titles.

**SINGLE STAKE:** Any eligible sighthound including those disqualified to run in other stakes. No "first-Time- entered" hounds shall be permitted in the Singles Stake at a Regional Invitational. Entries limited to 10 based on postmark - first come, first served.

**LIMITED STAKE:** Any eligible sighthound of a Limited or Provisional stake breed that has met certification requirements.

### **NON-REGULAR STAKES OFFERED**

**on Saturday March 26, 2016**

**BENCH STAKE:** For any; sight hound with proof on file with the ASFA of a conformation champion title from the AKC,CKC or both or a conformation grand champion title from the UKC. To enter this stake, the owner must attach a copy of the hound's show championship certificate to the entry form.

**BREEDER STAKE:** For any breed which shall have, designated at time of entry, two hounds bred by The same individual

**KENNEL STAKE:** For hounds of any individual breeds; an entry shall consist of two hounds designated at time of entry, in one of the regular stakes being owned and kenneled by the same person..

Hounds entered in the Single Stake are not eligible to be entered in Breeder, Kennel, or Bench stakes.

**Conditions of Entry: This applies to the SSRRC SUNDAY TRIAL ONLY** All entries must be one year or older on the day of the trial • Stakes will be split into flights by public random draw if the entry in any regular stake is 20 or more • Bitches in season, lame hounds and hounds with breed disqualifications will be excused at roll call. Spayed, neutered, monorchid or cryptorchid hounds without breed disqualifications may be entered; hounds with breed disqualifications are not eligible to enter except in the Single Stake • Hounds not present at the time of roll call will be scratched • All hounds will run twice, in trios if possible or braces (except in the Single Stake), unless excused, dismissed or disqualified •

### **ADDITIONAL Eligibility for Region 7 Invitational ONLY**

**No Day of Trial Entries. No First-Time Entries. Regional Invitational Requirements**  
**Any hound that has earned at least one ASFA point is eligible to enter. For a Limited Stake to be eligible, the entered hound must have received a placement, with competition. All points or placements must be earned by the closing date of the event. Any hound entered in the Single Stake does not need prior ASFA experience. An eligible hound may be entered in any number of Regional Invitationals.**

### **Trophy Sponsorships**

Recognize a special human, hound, breed or kennel by donating to the trophy fund. Each sponsor will be listed in the catalog if the donation is received by the closing date. ALL funds will go towards prizes for this event. Any funds left over will be donated to the Region 7 trophy fund.

**Champ \$5**

**Bronze \$10**

**Silver \$20**

**Gold \$30**

**Platinum \$50**

**The following REGION 7 Perpetual Trophies will be offered on Saturday, March 26, 2016**

### **Best in Regional Trophy**

### **Regional Invitational Best of Breed Trophies**

**Basenji:** The CJ Trophy, donated by Dave and Carol Kelly in honor of Ch Sundance Nitengale, LCM III

**Borzoi –** donated by Shirley Rehberg and Rachel Gongre in honor of Shirri Peak

**Greyhound:** The Brandy Cup, donated by John and Debbie Parker on behalf of Southeastern Greyhound Club in honor of AOK Speed Chic, LCM (1990-2001)

**Italian Greyhound:** The Iggy Glavine IG Trophy, donated by Sally Cersosimo and the Alley Family in honor of Iggy III, ICM, NAJ, SC, JOR and Glavine Alley, F.Ch, the first Italian Greyhounds to lure course regularly in Region 7

**Pharaoh Hound:** The Mia Trophy is a bronze coursing Pharaoh Hound by Garry Newton donated by Thom and Pam Haig

**Rhodesian Ridgeback:** The "Lion Hounds of the South" In memory of all the great running Ridgebacks that have the skill and ability to make the ground tremble. Donated by Jerry & Crystal Slattery and Dale & Kasey Parks.

**Saluki:** The Region 7 Invitational Saluki Best of Breed Trophy, donated by Tom Cigolle in honor of "Fuhais" BII Montebello Sherom's Fuhais, LCM6

**Whippet" The Hardy/Dino/Nitro Trophy.** Perpetual trophy donated by Carolina Lure Coursing Society and Friends of TnT Kennels in honor of Hardy, Cher Che Hard to Say Nothing, SC, LCM; Dino, FCh Carbeths Mr. Right, MC, LCM 10; and Nitro, TnT's Accelerated Heart, LCM3, TRP.

### **REGION 7 TROPHIES, AWARDS & PRIZES** **IN ADDITION TO REGION 7 PERPETUAL TROPHIES**

**BEST IN FIELD - A unique stained glass piece of art**

**ALL BOB WINNERS WILL RECEIVE PRIZES THAT HAVE BEEN DONATED BY GENEROUS INDIVIDUALS OR SSRRC.**

**KENNEL AND BREEDER STAKES WINNERS WILL RECEIVE A \$10 GIFT CARD IN ADDITION TO THE ROSETTE**

**TURTLE AWARD – given to the Whippet with the lowest total qualifying score**

## IMPORTANT STUFF TO KNOW

### Facility Information

It is recommended that all hounds entered be in top physical condition due to the length of the course, which will be run on natural terrain (mowed fields). **EACH HOUND IS ENTERED AND COMPETES AT THE SOLE RISK OF ITS OWNER.**

**\*\*REFUNDS - SSRRRC** will issue a refund of entry fees for dogs that are in season or lame, If your hound comes in season or becomes lame before the Trial, and you will not be attending Trial for these reasons, you must call the Trial Secretary BEFORE Roll Call – otherwise you forfeit your entry fees!

**Veterinarian on call:** Emergency Veterinarian  
Buffalo Ridge Animal Hospital  
748 Village Campus Cir.  
The Villages, FL 32162  
(352)750-4711

**BREAKFAST and LUNCH AT THE FIELD WILL BE AVAILABLE CONCESSIONS –**  
The Grand Oaks will have coffee and doughnuts in the mornings and grilled items available for purchase at lunch!



**GROUP DINNER – REGIONAL MEETING SATURDAY EVENING**

**Dinner will be at The Bistro on the property at 6:30pm**

**A RAFFLE TICKET WILL BE GIVEN TO EACH REGIONAL ENTRY**

For door prizes at the dinner

## LODGING

**HOTELS & MOTELS THAT WILL ACCEPT DOGS** please confirm the motel policy regarding pet fees.

**Owners must assume full responsibility. Early reservations are recommended. As rules may change, please check the hotels before registering. Pet fees may apply. ASFA rules and common courtesy; you are responsible for picking up after your dogs at the hotel, campground, and trial site.**

**The Grand Oaks Resort - will allow dry camping at the field in an RV, Motorhome, or van for \$35 per night. NO TENT CAMPING IS ALLOWED!**

**RV Sites with 50-amp, water and Sewer are offered by the resort. Please contact Grand Oaks Reservations at: Lori Mount 3527505500 X231**

**There are also Cabins on site with 1-4 bedrooms and a totally refundable dog deposit. Contact Lori for reservations of these as well. Lori Mount 3527505500 X231**

### Econo Lodge

6.48 miles from Lady Lake, FL  
1308 North 14th Street  
Leesburg, FL 34748-3409  
855-738-5257

### Days Inn Leesburg

7.08 miles from Lady Lake, FL

1115 W. North Blvd  
Leesburg, FL 34748  
352-787-3131

## LURE COURSE DESIGNS

**FIELD CONDITIONS:** The field is grass, which has been occasionally mowed. It is a hayfield and is not perfectly groomed. The field is well away from the highway, but is NOT permanently fenced. **SOME** of the course plans have different lengths associated with them. The length of the course will depend on field conditions the day of the event. The terrain has some hills.

**PLEASE PARK IN DESIGNATED AREAS ONLY!**

Saturday March 26 935 Yards

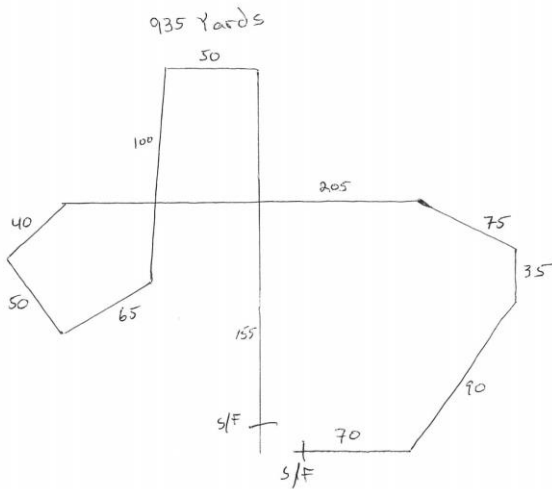

Sunday March 27 785 Yards

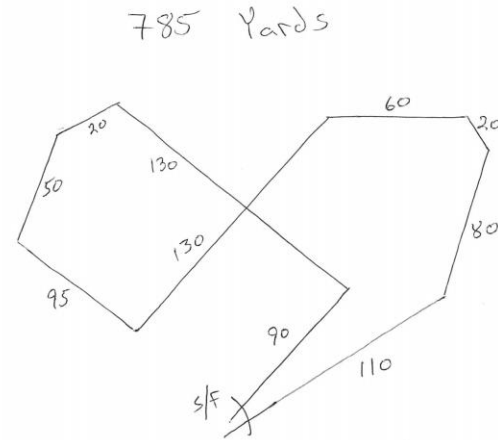



**FILL OUT ENTRY/ENTRIES BELOW FOR KENNEL/BREEDER STAKES.**  
Include an additional \$5.00 per pair of hounds for each Kennel and/or Breeder Stake entry.

**KENNEL STAKE ENTRY**

Registered Name and AKC Number (fill out below for each hound entered)

Breed: .....

Hound 1: .....

.....

Hound 2: .....

.....

Owner: .....

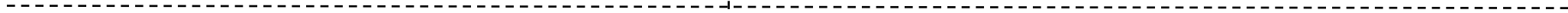

**BREEDER STAKE ENTRY**

Registered Name and AKC Number (fill out below for each hound entered)

Breed: .....

Hound 1: .....

.....

Hound 2: .....

.....

Breeder: .....

**FILL OUT ENTRY/ENTRIES BELOW FOR KENNEL/BREEDER STAKES.**  
Include an additional \$5.00 per pair of hounds for each Kennel and/or Breeder Stake entry.

**KENNEL STAKE ENTRY**

Registered Name and AKC Number (fill out below for each hound entered)

Breed: .....

Hound 1: .....

.....

Hound 2: .....

.....

Owner: .....

**BREEDER STAKE ENTRY**

Registered Name and AKC Number (fill out below for each hound entered)

Breed: .....

Hound 1: .....

.....

Hound 2: .....

.....

Breeder: .....

**FILL OUT ENTRY/ENTRIES BELOW FOR BENCH STAKES.**

Include an additional \$5.00 per hound entered. Proof of Conformation  
Championship MUST accompany entry.

**BENCH STAKE ENTRY**

Registered Name and AKC Number (fill out below for each hound entered)

Breed: .....

Hound : .....

.....

Owner: .....

**BENCH STAKE ENTRY**

Registered Name and AKC Number (fill out below for each hound entered)

Breed: .....

Hound 1: .....

.....

Ownerr: .....

**FILL OUT ENTRY/ENTRIES BELOW FOR BENCH STAKES.**

Include an additional \$5.00 per hound entered. Proof of Conformation  
Championship MUST accompany entry.

**BENCH STAKE ENTRY**

Registered Name and AKC Number (fill out below for each hound entered)

Breed: .....

Hound 1: .....

.....

Owner: .....

**BENCH STAKE ENTRY**

Registered Name and AKC Number (fill out below for each hound entered)

Breed: .....

Hound 1: .....

.....

Ownerr: .....

## 2016 SSRRC Easter Trial and ASFA Region 7 Invitational Worksheet

To help both you and SSRRC account for funds accurately here is a handy worksheet for you to fill out  
And include with your entries. Just leave blank those items you are not entering/sending money for.

Total it up at the bottom and send only one check to Ginny, made payable to "SSRRC". Don't forget  
to send in all the appropriate entry forms. .

Name: \_\_\_\_\_ Breed(s): \_\_\_\_\_  
Address: \_\_\_\_\_  
Phone: \_\_\_\_\_ E-mail: \_\_\_\_\_

### Saturday Region 7 Invitational

First hound \_\_\_\_\_ x \$20 = \$ \_\_\_\_\_  
Additional hounds \_\_\_\_\_ x \$15 = \$ \_\_\_\_\_

Breeder Stake pairs \_\_\_\_\_ x \$5 = \$ \_\_\_\_\_  
Kennel Stake pairs \_\_\_\_\_ x \$5 = \$ \_\_\_\_\_  
Bench Stake entries \_\_\_\_\_ x \$5 = \$ \_\_\_\_\_

### Sunday Entries

First hound \_\_\_\_\_ x \$20 = \$ \_\_\_\_\_  
Second hound \_\_\_\_\_ x \$15 = \$ \_\_\_\_\_

**Sponsorships (if you want to dedicate your donation, please fill out  
below)**

Champ Circle (\$5 to \$9) Amount \$ \_\_\_\_\_  
Bronze Circle (\$10 to \$19) Amount \$ \_\_\_\_\_  
Silver Circle (\$20 to \$29) Amount \$ \_\_\_\_\_  
Gold Circle (\$30 to \$49) Amount \$ \_\_\_\_\_  
Platinum Circle (\$50 or more) Amount \$ \_\_\_\_\_

**I would like to sponsor a prize in the name of (your dedication will be listed in  
the catalog IF we receive it by the deadline:**

-----TSHIRT'S-----

**Yes, I would like a Commemorative Shirt – These are unisex, so they run  
Slightly large.**

Short Sleeve T \_\_\_\_\_ Size \_\_\_\_\_ (S-L) Quantity \_\_\_\_\_ x \$20 = \$ \_\_\_\_\_

Short Sleeve T \_\_\_\_\_ Size \_\_\_\_\_ (XL-4X) Quantity \_\_\_\_\_ x \$24 = \$ \_\_\_\_\_

Long Sleeve T \_\_\_\_\_ Size \_\_\_\_\_ (S-L) Quantity \_\_\_\_\_ x \$25 = \$ \_\_\_\_\_

Long Sleeve T \_\_\_\_\_ Size \_\_\_\_\_ (XL-4X) Quantity \_\_\_\_\_ x \$28 = \$ \_\_\_\_\_

Sweatshirt \_\_\_\_\_ Size \_\_\_\_\_ (S-L) Quantity \_\_\_\_\_ x \$30 = \$ \_\_\_\_\_

Sweatshirt \_\_\_\_\_ Size \_\_\_\_\_ (XLx4X) Quantity \_\_\_\_\_ x \$34 = \$ \_\_\_\_\_

TOTAL AMOUNT \$ \_\_\_\_\_ ☐ pay by check (included) ☐ pay by credit card

**The Regional Dinner and Meeting is on Saturday, March 26. We need to  
know if you are coming! Please indicate below if you will/will not attend and  
how many are in your party. Each person will order/pay for their own meal.  
RVers will be provided transportation.**

**YES I WILL Attend \_\_\_\_\_ Number in my party \_\_\_\_\_**

**No I will NOT be able to attend \_\_\_\_\_**

# OFFICIAL AMERICAN SIGHTHOUND FIELD ASSOCIATION ENTRY FORM

**SSRRC**

**Region 7 Invitational Saturday March 26, 2016**

**NO DAY OF TRIAL ENTRIES ACCEPTED FOR REGION INVITATIONAL**

Early entries close 9 P.M. Friday March 11, 2016 at the FTS's residence.

## Entry Fees for Regional Invitational:

\$20 first hound \$15 each additional hound, same household (Single Stake entries limited to 10 by postmark) \$5 Per Pair for Breeder Stakes \$5 Per Pair for Kennel Stakes

\$5 Per Hound for Bench Stakes Make checks payable (in US funds) to **SSRRC** and mail to:

Ginny Merchant 38741 Ilex Trail Eustis, FL 32736

Fee Paid \_\_\_\_\_ The Field Secretary cannot accept conditional, unsigned, incomplete or unpaid entries; please check your completed entry carefully.

|                                                                                                                                                                                    |                |                                                                                                 |  |
|------------------------------------------------------------------------------------------------------------------------------------------------------------------------------------|----------------|-------------------------------------------------------------------------------------------------|--|
| Breed:                                                                                                                                                                             | Call Name:     |                                                                                                 |  |
| Registered Name of Hound:                                                                                                                                                          |                |                                                                                                 |  |
| Stake:                                                                                                                                                                             |                | Additional Stakes:                                                                              |  |
| <input type="checkbox"/> Open <input type="checkbox"/> FCH <input type="checkbox"/> Veteran <input type="checkbox"/> Single <input type="checkbox"/> Limited                       |                | <input type="checkbox"/> Kennel <input type="checkbox"/> Breeder <input type="checkbox"/> Bench |  |
| Registration Number: (please write in registration body before number)                                                                                                             |                |                                                                                                 |  |
| <input type="checkbox"/> If possible, please separate my hounds                                                                                                                    | Date of Birth: | Sex: <input type="checkbox"/> Dog <input type="checkbox"/> Bitch                                |  |
| Name of actual owner(s):                                                                                                                                                           |                |                                                                                                 |  |
| Address:                                                                                                                                                                           |                | Phone:                                                                                          |  |
| City:                                                                                                                                                                              | State:         | Zip:                                                                                            |  |
| E-mail (Optional)                                                                                                                                                                  |                | (Optional) Region of Residence:                                                                 |  |
| <input type="checkbox"/> Check if this is the first ASFA trial for this hound. Attach a Hound <del>Certification</del> or waiver if entered in Open, Veterans, Limited.            |                |                                                                                                 |  |
| <input type="checkbox"/> Check if this is a first-time entry, a copy of the official <del>Registration</del> of this hound must accompany this entry unless NGA.                   |                |                                                                                                 |  |
| <input type="checkbox"/> Check if any <del>information</del> has changed since the last ASFA trial entry. <del>Registration</del> _____                                            |                |                                                                                                 |  |
| <input type="checkbox"/> Check if this hound has been dismissed within the last 6 trials entered. Must be marked in order to qualify for a "clean" trial <del>registration</del> . |                |                                                                                                 |  |

I CERTIFY that I am the actual owner of this dog, or that I am the duly authorized agent of the actual owner whose name I have entered above. In consideration of the acceptance of this entry and the opportunity to have this dog judged and to win prize money, ribbons, or trophies, I (we) agree to abide by the rules and regulations of the American Sighthound Field Association in effect at the time of this lure field trial, and by any additional rules and regulations appearing in the premium list for this lure field trial. I (we) agree that the club holding this lure field trial has the right to refuse this entry for cause, which the club shall deem to be sufficient. I (we) agree to hold this club, its members, directors, governors, officers, agents or other functionaries, any employees of the aforementioned parties and the owner(s) of the trial premises or grounds harmless from any claim for loss or injury which may be alleged to have been caused directly or indirectly to any person or thing by the act of this dog while in or upon the lure field trial premises or grounds or near any entrance thereto and I (we) personally assume all responsibility and liability for any such claim, and I (we) further agree to hold the aforementioned parties harmless from any claim loss of this dog by disappearance, theft damage or injury be caused or alleged to be caused by the negligence of the club or any of the aforementioned parties or by the negligence of any person or any other cause or causes. I (we) certify and represent that the dog entered is not a hazard to person or other dogs. This entry is submitted for acceptance of the forgoing representations and agreements

SIGNATURE of owner or his agent

duly authorized to make this entry \_\_\_\_\_

# OFFICIAL AMERICAN SIGHTHOUND FIELD ASSOCIATION ENTRY FORM

**SSRRC**

**Region 7 Invitational Saturday March 26, 2016**

**NO DAY OF TRIAL ENTRIES ACCEPTED FOR REGION INVITATIONAL**

Early entries close 9 P.M. Friday March 11, 2016 at the FTS's residence.

## Entry Fees for Regional Invitational:

\$20 first hound \$15 each additional hound, same household (Single Stake entries limited to 10 by postmark) \$5 Per Pair for Breeder Stakes \$5 Per Pair for Kennel Stakes

\$5 Per Hound for Bench Stakes Make checks payable (in US funds) to **SSRRC** and mail to:

Ginny merchant 38741 Ilex Trail Eustis, FL 32736

Fee Paid \_\_\_\_\_ The Field Secretary cannot accept conditional, unsigned, incomplete or unpaid entries; please check your completed entry carefully.

|                                                                                                                                                                                    |                |                                                                                                 |  |
|------------------------------------------------------------------------------------------------------------------------------------------------------------------------------------|----------------|-------------------------------------------------------------------------------------------------|--|
| Breed:                                                                                                                                                                             | Call Name:     |                                                                                                 |  |
| Registered Name of Hound:                                                                                                                                                          |                |                                                                                                 |  |
| Stake:                                                                                                                                                                             |                | Additional Stakes:                                                                              |  |
| <input type="checkbox"/> Open <input type="checkbox"/> FCH <input type="checkbox"/> Veteran <input type="checkbox"/> Single <input type="checkbox"/> Limited                       |                | <input type="checkbox"/> Kennel <input type="checkbox"/> Breeder <input type="checkbox"/> Bench |  |
| Registration Number: (please write in registration body before number)                                                                                                             |                |                                                                                                 |  |
| <input type="checkbox"/> If possible, please separate my hounds                                                                                                                    | Date of Birth: | Sex: <input type="checkbox"/> Dog <input type="checkbox"/> Bitch                                |  |
| Name of actual owner(s):                                                                                                                                                           |                |                                                                                                 |  |
| Address:                                                                                                                                                                           |                | Phone:                                                                                          |  |
| City:                                                                                                                                                                              | State:         | Zip:                                                                                            |  |
| E-mail (Optional)                                                                                                                                                                  |                | (Optional) Region of Residence:                                                                 |  |
| <input type="checkbox"/> Check if this is the first ASFA trial for this hound. Attach a Hound <del>Certification</del> or waiver if entered in Open, Veterans, Limited.            |                |                                                                                                 |  |
| <input type="checkbox"/> Check if this is a first-time entry, a copy of the official <del>Registration</del> of this hound must accompany this entry unless NGA.                   |                |                                                                                                 |  |
| <input type="checkbox"/> Check if any <del>information</del> has changed since the last ASFA trial entry. <del>Registration</del> _____                                            |                |                                                                                                 |  |
| <input type="checkbox"/> Check if this hound has been dismissed within the last 6 trials entered. Must be marked in order to qualify for a "clean" trial <del>registration</del> . |                |                                                                                                 |  |

I CERTIFY that I am the actual owner of this dog, or that I am the duly authorized agent of the actual owner whose name I have entered above. In consideration of the acceptance of this entry and the opportunity to have this dog judged and to win prize money, ribbons, or trophies, I (we) agree to abide by the rules and regulations of the American Sighthound Field Association in effect at the time of this lure field trial, and by any additional rules and regulations appearing in the premium list for this lure field trial. I (we) agree that the club holding this lure field trial has the right to refuse this entry for cause, which the club shall deem to be sufficient. I (we) agree to hold this club, its members, directors, governors, officers, agents or other functionaries, any employees of the aforementioned parties and the owner(s) of the trial premises or grounds harmless from any claim for loss or injury which may be alleged to have been caused directly or indirectly to any person or thing by the act of this dog while in or upon the lure field trial premises or grounds or near any entrance thereto and I (we) personally assume all responsibility and liability for any such claim, and I (we) further agree to hold the aforementioned parties harmless from any claim loss of this dog by disappearance, theft damage or injury be caused or alleged to be caused by the negligence of the club or any of the aforementioned parties or by the negligence of any person or any other cause or causes. I (we) certify and represent that the dog entered is not a hazard to person or other dogs. This entry is submitted for acceptance of the forgoing representations and agreements

SIGNATURE of owner or his agent

duly authorized to make this entry \_\_\_\_\_

# OFFICIAL AMERICAN SIGHTHOUND FIELD ASSOCIATION ENTRY FORM

## SSRRC

**Sunday March 27, 2016** Early entries close 9 P.M. **Friday March 11, 2016** at the FTS's residence. **Early Entries for trial: \$20.00 first hound**

**\$15.00 second hound, DAY OF TRIAL FEE \$30.00 per hound**

(Substitutions, same owner, until (**7:30 AM Day of Trial**) Make checks payable (in US funds) to **SSRRC** and mail to:

**Ginny Merchant 38741 Ilex Trail Eustis, FL 32736**

Fee Paid \_\_\_\_\_ The Field Secretary cannot accept conditional, unsigned, incomplete or unpaid entries; please check your completed entry carefully.

|                                                                                                                                                                                                                                                                                                                                                                                                                                                                                                                                                                                                                  |                                                                                                 |                                                                  |
|------------------------------------------------------------------------------------------------------------------------------------------------------------------------------------------------------------------------------------------------------------------------------------------------------------------------------------------------------------------------------------------------------------------------------------------------------------------------------------------------------------------------------------------------------------------------------------------------------------------|-------------------------------------------------------------------------------------------------|------------------------------------------------------------------|
| Breed:                                                                                                                                                                                                                                                                                                                                                                                                                                                                                                                                                                                                           | Call Name:                                                                                      |                                                                  |
| Registered Name of Hound:                                                                                                                                                                                                                                                                                                                                                                                                                                                                                                                                                                                        |                                                                                                 |                                                                  |
| Stake:                                                                                                                                                                                                                                                                                                                                                                                                                                                                                                                                                                                                           | Additional Stakes:                                                                              |                                                                  |
| <input type="checkbox"/> Open <input type="checkbox"/> FCH <input type="checkbox"/> Veteran <input type="checkbox"/> Single <input type="checkbox"/> Limited                                                                                                                                                                                                                                                                                                                                                                                                                                                     | <input type="checkbox"/> Kennel <input type="checkbox"/> Breeder <input type="checkbox"/> Bench |                                                                  |
| Registration Number: (please write in body before number)                                                                                                                                                                                                                                                                                                                                                                                                                                                                                                                                                        |                                                                                                 |                                                                  |
| <input type="checkbox"/> If possible, please separate my hounds                                                                                                                                                                                                                                                                                                                                                                                                                                                                                                                                                  | Date of Birth:                                                                                  | Sex: <input type="checkbox"/> Dog <input type="checkbox"/> Bitch |
| Name of actual owner(s):                                                                                                                                                                                                                                                                                                                                                                                                                                                                                                                                                                                         |                                                                                                 |                                                                  |
| Address:                                                                                                                                                                                                                                                                                                                                                                                                                                                                                                                                                                                                         |                                                                                                 | Phone:                                                           |
| City:                                                                                                                                                                                                                                                                                                                                                                                                                                                                                                                                                                                                            | State:                                                                                          | Zip:                                                             |
| E-mail (Optional)                                                                                                                                                                                                                                                                                                                                                                                                                                                                                                                                                                                                |                                                                                                 | (Optional) Region of Residence:                                  |
| <input type="checkbox"/> Check if this is the first ASFA trial for this hound. Attach a Hound Certification or waiver if entered in Open, Veterans, Limited.<br><input type="checkbox"/> Check if this is a first-time entry, a copy of the official Registration of this hound must accompany this entry unless NGA.<br><input type="checkbox"/> Check if any information has changed since the last ASFA trial entry. Recording _____<br><input type="checkbox"/> Check if this hound has been dismissed within the last 6 trials entered. Must be marked in order to qualify for a "clean" trial requirement. |                                                                                                 |                                                                  |

I CERTIFY that I am the actual owner of this dog, or that I am the duly authorized agent of the actual owner whose name I have entered above. In consideration of the acceptance of this entry and the opportunity to have this dog judged and to win prize money, ribbons, or trophies, I (we) agree to abide by the rules and regulations of the American Sighthound Field Association in effect at the time of this lure field trial, and by any additional rules and regulations appearing in the premium list for this lure field trial. I (we) agree that the club holding this lure field trial has the right to refuse this entry for cause, which the club shall deem to be sufficient. I (we) agree to hold this club, its members, directors, governors, officers, agents or other functionaries, any employees of the aforementioned parties and the owner(s) of the trial premises or grounds harmless from any claim for loss or injury which may be alleged to have been caused directly or indirectly to any person or thing by the act of this dog while in or upon the lure field trial premises or grounds or near any entrance thereto and I (we) personally assume all responsibility and liability for any such claim, and I (we) further agree to hold the aforementioned parties harmless from any claim loss of this dog by disappearance, theft damage or injury be caused or alleged to be caused by the negligence of the club or any of the aforementioned parties or by the negligence of any person or any other cause or causes. I (we) certify and represent that the dog entered is not a hazard to person or other dogs. This entry is submitted for acceptance of the forgoing representations and agreements

**SIGNATURE** of owner or his agent  
duly authorized to make this entry \_\_\_\_\_

# OFFICIAL AMERICAN SIGHTHOUND FIELD ASSOCIATION ENTRY FORM

## SSRRC

**Sunday March 27, 2016** Early entries close 9 P.M. **Friday March 11, 2016** at the FTS's residence. **Early Entries for trial: \$20.00 first hound**

**\$15.00 second hound, DAY OF TRIAL FEE \$30.00 per hound**

(Substitutions, same owner, until (**7:30 AM Day of Trial**) Make checks payable (in US funds) to **SSRRC** and mail to:

**Ginny Merchant 38741 Ilex Trail Eustis, FL 32736**

Fee Paid \_\_\_\_\_ The Field Secretary cannot accept conditional, unsigned, incomplete or unpaid entries; please check your completed entry carefully.

|                                                                                                                                                                                                                                                                                                                                                                                                                                                                                                                                                                                                                  |                                                                                                 |                                                                  |
|------------------------------------------------------------------------------------------------------------------------------------------------------------------------------------------------------------------------------------------------------------------------------------------------------------------------------------------------------------------------------------------------------------------------------------------------------------------------------------------------------------------------------------------------------------------------------------------------------------------|-------------------------------------------------------------------------------------------------|------------------------------------------------------------------|
| Breed:                                                                                                                                                                                                                                                                                                                                                                                                                                                                                                                                                                                                           | Call Name:                                                                                      |                                                                  |
| Name of Hound:                                                                                                                                                                                                                                                                                                                                                                                                                                                                                                                                                                                                   |                                                                                                 |                                                                  |
| Registered Stake:                                                                                                                                                                                                                                                                                                                                                                                                                                                                                                                                                                                                | Additional Stakes:                                                                              |                                                                  |
| <input type="checkbox"/> Open <input type="checkbox"/> FCH <input type="checkbox"/> Veteran <input type="checkbox"/> Single <input type="checkbox"/> Limited                                                                                                                                                                                                                                                                                                                                                                                                                                                     | <input type="checkbox"/> Kennel <input type="checkbox"/> Breeder <input type="checkbox"/> Bench |                                                                  |
| Registration Number: (please write in body before number)                                                                                                                                                                                                                                                                                                                                                                                                                                                                                                                                                        |                                                                                                 |                                                                  |
| <input type="checkbox"/> If possible, please separate my hounds                                                                                                                                                                                                                                                                                                                                                                                                                                                                                                                                                  | Date of Birth:                                                                                  | Sex: <input type="checkbox"/> Dog <input type="checkbox"/> Bitch |
| Name of actual owner(s):                                                                                                                                                                                                                                                                                                                                                                                                                                                                                                                                                                                         |                                                                                                 |                                                                  |
| Address:                                                                                                                                                                                                                                                                                                                                                                                                                                                                                                                                                                                                         |                                                                                                 | Phone:                                                           |
| City:                                                                                                                                                                                                                                                                                                                                                                                                                                                                                                                                                                                                            | State:                                                                                          | Zip:                                                             |
| E-mail (Optional)                                                                                                                                                                                                                                                                                                                                                                                                                                                                                                                                                                                                |                                                                                                 | (Optional) Region of Residence:                                  |
| <input type="checkbox"/> Check if this is the first ASFA trial for this hound. Attach a Hound Certification or waiver if entered in Open, Veterans, Limited.<br><input type="checkbox"/> Check if this is a first-time entry, a copy of the official Registration of this hound must accompany this entry unless NGA.<br><input type="checkbox"/> Check if any information has changed since the last ASFA trial entry. Recording _____<br><input type="checkbox"/> Check if this hound has been dismissed within the last 6 trials entered. Must be marked in order to qualify for a "clean" trial requirement. |                                                                                                 |                                                                  |

I CERTIFY that I am the actual owner of this dog, or that I am the duly authorized agent of the actual owner whose name I have entered above. In consideration of the acceptance of this entry and the opportunity to have this dog judged and to win prize money, ribbons, or trophies, I (we) agree to abide by the rules and regulations of the American Sighthound Field Association in effect at the time of this lure field trial, and by any additional rules and regulations appearing in the premium list for this lure field trial. I (we) agree that the club holding this lure field trial has the right to refuse this entry for cause, which the club shall deem to be sufficient. I (we) agree to hold this club, its members, directors, governors, officers, agents or other functionaries, any employees of the aforementioned parties and the owner(s) of the trial premises or grounds harmless from any claim for loss or injury which may be alleged to have been caused directly or indirectly to any person or thing by the act of this dog while in or upon the lure field trial premises or grounds or near any entrance thereto and I (we) personally assume all responsibility and liability for any such claim, and I (we) further agree to hold the aforementioned parties harmless from any claim loss of this dog by disappearance, theft damage or injury be caused or alleged to be caused by the negligence of the club or any of the aforementioned parties or by the negligence of any person or any other cause or causes. I (we) certify and represent that the dog entered is not a hazard to person or other dogs. This entry is submitted for acceptance of the forgoing representations and agreements

**SIGNATURE** of owner or his agent  
duly authorized to make this entry \_\_\_\_\_

**AMERICAN SIGHTHOUND FIELD ASSOCIATION  
HOUND CERTIFICATION**

**Rule effective October 1, 1994: Ch. V, Sec. 4 (a) OPEN STAKE:** *To be eligible to enter the open stake, a hound must have been certified by a licensed judge within the year preceding the closing date for the entry or have previously competed in the Open Stake.* This eligibility requirement also applies to a hound entered in the Limited or Veteran Stake, which has not competed in Open previously. Please complete this portion of this form and attach it to the entry form for the hound's first entry, including an entry for a Fun Trial.

Registered Name of Hound: \_\_\_\_\_

Registration Number: \_\_\_\_\_ Breed: \_\_\_\_\_

Registered Owner's Name: \_\_\_\_\_

I hereby certify that on (date) \_\_\_\_\_, the above named hound completed a lure course of at least 500 yards, running with another hound of the same breed (or another breed with a similar running style). During the course the above named hound showed no inclination to interfere with the other hound. I further certify that I am a licensed judge for the ASFA.

Name of Licensed Judge: \_\_\_\_\_

Signature: \_\_\_\_\_ Date: \_\_\_\_\_

I hereby certify that the hound running in the certification course is the hound identified above and that information provided on this form is true and correct.

Signature: \_\_\_\_\_ Date: \_\_\_\_\_

Owner or Authorized Agent of Hound

This certification form must be attached to the entry form the first time this hound is entered in an open, limited, or veteran stake. Any hound entered in open, limited, or veteran (as a first time entered hound), which has not been certified, shall be declared ineligible by the records coordinator and shall forfeit any points and placements awarded.

**PLEASE RETAIN A COPY FOR YOUR RECORDS.**

**AMERICAN SIGHTHOUND FIELD ASSOCIATION  
HOUND CERTIFICATION WAIVER**

**Waiver of Requirement:** *This requirement will be waived for a hound that has earned a lure coursing or racing title from another recognized organization, if such title requires competition, and if a waiver for such title has been approved by the ASFA, or a CKC Hound Certification Form. If your hound qualifies for a waiver, complete this portion of this form and attach it to your entry form. Proof of waivers must accompany this certification form.*

Registered Name of Hound: \_\_\_\_\_

Registration Number: \_\_\_\_\_ Breed: \_\_\_\_\_

Registered Owner's Name: \_\_\_\_\_

|                    |     |      |    |                      |     |                      |      |     |
|--------------------|-----|------|----|----------------------|-----|----------------------|------|-----|
| <b><u>CKC:</u></b> | FCH | FCHX |    | <b><u>CWA:</u></b>   | ARX | TRP                  | SRA  | DPC |
| <b><u>AKC:</u></b> | QC  | SC   | FC | <b><u>LGRA:</u></b>  | GRC | <b><u>NAWRA:</u></b> | RCH  | SR  |
| <b><u>WRA:</u></b> | CR  | WRCH |    | <b><u>NOTRA:</u></b> | ORC | OTR                  | SORC | SOR |

Hound Certification previously submitted.

I hereby certify that the hound identified above has completed the requirements for the title indicated above (or that the required Certification was previously submitted) and that the information provided on this form is true and correct.

Signature: \_\_\_\_\_ Date: \_\_\_\_\_

Owner or Authorized Agent of Hound

**AMERICAN SIGHTHOUND FIELD ASSOCIATION  
HOUND CERTIFICATION**

**Rule effective October 1, 1994: Ch. V, Sec. 4 (a) OPEN STAKE:** *To be eligible to enter the open stake, a hound must have been certified by a licensed judge within the year preceding the closing date for the entry or have previously competed in the Open Stake.* This eligibility requirement also applies to a hound entered in the Limited or Veteran Stake, which has not competed in Open previously. Please complete this portion of this form and attach it to the entry form for the hound's first entry, including an entry for a Fun Trial.

Registered Name of Hound: \_\_\_\_\_

Registration Number: \_\_\_\_\_ Breed: \_\_\_\_\_

Registered Owner's Name: \_\_\_\_\_

I hereby certify that on (date) \_\_\_\_\_, the above named hound completed a lure course of at least 500 yards, running with another hound of the same breed (or another breed with a similar running style). During the course the above named hound showed no inclination to interfere with the other hound. I further certify that I am a licensed judge for the ASFA.

Name of Licensed Judge: \_\_\_\_\_

Signature: \_\_\_\_\_ Date: \_\_\_\_\_

I hereby certify that the hound running in the certification course is the hound identified above and that information provided on this form is true and correct.

Signature: \_\_\_\_\_ Date: \_\_\_\_\_

Owner or Authorized Agent of Hound

This certification form must be attached to the entry form the first time this hound is entered in an open, limited, or veteran stake. Any hound entered in open, limited, or veteran (as a first time entered hound), which has not been certified, shall be declared ineligible by the records coordinator and shall forfeit any points and placements awarded.

**PLEASE RETAIN A COPY FOR YOUR RECORDS.**

**AMERICAN SIGHTHOUND FIELD ASSOCIATION  
HOUND CERTIFICATION WAIVER**

**Waiver of Requirement:** *This requirement will be waived for a hound that has earned a lure coursing or racing title from another recognized organization, if such title requires competition, and if a waiver for such title has been approved by the ASFA, or a CKC Hound Certification Form. If your hound qualifies for a waiver, complete this portion of this form and attach it to your entry form. Proof of waivers must accompany this certification form.*

Registered Name of Hound: \_\_\_\_\_

Registration Number: \_\_\_\_\_ Breed: \_\_\_\_\_

Registered Owner's Name: \_\_\_\_\_

|                    |     |      |    |                      |     |                      |      |     |
|--------------------|-----|------|----|----------------------|-----|----------------------|------|-----|
| <b><u>CKC:</u></b> | FCH | FCHX |    | <b><u>CWA:</u></b>   | ARX | TRP                  | SRA  | DPC |
| <b><u>AKC:</u></b> | QC  | SC   | FC | <b><u>LGRA:</u></b>  | GRC | <b><u>NAWRA:</u></b> | RCH  | SR  |
| <b><u>WRA:</u></b> | CR  | WRCH |    | <b><u>NOTRA:</u></b> | ORC | OTR                  | SORC | SOR |

Hound Certification previously submitted.

I hereby certify that the hound identified above has completed the requirements for the title indicated above (or that the required Certification was previously submitted) and that the information provided on this form is true and correct.

Signature: \_\_\_\_\_ Date: \_\_\_\_\_

Owner or Authorized Agent of Hound