



Coursing
Hounds
Assoc. of
the Mid-
Potomac

We appreciate being able to use the fields at Oatlands.
Please leave them as you found them.

**ON-LINE ENTRIES ARE AVAILABLE VIA PAY PAL
PAYMENT TO CHAMPTREAS@GMAIL.COM (add a \$1
per entry for a PayPal fee). This part goes directly to our
Treasurer.**

**You will also need to scan in & email your ENTRY, along
with the PayPal receipt, to Audrey Silverstein
dinosmommie@yahoo.com). If you have questions, call
Audrey at 410-868-6369.**

Substitutions (same owner) until 8 a.m. day of trial.

LCIs will be limited to 10 dogs each day.

**We will have a moment of silence this weekend & share
some thoughts regarding our hard-working member
Jay Johnson who died 9 Dec. '24.**

EARLY ENTRIES CLOSE 6 pm on THURSDAY May 1, 2025
at the Field Trial Secretary's address: 1280 Brighton Circle, Seven Valleys,
PA 17360 For questions, email: dinosmommie@yahoo.com
Day-of-Trial Entries close 15 minutes before roll call each day.

COURSING HOUNDS ASSOCIATION OF THE MID-POTOMAC

Region 8
ALL BREED ASFA SANCTIONED LURE FIELD TRIAL



SATURDAY May 3, 2025
SUNDAY May 4, 2025

At Oatlands Plantation
20850 Oatlands Plantation Lane
Leesburg, Virginia
CHAMP CUP EVENT

EARLY ENTRY FEES: \$25.00 for the FIRST HOUND
\$20 for EACH ADDITIONAL HOUND
ENTERED BY THE SAME OWNER OR
FAMILY MEMBER

DAY-OF-ENTRIES FOR THIS TRIAL: \$35 PER DOG

TRIAL Hours: 7:30 am until complete
ROLL CALL: 8:30 am ALL BREEDS
(CELL ON FIELD: 410-868-6369)

Permission has been granted by the American Sighthound Field Association
for the holding of this event under A.S.F.A. rules and regulations
Samantha Duryee, **CHAIRPERSON, ASFA Scheduling Committee**
Go to www.ASFA.org
for online Rulebook, Policies, Contacts, Clubs,
Trial Schedules, Trial Results & much more.

CHAMP Officers 2025

PRESIDENT-- Annie Andrews VICE PRESIDENT -Torie Cassano
 SECRETARY--Bobbie Lutz TREASURER--Celeste Mulcrone
DIRECTORS: Rest of CHAMP Members
ASFA LIAISON: Torie Cassano

JUDGES AND ASSIGNMENTS: (S=Single Judge)

Diana Darling – LaPlata, MD
Paul Kytta – Macedonia, OH
Donna Richards – Denver, NC

Sat. (5/3/25) Assignments

Judge	A F	A Z	B A	B Z	C I	G H	I B	I G	I W	L C	P H	R R	S A	S D	S L	S W	W H	P V	S L	
Diana					S		S		S				S			S				S
Paul	S	S	S	S										S	S		S			
Donna						S		S		S	S	S								S

Sun. (5/4/25) Assignments

Judge	A F	A Z	B A	B Z	C I	G H	I B	I G	I W	L C	P H	R R	S A	S D	S L	S W	W H	P V	S L	
Diana			S					S				S	S				S			
Paul					S	S	S		S	S						S			S	
Donna	S	S		S									S		S					S

FIELD COMMITTEE:

Field Trial Chairman: Torie Cassano: 19967 Telegraph Springs Rd., Purcellville, VA 20132; email: casacassano@gmail.com; cell: 646-963-3316
Field Trial Secretary: Audrey Silverstein: 1280 Brighton Circle, Seven Valleys, PA 17360; email: dinosmommie@yahoo.com; cell: 410-868-6369
Field Clerks: Audrey Silverstein, Bobbie Lutz, & members of CHAMP
Lure Operators: John Antonik, Cindy Antonik, Francis Byrne, Celeste Mulcrone,
Huntmasters: John Antonik, Francis Byrne, Celeste Mulcrone, Pat Spinazzola
Inspection Committee: Members of CHAMP

ELIGIBLE BREEDS AND REGISTRY

Only purebred Afghan Hounds, Azawakhs, Basenjis, Borzois, Cimechi dell'Etna, Greyhounds, Ibizan Hounds, Irish Wolfhounds, Italian Greyhounds, Pharaoh Hounds, Rhodesian Ridgebacks, Salukis, Scottish Deerhounds, Sloughis, Silken Windhounds, and Whippets may be entered in the regular stakes.

Provisional breeds may be entered in the Provisional Stake or the Singles Stake. Provisional stake breeds currently include: purebred Chart Polskis, Galgo Españols, Magyar Agars, Peruvian Inca Orchids, & Portuguese Podengos (Medio, Grande & Pequeno) and must be individually registered with the appropriate registry.

All entries shall be individually registered with the AKC (ILP/PAL included), the NGA, the UKC, the FCI, an ASFA-recognized foreign or ASFA Board approved registry, or possess a CRN from the SPDBS. A photocopy of acceptable registry must be submitted with each hound's first trial entry; this requirement is waived for hounds registered with the NGA.

REGULAR STAKES OFFERED

OPEN STAKE: Any eligible sighthound that has met certification requirements, excluding ASFA Field Champions of record.

FIELD CHAMPION STAKE: Any ASFA Field Champion

VETERAN STAKE: Any eligible sighthound whose age is at least six years, except Irish Wolfhounds whose age shall be at least five years; and Afghan Hounds, Ibizan Hounds, Rhodesian Ridgebacks, Salukis and Whippets whose age shall be at least seven years. Points go toward V-FCh or V-LCM titles.

PROVISIONAL STAKE: Any eligible sighthound of a Provisional breed that has met certification requirements. Not eligible to compete in Best of Breed or Best in Field.

SINGLES STAKE: Any eligible sighthound including those disqualified to run in other stakes. Each hound runs alone. The winner of this Singles stake shall not be eligible to compete in Best of Breed nor in Best in Field, but will be awarded High Scoring Single. Hounds are eligible to earn TCP and CPS titles from the Singles stake.

LURE CHASING INSTINCT (LCI) STAKE: Dogs run alone. Open to NON sighthounds and sighthound mixes. All entries shall be individually registered with the AKC (including ILP & PAL) or the UKC. A photocopy of acceptable registry must be submitted with each dog's first ASFA field trial entry. Dogs without a recognized registry number may obtain an ASFA ID number for a \$10 registration fee at time of entry.

Small Open: for dogs 17-1/2 inches or less at the withers and / or brachycephalic ("flat-faced") dogs who have not achieved the title of LCC.

Small Excellent: for dogs 17-1/2 inches or less at the withers and/or brachycephalic dogs who have achieved the title of LCC.

Small Veteran: for dogs 17-1/2 inches or less at the withers and/or brachycephalic dogs over the age of 7 years.

Large Open: for dogs over 17-1/2 inches at the withers who have not achieved the title of LCC.

Large Excellent: is for dogs over 17-1/2 inches at the withers who have achieved the title of LCC.

Large Veteran: for dogs over 17-1/2 inches at the withers who are over the age of 7 years.

Sighthound Mix Open: for dogs with a sighthound breed in its background who have not achieved the title of LCC.

Sighthound Mix Excellent: for dogs with sighthound breed in its background who have achieved the title of LCC.

Sighthound Mix Veteran: for dogs with sighthound breed in its background over the age of 7 years.

When running as a stake within a regular ASFA trial, Small will run 50% of the ASFA course as laid out for the sighthounds up to a maximum of 400 yards. All other stakes will run the full ASFA laid out course length.

******* LCIs will be limited to 10 dogs each day. *******

CONDITIONS OF ENTRY

- All entries must be one year or older on the day of the trial.
- Stakes will be split into flights by public random draw if the entry in any regular stake is 20 or more.
- Bitches in season, lame hounds and hounds with breed disqualifications will be excused at roll call.
- Exhibitors are requested not to bring bitches known to be in season to the field
- Spayed, neutered, monorchid or cryptorchid hounds without breed disqualifications may be entered.
- Hounds with breed disqualifications are not eligible to enter except in the Singles Stake.
- Hounds not present at the time of roll call will be scratched.
- All hounds will run twice, in trios if possible or braces (except in the Singles Stake and the LCIs), unless excused, dismissed, or disqualified.

COURSE PLANS -field is next to main road into Oatlands

Sat. – 650 yds

Sun. –708 yds

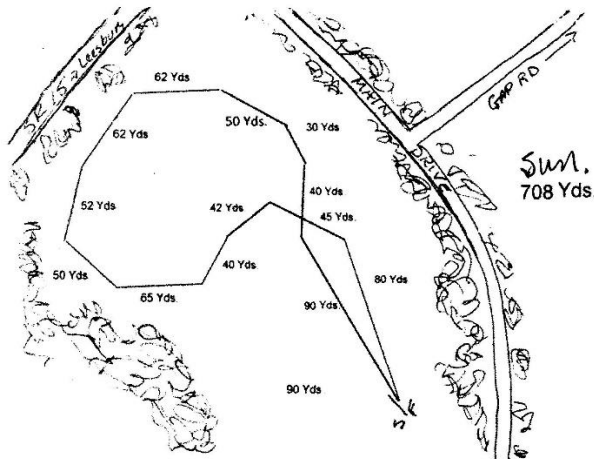
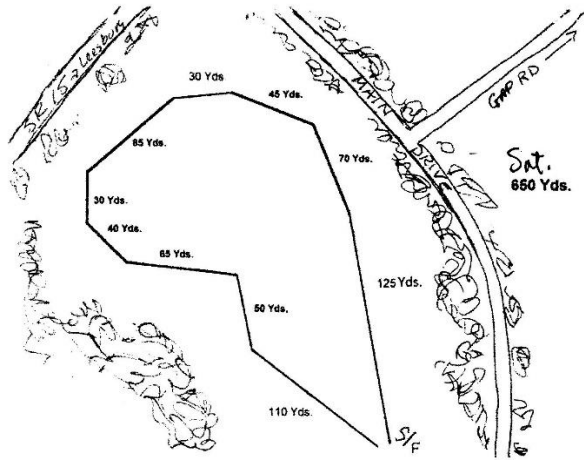

Course plan each day will be reversed for final run.

Equipment: lure machine is battery-powered continuous loop.

Lure type: highly-visible white plastic bags.

The club reserves the right to alter the course diagram as required by weather and/or field conditions on the day of the trial.

DIRECTIONS TO THE FIELD:

Directions from the North:

From Interstate 70 in Frederick, MD: take Route 340/15 South. Bear onto 15S at the split. Leesburg is 24 miles. Follow 15/7 Leesburg bypass to 15 South. Oatlands is 6 miles south of Leesburg on Rt. 15. Turn LEFT on to **Gap Road** and proceed to the field on the right. **Gap Rd.** is BEFORE Oatlands this direction. Watch for coursing signs.

From Washington Beltway: take either Route 7 or Dulles Greenway west to Leesburg 15/7 bypass, then exit south on Route 15-South. Follow rest of directions above.

Directions from the South:

Follow Route 15 North toward Leesburg. Oatlands is on the right before Leesburg. Go past the main entrance of Oatlands and TURN RIGHT on the first road, **Gap Road**. This is a narrow dirt road. Follow coursing signs to the field.

FIELD:

The field is fenced with typical board farm fencing. Please bring your own shade and water.

**** Limited overnight camping (10 RVs) on the field is permitted with prior notification to Bobbie Lutz-- email: lutzsei@aol.com or cell 703-505-1479****
**** \$10 per night is charged for non-club members. ****

CERTIFICATIONS:

Certifications will be offered on Saturday after completion of the trial if weather, equipment, daylight, and judges permit. The cost is \$10.00 per hound. Hound certification will NOT be offered on Sunday.

PRACTICE:

Practice will be offered on Saturday AFTER the trial and Certifications--weather, equipment, and time permitting. Cost is \$3.00 per hound

DISCLAIMER: Upon entering this trial, the exhibitor agrees to hold harmless the CHAMP club, its members, and the event location organization (Oatlands) for any injury, loss, or damage sustained by person or hound. There will be no refund if the trial has to be canceled due to weather or other unforeseen circumstance.

Coursing Hounds Association of the Mid-Potomac

Presents



The CHAMP Cup Run 2025

*In remembrance of Pete Smith &
Jay Johnson (who we lost on 9 Dec. '24)*

The CHAMP Cup run for Best in Event will be held on Sunday.

Hounds winning Best of Breed on Saturday and/or Sunday and previous CHAMP Cup winners are eligible to compete for the CHAMP Cup. **Dogs do not have to run both days to be eligible.**

Like us on Facebook & view the premium there.

**BEST IN FIELD WILL NOT BE OFFERED either day.
BEST in EVENT on Sunday will be offered.**

RIBBONS & TROPHIES:

First – Blue; Second – Red; Third – Yellow;
Fourth – White; NBQ – Green
High Score Single – Navy & Gold
Best of Breed – Purple and Gold

Best in Event – Red, White and Blue

There will be a \$5.00 fine assessed for any loose hound not taking part in a course in progress.

**ENTRIES will NOT be acknowledged by mail.
Separate, dated entry forms are required for each day.**

MOTEL ACCOMMODATIONS:

Red Roof Inn, 721 East Market Street, Leesburg, VA 703/777-6622,
Best Western, 726 E. Market St. Leesburg, VA , 703/777-9400
Holiday Inn, 1500 E. Market St., Leesburg, VA, 703/771-9200
Holiday Inn at Dulles, 1000 Sully Rd., Sterling, VA 703/471-7411—
12 miles from Leesburg

(You'll need to verify if these hotels still honor canine guests & what their pet fee is, if any.)

VETERINARIANS: TLC Emergency Clinic, 165 Ft.Evans Rd. NE, Leesburg, VA 20185; **703-777-5755**. (Rt 15 bypass to Rt.7 Bus.; R. on Ft. Evans to end) **or** **Blue Ridge Veterinary Assoc.**: 120 E. Cornwell Ln., Purcellville, VA 20132; Phone: **540-338-7387** From the Rt. 7-15 bypass (& W. Market St.), go west on Rt. 7 for **6.5 miles**. Take the Purcellville exit (Rt. 287) toward Purcellville and Business 7. Take immediate right onto Hirst Rd. Go approx. 1 mile & take a left onto Hatcher Ave. Take the next right onto E. Skyline Dr. to the clinic.) **They are also a 24-hr. emergency service.**

LUNCH will be offered. A \$5 donation would be appreciated.

OFFICIAL AMERICAN SIGHTHOUND FIELD ASSOCIATION
ENTRY FORM
COURSING HOUNDS ASSOCIATION OF THE MID-POTOMAC
Saturday, May 3, 2025

Field Trial Secretary: Audrey Silverstein: 1280 Brighton Circle, Seven Valleys, PA 17360
 Early Entries close 6 pm Thursday, **May 1, 2025** --- **Day-of-Trial Entries \$35 per dog**
Early Entry Fees: \$25 first hound, \$20.00 for each additional hound

Make checks payable in US funds to CHAMP

Fee Paid _____ The Field Secretary cannot accept conditional, unsigned, incomplete or unpaid entries; please check your completed entry carefully.

Breed:		Call Name:	
Registered Name of Hound:			
Stake: <input type="checkbox"/> Open <input type="checkbox"/> FCH <input type="checkbox"/> Veteran <input type="checkbox"/> Singles <input type="checkbox"/> Provisional		Additional Stakes <input type="checkbox"/> Kennel <input type="checkbox"/> Breeder <input type="checkbox"/> Bench	
Registration Number: (Please write in registering body before number)			
<input type="checkbox"/> If possible, please separate my hounds		Date of Birth:	Sex: <input type="checkbox"/> Dog <input type="checkbox"/> Bitch
Name of actual owner(s):			
Address:		Phone:	
City:		State:	Zip:
E-mail (Optional)		(Optional) Region of Residence:	
Emergency Contact Name and Phone (Optional)			
<input type="checkbox"/> Check if this is the first ASFA trial for this hound. Attach a Hound Certification or waiver if entered in Open, Veterans, Provisional. <input type="checkbox"/> Check if this is a first-time entry, a copy of the official Registration of this hound must accompany this entry unless NGA.			
<input type="checkbox"/> Check if any information has changed since the last ASFA trial entry. Regarding _____			
<input type="checkbox"/> Check if this hound has been dismissed within the last 6 trials entered. Must be marked in order to qualify for a "clean" trial requirement.			

I CERTIFY that I am the actual owner of this dog, or that I am the duly authorized agent of the actual owner whose name I have entered above. In consideration of the acceptance of this entry and the opportunity to have this dog judged and to win prize money, ribbons, or trophies, I (we) agree to abide by the rules and regulations of the American Sighthound Field Association in effect at the time of this lure field trial, and by any additional rules and regulations appearing in the premium list for this lure field trial. I (we) agree that the club holding this lure field trial has the right to refuse this entry for cause, which the club shall deem to be sufficient. I (we) agree to hold this club, its members, directors, governors, officers, agents or other functionaries, any employees of the aforementioned parties and the owner(s) of the trial premises or grounds harmless from any claim for loss or injury which may be alleged to have been caused directly or indirectly to any person or thing by the act of this dog while in or upon the lure field trial premises or grounds or near any entrance thereto and I (we) personally assume all responsibility and liability for any such claim, and I (we) further agree to hold the aforementioned parties harmless from any claim loss of this dog by disappearance, theft damage or injury be caused or alleged to be caused by the negligence of the club or any of the aforementioned parties or by the negligence of any person or any other cause or causes. I (we) certify and represent that the dog entered is not a hazard to person or other dogs. This entry is submitted for acceptance of the forgoing representations and agreements.

SIGNATURE of owner or his agent
 duly authorized to make this entry _____
 EF-A ~ rev 03-23©

Please separate the entries before submitting to FTS.

OFFICIAL AMERICAN SIGHTHOUND FIELD ASSOCIATION
ENTRY FORM
COURSING HOUNDS ASSOCIATION OF THE MID-POTOMAC
Sunday, May 4, 2025

Field Trial Secretary: Audrey Silverstein: 1280 Brighton Circle, Seven Valleys, PA 17360
 Early Entries close 6 pm Thursday, **May 1, 2025** --- **Day-of-Trial Entries \$35 per dog**
Early Entry Fees: \$25 first hound, \$20.00 for each additional hound

Make checks payable in US funds to CHAMP

Fee Paid _____ The Field Secretary cannot accept conditional, unsigned, incomplete or unpaid entries; please check your completed entry carefully.

Breed:		Call Name:	
Registered Name of Hound:			
Stake: <input type="checkbox"/> Open <input type="checkbox"/> FCH <input type="checkbox"/> Veteran <input type="checkbox"/> Singles <input type="checkbox"/> Provisional		Additional Stakes <input type="checkbox"/> Kennel <input type="checkbox"/> Breeder <input type="checkbox"/> Bench	
Registration Number (Please write in registering body before number)			
<input type="checkbox"/> If possible, please separate my hounds		Date of Birth:	Sex: <input type="checkbox"/> Dog <input type="checkbox"/> Bitch
Name of actual owner(s):			
Address:		Phone:	
City:		State:	Zip:
E-mail (Optional)		(Optional) Region of Residence:	
Emergency Contact Name and Phone (Optional)			
<input type="checkbox"/> Check if this is the first ASFA trial for this hound. Attach a Hound Certification or waiver if entered in Open, Veterans, Provisional. <input type="checkbox"/> Check if this is a first-time entry, a copy of the official Registration of this hound must accompany this entry unless NGA.			
<input type="checkbox"/> Check if any information has changed since the last ASFA trial entry. Regarding _____			
<input type="checkbox"/> Check if this hound has been dismissed within the last 6 trials entered. Must be marked in order to qualify for a "clean" trial requirement.			

I CERTIFY that I am the actual owner of this dog, or that I am the duly authorized agent of the actual owner whose name I have entered above. In consideration of the acceptance of this entry and the opportunity to have this dog judged and to win prize money, ribbons, or trophies, I (we) agree to abide by the rules and regulations of the American Sighthound Field Association in effect at the time of this lure field trial, and by any additional rules and regulations appearing in the premium list for this lure field trial. I (we) agree that the club holding this lure field trial has the right to refuse this entry for cause, which the club shall deem to be sufficient. I (we) agree to hold this club, its members, directors, governors, officers, agents or other functionaries, any employees of the aforementioned parties and the owner(s) of the trial premises or grounds harmless from any claim for loss or injury which may be alleged to have been caused directly or indirectly to any person or thing by the act of this dog while in or upon the lure field trial premises or grounds or near any entrance thereto and I (we) personally assume all responsibility and liability for any such claim, and I (we) further agree to hold the aforementioned parties harmless from any claim loss of this dog by disappearance, theft damage or injury be caused or alleged to be caused by the negligence of the club or any of the aforementioned parties or by the negligence of any person or any other cause or causes. I (we) certify and represent that the dog entered is not a hazard to person or other dogs. This entry is submitted for acceptance of the forgoing representations and agreements.

SIGNATURE of owner or his agent
 duly authorized to make this entry _____
 EF-A ~ rev 03-23©

Please separate the entries before submitting to FTS.

**AMERICAN SIGHTHOUND FIELD ASSOCIATION
HOUND CERTIFICATION**

Rule effective October 1, 1994: Ch. V, Sec. 4 (a) OPEN STAKE: *To be eligible to enter the open stake, a hound must have been certified by a licensed judge within the year preceding the closing date for the entry or have previously competed in the Open Stake.* This eligibility requirement also applies to a hound entered in the Veteran Stake, which has not competed in Open previously. Please complete this portion of this form and attach it to the entry form for the hound's first entry, including an entry for a Fun Trial.

Registered Name of Hound: _____

Registration Number: _____ Breed: _____

Registered Owner's Name: _____

I hereby certify that on (date) _____, the above named hound completed a lure course of at least 500 yards, running with another hound of the same breed (or another breed with a similar running style). During the course the above named hound showed no inclination to interfere with the other hound. I further certify that I am a licensed judge for the ASFA.

Name of Licensed Judge: _____

Signature: _____ Date: _____

I hereby certify that the hound running in the certification course is the hound identified above and that information provided on this form is true and correct.

Signature: _____ Date: _____

Owner or Authorized Agent of Hound

This certification form must be attached to the entry form the first time this hound is entered in an open or veteran stake. Any hound entered in open, or veteran (as a first time entered hound), which has not been certified, shall be declared ineligible by the records coordinator and shall forfeit any points and placements awarded.

PLEASE RETAIN A COPY FOR YOUR RECORDS.

**AMERICAN SIGHTHOUND FIELD ASSOCIATION
HOUND CERTIFICATION WAIVER**

Waiver of Requirement: *This requirement will be waived for a hound that has earned a lure coursing title from another recognized organization, if such title requires competition, and if a waiver for such title has been approved by the ASFA, or a CKC Hound Certification Form.* If your hound qualifies for a waiver, complete this portion of this form and attach it to your entry form. Proof of waivers must accompany this certification form.

Registered Name of Hound: _____

Registration Number: _____ Breed: _____

Registered Owner's Name: _____

CKC: FCH FCHX

AKC: QC SC FC

Hound Certification previously submitted.

I hereby certify that the hound identified above has completed the requirements for the title indicated above (or that the required Certification was previously submitted) and that the information provided on this form is true and correct.

Signature: _____ Date: _____

Owner or Authorized Agent of Hound

**AMERICAN SIGHTHOUND FIELD ASSOCIATION
HOUND CERTIFICATION**

Rule effective October 1, 1994: Ch. V, Sec. 4 (a) OPEN STAKE: *To be eligible to enter the open stake, a hound must have been certified by a licensed judge within the year preceding the closing date for the entry or have previously competed in the Open Stake.* This eligibility requirement also applies to a hound entered in the Veteran Stake, which has not competed in Open previously. Please complete this portion of this form and attach it to the entry form for the hound's first entry, including an entry for a Fun Trial.

Registered Name of Hound: _____

Registration Number: _____ Breed: _____

Registered Owner's Name: _____

I hereby certify that on (date) _____, the above named hound completed a lure course of at least 500 yards, running with another hound of the same breed (or another breed with a similar running style). During the course the above named hound showed no inclination to interfere with the other hound. I further certify that I am a licensed judge for the ASFA.

Name of Licensed Judge: _____

Signature: _____ Date: _____

I hereby certify that the hound running in the certification course is the hound identified above and that information provided on this form is true and correct.

Signature: _____ Date: _____

Owner or Authorized Agent of Hound

This certification form must be attached to the entry form the first time this hound is entered in an open or veteran stake. Any hound entered in open, or veteran (as a first time entered hound), which has not been certified, shall be declared ineligible by the records coordinator and shall forfeit any points and placements awarded.

PLEASE RETAIN A COPY FOR YOUR RECORDS.

**AMERICAN SIGHTHOUND FIELD ASSOCIATION
HOUND CERTIFICATION WAIVER**

Waiver of Requirement: *This requirement will be waived for a hound that has earned a lure coursing title from another recognized organization, if such title requires competition, and if a waiver for such title has been approved by the ASFA, or a CKC Hound Certification Form.* If your hound qualifies for a waiver, complete this portion of this form and attach it to your entry form. Proof of waivers must accompany this certification form.

Registered Name of Hound: _____

Registration Number: _____ Breed: _____

Registered Owner's Name: _____

CKC: FCH FCHX

AKC: QC SC FC

Hound Certification previously submitted.

I hereby certify that the hound identified above has completed the requirements for the title indicated above (or that the required Certification was previously submitted) and that the information provided on this form is true and correct.

Signature: _____ Date: _____

Owner or Authorized Agent of Hound

OFFICIAL AMERICAN SIGHTHOUND FIELD ASSOCIATION

LCI ENTRY FORM

COURSING HOUNDS ASSOCIATION OF THE MID-POTOMAC

SATURDAY May 3, 2025

Field Trial Secretary: Audrey Silverstein: 1280 Brighton Circle, Seven Valleys, PA 17360

Early Entries close 6 pm Thursday, May 1, 2025 --- **Day-of-Trial Entries \$35 per dog.**

Early Entry Fees: \$25 first hound, \$20.00 for each additional hound

Make checks payable in US funds to CHAMP

Fee Paid _____ The Field Secretary cannot accept conditional, unsigned, incomplete, or unpaid entries; please check your completed entry carefully.

LCIs will be limited to 10 dogs each day.

Breed:		Call Name:	
Registered Name of dog:			
Stake: <input type="checkbox"/> LCI-Small <input type="checkbox"/> LCI-Large <input type="checkbox"/> LCI-Sighthound Mix <input type="checkbox"/> Open <input type="checkbox"/> Excellent <input type="checkbox"/> Veteran			
Registration Number: (please write in registering body before number)			
Date of Birth:		Sex: <input type="checkbox"/> Dog <input type="checkbox"/> Bitch	
Name of actual owner(s):			
Address:		Phone:	
City:		State:	Zip:
E-mail		(Optional) Region of Residence:	
Emergency Contact Name and Phone (Optional)			
<input type="checkbox"/> Check if this is a first-time entry, a copy of the official Registration of this hound must accompany this entry. (i.e., AKC Registration form, PAL registration, Canine Partner, etc.)			
<input type="checkbox"/> Check if any information has changed since the last ASFA trial entry. Regarding _____			

I CERTIFY that I am the actual owner of this dog, or that I am the duly authorized agent of the actual owner whose name I have entered above. In consideration of the acceptance of this entry and the opportunity to have this dog judged and to win prize money, ribbons, or trophies, I (we) agree to abide by the rules and regulations of the American Sighthound Field Association in effect at the time of this lure field trial, and by any additional rules and regulations appearing in the premium list for this lure field trial. I (we) agree that the club holding this lure field trial has the right to refuse this entry for cause, which the club shall deem to be sufficient. I (we) agree to hold this club, its members, directors, governors, officers, agents or other functionaries, any employees of the aforementioned parties and the owner(s) of the trial premises or grounds harmless from any claim for loss or injury which may be alleged to have been caused directly or indirectly to any person or thing by the act of this dog while in or upon the lure field trial premises or grounds or near any entrance thereto and I (we) personally assume all responsibility and liability for any such claim, and I (we) further agree to hold the aforementioned parties harmless from any claim loss of this dog by disappearance, theft damage or injury be caused or alleged to be caused by the negligence of the club or any of the aforementioned parties or by the negligence of any person or any other cause or causes. I (we) certify and represent that the dog entered is not a hazard to person or other dogs. This entry is submitted for acceptance of the forgoing representations and agreements.

SIGNATURE of owner or his agent
duly authorized to make this entry _____

Please separate the entries before submitting to FTS.

OFFICIAL AMERICAN SIGHTHOUND FIELD ASSOCIATION

LCI ENTRY FORM

COURSING HOUNDS ASSOCIATION OF THE MID-POTOMAC

SUNDAY May 4, 2025

Field Trial Secretary: Audrey Silverstein: 1280 Brighton Circle, Seven Valleys, PA 17360

Early Entries close 6 pm Thursday, May 1, 2025 --- **Day-of-Trial Entries \$35 per dog.**

Early Entry Fees: \$25 first hound, \$20.00 each additional hound

Make checks payable in US funds to CHAMP

Fee Paid _____ The Field Secretary cannot accept conditional, unsigned, incomplete, or unpaid entries; please check your completed entry carefully.

LCIs will be limited to 10 dogs each day.

Breed:		Call Name:	
Registered Name of dog:			
Stake: <input type="checkbox"/> LCI-Small <input type="checkbox"/> LCI-Large <input type="checkbox"/> LCI-Sighthound Mix <input type="checkbox"/> Open <input type="checkbox"/> Excellent <input type="checkbox"/> Veteran			
Registration Number: (please write in registering body before number)			
Date of Birth:		Sex: <input type="checkbox"/> Dog <input type="checkbox"/> Bitch	
Name of actual owner(s):			
Address:		Phone:	
City:		State:	Zip:
E-mail		(Optional) Region of Residence:	
Emergency Contact Name and Phone (Optional)			
<input type="checkbox"/> Check if this is a first-time entry, a copy of the official Registration of this hound must accompany this entry. (i.e., AKC Registration form, PAL registration, Canine Partner, etc.)			
<input type="checkbox"/> Check if any information has changed since the last ASFA trial entry. Regarding _____			

I CERTIFY that I am the actual owner of this dog, or that I am the duly authorized agent of the actual owner whose name I have entered above. In consideration of the acceptance of this entry and the opportunity to have this dog judged and to win prize money, ribbons, or trophies, I (we) agree to abide by the rules and regulations of the American Sighthound Field Association in effect at the time of this lure field trial, and by any additional rules and regulations appearing in the premium list for this lure field trial. I (we) agree that the club holding this lure field trial has the right to refuse this entry for cause, which the club shall deem to be sufficient. I (we) agree to hold this club, its members, directors, governors, officers, agents or other functionaries, any employees of the aforementioned parties and the owner(s) of the trial premises or grounds harmless from any claim for loss or injury which may be alleged to have been caused directly or indirectly to any person or thing by the act of this dog while in or upon the lure field trial premises or grounds or near any entrance thereto and I (we) personally assume all responsibility and liability for any such claim, and I (we) further agree to hold the aforementioned parties harmless from any claim loss of this dog by disappearance, theft damage or injury be caused or alleged to be caused by the negligence of the club or any of the aforementioned parties or by the negligence of any person or any other cause or causes. I (we) certify and represent that the dog entered is not a hazard to person or other dogs. This entry is submitted for acceptance of the forgoing representations and agreements.

SIGNATURE of owner or his agent
duly authorized to make this entry _____

Please separate the entries before submitting to FTS.

OFFICIAL AMERICAN SIGHTHOUND FIELD ASSOCIATION
Lure Chasing Instinct **FIRST TIME Registration**
COURSING HOUNDS ASSOCIATION OF THE MID-POTOMAC

Fee Paid _____ The Field Secretary cannot accept conditional, unsigned, incomplete, or unpaid entries; please check your completed entry carefully.

Please print legibly.

Breed:		Call Name:	
Registered Name of Hound:			
FTS will circle Size after wicketing at Inspection: Size Small: up to 17½ inches (or brachycephalic) Size Large: over 17½ inches			
Registration Number: (please write in registering body before number)			
Date of Birth:		Sex: <input type="checkbox"/> Dog <input type="checkbox"/> Bitch	
Name of actual owner(s):			
Address:		Phone:	
City:		State:	Zip:
E-mail		Region of Residence: (Optional)	
Emergency Contact Name and Phone			

This top portion is to be submitted with the \$10 fee to the ASFA by the Field Trial Secretary, with the records.
 * * * * *

_____ was entered in the _____
 (Dog's Name) (ASFA Club Name)

ASFA trial held on _____. The dog was wicketed at inspection and is registered as Size _____. The fee of \$10 was received by the FTS and submitted to the ASFA Records Coordinator.

 Printed name of Field Trial Secretary

 Signature of Field Trial Secretary

(Owner is to retain this receipt as proof of registration until notified by the ASFA.)

OFFICIAL AMERICAN SIGHTHOUND FIELD ASSOCIATION
Lure Chasing Instinct **FIRST TIME Registration**
COURSING HOUNDS ASSOCIATION OF THE MID-POTOMAC

Fee Paid _____ The Field Secretary cannot accept conditional, unsigned, incomplete, or unpaid entries; please check your completed entry carefully.

Please print legibly.

Breed:		Call Name:	
Registered Name of Hound:			
FTS will circle Size after wicketing at Inspection: Size Small: up to 17½ inches (or brachycephalic) Size Large: over 17½ inches			
Registration Number: (please write in registering body before number)			
Date of Birth:		Sex: <input type="checkbox"/> Dog <input type="checkbox"/> Bitch	
Name of actual owner(s):			
Address:		Phone:	
City:		State:	Zip:
E-mail		Region of Residence: (Optional)	
Emergency Contact Name and Phone			

This top portion is to be submitted with the \$10 fee to the ASFA by the Field Trial Secretary, with the records.
 * * * * *

_____ was entered in the _____
 (Dog's Name) (ASFA Club Name)

ASFA trial held on _____. The dog was wicketed at inspection and is registered as Size _____. The fee of \$10 was received by the FTS and submitted to the ASFA Records Coordinator.

 Printed name of Field Trial Secretary

 Signature of Field Trial Secretary

(Owner is to retain this receipt as proof of registration until notified by the ASFA.)