

Motels (check or current dog policies and restrictions)

Hyatt Place - Lansing East, 2401 Showtime Dr., Lansing MI (\$75 pet fee) 517-679-7600

Best Western, 2209 University Park Dr., Okemos MI (\$25 per dog pet fee) 517-349-8700

Candlewood Suites 3545 Forest Rd Lansing, MI (Pet fee) 517-351-8181

Hampton Inn & Suites, 2200 Hampton Pl., Okemos, MI (pet fee) 517-349-6100

Holiday Inn Express & Suites, 2350 Jolly Oak Rd., Okemos, MI (\$25.00 per dog pet fee)

517-999-8700 ext. 500

HomeTown Studios, 2335 Woodlake Dr., Okemos, MI. (\$10.00 per dog per day pet fee)  
517-347-1000

Red Roof Inn, 3615 Dunckel Rd., Lansing, MI (one dog per room but inquire when you call as sometimes they are flexible) 517-332-2575

Comfort Inn Okemos 2187 University Park Dr, Okemos, MI 48864 (Pet Fee) 517-347-6690

Residence Inn Marriott, 922 Delta Commerce Dr., Lansing, MI. 517-886-5030

Staybridge Suites, 3553 Meridian Crossing Dr., Okemos, MI (pet fee). 517-347-3044

Check bringfido.com as there are a number of airbnb, vrbo and hotels listed there for the area.

### Camping

Permitted on site. Dry Camping only. No hookups, no water, no electricity. Bigger rigs need to check with FTS before signing up for camping. \$20 per night

### Veterinarians

Greater Lansing Veterinary Center

Open 24/7. Please call ahead

1290 W Grand River Ave Suite 500, Williamston, MI 48895

Phone: (517) 708-2525

### Directions to the Trial Site

From the West (Lansing) on I96, take the Williamston Rd exit 117A toward Dansville. Turn right onto Williamston Rd 1.3 miles turn left onto Holt Rd. 1.0 mile turn right onto N. Meech Rd. About 0.7 miles the farm will be on the right. From the East (Webberville, Howell) on I96, turn left onto M-43 E/M-52 S/ Stockbridge Rd. Continue to follow M-52 S/Stockbridge Rd for 1.1 miles. Turn right onto Holt Rd. 3.3 miles turn left onto Meech Rd. About 0.7 miles the farm will be on the right.

### PLEASE NOTE

- Bring your own shade and water.
- **BRING YOUR OWN FOOD AND WATER. Lunch will NOT be available** for purchase on-site. Fast food places are in Williamston or Webberville.
- HOUND CERTIFICATIONS and practice after the trial on Saturday, conditions permitting. Free to members of MGA and event workers, as designated by the field trial chairman; \$5.00 per dog for all others.
- Please take your trash with you!
- **ONLINE ENTRIES** available at <https://www.michigangazehound.com/online-entries>. \$2 processing fee per entry, if paypal is used.

**Go to [www.asfa.org](http://www.asfa.org) for the latest Rulebook, Policies, Contacts, Clubs, Trial Schedules, Trial Results & much more**

## Premium List

Early entry fee: \$20 each hound

**Early entries close 6:00 PM, Wednesday June 25, 2025 at**  
FTS address (984 Merry Ln Leslie, MI 49251)

*Online Entry available*

Day of Trial entry fee: \$30

Day of Trial Entries close 7:15 AM at the FTS table

## ASFA Silken Windhound Specialty Lure Field Trial

### Michigan Gazehound Association

[michigangazehound.com](http://michigangazehound.com)



**June 28-29, 2025**

**Tazidan Farm**

**1629 N Meech Rd**

**Williamston, MI**

**Region 6**

Day of Trial Phone: 517-749-1115

Permission has been granted by the American Sighthound Field Association (ASFA) for the holding of this event under ASFA rules and regulations.

Approved by Samantha Duryee, Chairperson, ASFA Scheduling Committee

## Michigan Gazehound Association

President—Lianna Frazer; Vice President—Michelle Hogan  
Secretary—Jessica Epstein; Treasurer—Matt Botzau; Director—Karen Estis

Judges and Assignments (\* = provisional, # = Canadian judge, S=single judge)

<b>Saturday Judges</b>	<b>SW</b>
Judy Lowther	x
<b>Sunday Judges</b>	<b>SW</b>
Sabrina Wright Hiller	x

Judy Lowther, Cleveland OH

Sabrina Wright-Hiller, Jefferson, IA

### Field Trial Committee

Field Trial Chair: Michelle Hogan 20836 Hall Rd PMB 327 Clinton Twp, MI 48038  
Email: pandorabasenjis@gmail.com Phone: (586) 246-6261

Field Trial Secretary: Jessica Epstein, 984 Merry Ln, L eslie MI 49251

Email: wolfpine8@gmail.com Phone: 517-749-1115

Lure Operator: Matt Botzau, Denis Seeley, Joe Shoemaker, Jarret Teamer, Meg Willis-Redfern, Don White

Additional Members: Jill Botzau, Lianna Frazer, Diane Guest, Suzanne LaCroix, Vicki Roll, Kelli Harmon

### Ribbons

Ribbons or rosettes will be offered for all placements: 1st (blue), 2nd (red), 3rd (yellow), 4th (white), NBQ (green), High Scoring Single (navy/gold), Best of Breed (purple/gold). Other prizes may be offered by MGA and friends of MGA.

**Trial Hours:** 7:00 A.M. until one hour after the last scored course of the day

**Day of Trial Entries Close:** 7:15 A.M. **Roll Call:** 7:30 A.M.

Substitutions will be accepted for lame or in-season hounds.

Make checks payable to "MGA" in US funds. Do NOT send entries "signature required". Entries will NOT be acknowledged by mail. Late, incomplete, or unpaid entries will not be accepted. Entries will be acknowledged by e mail if a legible e-mail address is provided on the entry form. There will be a \$25 fee for any returned check.

### Conditions of Entry

- All entries must be one year or older on the day of the trial
- Stakes will be split into flights by public random draw if the entry in any regular stake is 20 or more
- Bitches in season, lame hounds and hounds with breed disqualifications will be excused at roll call. Spayed, neutered, monorchid or cryptorchid hounds without breed disqualifications may be entered. Hounds with breed disqualifications are not eligible to enter except in the Single Stake
- Hounds not present at the time of roll call will be scratched
- All hounds will run twice, in trios if possible or braces (except in the Single Stake and all LCI Stakes), unless excused, dismissed or disqualified.

### Eligible Breeds & Registry

Only purebred Silken Windhounds and must be individually registered with the appropriate registry.

All entries shall be individually registered with the AKC (ILP/PAL included), the NGA, the UKC, the FCI, an ASFA-recognized foreign or ASFA Board approved registry, or possess a CRN from the SPDBS. A photocopy of acceptable registry must be submitted with each hound's first ASFA field trial entry; this requirement is waived for hounds registered with the NGA.

### Regular Stakes Offered

**OPEN STAKE:** Any eligible Silken Windhound, excluding ASFA Field Champions of record that has met the certification requirements.

**FIELD CHAMPION STAKE:** Any Silken Windhound ASFA Field Champion of record. **VETERAN STAKE:** Any eligible Silken Windhound that has met the certification requirements and whose age is at least six years. Points go toward V-FCh or V-LCM titles.

**SINGLES STAKE:** Any eligible Silken Windhound including those disqualified to run in other stakes. Each hound runs alone. Not eligible for Best of Breed or Best in Field. Hounds are eligible to earn TCP and CPX titles from the Singles stake. Provisional breeds are not eligible for these titles.

### HOW TO ENTER

**Scanned/E-mailed entries are acceptable. However, payment MUST be made at the time of sending entries using the payment option on the Michigan Gazehound Association website. The email payment confirmation you receive from PayPal can be forwarded to the FTS as proof of payment.**

**MAILED entries may be paid by either a check in US Funds or by using the payment button at the Michigan Gazehound Association Website.**

**Online entries are also accepted via the AKC entry forms for sighthounds at the Michigan Gazehound Association website. Payment can be made after submitting your online entries.**

### NO EXCEPTIONS.

**If you have NOT provided payment by roll call on the day of trial, your entry will be considered conditional and not accepted.**

**ONLINE:** Instructions on how to Enter and Pay ONLINE can be found on the Online Entries Page on the Michigan Gazehound Association website:

<https://www.michigangazehound.com/online-entries>

## Course Plans

### Saturday

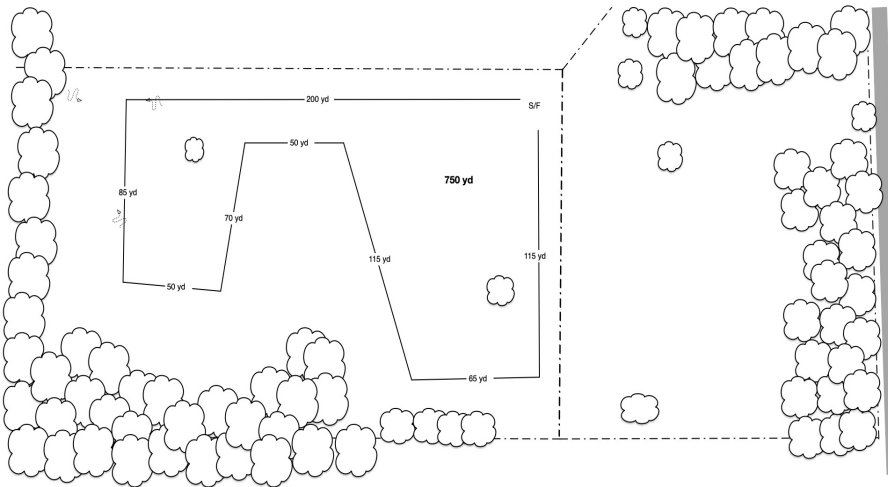

### Sunday

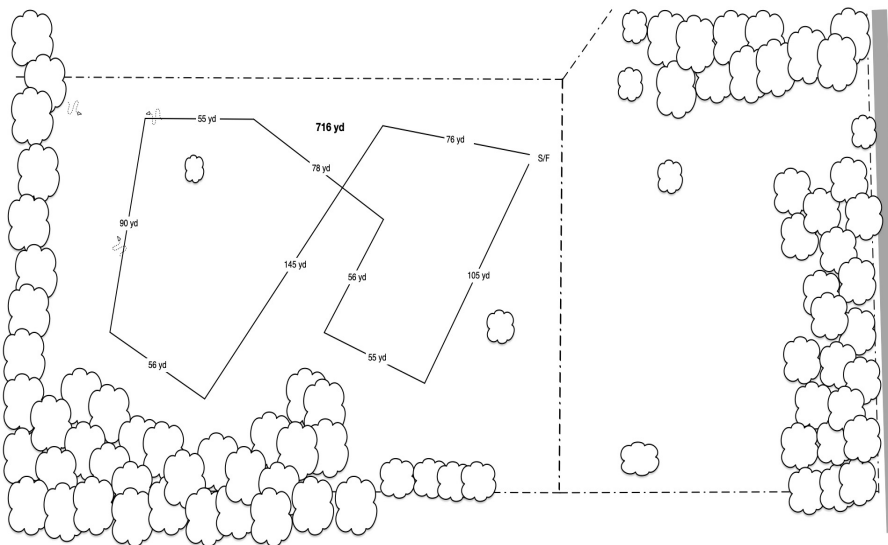

- Gas-powered continuous loop lure machines will be used, with backup equipment on site
- The lure will consist of highly visible white or black plastic strips and/or fur strips
- Course may be altered as required by weather or field conditions
- Course will be reversed for finals
- A \$5.00 fine will be collected from the handler of any non-competing hound running loose on the field during the course in progress, and from any person not cleaning up after his/her hound.
- A pool with water will be on-site for cooling off dogs

### Info about the farm:

- There is a small downhill walk to get from parking to the running field. Accommodations can be made to get you to the field as necessary.
- Field is completely fenced.
- Please do not go around the roped off areas.
- Take trash with you!
- The ticks are bad! So bring repellent for you and your dogs







## MGA ANNUAL POTLUCK

On Saturday after the trial we are having our potluck! Outside of the barn (Inside if it is raining), we will have tables set up for dishes. There is electric in the barn for crock pots, etc. Open to all! Any dish is welcome, ie chips, desserts, sandwiches, etc



# OFFICIAL AMERICAN SIGHTHOUND FIELD ASSOCIATION ENTRY FORM

Michigan Gazehound Association Saturday

June 28, 2025

Make checks payable to "MGA" in US funds and mail to:

Jessica Epstein, 984 Merry Ln, Leslie MI 49251

Entry fee is \$20 each hound; closing 9:00 PM, Wednesday June 25 2025 at FTS address.

Day of Trial entry fee is \$30 each hound; closing at 7:15 AM at FTS table.

Fee Paid \_\_\_\_\_ The Field Secretary cannot accept conditional, unsigned, incomplete, or unpaid entries; please check your completed entry carefully.

Breed:	Call Name:		
Registered Name of Hound:			
Stake: <input type="checkbox"/> Open <input type="checkbox"/> FCH <input type="checkbox"/> Veteran <input type="checkbox"/> Singles <input type="checkbox"/> Provisional		Additional Stakes <input type="checkbox"/> Kennel <input type="checkbox"/> Breeder <input type="checkbox"/> Bench	
<b>Registration Number:</b> (please write in registering body before number)			
<input type="checkbox"/> If possible, please separate my hounds	Date of Birth:	Sex: <input type="checkbox"/> Dog <input type="checkbox"/> Bitch	
Name of actual owner(s):			
Address:		Phone:	
City:		State:	Zip:
E-mail (Optional)		(Optional) Region of Residence:	
Emergency Contact Name and Phone (Optional)			
<input type="checkbox"/> <b>Check if this is the first ASFA trial for this hound. Attach a Hound Certification or waiver if entered in Open, Veterans, Provisional.</b>			
<input type="checkbox"/> <b>Check if this is a first-time entry, a copy of the official Registration of this hound must accompany this entry unless NGA.</b>			
<input type="checkbox"/> Check if any information has changed since the last ASFA trial entry. Regarding _____			
<input type="checkbox"/> Check if this hound has been dismissed within the last 6 trials entered. Must be marked in order to qualify for a "clean" trial requirement.			

I CERTIFY that I am the actual owner of this dog, or that I am the duly authorized agent of the actual owner whose name I have entered above. In consideration of the acceptance of this entry and the opportunity to have this dog judged and to win prize money, ribbons, or trophies, I (we) agree to abide by the rules and regulations of the American Sighthound Field Association in effect at the time of this lure field trial, and by any additional rules and regulations appearing in the premium list for this lure field trial. I (we) agree that the club holding this lure field trial has the right to refuse this entry for cause, which the club shall deem to be sufficient. I (we) agree to hold this club, its members, directors, governors, officers, agents or other functionaries, any employees of the aforementioned parties and the owner(s) of the trial premises or grounds harmless from any claim for loss or injury which may be alleged to have been caused directly or indirectly to any person or thing by the act of this dog while in or upon the lure field trial premises or grounds or near any entrance thereto and I (we) personally assume all responsibility and liability for any such claim, and I (we) further agree to hold the aforementioned parties harmless from any claim loss of this dog by disappearance, theft damage or injury be caused or alleged to be caused by the negligence of the club or any of the aforementioned parties or by the negligence of any person or any other cause or causes. I (we) certify and represent that the dog entered is not a hazard to person or other dogs. This entry is submitted for acceptance of the forgoing representations and agreements.

**SIGNATURE** of owner or his agent  
duly authorized to make this entry \_\_\_\_\_

**Please separate the entries before submitting to FTS.**

# OFFICIAL AMERICAN SIGHTHOUND FIELD ASSOCIATION ENTRY FORM

Michigan Gazehound Association

Sunday June 29, 2025

Make checks payable to "MGA" in US funds and mail to:

Jessica Epstein, 984 Merry Ln, Leslie MI 49251

Entry fee is \$20 each hound; closing 9:00 PM, Wednesday June 25, 2025 at FTS address.

Day of Trial entry fee is \$30 each hound; closing at 7:15 AM at FTS table.

Fee Paid \_\_\_\_\_ The Field Secretary cannot accept conditional, unsigned, incomplete, or unpaid entries; please check your completed entry carefully.

Breed:	Call Name:		
Registered Name of Hound:			
Stake: <input type="checkbox"/> Open <input type="checkbox"/> FCH <input type="checkbox"/> Veteran <input type="checkbox"/> Singles <input type="checkbox"/> Provisional		Additional Stakes <input type="checkbox"/> Kennel <input type="checkbox"/> Breeder <input type="checkbox"/> Bench	
<b>Registration Number:</b> (please write in registering body before number)			
<input type="checkbox"/> If possible, please separate my hounds	Date of Birth:	Sex: <input type="checkbox"/> Dog <input type="checkbox"/> Bitch	
Name of actual owner(s):			
Address:		Phone:	
City:		State:	Zip:
E-mail (Optional)		(Optional) Region of Residence:	
Emergency Contact Name and Phone (Optional)			
<input type="checkbox"/> <b>Check if this is the first ASFA trial for this hound. Attach a Hound Certification or waiver if entered in Open, Veterans, Provisional.</b>			
<input type="checkbox"/> <b>Check if this is a first-time entry, a copy of the official Registration of this hound must accompany this entry unless NGA.</b>			
<input type="checkbox"/> Check if any information has changed since the last ASFA trial entry. Regarding _____			
<input type="checkbox"/> Check if this hound has been dismissed within the last 6 trials entered. Must be marked in order to qualify for a "clean" trial requirement.			

I CERTIFY that I am the actual owner of this dog, or that I am the duly authorized agent of the actual owner whose name I have entered above. In consideration of the acceptance of this entry and the opportunity to have this dog judged and to win prize money, ribbons, or trophies, I (we) agree to abide by the rules and regulations of the American Sighthound Field Association in effect at the time of this lure field trial, and by any additional rules and regulations appearing in the premium list for this lure field trial. I (we) agree that the club holding this lure field trial has the right to refuse this entry for cause, which the club shall deem to be sufficient. I (we) agree to hold this club, its members, directors, governors, officers, agents or other functionaries, any employees of the aforementioned parties and the owner(s) of the trial premises or grounds harmless from any claim for loss or injury which may be alleged to have been caused directly or indirectly to any person or thing by the act of this dog while in or upon the lure field trial premises or grounds or near any entrance thereto and I (we) personally assume all responsibility and liability for any such claim, and I (we) further agree to hold the aforementioned parties harmless from any claim loss of this dog by disappearance, theft damage or injury be caused or alleged to be caused by the negligence of the club or any of the aforementioned parties or by the negligence of any person or any other cause or causes. I (we) certify and represent that the dog entered is not a hazard to person or other dogs. This entry is submitted for acceptance of the forgoing representations and agreements.

**SIGNATURE** of owner or his agent  
duly authorized to make this entry \_\_\_\_\_

**Please separate the entries before submitting to FTS.**

**AMERICAN SIGHTHOUND FIELD ASSOCIATION  
HOUND CERTIFICATION**

**Rule effective October 1, 1994: Ch. V, Sec. 4 (a) OPEN STAKE:** *To be eligible to enter the open stake, a hound must have been certified by a licensed judge within the year preceding the closing date for the entry or have previously competed in the Open Stake.* This eligibility requirement also applies to a hound entered in the Veteran Stake, which has not competed in Open previously. Please complete this portion of this form and attach it to the entry form for the hound's first entry, including an entry for a Fun Trial.

Registered Name of Hound: \_\_\_\_\_

Registration Number: \_\_\_\_\_ Breed: \_\_\_\_\_

Registered Owner's Name: \_\_\_\_\_

I hereby certify that on (date) \_\_\_\_\_, the above named hound completed a lure course of at least 500 yards, running with another hound of the same breed (or another breed with a similar running style). During the course the above named hound showed no inclination to interfere with the other hound. I further certify that I am a licensed judge for the ASFA.

Name of Licensed Judge: \_\_\_\_\_

Signature: \_\_\_\_\_ Date: \_\_\_\_\_

I hereby certify that the hound running in the certification course is the hound identified above and that information provided on this form is true and correct.

Signature: \_\_\_\_\_ Date: \_\_\_\_\_

Owner or Authorized Agent of Hound

This certification form must be attached to the entry form the first time this hound is entered in an open or veteran stake. Any hound entered in open, or veteran (as a first time entered hound), which has not been certified, shall be declared ineligible by the records coordinator and shall forfeit any points and placements awarded.

**PLEASE RETAIN A COPY FOR YOUR RECORDS.**

**AMERICAN SIGHTHOUND FIELD ASSOCIATION  
HOUND CERTIFICATION WAIVER**

**Waiver of Requirement:** *This requirement will be waived for a hound that has earned a lure coursing title from another recognized organization, if such title requires competition, and if a waiver for such title has been approved by the ASFA, or a CKC Hound Certification Form.* If your hound qualifies for a waiver, complete this portion of this form and attach it to your entry form. Proof of waivers must accompany this certification form.

Registered Name of Hound: \_\_\_\_\_

Registration Number: \_\_\_\_\_ Breed: \_\_\_\_\_

Registered Owner's Name: \_\_\_\_\_

**CKC:** FCH FCHX

**AKC:** QC SC FC

Hound Certification previously submitted.

I hereby certify that the hound identified above has completed the requirements for the title indicated above (or that the required Certification was previously submitted) and that the information provided on this form is true and correct.

Signature: \_\_\_\_\_ Date: \_\_\_\_\_

Owner or Authorized Agent of Hound

**AMERICAN SIGHTHOUND FIELD ASSOCIATION  
HOUND CERTIFICATION**

**Rule effective October 1, 1994: Ch. V, Sec. 4 (a) OPEN STAKE:** *To be eligible to enter the open stake, a hound must have been certified by a licensed judge within the year preceding the closing date for the entry or have previously competed in the Open Stake.* This eligibility requirement also applies to a hound entered in the Veteran Stake, which has not competed in Open previously. Please complete this portion of this form and attach it to the entry form for the hound's first entry, including an entry for a Fun Trial.

Registered Name of Hound: \_\_\_\_\_

Registration Number: \_\_\_\_\_ Breed: \_\_\_\_\_

Registered Owner's Name: \_\_\_\_\_

I hereby certify that on (date) \_\_\_\_\_, the above named hound completed a lure course of at least 500 yards, running with another hound of the same breed (or another breed with a similar running style). During the course the above named hound showed no inclination to interfere with the other hound. I further certify that I am a licensed judge for the ASFA.

Name of Licensed Judge: \_\_\_\_\_

Signature: \_\_\_\_\_ Date: \_\_\_\_\_

I hereby certify that the hound running in the certification course is the hound identified above and that information provided on this form is true and correct.

Signature: \_\_\_\_\_ Date: \_\_\_\_\_

Owner or Authorized Agent of Hound

This certification form must be attached to the entry form the first time this hound is entered in an open or veteran stake. Any hound entered in open or veteran (as a first time entered hound), which has not been certified, shall be declared ineligible by the records coordinator and shall forfeit any points and placements awarded.

**PLEASE RETAIN A COPY FOR YOUR RECORDS.**

**AMERICAN SIGHTHOUND FIELD ASSOCIATION  
HOUND CERTIFICATION WAIVER**

**Waiver of Requirement:** *This requirement will be waived for a hound that has earned a lure coursing title from another recognized organization, if such title requires competition, and if a waiver for such title has been approved by the ASFA, or a CKC Hound Certification Form.* If your hound qualifies for a waiver, complete this portion of this form and attach it to your entry form. Proof of waivers must accompany this certification form.

Registered Name of Hound: \_\_\_\_\_

Registration Number: \_\_\_\_\_ Breed: \_\_\_\_\_

Registered Owner's Name: \_\_\_\_\_

**CKC:** FCH FCHX

**AKC:** QC SC FC

Hound Certification previously submitted.

I hereby certify that the hound identified above has completed the requirements for the title indicated above (or that the required Certification was previously submitted) and that the information provided on this form is true and correct.

Signature: \_\_\_\_\_ Date: \_\_\_\_\_

Owner or Authorized Agent of Hound

Michigan Gazehound Association  
Williamston Camping Registration

**Rates**

- \$20/night for primitive camping

**Instructions**

- Please complete form and either...
    - Submit form with payment, which may be included with entries, to the field trial secretary in advance of the event, **OR**
- Present form and separate payment at the event to FTS.

1. No dumping of any waste water.
2. Campers must maintain a clean site during the event and upon departure. Take trash with you.
3. Bigger RVs need to first contact the FTS before submitting this form.

**Camping Request and Registration**

Camper Name:

\_\_\_\_\_

Phone: \_\_\_\_\_

Address:

\_\_\_\_\_

Emergency Contact Name and Phone:

\_\_\_\_\_

Number of people staying on site: \_\_\_\_\_

Number of nights: \_\_\_\_\_ Amount paid: \_\_\_\_\_

*I have read the above camping rules and by signing this form will recognize and comply with said terms. Be it understood that in no way shall the owners of Tazidan Farm be held responsible for loss or injury of any character to persons or articles while participating in the event at the Farm.*

Signed:

\_\_\_\_\_

Date: \_\_\_\_\_